

INDEX OF SHEETS

- 1 COVER SHEET, INDEX OF SHEETS & LIST OF STANDARDS
- 2-3 SUMMARY OF QUANTITIES
- 4 GENERAL NOTES
- 5-7 EXISTING TYPICAL SECTIONS
- 8-13 PROPOSED TYPICAL SECTIONS
- 14-17 SCHEDULE OF QUANTITIES
- 18 HORIZONTAL CONTROL LAYOUT & TIE POINTS
- 19-20 ROW PLANS
- 21-24 PLAN AND PROFILE
- 25-44 STAGE CONSTRUCTION / TRAFFIC CONTROL PLANS
- 45-50 EROSION CONTROL
- 51-54 STAGE PAVING TYPICAL SECTIONS / PAVING DETAILS
- 55-56 DETAILS
- 57 WETLAND GRADING PLAN
- 58 WETLAND SEEDING / PLANTING PLAN
- 59-63 STRUCTURE PLANS
- 64-111 CROSS SECTIONS

LIST OF STANDARDS

- 000001-04 STANDARD SYMBOLS, ABBREVIATIONS AND PATTERNS
- 280001-03 TEMPORARY EROSION CONTROL SYSTEMS
- 406201 MAILBOX TURNOUT
- 515001-02 NAME PLATES FOR BRIDGES
- 542301-01 PRECAST REINFORCED CONCRETE FLARED END SECTION
- 630301-04 SHOULDER WIDENING FOR TYPE 1 (SPECIAL) GUARDRAIL TERMINALS
- 631032-03 TRAFFIC BARRIER TERMINAL, TYPE 6A
- 635006-02 REFLECTOR AND TERMINAL MARKER PLACEMENT
- 6350011-01 REFLECTOR MARKER AND MOUNTING DETAILS
- 666001 RIGHT OF WAY MARKERS
- 667101 PERMANENT SURVEY MARKERS
- 701001-01 OFF-ROAD OPERATIONS, 2L 2W, 15' MIN. AWAY, FOR SPEEDS > 45 MPH
- 701006-02 OFF-ROAD OPERATIONS, 2L 2W, 15' TO PAVEMENT EDGE, FOR SPEEDS > 45 MPH
- 701011-01 OFF-ROAD MOVING OPERATIONS, 2L 2W, DAY ONLY, FOR SPEEDS > 45 MPH
- 701201-02 LANE CLOSURE, 2L 2W, DAY ONLY, ON-ROAD TO 24" OFF-ROAD, FOR SPEEDS > 45 MPH
- 701301-02 LANE CLOSURE, 2L 2W, SHORT TIME OPERATIONS
- 701306-01 LANE CLOSURE, 2L 2W, SLOW MOVING DAY ONLY OPERATIONS, FOR SPEEDS > 45 MPH
- 701311-02 LANE CLOSURE, 2L 2W, MOVING DAY ONLY OPERATIONS
- 702001-06 TRAFFIC CONTROL DEVICES
- 780001-01 TYPICAL PAVEMENT MARKINGS



345 E. ASH AVE.
 DECATUR, ILLINOIS 62526
 PH. 217-875-4800

JOINT UTILITY LOCATING INFORMATION FOR EXCAVATORS

J.U.L.I.E. Telephone No. Toll Free 1-800-892-0123

STATE OF ILLINOIS
 DEPARTMENT OF TRANSPORTATION
 DIVISION OF HIGHWAYS
 PLANS FOR PROPOSED
HPP, NCPD, HPR FEDERAL AID HIGHWAY

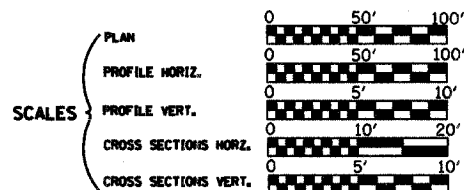

FAS 209 (C.H. 14) OVER KEATING CREEK
SECTION 00-00091-00-BR
PROJECT BRS-NCPD-HPP-1323(113)
MERCER COUNTY
C - 9413900

A.D.T.-----1185 (2002)
 CLASS ROAD-----COLLECTOR
 DESIGN SPEED-----50 mph

PROJECT AND IMPROVEMENT BEGINS
STA. 87+25.00

QC/QA
BITUMINOUS

STRUCTURE NO. 066-3157
STA. 111+37.50 TO
STA. 111+97.50

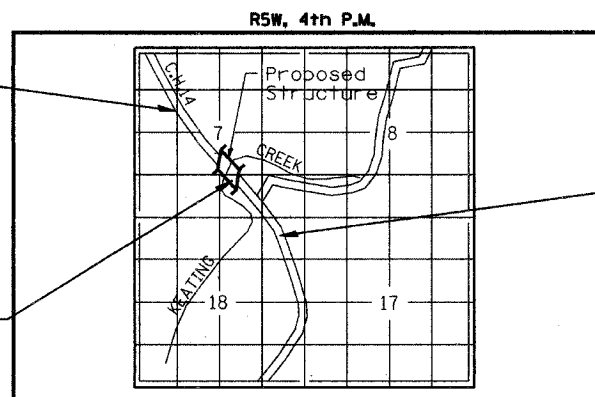

PROJECT AND IMPROVEMENT ENDS
STA. 136+50.00



LAYOUT

Approximate Scale: scale miles

Total and Net Length of Improvement 4925.00 Feet = 0.933 Miles

Stephen Keboe
 Illinois Professional No. 48103

2-15-07
 Date

CONTRACT NO. : 89312

Expires: 11-30-07

RTE. NO.	SECTION	COUNTY	TOTAL SHEETS	SHTS. NO.
C.H. 14 FAS 209	00-00091-00-BR	MERCER	III	I
FED. ROAD DIST. NO.	ILLINOIS PROJECT			

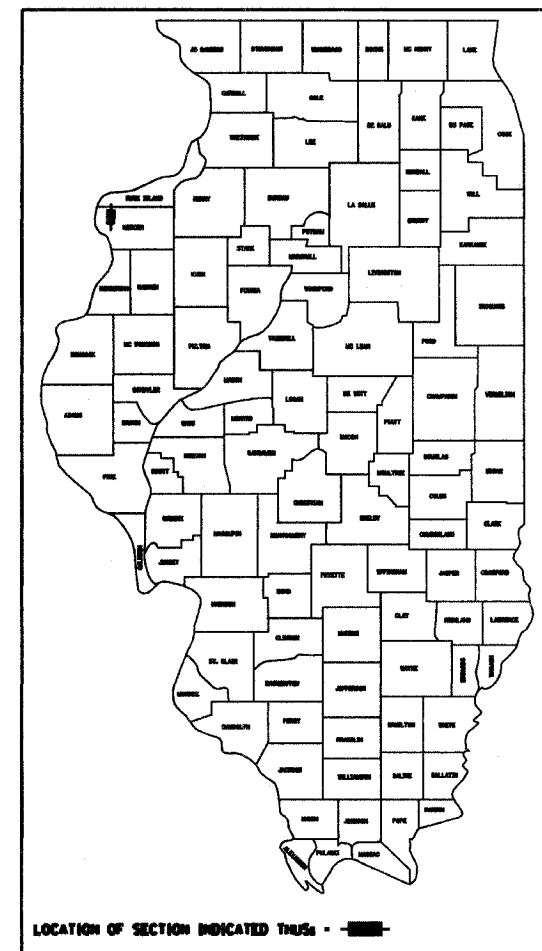

AGENCY RESPONSIBLE FOR LETTING	
APPROVED	<u>February 19</u> 20 <u>07</u> <i>[Signature]</i> COUNTY ENGINEER
PASSED	<u>February 26</u> 20 <u>07</u> <i>[Signature]</i> DISTRICT 4 ENGINEER OF LOCAL ROADS AND STREETS
RELEASING FOR BID BASED ON LIMITED REVIEW	<u>FEB 26</u> 20 <u>07</u> <i>[Signature]</i> DEPUTY DIRECTOR OF HIGHWAYS REGION 4 ENGINEER