

RTE.	SECTION	COUNTY	TOTAL SHEETS	SHEET NO.
C.H. 14 F.A.S. 209	00-00091-00-BR	MERCER	111	26
STA. 87+25	TO STA. 100+00			
CONTRACT NO. 89312				

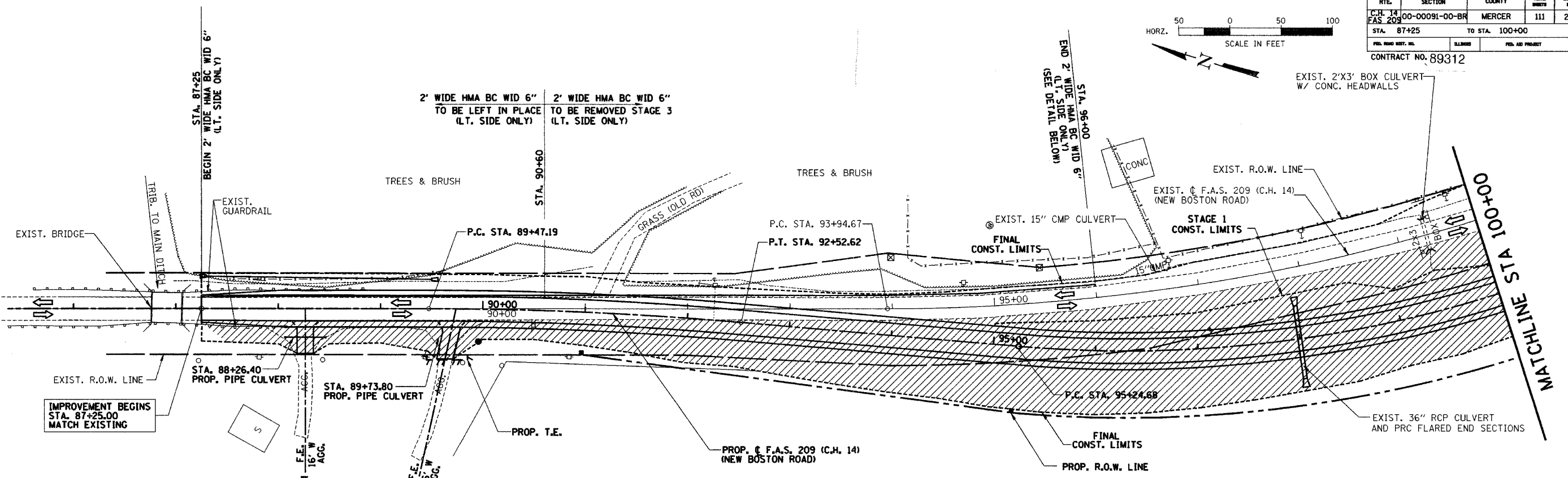
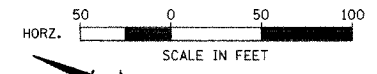

OVERALL STAGE 1

SUGGESTED CONSTRUCTION SEQUENCE

MAINTAIN 2-WAY TRAFFIC ON EXISTING PAVEMENT USING TRAFFIC CONTROL STDS. 701001, 701006, 701011, 701201 & 701301
STA. 87+25 TO 136+50

- 1 PLACE TEMPORARY EROSION CONTROL MEASURES
- 2 REMOVE TREES DESIGNATED IN THE PLANS TO BE REMOVED
- 3 REMOVE AND STOCKPILE WETLAND MATERIAL AS SHOWN IN CROSS SECTIONS
- 4 GRADE WETLAND AND THEN PLACE WETLAND MATERIAL IN PROPOSED WETLAND LT STA 111+90 TO LT STA 113+80
- 5 SEED AND PLANT WETLAND ACCORDING TO PLANS
- 6 CONSTRUCT BRIDGE STA 111+67
- 7 CONSTRUCT NEW CROSS ROAD CULVERT STA 125+00 ALONG WITH TEMPORARY CULVERT AND MANHOLE
- 8 CONSTRUCT PATCH STA 125+00
- 9 CONSTRUCT NEW CROSS ROAD CULVERT STA 127+25 ALONG WITH TEMPORARY CULVERT
- 10 REMOVE EXISTING 12" CMP CULVERT AT STA 127+18.16
- 11 CONSTRUCT PATCH STA 127+25
- 12 CONSTRUCT PIPE CULVERT LT STA 87+30 TO LT 89+50
- 13 CONSTRUCT 2' WIDE HOT-MIX ASPHALT BASE COURSE WIDENING 6" LT STA 87+25 TO LT STA 96+00 AND TEMPORARY EARTH SHOULDER
- 14 CONSTRUCT 2' WIDE HOT-MIX ASPHALT BASE COURSE WIDENING 6" RT STA 87+25 TO RT STA 91+13
- 15 REMOVE AND STOCKPILE TOPSOIL RT STA 106+50 TO STA 133+00
- 16 CONSTRUCT FINAL EARTHWORK UP TO BOTTOM OF SUBGRADE ELEVATION ALONG RT SIDE
- 17 CONSTRUCT TEMPORARY 2:1 SLOPE ON LT SIDE STA 102+50 TO STA STA 126+00
- 18 CONSTRUCT HOT-MIX ASPHALT BASE COURSE WIDENING 6" RT STA 87+25 TO RT STA 91+13
- 19 CONSTRUCT HOT-MIX ASPHALT BASE COURSE WIDENING 6" RT STA 132+44 TO RT STA 136+50
- 20 CONSTRUCT HOT-MIX ASPHALT BASE COURSE 4" RT STA 91+13 TO RT STA 94+00
- 21 CONSTRUCT HOT-MIX ASPHALT BASE COURSE 4" RT STA 127+50 TO RT STA 132+44
- 22 CONSTRUCT FULL DEPTH PAVEMENT STA 94+00 TO STA 127+50
- 23 CONSTRUCT ENTRANCE CULVERT RT STA 88+26.4, MAINTAIN ACCESS
- 24 CONSTRUCT ENTRANCE CULVERT RT STA 133+29.8 AND STA 135+12.5, MAINTAIN ACCESS
- 25 CONSTRUCT AGGREGATE SHOULDERS AND MAILBOX TURNOUTS
- 26 CONSTRUCT F.E. RT STA 109+50
- 27 PLACE TOPSOIL AND FINAL SEEDING ALONG RIGHT SIDE
- 28 CONSTRUCT NEW GUARDRAIL AT BRIDGE
- 29 APPLY FINAL STRIPING STA 94+00 TO 127+00

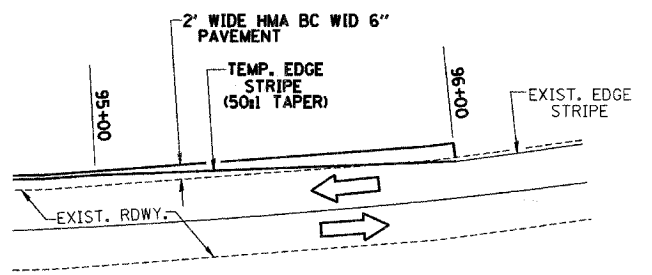

TEMPORARY PAVEMENT & STRIPING DETAIL

- = HATCHED AREA INDICATES WORK AREA
- = DIRECTION OF TRAFFIC

NOTE: LEFT AND RIGHT SIDES OF THE EXISTING TRAFFIC LANES SHALL NOT BE WORKED ON SIMULTANEOUSLY.

LANE CLOSURE, DAY OPERATIONS ONLY
OPEN EXISTING ROADWAY TO TRAFFIC AT NIGHT

TRAFFIC CONTROL - STAGE I

Date	Designed: SMK	F.A.S. 209 (C.H. 14) OVER KEATING CREEK NEW BOSTON ROAD SECTION 00-00091-00-BR MERCER COUNTY
Revisions	Drawn: SRS	
	Checked: SMK	
	App. by: SMK	
Prepared by:	URS 345 East Ash Avenue Decatur, IL 62526	URS Job No. 21-00001253.01