

180 170 160 150 140 130 120 110 100 90 80 70 60 50 40 30 20 10 0 10 20 30 40 50 60

RTE. NO.	SECTION NO.	COUNTY	TOTAL SHTS.	SHEET NO.
FAS 209 C.H. 14	00-00091-00-BR	MERCER	III	90
STA. 87+00.00		TO STA. 87+50.00		
FED. ROAD DIST. NO.		ILLINOIS PROJECT		

CONTRACT NO. 89312

SCALE  
HORZ. 1"=10'  
VERT. 1"=5'

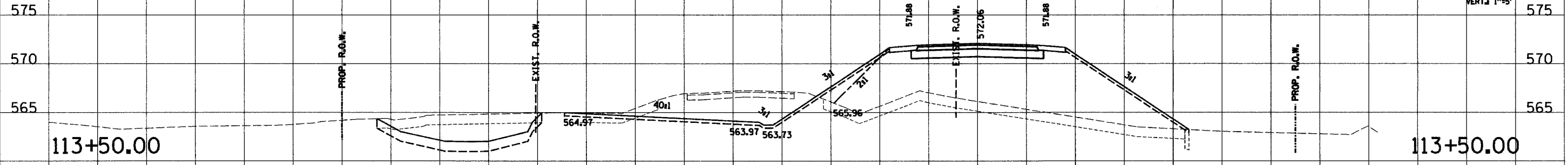

113+50.00 TE1A = 73.8 WEP1A = 33.8 WEE1A = 1.8 C1B = 68.3 F1B = 367. WTS1B = 33.8 TS1B = 8.8 C3 = 94.3 F3 = 11.1 TS3 = 21.3

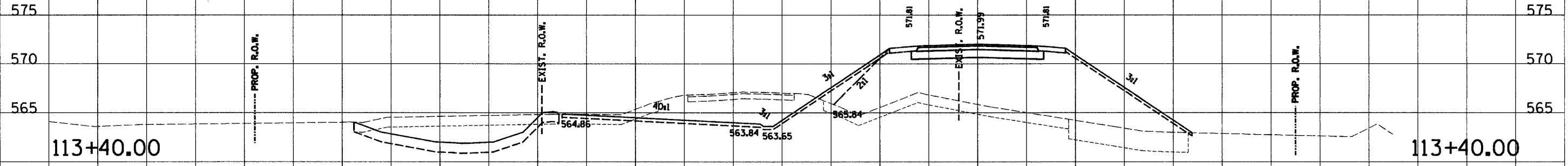

113+40.00 TE1A = 50. WEP1A = 41.9 WEE1A = 48.9 C1B = 76.1 F1B = 403. WTS1B = 41.9 TS1B = 8.9 C3 = 94.1 F3 = 11.2 TS3 = 21.5

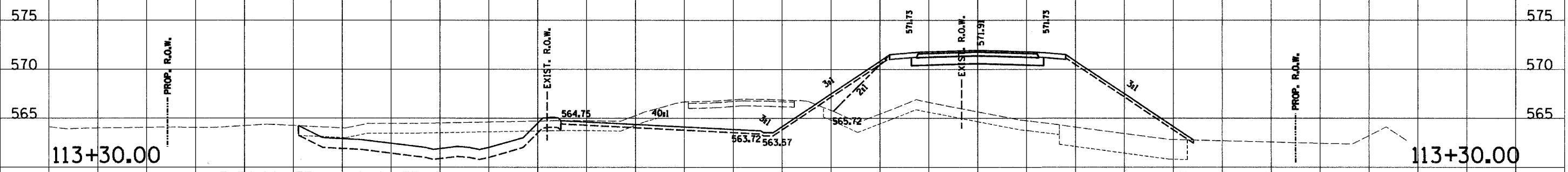

113+30.00 TE1A = 48.2 WEP1A = 53.7 WEE1A = 52.4 C1B = 91.4 F1B = 410.3 WTS1B = 53.7 TS1B = 9.0 C3 = 93.8 F3 = 11.2 TS3 = 21.6

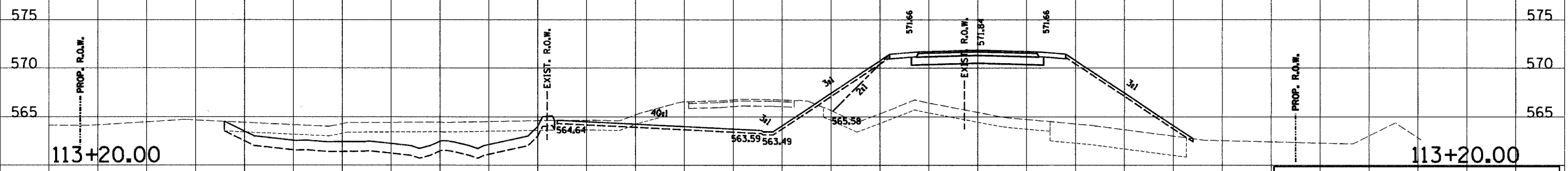

113+20.00 TE1A = 46.3 WEP1A = 67.6 WEE1A = 55.8 C1B = 118.6 F1B = 407. WTS1B = 67.6 TS1B = 9.0 C3 = 93.6 F3 = 11.4 TS3 = 21.8

C.H. 14

180 170 160 150 140 130 120 110 100 90 80 70 60 50 40 30 20 10 0 10 20 30 40 50 60 70 80 90 100