

180 170 160 150 140 130 120 110 100 90 80 70 60 50 40 30 20 10 0 10 20 30 40 50 60

| | | | | |
|---------------------|----------------|-----------------------------|-------------|-----------|
| RTE. NO. | SECTION NO. | COUNTY | TOTAL SHTS. | SHEET NO. |
| FAS 209 C.H. 14 | 00-00091-00-BR | MERCER | 111 | 91 |
| STA. 87+00.00 | | TO STA. 87+50.00 | | |
| FED. ROAD DIST. NO. | | ILLINOIS PROJECT | | |
| CONTRACT NO. 89312 | | SCALE | | |
| | | HORZ. 1"=10' VERT. 1"=5' | | |

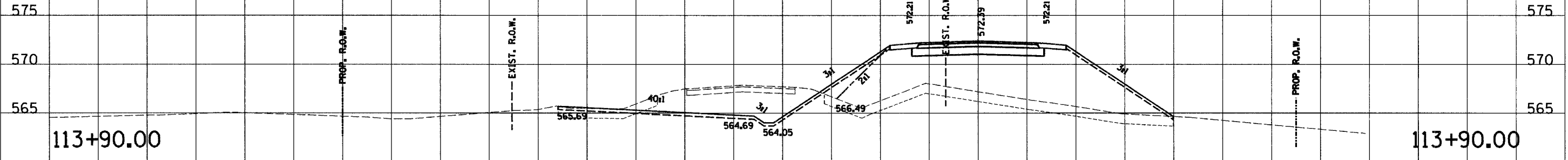

113+90.00 TE1A = 71.3 WEP1A = 0.0 WEE1A = 0.0 C1B = 0.0 F1B = 314.3 WTS1B = 0.0 TS1B = 7.6 C3 = 93.4 F3 = 10.6 TS3 = 22.1

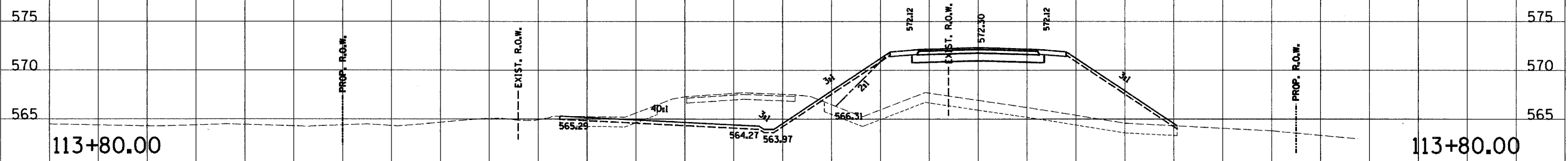

113+80.00 TE1A = 72.2 WEP1A = 0.0 WEE1A = 0.0 C1B = 0.0 F1B = 329.4 WTS1B = 0.0 TS1B = 7.9 C3 = 98.3 F3 = 10.8 TS3 = 21.9

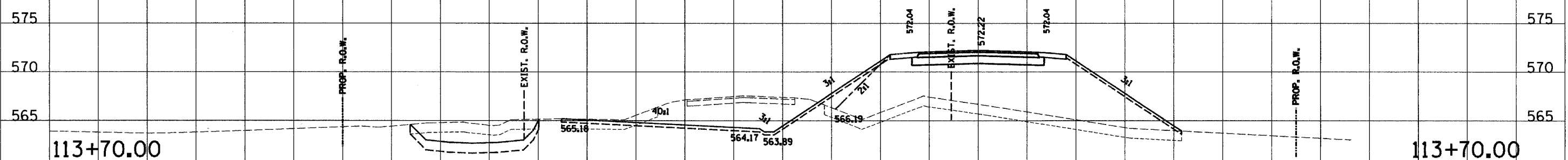

113+70.00 TE1A = 73.1 WEP1A = 26.3 WEE1A = 0.0 C1B = 46.3 F1B = 340. WTS1B = 26.3 TS1B = 8.2 C3 = 97.0 F3 = 10.9 TS3 = 21.8

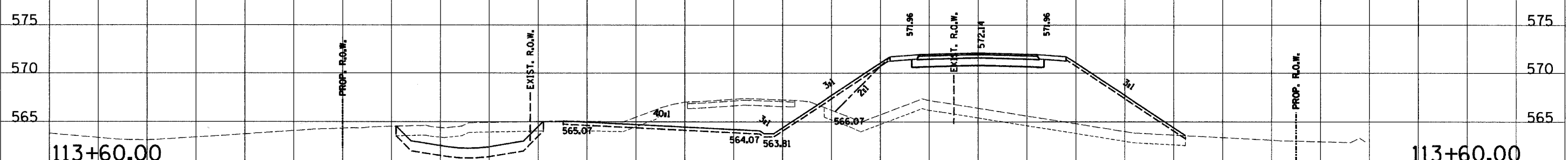

113+60.00 TE1A = 73.9 WEP1A = 30.2 WEE1A = 0.0 C1B = 56.2 F1B = 353.3 WTS1B = 30.2 TS1B = 8.5 C3 = 95.9 F3 = 10.9 TS3 = 21.7

C.H. 14

180 170 160 150 140 130 120 110 100 90 80 70 60 50 40 30 20 10 0 10 20 30 40 50 60 70 80 90 100