

FED. AID DIST. NO.	SECTION	COUNTY	TOTAL SHEETS	SHEET NO.
6385 96-00306-00-SP	McLean	30	10	
STA. 789+01		TO STA. 794+25		

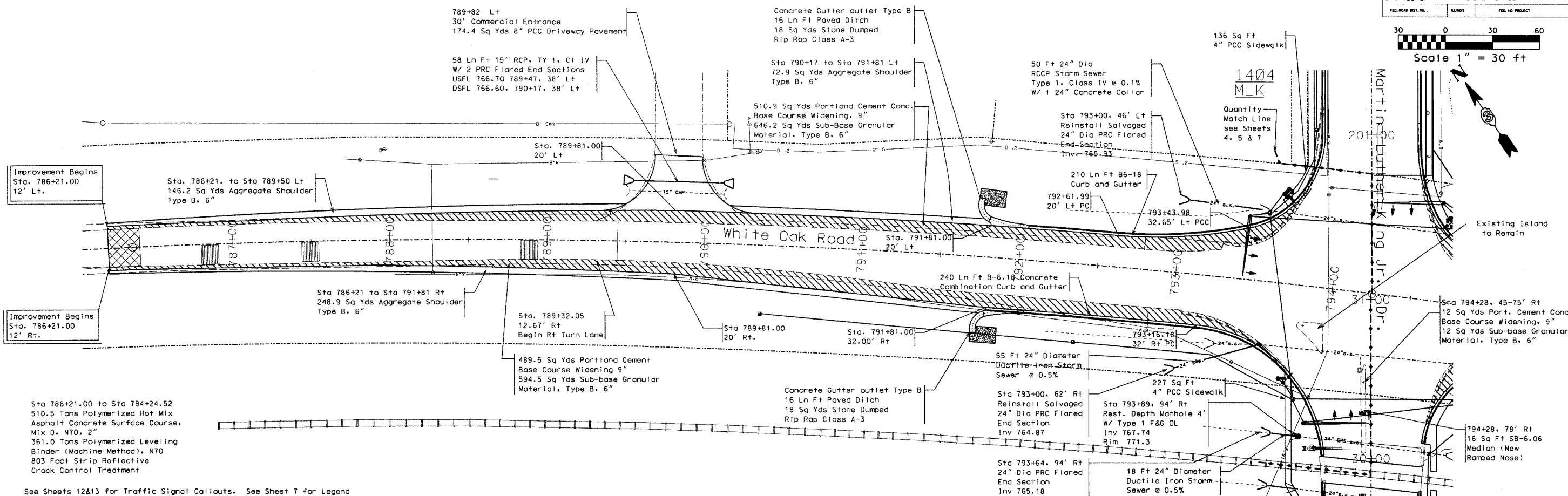

Sta 786+21.00 to Sta 794+24.52
 510.5 Tons Polymerized Hot Mix Asphalt Concrete Surface Course, Mix D, N70, 2"
 361.0 Tons Polymerized Leveling Binder (Machine Method), N70
 803 Foot Strip Reflective Crack Control Treatment

See Sheets 12&13 for Traffic Signal Callouts. See Sheet 7 for Legend

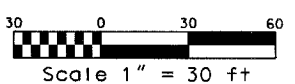
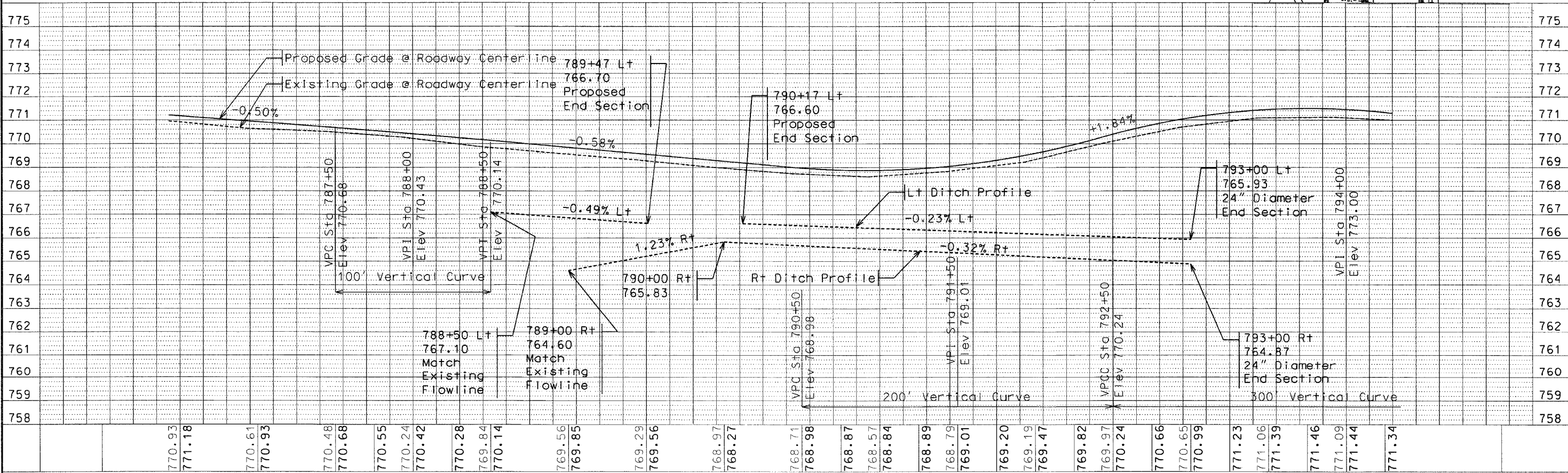

Lewis, Yockey & Brown, Inc.
 Consulting Engineers & Land Surveyors
 505 North Main Street, 1111 North Main Street, 222 East Center Street, 1155 South Elm Street
 Bloomington, IL 61701, Springfield, IL 62701, Peoria, IL 61601, St. Louis, MO 63101
 Ph. (309) 829-2552 Ph. (309) 962-8151 Ph. (309) 527-2552

MLK and WHITE OAK RD.
 Intersection Improvements
 North White Oak Road
 Plan and Profile

10
 4018.63