

T.A. SHEET	SECTION	COUNTY	TOTAL SHEETS	SHEET NO.
6385	96-00306-00-SP	McLEAN	30	18
STA. 204+00		TO STA. 206+00		
FED. ROAD DIST. NO. ...		ILLINOIS		FED. AID PROJECT

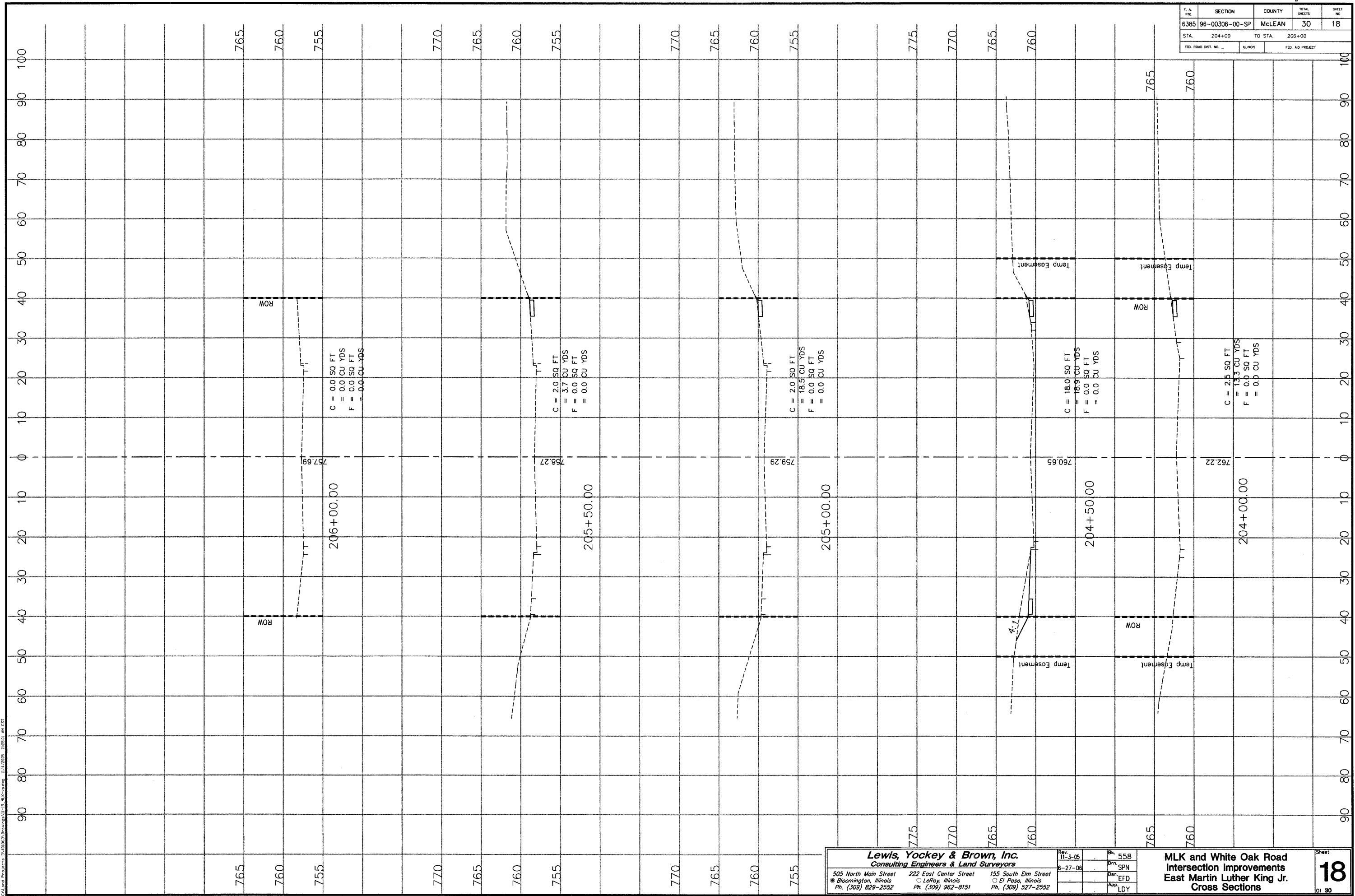

765
760
755

206+00.00

757.69

ROW

C = 0.0 SQ FT
= 0.0 CU YDS
F = 0.0 SQ FT
= 0.0 CU YDS

770
765
760
755

205+50.00

758.27

ROW

C = 2.0 SQ FT
= 3.7 CU YDS
F = 0.0 SQ FT
= 0.0 CU YDS

770
765
760
755

205+00.00

759.29

ROW

C = 2.0 SQ FT
= 18.9 CU YDS
F = 0.0 SQ FT
= 0.0 CU YDS

775
770
765
760

204+50.00

760.65

ROW

C = 18.0 SQ FT
= 18.9 CU YDS
F = 0.0 SQ FT
= 0.0 CU YDS

765
760

204+00.00

762.22

ROW

C = 2.5 SQ FT
= 13.3 CU YDS
F = 0.0 SQ FT
= 0.0 CU YDS

Lewis, Yockey & Brown, Inc.
Consulting Engineers & Land Surveyors

505 North Main Street
Bloomington, Illinois
Ph. (309) 829-2552

222 East Center Street
LeRoy, Illinois
Ph. (309) 962-8151

155 South Elm Street
El Paso, Illinois
Ph. (309) 527-2552

Rev. 11-3-05
6-27-08

Bk. 558
Drm. SPN
Des. EFD
App. LDY

**MLK and White Oak Road
Intersection Improvements
East Martin Luther King Jr.
Cross Sections**

Sheet **18** of 30

DATE PLOTTED: 11/08/08 11:50:48 AM

4018.63