

F.A.U. ROUTE	SECTION	COUNTY	TOTAL SHEETS	SHEET NUMBER
9415	02-00055-00-RP	RANDOLPH	35	11
CITY OF CHESTER		PROJECT NO. M-5014(008)		
CONTRACT NO. 97274		JOB NO. C98-304-06		
FEDERAL AID PROJECT				

LEGEND

- POWER POLE
- POWER / TELEPHONE POLE
- TELEPHONE POLE
- SANITARY SEWER & MANHOLE
- FIRE HYDRANT
- WATER VALVE
- WATER METER
- WATER LINE
- GAS LINE
- GAS VALVE
- GAS METER
- RIGHT-OF-WAY LINE
- PROPERTY LINE
- FENCE LINE
- TREE LINE
- TELEPHONE PEDESTAL
- SIGN
- MAILBOX
- REINFORCED CONCRETE PIPE CULVERT
- CORRUGATED METAL PIPE CULVERT
- TOP OF CASTING
- INVERT
- FLOWLINE
- CURB FLAG
- BACK OF CURB

NOTE TO CONTRACTOR:
 EXISTING 15"/18" VCP UNDER HOUSE, GARPORT AND DRIVEWAY. CONNECTS TO EXISTING 24"/30" VCP UNDER SIDEWALK. EXACT LOCATION OF INTERCONNECT IS UNKNOWN. CONTRACTOR SHALL TAKE PRECAUTION WHEN REMOVING 24"/30" VCP IN THIS AREA TO KEEP DAMAGE OF THE EXISTING 15"/18" VCP TO A MINIMUM. CONTRACTOR SHALL EXISTING 15"/18" VCP TO NEW STORM SEWER SYSTEM. SEE SPECIAL PROVISIONS. THE CONTRACTOR SHALL LOCATE 15"/18" SEWER BENEATH THE EXISTING SIDEWALK PRIOR TO INSTALLING NEW INLETS/STORM SEWER AT STA. 26+80.

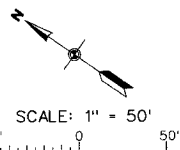
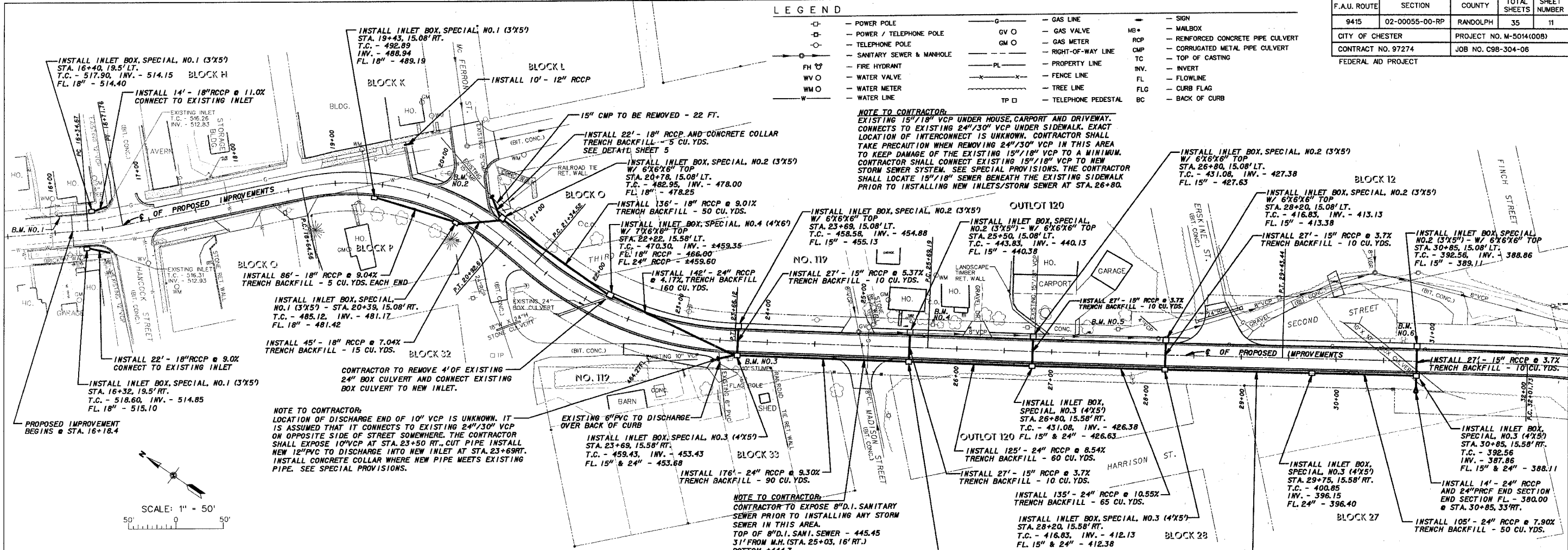

NOTE TO CONTRACTOR:
 LOCATION OF DISCHARGE END OF 10" VCP IS UNKNOWN. IT IS ASSUMED THAT IT CONNECTS TO EXISTING 24"/30" VCP ON OPPOSITE SIDE OF STREET SOMEWHERE. THE CONTRACTOR SHALL EXPOSE 10" VCP AT STA. 23+50 RT., CUT PIPE INSTALL NEW 12" PVC TO DISCHARGE INTO NEW INLET AT STA. 23+69 RT. INSTALL CONCRETE COLLAR WHERE NEW PIPE MEETS EXISTING PIPE. SEE SPECIAL PROVISIONS.

NOTE TO CONTRACTOR:
 CONTRACTOR TO EXPOSE 8" D.I. SANITARY SEWER PRIOR TO INSTALLING ANY STORM SEWER IN THIS AREA. TOP OF 8" D.I. SANI. SEWER - 445.45 31' FROM M.H. (STA. 25+03, 16' RT.) BOTTOM ±444.7

BENCHMARKS

- B.M. NO. 1 - 2-600 NAILS SET IN WESTERLY SIDE OF POWER POLE ON EAST SIDE OF BUENA VISTA STREET ±75' NORTH OF HANCOCK STREET. CENTERLINE OF IMPROVEMENT STA. 16+08, 18' LT. ELEV. - 581.41
- B.M. NO. 2 - 2-600 NAILS SET IN WESTERLY SIDE OF UTILITY POLE AT NORTHERLY CORNER OF INTERSECTION OF WILKINSON ST. AND BUENA VISTA ST. CENTERLINE OF IMPROVEMENT STA. 20+12, 29' LT. ELEV. - 489.91
- B.M. NO. 3 - 2-600 NAILS SET IN WEST SIDE LIGHT POLE ON WEST SIDE OF BUENA VISTA ST. ±250' SOUTH OF INTER. WILKINSON ST. AND BUENA VISTA ST. CENTERLINE OF IMPROVEMENT STA. 23+60, 20 RT. ELEV. - 483.73
- B.M. NO. 4 - 2-600 NAILS SET IN WEST SIDE UTILITY POLE ON EAST SIDE OF BUENA VISTA ST. ±75' SOUTH OF INTER. MADISON ST. AND BUENA VISTA ST. CENTERLINE OF IMPROVEMENT STA. 25+75, 25 LT. ELEV. - 444.63
- B.M. NO. 5 - RAILROAD SPIKE FOUND IN WEST SIDE UTILITY POLE ON EAST SIDE OF BUENA VISTA ST. ±120' NORTH OF INTER. ERSKINE ST. AND BUENA VISTA ST. CENTERLINE OF IMPROVEMENT STA. 27+70, 25 LT. ELEV. - 437.59
- B.M. NO. 6 - 2-600 NAILS SET IN WEST SIDE LIGHT POLE ON EAST SIDE OF BUENA VISTA ST. ±200' SOUTH OF INTER. ERSKINE ST. AND BUENA VISTA ST. CENTERLINE OF IMPROVEMENT STA. 30+70, 25 LT. ELEV. - 394.21
- B.M. NO. 7 - 2-600 NAILS SET IN WESTERLY SIDE OF UTILITY POLE ON EAST SIDE OF BUENA VISTA ST. ±250' NORTH OF INTER. GLEASON HILL HILL RD. AND BUENA VISTA ST. CENTERLINE OF IMPROVEMENT STA. 33+48, 50 LT. ELEV. - 397.21

