

FAP ROUTE	SECTION	COUNTY	TOTAL SHEETS	SHEET NO.
	05-00016-02-RP	MADISON	42	14
STA.	TO STA.			
CONTRACT NO.: 97290				

- NOTES**
- ROAD CLOSURE IS IN ACCORDANCE WITH STD. BLR 21.
 - TRAFFIC CONTROL IS IN ACCORDANCE WITH STD. 701501 AND AS DIRECTED BY THE ENGINEER.
 - DISTANCES MAY BE ADJUSTED TO FIT FIELD CONDITIONS.
 - EXACT LOCATIONS OF ALL WARNING SIGNS AND BARRICADES SHALL BE APPROVED BY THE ENGINEER PRIOR TO INSTALLATION.

- LEGEND**
- 1 ROAD CLOSED TO THRU TRAFFIC
 - 2 ROAD CONSTRUCTION AHEAD (WITH FLASHING LIGHT)
 - 4 ROAD CLOSED AHEAD
 - 5 DETOUR AHEAD 500 FEET 48" X 48" (W20-2)
 - 6 DETOUR 30" X 24" (M4-9R)
 - 7 END DETOUR 24"X18" (M4-8A)
 - 8 24" X 24"
 - 9 24" X 24"
 - 10 24" X 24"
 - 11 WEST CORBIN STREET
 - 18"x 18" (MINIMUM) ORANGE FLAG
 - FLASHING LIGHT
 - TYPE III BARRICADE WITH FLASHING LIGHT
 - T SIGN LOCATION AND DIRECTION

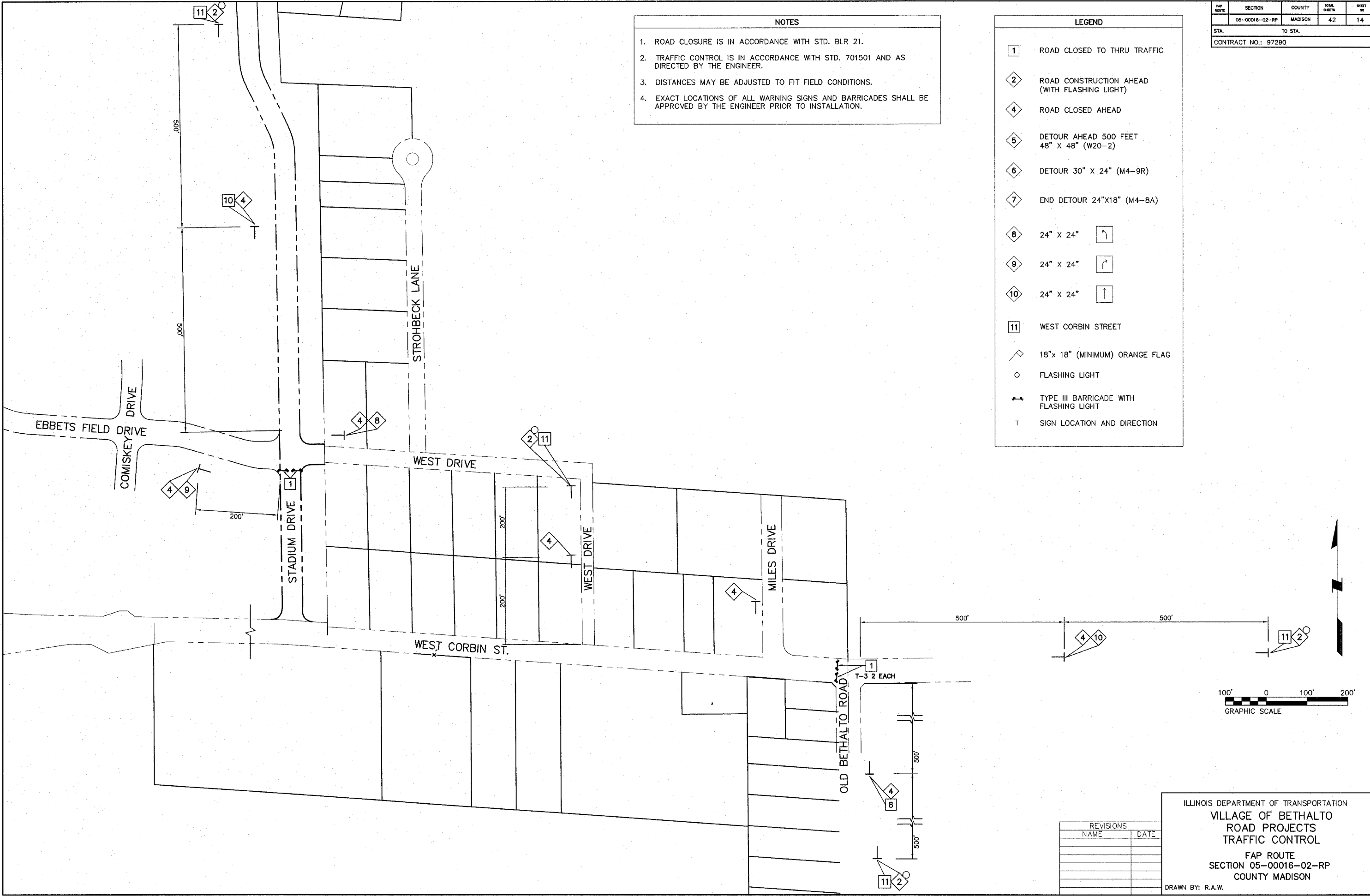

REVISIONS	
NAME	DATE

ILLINOIS DEPARTMENT OF TRANSPORTATION
VILLAGE OF BETHALTO
ROAD PROJECTS
TRAFFIC CONTROL
 FAP ROUTE
 SECTION 05-00016-02-RP
 COUNTY MADISON
 DRAWN BY: R.A.W.