

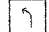

FAP ROUTE	SECTION	COUNTY	TOTAL SHEETS	SHEET NO.
	05-00016-02-RP	MADISON	42	16
STA.	TO STA.			
CONTRACT NO.: 97290				

LEGEND	
1	ROAD CLOSED TO THRU TRAFFIC
2	ROAD CONSTRUCTION AHEAD (WITH FLASHING LIGHT)
4	ROAD CLOSED AHEAD
5	DETOUR AHEAD 500 FEET 48" X 48" (W20-2)
6	DETOUR 30" X 24" (M4-9R)
7	END DETOUR 24"X18" (M4-8A)
8	24" X 24" 
9	24" X 24" 
10	24" X 24" 
11	WEST CORBIN STREET
	18"x 18" (MINIMUM) ORANGE FLAG
	FLASHING LIGHT
	TYPE III BARRICADE WITH FLASHING LIGHT
T	SIGN LOCATION AND DIRECTION

NOTES	
1.	ROAD CLOSURE IS IN ACCORDANCE WITH STD. BLR 21.
2.	TRAFFIC CONTROL IS IN ACCORDANCE WITH STD. 702001 AND AS DIRECTED BY THE ENGINEER
3.	DISTANCES MAY BE ADJUSTED TO FIT FIELD CONDITIONS.
4.	EXACT LOCATIONS OF ALL WARNING SIGNS AND BARRICADES SHALL BE APPROVED BY THE ENGINEER PRIOR TO INSTALLATION.

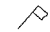
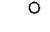
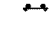
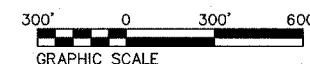
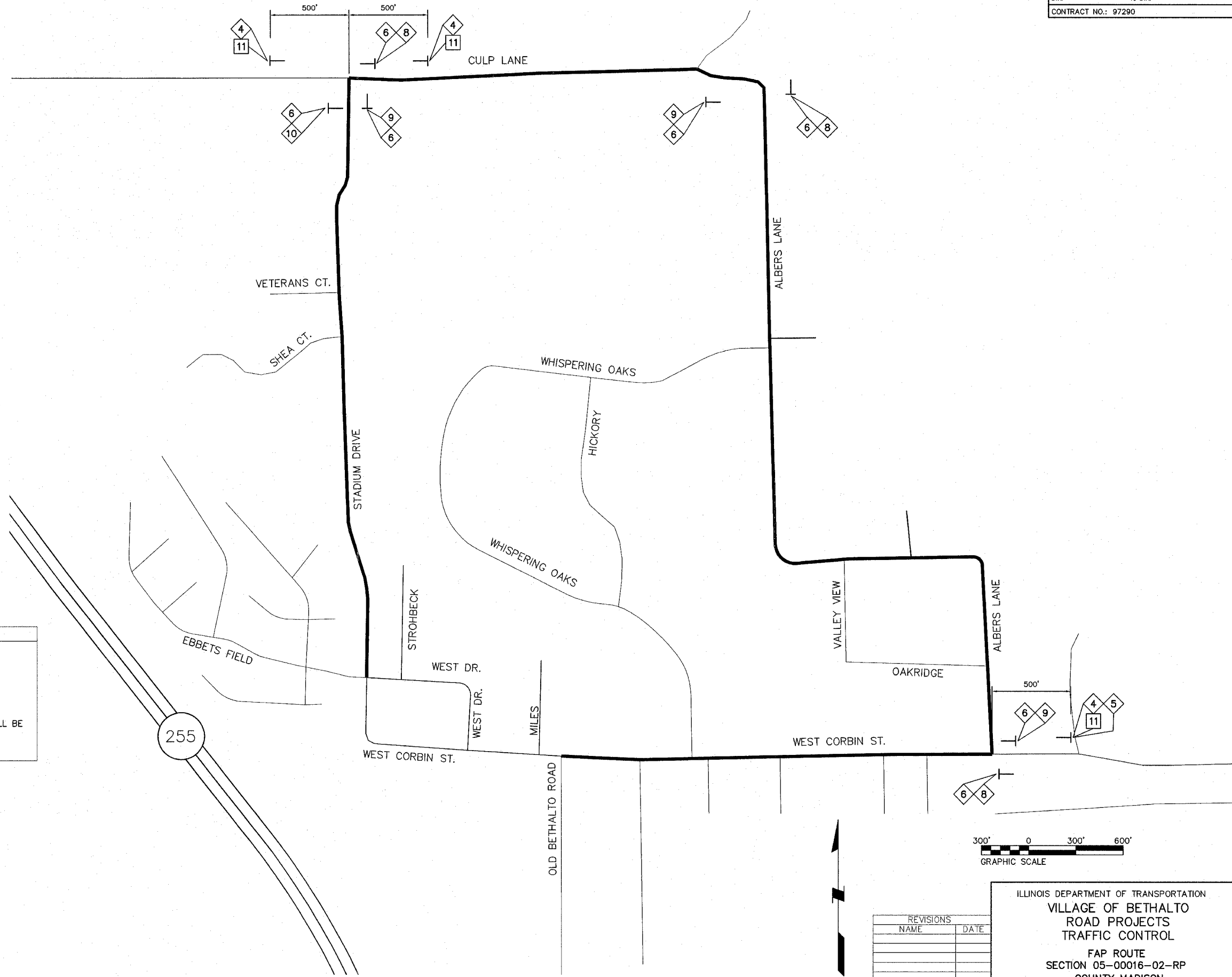

REVISIONS	
NAME	DATE

ILLINOIS DEPARTMENT OF TRANSPORTATION
VILLAGE OF BETHALTO
ROAD PROJECTS
TRAFFIC CONTROL
FAP ROUTE
SECTION 05-00016-02-RP
COUNTY MADISON
DRAWN BY: R.A.W.