

F.A. RTE.	SECTION	COUNTY	TOTAL SHEETS	SHEET NO.
*	**	WILLIAMSON	917	123
STA. TO STA.		FED. ROAD DIST. NO. ILLINOIS FED. AID PROJECT		
		* I-57, & OLD IL 13 (FAU 9629)		
		** (X1-6-2)VB-2,(X1-6)HKB-2		

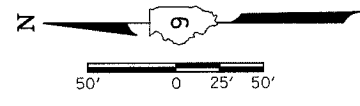

STA. 1538+38 (C NB) SKEWED 55° RT. AH.
 EXIST. 36" RCCP EXTEND WITH
 PIPE CULVERTS, CLASS A, TYPE 2 36"
 LT. 27.0', DSFL = 452.68
 RT. 25.0', USFL = 457.61
 CONCRETE COLLAR 0.66 CU. YDS. EACH (SEE DETAIL SHEET)
 CAST-IN-PLACE REINFORCED CONCRETE END SECTIONS 36"
 PIPE CULVERT REMOVAL
 CONCRETE HEADWALL REMOVAL
 EXTENSION RT. MUST BE COMPLETED PRIOR TO I-57 STAGE 3 CONSTRUCTION
 EXTENSION LT. MUST BE COMPLETED PRIOR TO I-57 STAGE 4 CONSTRUCTION

PROP. CURVE NEWEE-1
 PI STA. = 8+81.41
 $\Delta = 12^\circ 08' 09''$ (RT)
 $D = 7^\circ 29' 23''$
 $R = 765.00'$
 $T = 81.32'$
 $L = 162.03'$
 $E = 4.31'$
 S.E. RUN = 8%
 P.C. STA. = 8+00.09
 P.T. STA. = 9+62.12

GRADING AND SHAPING FORESLOPES
 110' X 10'
 LT. STA. 1535+25 TO STA. 1536+35 (C NB)
 GRADE EXISTING DITCH TO DRAIN

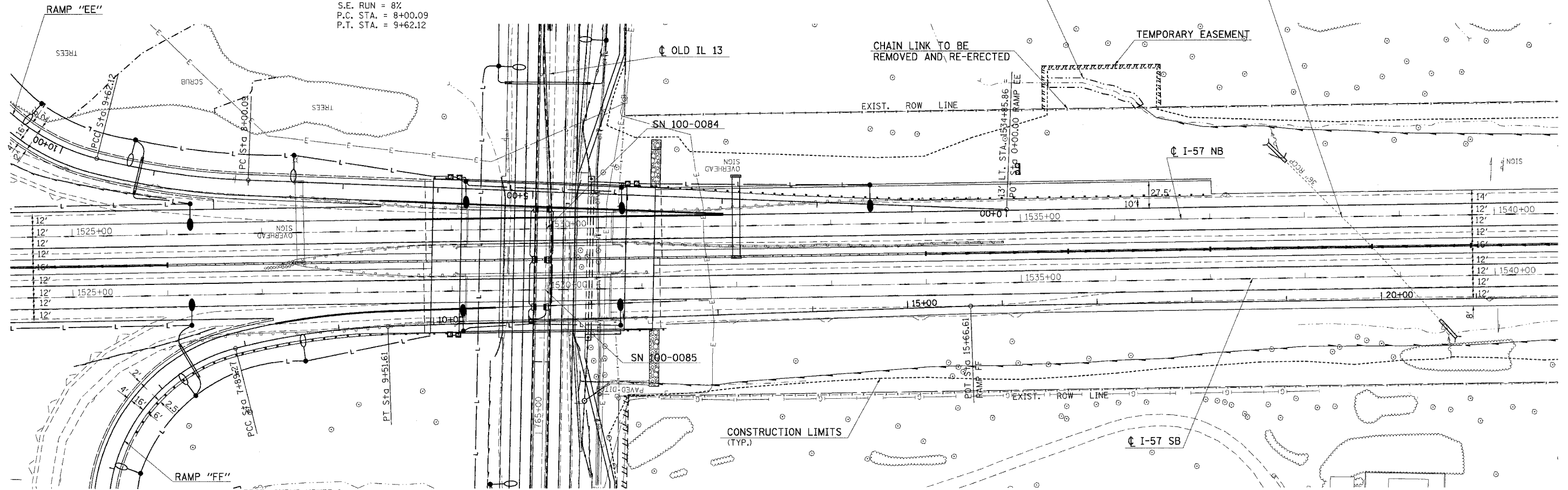

PROP. CURVE NEWFF-2
 PI STA. = 8+70.75
 $\Delta = 12^\circ 09' 32''$ (RT)
 $D = 7^\circ 29' 23''$
 $R = 765.00'$
 $T = 81.48'$
 $L = 162.34'$
 $E = 4.33'$
 S.E. RUN = 8%
 P.C. STA. = 7+89.27
 P.T. STA. = 9+51.61

REVISIONS	
NAME	DATE

ILLINOIS DEPARTMENT OF TRANSPORTATION
I-57 PLAN - PROFILE
STA. 1525+00 TO STA. 1540+00
 SHEET 1 OF 2
 SCALE: VERT. 50
 HORIZ. DATE
 DRAWN BY CNH
 CHECKED BY

PLOT DATE = 12/17/2006
 FILE NAME = c:\pwworkspace\982882\civil3\1540.dwg
 USER NAME = jason
 PPAAS, PPT3