

F.A. RTE.	SECTION	COUNTY	TOTAL SHEETS	SHEET NO.
**	**	WILLIAMSON	917	250
STA. 1513+50.0000 TO STA. 1513+66.4968				
FED. ROAD DIST. NO. ILLINOIS FED. AID PROJECT				
* 1-57, & OLD ILL. 13 (FAU 9629)				
** (X1-6-2)VB-2,(X1-6)HBK-2				

DATE	
BY	
REVIEWED	
DESIGNED	
CHECKED	
NO.	

DATE	
BY	
REVIEWED	
DESIGNED	
CHECKED	
NO.	

PLOT DATE = 10/25/2006  
 PLOT SCALE = 1"=40'  
 USER NAME = lavenderba

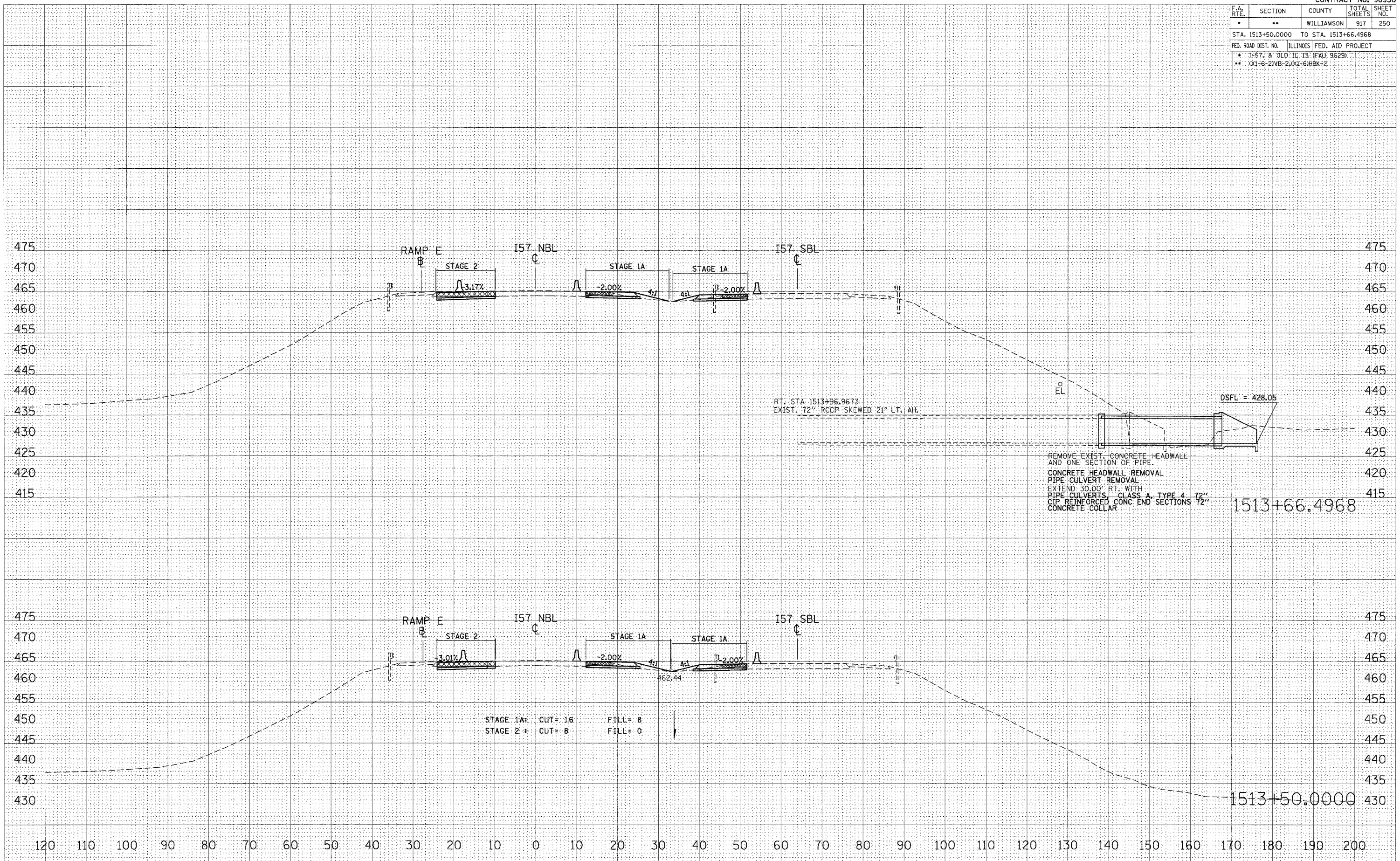

STAGE 1A: CUT= 16 FILL= 8  
 STAGE 2 : CUT= 8 FILL= 0

REMOVE EXIST. CONCRETE HEADWALL AND ONE SECTION OF PIPE.  
 CONCRETE HEADWALL REMOVAL  
 PIPE CULVERT REMOVAL  
 EXTEND 30.00' RT. WITH PIPE CULVERTS, CLASS A, TYPE 4, 72" CIP REINFORCED CONC END SECTIONS 72" CONCRETE COLLAR

STA 1513+50.0000 TO STA 1513+66.4968 I57 NBL STAGES 1, 1A, 2, & 3