

CONTRACT NO. 98950

F.A. RTE.	SECTION	COUNTY	TOTAL SHEETS	SHEET NO.
*	*	WILLIAMSON	917	363

STA. TO STA.  
 FED. ROAD DIST. NO. ILLINOIS FED. AID PROJECT  
 \* I-57, & OLD IL 13 (FAU 9629)  
 \*\* (X1-6-2)VB-2,(X1-6)HBK-2

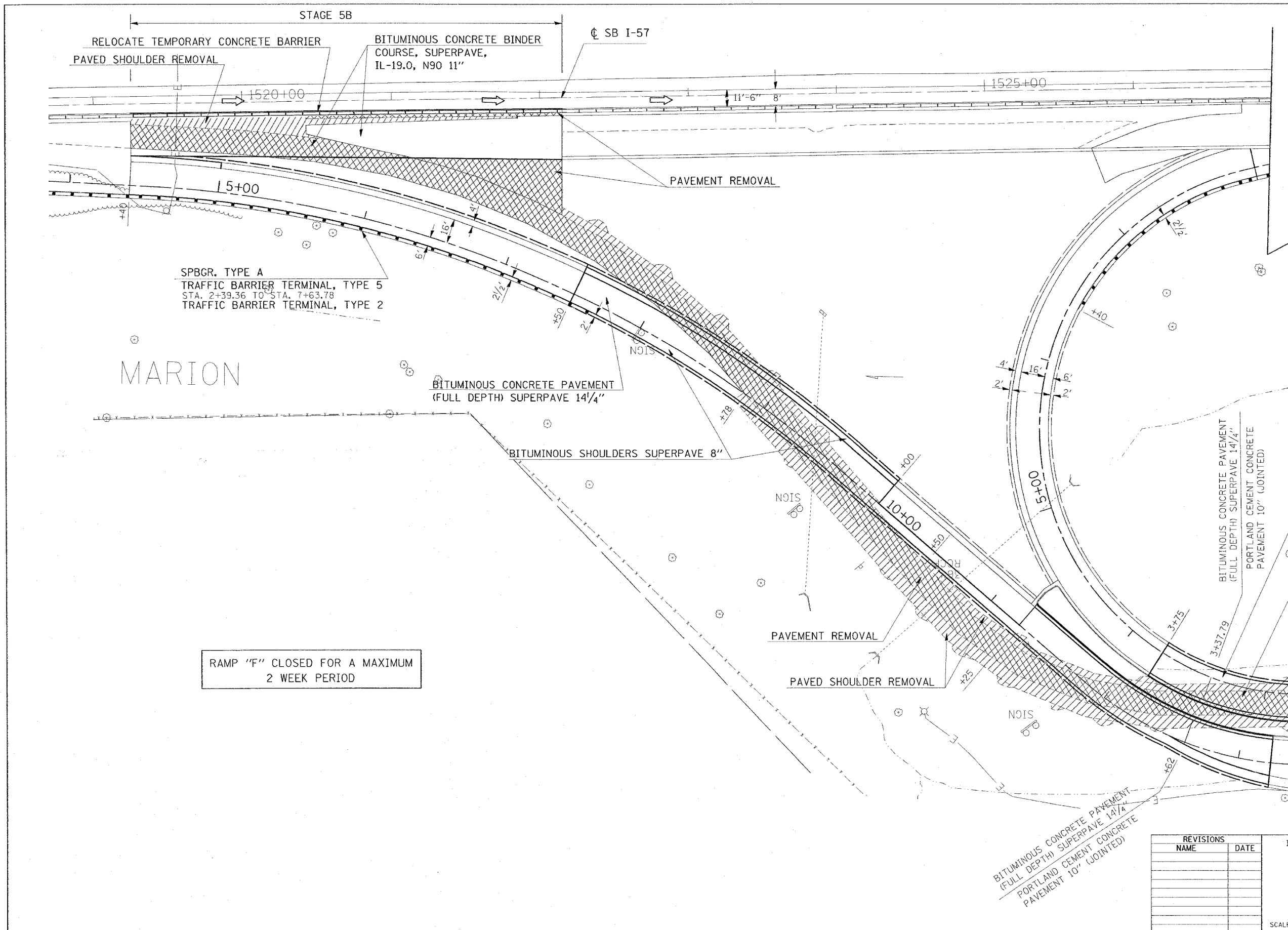

MARION

SPBGR. TYPE A  
 TRAFFIC BARRIER TERMINAL, TYPE 5  
 STA. 2+39.36 TO STA. 7+63.78  
 TRAFFIC BARRIER TERMINAL, TYPE 2

RAMP "F" CLOSED FOR A MAXIMUM  
 2 WEEK PERIOD

MATCHLINE STAGE 5A & 5B (SEE SHEET 4 OF 4)

REVISIONS	
NAME	DATE

ILLINOIS DEPARTMENT OF TRANSPORTATION  
**RAMP "F" AND "FF"**  
**STAGE 5A & 5B**  
**SHEET 3 OF 4**

SCALE: VERT. APPROX. 30  
 HORIZ. DATE  
 DRAWN BY CNH  
 CHECKED BY

PLOT DATE = 11/17/2006  
 FILE NAME = c:\p\objects\98950\stage5a\stage5a.dgn  
 PLOT SCALE = 30.0000 / IN.  
 USER NAME = mason