

CONTRACT NO. 98950				
F.A. RTE.	SECTION	COUNTY	TOTAL SHEETS	SHEET NO.
*	**	WILLIAMSON	917	553
STA. 1513+66.4968 TO STA. 1514+00.0000				
FED. ROAD DIST. NO.	ILLINOIS FED. AID PROJECT			
* 1-57, & OLD IL. 13 (FAJ 9629)				
** (X1-6-2) NB-2, (X1-6) HBK-2				

DATE	
BY	
FINAL SURVEY	
SURVEYED	
PLOTTED	
TEMPLATE	
NO. _____	
AREAS CHECKED	

DATE	
BY	
ORIGINAL SURVEY	
SURVEYED	
PLOTTED	
TEMPLATE	
NO. _____	
AREAS CHECKED	

DATE = 10/25/2006
 PLOT SCALE = 10.0000" = 1.0000'
 USER NAME = lovendeb

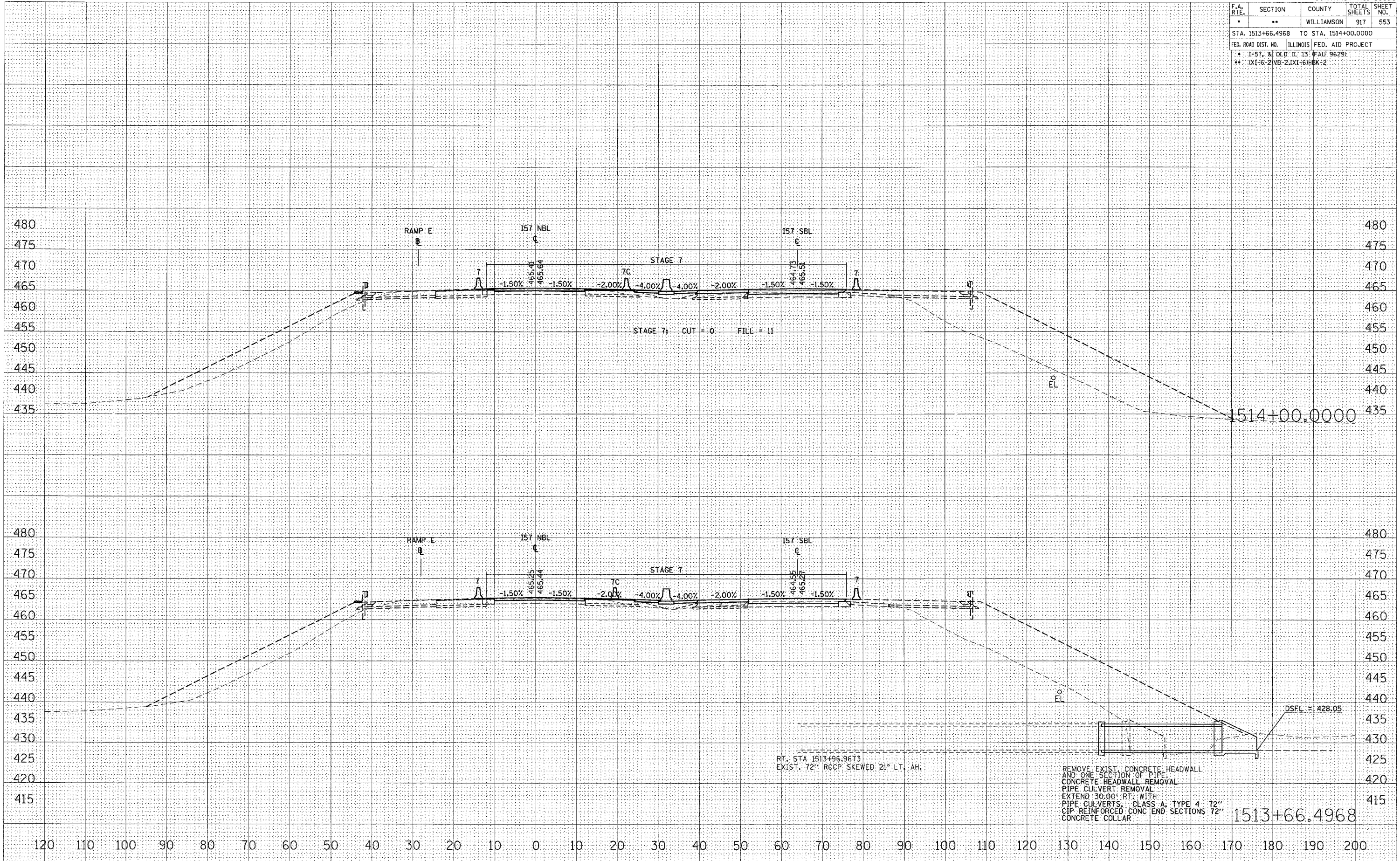

STA 1513+66.4968 TO STA 1514+00.0000 I57 NBL STAGE 7, 7A, 7B & 7C