

F.A. RTE.	SECTION	COUNTY	TOTAL SHEETS	SHEET NO.
*	**	WILLIAMSON	917	666
STA.		TO STA.		
FED. ROAD DIST. NO.		ILLINOIS FED. AID PROJECT		
* I-57, & OLD IL 13 (FAU 9629)				
** (X1-6-2)VB-2,(X1-6)HBK-2				

**LEGEND**

	END SECTIONS
	INLETS
	STORM SEWER
	CONCRETE COLLAR
	PAVED DITCH
	CLASS B PATCHES, 10 INCH

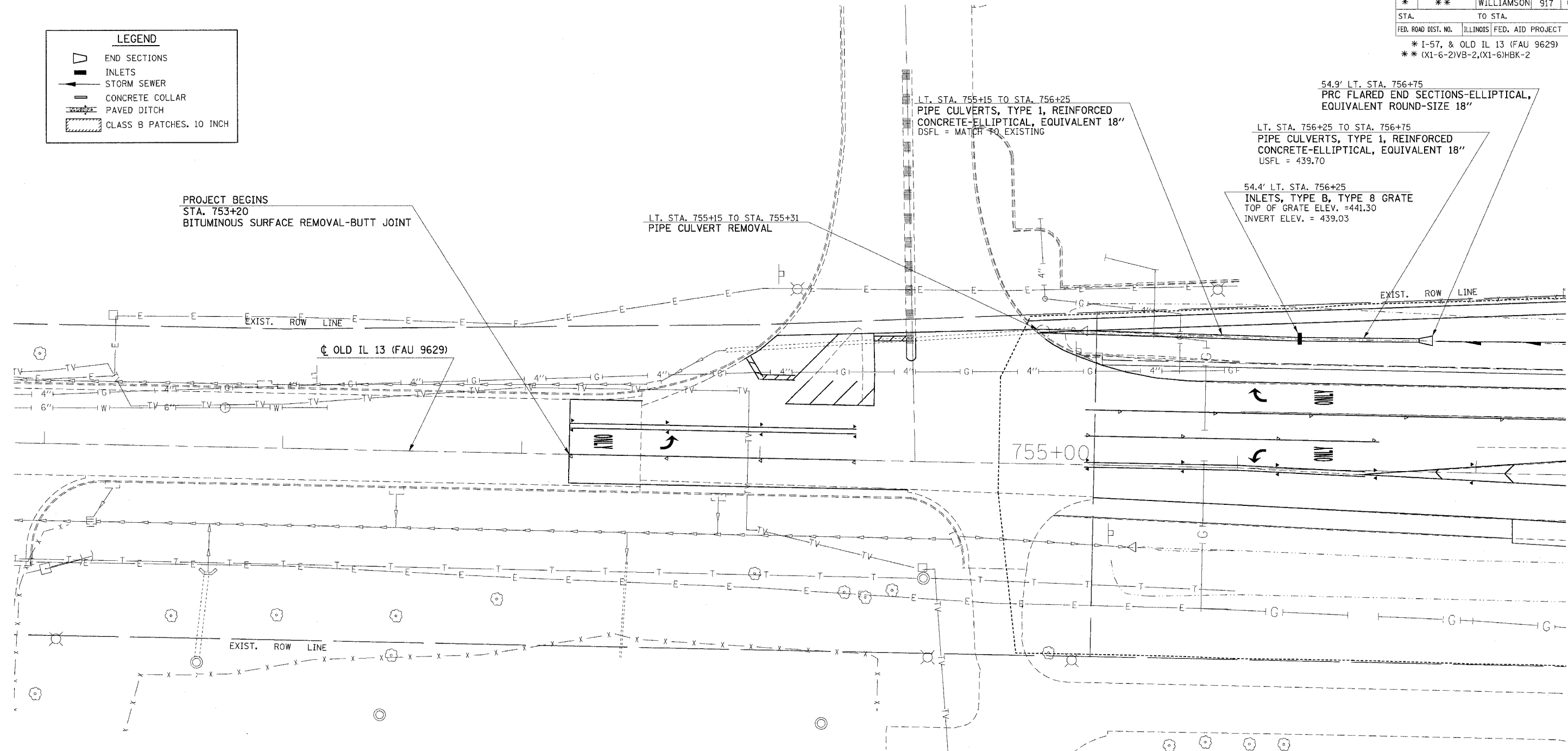

PLOT DATE = 12/6/2005  
FILE NAME = c:\p\proj\as\982802\add13\old13p8.dgn  
PLOT SCALE = 28.0000' / 1" IN.  
USER NAME = hraden

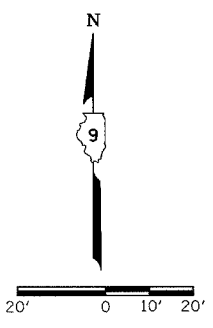

REVISIONS	
NAME	DATE

ILLINOIS DEPARTMENT OF TRANSPORTATION  
**STORM SEWER PLAN SHEET**  
**OLD ILLINOIS 13**  
**STA. 751+00 TO STA. 757+00**

SCALE: VERT. 20'  
HORIZ. 20'

DATE: \_\_\_\_\_

DRAWN BY CNH  
CHECKED BY \_\_\_\_\_