

F.A. RTE.	SECTION	COUNTY	TOTAL SHEETS	SHEET NO.
*	**	WILLIAMSON	917	732

STATIONING ALONG WEST MAIN ST (IL 13)	OFFSET TO E.P. FEET	EDGE OF PAVT. ELEV. FEET	STATIONING ALONG RAMP "EE"	OFFSET TO E.P. FEET	DISTANCE ALONG RADIUS FEET
LT. 770+62.97	36.00	450.70			10
LT. 770+72.97	36.23	450.62			10
LT. 770+82.94	36.91	450.53			10
LT. 770+92.88	38.04	450.42			10
LT. 771+02.75	39.63	450.32			10
LT. 771+12.54	41.66	450.23			10
LT. 771+22.23	44.13	450.12			10
LT. 771+31.80	47.04	450.01			10
LT. 771+41.22	50.39	449.89			10
LT. 771+50.45	54.22	449.76	RT. 19+71.22	61.31	10
		449.61	RT. 19+66.44	52.53	10
		449.45	RT. 19+60.67	44.37	10
		449.28	RT. 19+53.99	36.93	10
		449.10	RT. 19+46.50	30.32	10
		448.93	RT. 19+38.29	24.62	10
		448.85	RT. 19+29.47	19.91	10
		448.86	RT. 19+20.17	16.26	10
		448.93	RT. 19+10.51	13.71	10
		449.00	RT. 19+00.61	12.30	10
					7.18

STATIONING ALONG WEST MAIN ST (IL 13)	OFFSET TO E.P. FEET	EDGE OF PAVT. ELEV. FEET	STATIONING ALONG RAMP "E"	OFFSET TO E.P. FEET	DISTANCE ALONG RADIUS FEET
LT. 773+68.98	33.00	449.06			10
LT. 773+58.79	33.50	449.09			10
LT. 773+48.70	34.98	449.09			10
LT. 773+38.80	37.43	449.07			10
LT. 773+29.18	40.84	449.02			10
LT. 773+19.93	45.16	448.96			10
LT. 773+11.15	50.36	448.88			10
LT. 773+02.92	56.39	448.78			10
LT. 772+95.51	63.20	448.68			10
LT. 772+88.95	70.74	448.63	RT. 0+70.74	30.19	10
		448.64	RT. 0+78.92	24.45	10
		448.71	RT. 0+87.66	19.60	10
		448.79	RT. 0+96.87	15.70	10
		448.88	RT. 1+06.38	12.63	10
		448.99	RT. 1+16.01	9.92	10
		449.12	RT. 1+25.72	7.53	10
		449.25	RT. 1+35.50	5.47	10
		449.38	RT. 1+45.35	3.73	10
		449.49	RT. 1+55.25	2.33	10
		449.62	RT. 1+65.19	1.25	10
		449.72	RT. 1+75.16	0.50	10
		449.82	RT. 1+85.15	0.09	10
					7.38

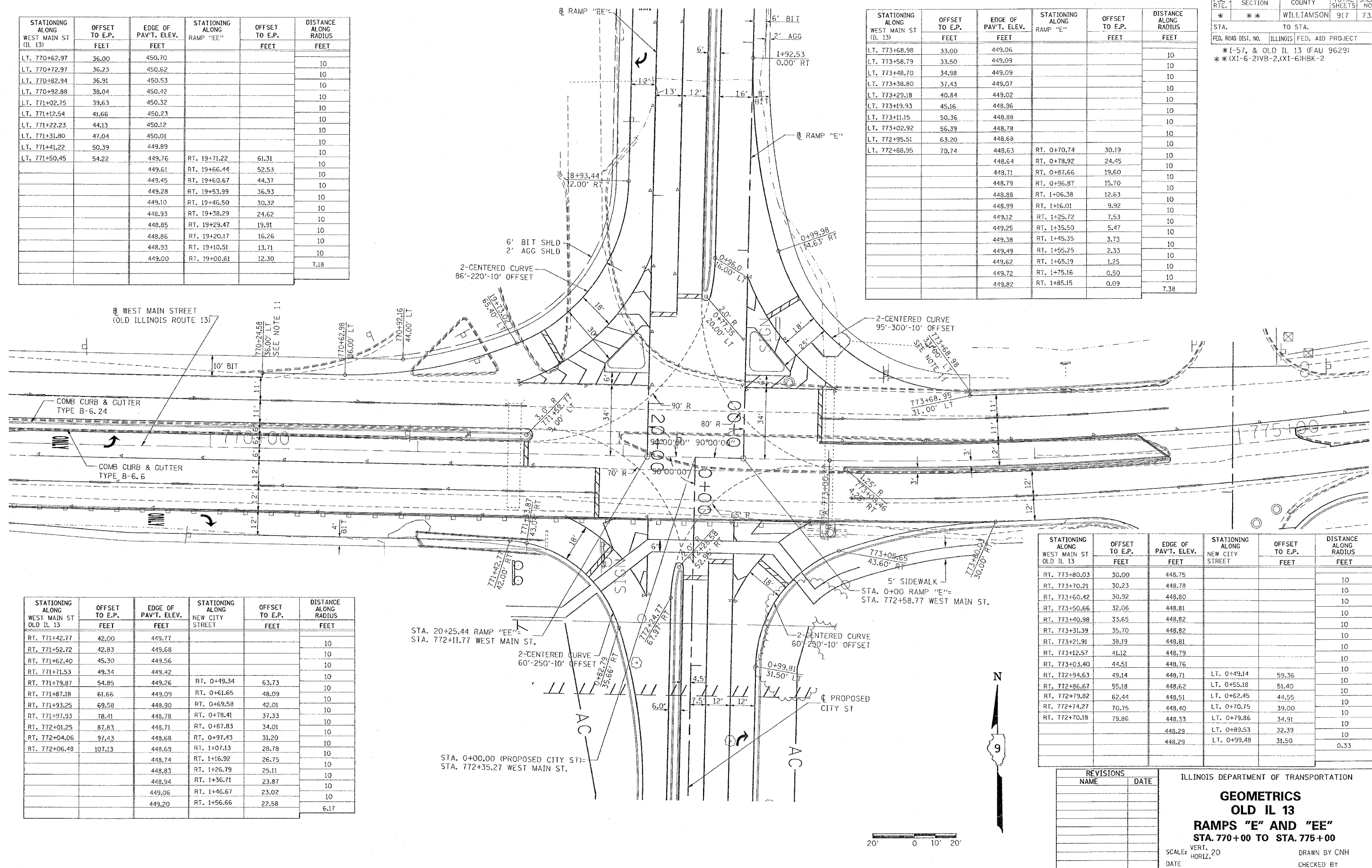

STATIONING ALONG WEST MAIN ST OLD IL 13	OFFSET TO E.P. FEET	EDGE OF PAVT. ELEV. FEET	STATIONING ALONG NEW CITY STREET	OFFSET TO E.P. FEET	DISTANCE ALONG RADIUS FEET
RT. 771+42.77	42.00	449.77			10
RT. 771+52.72	42.83	449.68			10
RT. 771+62.40	45.30	449.56			10
RT. 771+71.53	49.34	449.42			10
RT. 771+79.87	54.85	449.26	RT. 0+49.34	63.73	10
RT. 771+87.18	61.66	449.09	RT. 0+61.65	48.09	10
RT. 771+93.25	69.58	448.90	RT. 0+69.58	42.01	10
RT. 771+97.93	78.41	448.78	RT. 0+78.41	37.33	10
RT. 772+01.25	87.83	448.71	RT. 0+87.83	34.01	10
RT. 772+04.06	97.43	448.68	RT. 0+97.43	31.20	10
RT. 772+06.48	107.13	448.69	RT. 1+07.13	28.78	10
		448.74	RT. 1+16.92	26.75	10
		448.83	RT. 1+26.79	25.11	10
		448.94	RT. 1+36.71	23.87	10
		449.06	RT. 1+46.67	23.02	10
		449.20	RT. 1+56.66	22.58	10
					6.17

STATIONING ALONG WEST MAIN ST OLD IL 13	OFFSET TO E.P. FEET	EDGE OF PAVT. ELEV. FEET	STATIONING ALONG NEW CITY STREET	OFFSET TO E.P. FEET	DISTANCE ALONG RADIUS FEET
RT. 773+80.03	30.00	448.75			10
RT. 773+70.21	30.23	448.78			10
RT. 773+60.42	30.92	448.80			10
RT. 773+50.66	32.06	448.81			10
RT. 773+40.98	33.65	448.82			10
RT. 773+31.39	35.70	448.82			10
RT. 773+21.91	38.19	448.81			10
RT. 773+12.57	41.12	448.79			10
RT. 773+03.40	44.51	448.76			10
RT. 772+94.63	49.14	448.71	LT. 0+49.14	59.36	10
RT. 772+86.67	55.18	448.62	LT. 0+55.18	51.40	10
RT. 772+79.82	62.44	448.51	LT. 0+62.45	44.55	10
RT. 772+74.27	70.75	448.40	LT. 0+70.75	39.00	10
RT. 772+70.18	79.86	448.33	LT. 0+79.86	34.91	10
		448.29	LT. 0+89.53	32.39	10
		448.29	LT. 0+99.48	31.50	10
					0.33

REVISIONS	
NAME	DATE

ILLINOIS DEPARTMENT OF TRANSPORTATION
GEOMETRICS
OLD IL 13
RAMPS "E" AND "EE"
STA. 770+00 TO STA. 775+00
 SCALE: VERT. 20
 DATE: _____ DRAWN BY CNH
 CHECKED BY _____

PLOT DATE = 10/17/2008
 USER NAME = hudson