

**GENERAL NOTES:**

THIS SECTION SHALL BE CONSTRUCTED IN ACCORDANCE WITH THE PLANS, SPECIAL PROVISIONS AND "STANDARD SPECIFICATIONS FOR ROAD AND BRIDGE CONSTRUCTION", ADOPTED JANUARY 1, 2007.

THE WORK INVOLVED ON THIS SECTION CONSISTS OF EARTHWORK, TREE REMOVAL, THE REMOVAL OF THE EXISTING STRUCTURE, THE CONSTRUCTION OF A 302' FOOT LONG TRIPLE SPAN CONTINUOUS WELDED PLATE GIRDER BRIDGE, AGGREGATE SURFACE COURSE AND OTHER MISCELLANEOUS ITEMS NECESSARY TO COMPLETE THIS SECTION.

ALL ELEVATIONS ARE BASED ON U.S.G.S. MEAN SEA LEVEL DATUM.

IT SHALL BE THE CONTRACTOR'S RESPONSIBILITY TO CONTACT ALL THE UTILITIES, AFFECTING THE PROJECT, PRIOR TO CONSTRUCTION.

TWO (2) EACH CURLED END SECTIONS REQUIRED ON THE NW AND SE CORNERS. ITEM TO BE INCIDENTAL TO THE STEEL RAILING.

**TYPICAL CROSS SECTION PROPOSED**

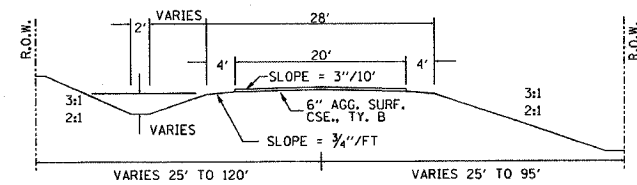

**TYPICAL CROSS SECTION EXISTING**

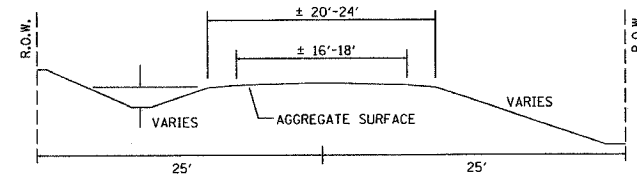

**FIELD ENTRANCE DETAIL**

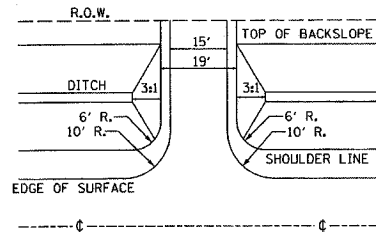

**UTILITIES:**  
J.U.L.I.E. 1-800-892-0123

VERIZON  
225 E. CHESTNUT  
OLNEY, IL 62450  
618-395-6181

WAYNE-WHITE ELECTRIC CO-OP  
ROUTE 45 WEST  
FAIRFIELD, IL 62837  
618-842-1296

NOTE: CONSTRUCT SPECIAL DITCH

STA 1+50 TO STA 7+50 LT  
STA 1+50 TO STA 7+75 RT  
STA 10+74 TO STA 18+35 LT  
STA 10+71 TO STA 18+35 RT

NOTE: CONSTRUCT STONE RIPRAP DITCH

STA 10+70 TO STA 11+00 LT & RT (0.48 TON/LIN FT)  
30 TON STONE RIPRAP DITCH ALLOWED IN PROPOSAL.

SEE SHEET NO. 7 FOR STONE RIPRAP DITCH DETAIL.

NOTE: TRAFFIC BARRIER TERMINAL 5A

STA 7+81.32 TO STA 7+94.57 RT  
STA 10+85.66 TO STA 10+98.91 LT

NOTE: STEEL PLATE BEAM GUARDRAIL TYPE B

STA 7+31.32 TO STA 7+81.32 RT  
STA 10+98.91 TO STA 11+48.91 LT

NOTE: TRAFFIC BARRIER TERMINAL TYPE 1

STA 7+06.32 TO STA 7+31.32 RT  
STA 11+48.91 TO STA 11+73.91 LT

NOTE: CONSTRUCT TRANSITIONS:  
STA 1+50 TO STA 2+00  
STA 18+00 TO STA 18+35  
ALL QUANTITIES ARE INCLUDED IN THE PROPOSAL.

EXISTING STRUCTURE-STA 9+50; STRUCTURE NUMBER: 097-3030  
A SINGLE SPAN THRU TRUSS BRIDGE WITH TWO PONY TRUSS APPROACH SPANS. CONCRETE DECK ON CONCRETE PIERS AND CLOSED CONCRETE ABUTMENTS. ±248' BK-BK ABUTMENTS. ±16' WIDE.

PROPOSED STRUCTURE: STA 9+40  
STRUCTURE NO. 097-3186.  
A CONTINUOUS WELDED PLATE GIRDER BRIDGE. TRIPLE SPAN- 92'-0", 118'-0", 92'-0". 24' ROADWAY, 27° SKEW RT. FORWARD.

SEE SHEETS 9-22 FOR THE DESIGN AND BILL OF MATERIALS.

21.0 EACH FURNISHING & ERECTING ROW MARKERS  
1.2 ACRES TREE REMOVAL  
196 UNITS-TREE REMOVAL (6 TO 15 UNITS DIAMETER)  
48 UNITS-TREE REMOVAL (OVER 15 UNITS DIAMETER)  
1.90 ACRES SEEDING, CLASS 2 SPECIAL REQUIRED

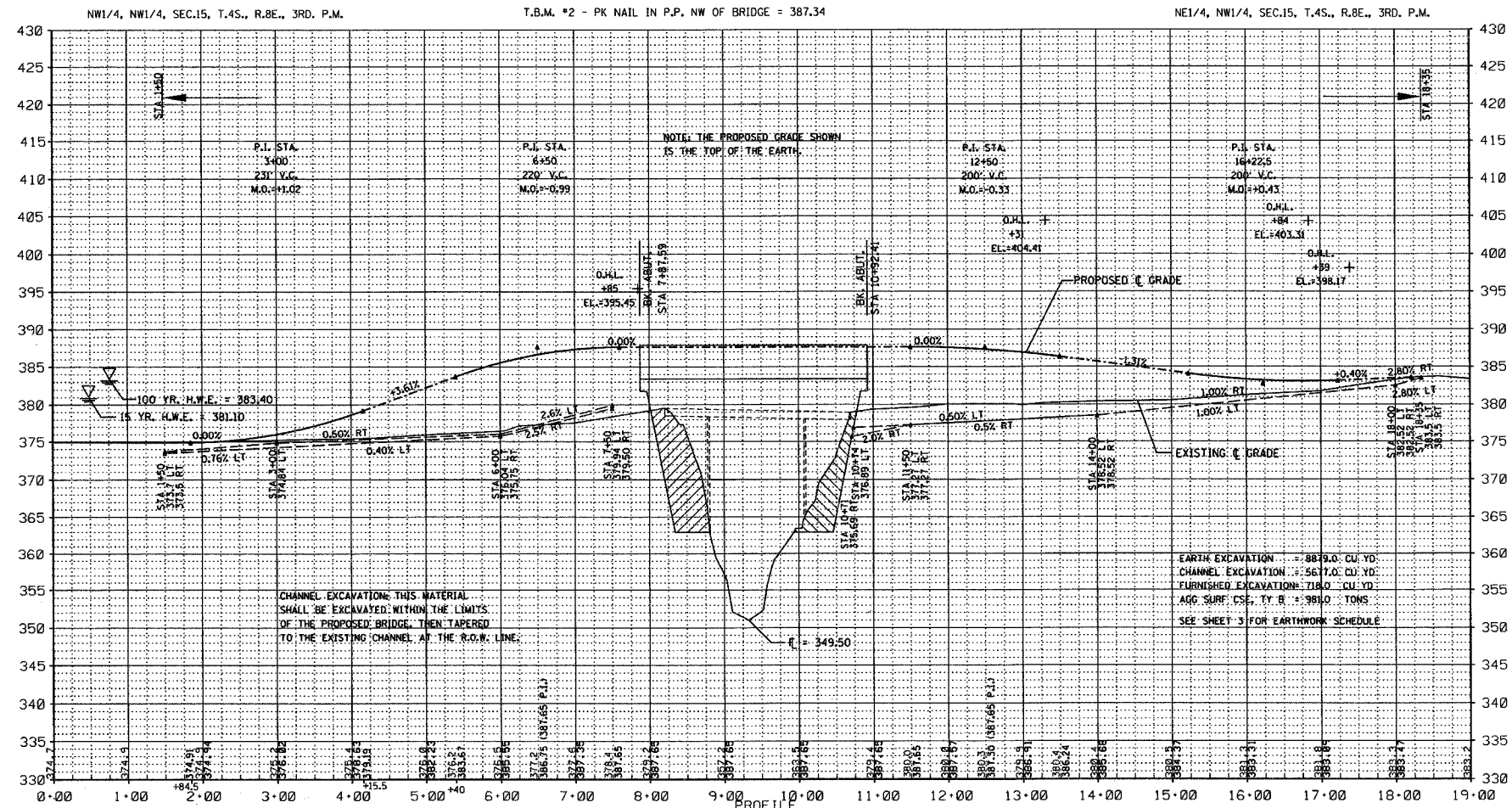

CHANNEL EXCAVATION: THIS MATERIAL SHALL BE EXCAVATED WITHIN THE LIMITS OF THE PROPOSED BRIDGE, THEN TAPERED TO THE EXISTING CHANNEL AT THE R.O.W. LINE.

EARTH EXCAVATION = 8819.0 CU. YD  
CHANNEL EXCAVATION = 5617.0 CU. YD  
FURNISHED EXCAVATION = 718.0 CU. YD  
AGG SURF. CSE., TY. B = 981.0 TONS  
SEE SHEET 3 FOR EARTHWORK SCHEDULE

F.A.S. SECTION	COUNTY	TOTAL SHEETS	SHEET NO.
882 84-00059-00-BR	WHITE	22	2
FED. ROAD DIST. NO. 9 ILLINOIS	FED. AID PROJECT		
PROJECT# BR5-882(108)	CONTRACT# 99268		
JOB # C-99-593-06	SKILLET FORK		
LEC JOB # H041005WH			
323 W. 3RD ST. P.O. BOX 160 MT. CARMEL, IL 62863			
PHONE: (618)-262-8651 FAX: (618)-263-3327			
405 W. STATE ST SUITE 1 PRINCETON, IN 47670			
PHONE: (812)-386-7611 FAX: (812)-385-2812			
<b>LAMAC ENGINEERING CO.</b>			
PROFESSIONAL DESIGN FIRM LAND SURVEY & PROFESSIONAL ENGINEERING CORPORATION			
184-000887 (62-032435)(35-002769)			
AARON M. MEFFORD REGISTERED PROFESSIONAL ENGINEER OF ILLINOIS			
NAME: Aaron M. Mefford			
SIGNATURE: <i>[Signature]</i>			
DATE: 2-12-07			
11-30-07 EXPIRES			
SHEET TITLE: PLAN & PROFILE			
SCALE: VARIES			
BY: AMM			
DATE: 12307			
REV:			
2 OF 22 SHEETS			
SHEET NO. 2			

F.A.S. ROUTE 882  
SKILLET FORK  
WHITE COUNTY, ILLINOIS