

REF: DWG: b:dwg  
 b:tbl.dwg  
 b:base.dwg  
 b:GOV/F01.dwg  
 b:base\_add.dwg

IMAGE FILES: Lansing.airfield2007.tif







UPDATE BY: Jason Dove  
 LAYOUT: 03\_sitecontrol

DATE: Thursday, March 08, 2007 8:45:09 PM  
 FILE: K:\Lansing\022702\Draw 9-21\Elect\Draw\Sheets\03\_sitecontrol.dwg

**HORIZONTAL/VERTICAL CONTROL**

NO.	STATION/OFFSET	ELEVATION	NORTHING	EASTING	DESCRIPTION
1	311+98.00 @ TAXIWAY G2	-	1775650.38	719616.74	INTERSECTION CENTERLINE TAXIWAY G2 AND CENTERLINE TAXIWAY G3
2	314+48.10 @ TAXIWAY G2	-	1775900.49	719615.05	INTERSECTION CENTERLINE TAXIWAY G2 AND CENTERLINE RUNWAY 9/27
3	316+98.10 @ TAXIWAY G2	-	1776150.48	719613.35	INTERSECTION CENTERLINE TAXIWAY G2 AND CENTERLINE TAXIWAY A
4	318+54.10 @ TAXIWAY G2	-	1776306.46	719612.18	INTERSECTION CENTERLINE TAXIWAY G2 AND APRON BASELINE
5	321+26.10 @ TAXIWAY G2	-	1776578.44	719610.29	INTERSECTION CENTERLINE TAXIWAY G2 AND ENTRANCE ROAD BASELINE
6	318+54.10, 300' RT, @ TAXIWAY G2	-	1776308.55	719912.17	EDGE OF APRON
7	502+28.16, @ ENTRANCE RD.	-	1776580.67	719938.45	ENTRANCE ROAD BASELINE
8	503+44.19, @ ENTRANCE RD.	-	1776696.69	719937.64	INTERSECTION ENTRANCE ROAD BASELINE AND BORROW SITE BASELINE
9	504+14.16, @ ENTRANCE RD.	-	1776766.66	719937.16	ENTRANCE ROAD BASELINE
10	507+66.32, @ ENTRANCE RD.	-	1776995.73	720057.13	INTERSECTION ENTRANCE ROAD BASELINE AND CENTERLINE GLENWOOD-LANSING ROAD
11	505+38.08, @ ENTRANCE RD.	-	1776767.53	720061.07	ENTRANCE ROAD BASELINE
12	18+50, @ BORROW SITE	-	1776703.13	720882.47	END OF BORROW SITE BASELINE
13	507+72.06, 99.53' LT, @ ENTRANCE RD.	-	1776999.75	719957.51	PK NAIL ON GLENWOOD-LANSING ROAD MEDIAN
14	325+30.13, 498.64' LT, @ TAXIWAY G2	-	1776979.01	719108.85	PK NAIL ON GLENWOOD-LANSING ROAD MEDIAN
BM1	3+10.61, 215.31' RT, @ RUNWAY 9/27	613.53	1775672.09	717734.60	AZ MARKER "LANSPO" (ROD IN CAN) (#202)
BM2	23+37.02, 209.83' RT, @ RUNWAY 9/27	613.56	1775691.67	719760.92	MARKER "LANSPO 1990" (ROD IN CAN) (#201)
BM3	37+49.70, 195.54' RT, @ RUNWAY 9/27	613.69	1775715.79	721173.47	GPS IGOA MONUMENT (#205)
BM4	146+22.30, 582.00' RT, @ RUNWAY 18/36	614.13	1775185.59	721169.44	CHISELED "X" ON CONCRETE BOX CULVERT

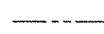
**LEGEND**

-  EXISTING BUILDING
-  EXISTING PAVEMENT
-  PROPOSED WORK AREA
-  PROPOSED BORROW SITE
-  BENCHMARK/CONTROL POINT
-  AIRPORT PROPERTY LINE
-  FUTURE/PROPOSED HANGAR (BY OTHERS)

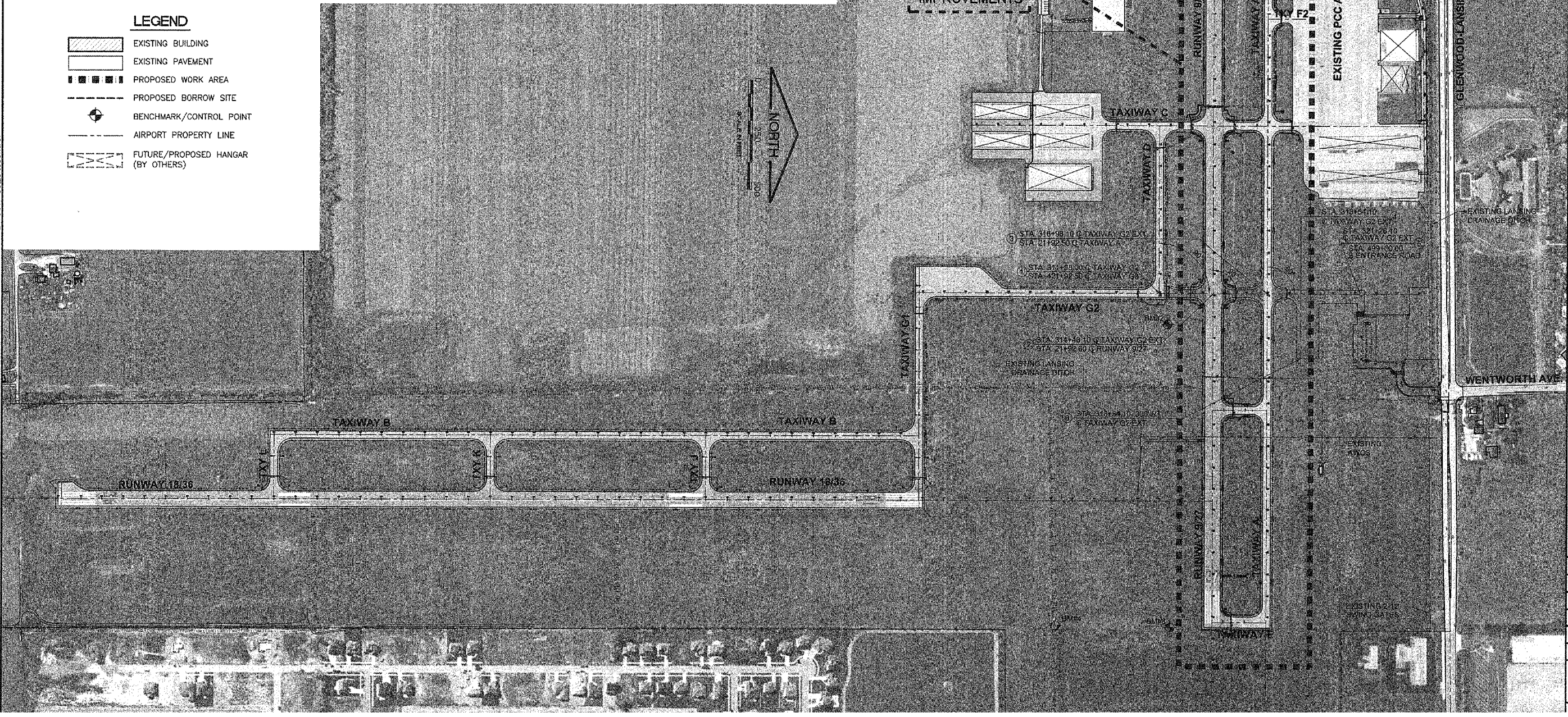

IL. CONTRACT: **LA036**  
 IL. LETTING ITEM: **2A**  
 IL. PROJECT: **IGQ-3565**  
 A.I.P. PROJECT: **3-17-0121-B25**

SURVEY BOOK # BOOK #

REVISIONS		
NUMBER	BY	DATE

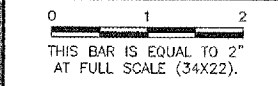

**VILLAGE OF LANSING  
 LANSING MUNICIPAL AIRPORT  
 LANSING, ILLINOIS**  
  
**REHABILITATE AIRFIELD LIGHTING SYSTEM  
 SITE PLAN**  
  
**HORIZONTAL AND VERTICAL CONTROL PLAN  
 LANSING MUNICIPAL AIRPORT**

© Copyright CMT, Inc.  
**CMT**  
 CRAWFORD, MURPHY & TILLY, INC.  
 CONSULTING ENGINEERS  
 License No. 154-009615



DESIGN BY: LAO  
 DRAWN BY: JWD  
 CHECKED BY: DKP  
 APPROVED BY: \_\_\_\_\_  
 DATE: 02 MARCH 2007  
 JOB No: 06297-02

**G-03**  
 SHEET 03 OF 21 SHEETS