

bmp 2101000-001  
 bmp 2101000-002  
 bmp 2101000-003  
 bmp 2101000-004  
 bmp 2101000-005

UPDATE BY: Jason Dove  
 LAYOUT: Layout1

DATE: Thursday, March 08, 2007 9:00:52 PM  
 FILE: K:\Lansing\0629702\_Rehab\_9-27\_Elect\Draw\Sheets\10\_sheets-3.dwg

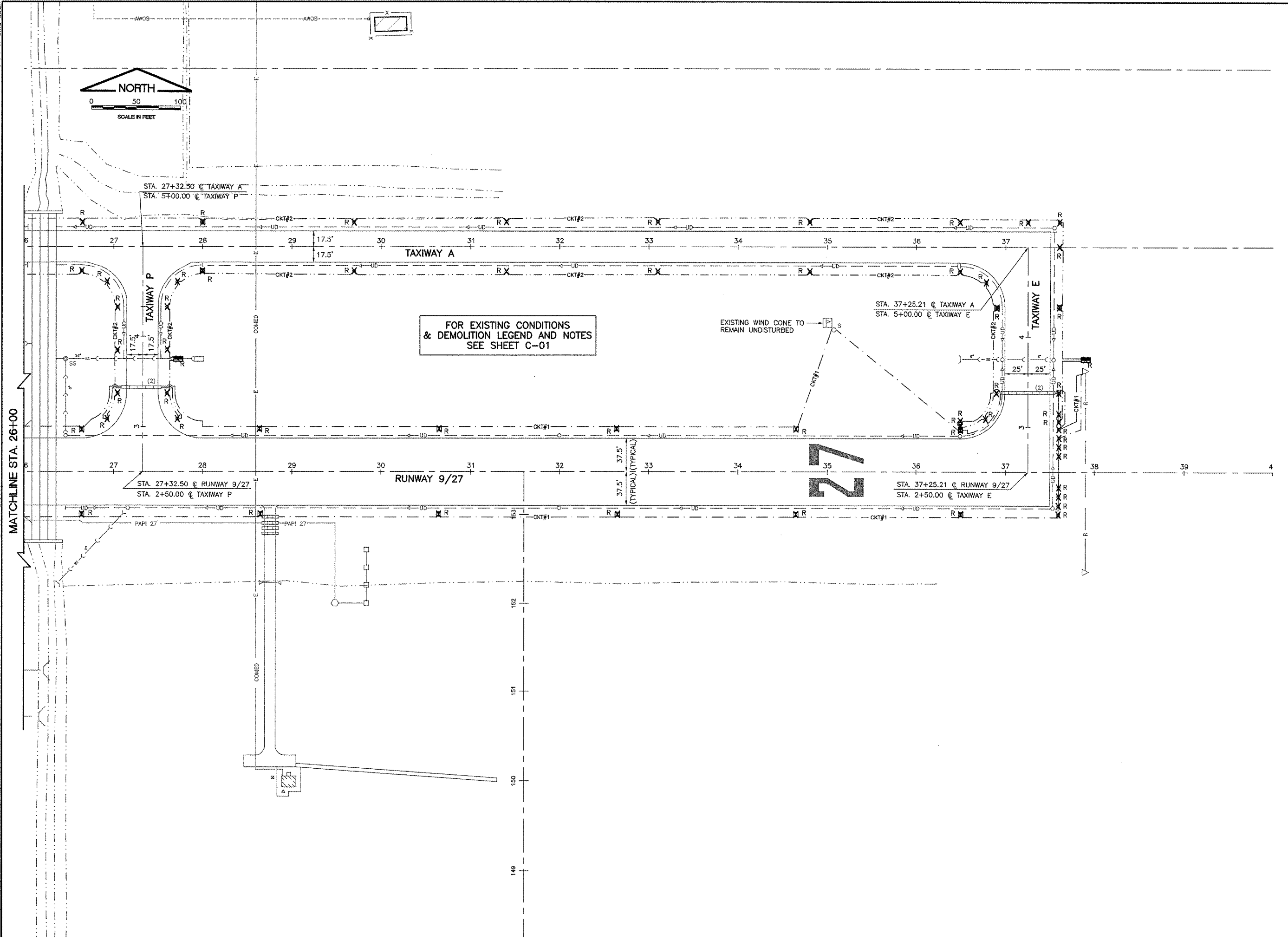

IL. CONTRACT: LA036  
 IL. LETTING ITEM: 2A  
 IL. PROJECT: IGQ-3565  
 A.I.P. PROJECT: 3-17-0121-B25

SURVEY BOOK # BOOK #

REVISIONS		
NUMBER	BY	DATE

0 1 2  
 THIS BAR IS EQUAL TO 2" AT FULL SCALE (34X22).

VILLAGE OF LANSING  
 LANSING MUNICIPAL AIRPORT  
 LANSING, ILLINOIS

REHABILITATE AIRFIELD LIGHTING SYSTEM  
 EXISTING CONDITIONS & DEMOLITION  
 RUNWAY 9/27  
 STA. 26+00 TO STA. 40+00

© Copyright GMT, Inc.  
**GMT**  
 CRAWFORD, MURPHY & TILLY, INC.  
 CONSULTING ENGINEERS  
 License No. 184-006518



DESIGN BY: JWD  
 DRAWN BY: JRO  
 CHECKED BY: DKP  
 APPROVED BY: ---  
 DATE: 02 MARCH 2007  
 JOB No: 06297-02

**C-03**  
 SHEET 10 OF 21 SHEETS