

REF: DWG: tbcnt.dwg
 lb.dwg
 len-base.dwg
 len-base-addtbl2.dwg

UPDATE BY: Jason Dove
 LAYOUT: Layout1

DATE: Thursday, March 08, 2007 9:00:56 PM
 FILE: K:\Lansing\062907\Rehab 9-27\Elec\Draw\Sheets\11_mark01.dwg

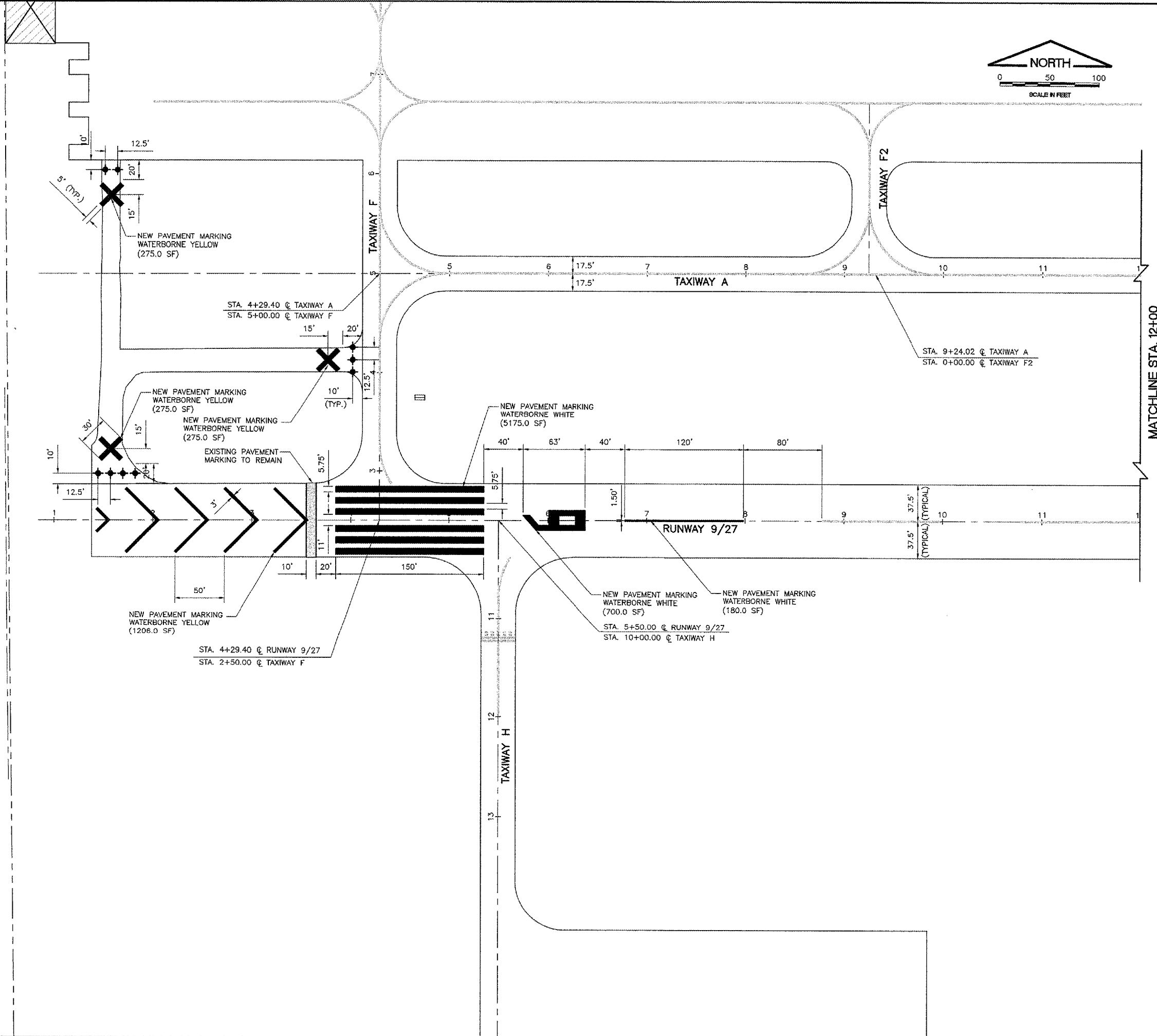

IL. CONTRACT: LA036
 IL. LETTING ITEM: 2A
 IL. PROJECT: IGQ-3565
 A.I.P. PROJECT: 3-17-0121-B25

SURVEY BOOK # BOOK #

REVISIONS		
NUMBER	BY	DATE

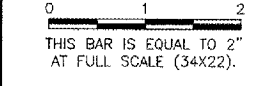

VILLAGE OF LANSING
LANSING MUNICIPAL AIRPORT
LANSING, ILLINOIS

REHABILITATE AIRFIELD LIGHTING SYSTEM
PAVEMENT MARKINGS
RUNWAY 9/27
STA. 1+00 TO STA. 12+00

© Copyright GMT, Inc.

GMT
 CRAWFORD, MURPHY & TILLY, INC.
 CONSULTING ENGINEERS
 License No. 184-000618

 Lansing Municipal
airport

DESIGN BY:	JWD
DRAWN BY:	JWD
CHECKED BY:	DKP
APPROVED BY:	----
DATE:	02 MARCH 2007
JOB No:	06297-02