

EXISTING US 20
 STA 55+00 TO STA 70+00 (WB)
 STA 56+50 TO STA 70+00 (EB)

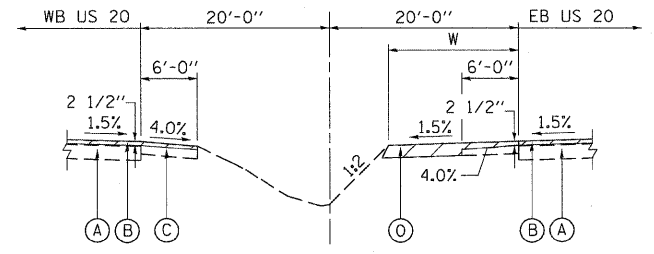

DETAIL A
 STA 55+00 TO STA 70+00 (WB)
 STA 56+50 TO STA 70+00 (EB)
 W=6' STA 59+35 TO STA 60+00
 W=20' STA 60+00 TO STA 61+00

- NOTES:**
1. THE TEMPORARY CONCRETE BARRIER IS SECURED TO THE PAVEMENT USING SIX ANCHORING PINS.
 2. EXISTING DIMENSIONS SHOWN ARE FROM RECORD PLANS. ACTUAL DIMENSIONS MAY VARY.
 3. SEE GENERAL NOTES SHEET 3 FOR TEMPORARY PAVEMENT INFORMATION.
 4. THE EXISTING PAVEMENT SLABS ARE REINFORCED WITH WIRE MESH.
 5. EXISTING THICKNESSES SHOWN ARE FROM RECORD PLANS AND PAVEMENT CORES. ACTUAL THICKNESSES MAY VARY.

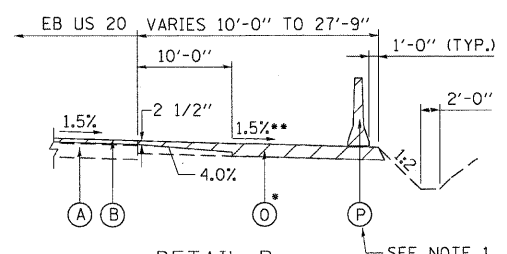

DETAIL B
 STA 56+50 TO STA 66+00

- EB US 20 OUTSIDE SHOULDER WIDENING BEGINS AT STA 64+37
- CROSS SLOPE TRANSITIONS FROM 4.0% TO 1.5% FROM STA 64+37 TO STA 65+00

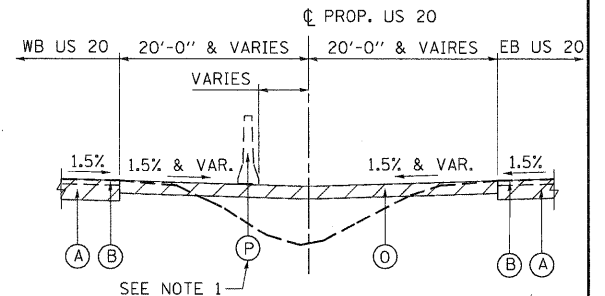

DETAIL C
 STA 78+50 TO STA 84+50

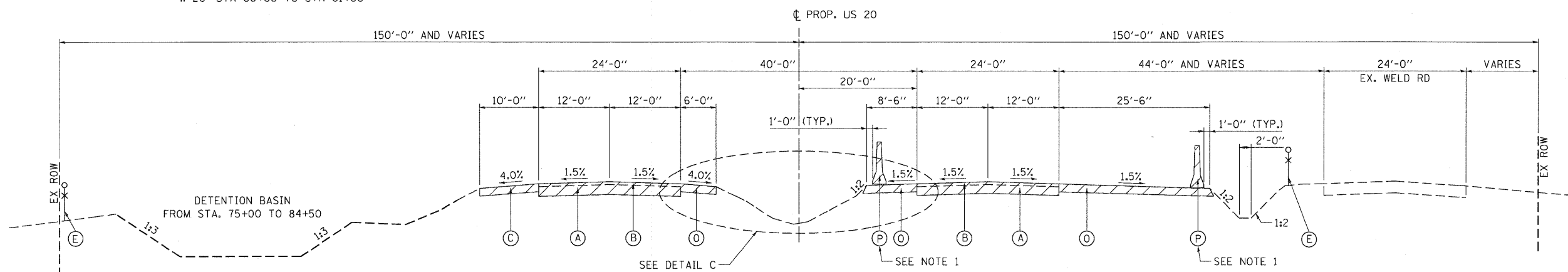

EXISTING US 20
 STA 70+00 TO STA 89+00

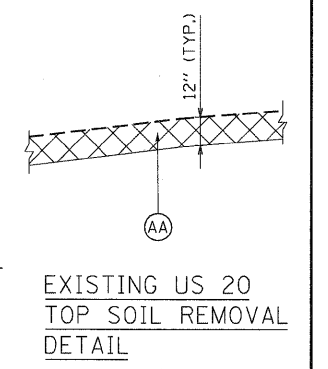

EXISTING US 20 TOP SOIL REMOVAL DETAIL
 SEE US 20 CROSS SECTIONS FOR TOPSOIL REMOVAL LIMITS

EXISTING LEGEND

- | | | |
|------------------------------------|---|-----------------------------------|
| (A) PCC PAVEMENT (10" AND VARIES) | (K) PCC SIDE WALK | (U) PCC PAVEMENT |
| (B) HMA SURFACE (3" AND VARIES) | (L) CURB AND GUTTER | (V) PCC PAVEMENT (11" AND VARIES) |
| (C) HMA SHOULDER (8" AND VARIES) | (M) CONCRETE MEDIAN | (W) HMA SURFACE (4" AND VARIES) |
| (D) HMA SHOULDER (6" AND VARIES) | (N) STEEL PLATE BEAM GUARDRAIL | (X) HMA SURFACE (5" AND VARIES) |
| (E) FENCE | (O) TEMP PAVEMENT (SEE NOTE 3) | (Y) HMA SURFACE (6" AND VARIES) |
| (F) CONCRETE MEDIAN BARRIER & BASE | (P) TEMPORARY CONCRETE BARRIER | (Z) CONC CURB TB |
| (G) PCC SHOULDER (10" AND VARIES) | (R) RETAINING WALL (CAST-IN-PLACE) | (AA) REMOVAL AND DISPOSAL |
| (H) TOPSOIL REMOVAL (X") | (S) TEMP. SOIL RETENTION SYSTEM | OF UNSUITABLE MATERIAL |
| (I) HMA BASE COURSE | (T) SUBBASE GRANULAR MATERIAL, TYPE C (10") | |
| (J) HMA PAVEMENT | | |

PROPOSED LEGEND

- | | |
|---|--|
| (1) CONTINUOUSLY REINFORCED CONCRETE PAVEMENT 10 3/4" | (11) COMB CC&G TB6.24 |
| (2) PCC PVT 10 JOINTED | (12) COMB CC&G TM4.24 |
| (3) STABILIZED SUBBASE (HMA) 4 1/2" | (13) CONC CURB TB SPL |
| (4) AGGREGATE SUBGRADE 12" | (14) PC CONC SIDEWALK 5 |
| (5) HOT-MIX ASPHALT SURFACE COURSE, MIX "D", N70, 2" | (15) SPBGR TY A 6FT POSTS |
| (6) SUB-BASE GRANULAR MATERIAL, TYPE B 12" | (16) EMBANKMENT |
| (7) CONCRETE BARRIER, DOUBLE FACE, 32" HEIGHT | (17) RETAINING WALL (SEE STRUCTURAL PLANS) |
| (8) CONCRETE BARRIER BASE | (18) DRILL AND GROUT #6 TIE BARS |
| (9) AGG WEDGE SHLD TYPE B | (19) TOPSOIL FURNISH AND PLACE, 6" |
| | (20) TOPSOIL FURNISH AND PLACE, 10" |

EXISTING TYPICAL SECTIONS

- | | |
|---|---|
| (21) HOT-MIX ASPHALT SURFACE COURSE, MIX "D", N70, 1 3/4" | (33) AGGREGATE SHOULDERS, TYPE B 4" |
| (22) HOT-MIX ASPHALT BASE COURSE, 8" | (34) SEEDING (SEE LANDSCAPING PLANS) |
| (23) SHOULDER RUMBLE STRIPS, 16" | (35) PCC SHOULDERS 10 3/4" |
| (24) AGGREGATE SURFACE COURSE, TYPE B, 4" | (36) PCC SHOULDERS 10" |
| (25) CONCRETE MEDIAN SURFACE, 4 INCH | (37) AGGREGATE SHOULDERS, TYPE B 10" |
| (26) CONCRETE MEDIAN, TYPE SB (SPECIAL) | (38) CONCRETE BARRIER, SINGLE FACE 42" HEIGHT (SPECIAL) |
| (27) POLY. HMA SURFACE COURSE, MIX "F", N90 1 3/4" | (39) CORRUGATED MEDIAN |
| (28) CHAIN LINK FENCE, 4' | (40) HOT-MIX ASPHALT BASE COURSE, 7" |
| (29) POLY. LEVELING BINDER (MM), IL-4.75, N50 3/4" (MIN) | (41) SODDING, SALT TOLERANT |
| (30) HOT-MIX ASPHALT SURFACE COURSE, MIX "D", N70, 3" | |
| (31) POLY. HMA SURFACE COURSE, MIX "F", N90 2" | |
| (32) COMB CC&G TB6.06 | |

\N160H45-XSCT1.DGN, \N160H45-BORDER.DGN, \N160H45-LEGEN.DGN, \N160H45-PLAN.DGN, \N160H45-TYPICAL.DGN
 12-12-2011 12:39:41
 BA-ZEKUJ \NF5-2044\AVVAULT_D-TRANS_07\2202-2379-001\CIVIL\CAD\60H45\SHEET\N160H45-SHT-TYPICAL.DGN

FILE NAME =	USER NAME = #USER#	DESIGNED - MRK	REVISED -	STATE OF ILLINOIS DEPARTMENT OF TRANSPORTATION FAP ROUTE 345 / US ROUTE 20	EXISTING TYPICAL SECTIONS U.S. ROUTE 20	F.A.P. RTE.	SECTION	COUNTY	TOTAL SHEETS	SHEET NO.	
#FILE#		DRAWN - MRK	REVISED -			345	8R-R	KANE	794	21	
PLOT SCALE = #SCALE#		CHECKED - DDH	REVISED -			SCALE: 1"=10' SHEET NO. OF STA. 56+50.00 TO STA. 89+00.00					
PLOT DATE = #DATE#		DATE - 12/16/11	REVISED -			CONTRACT NO. 60H45					