

PLAN	SURVEYED	BY	DATE
	PLOTTED		
	NOTE BOOK		
	NO.		
	CADD FILE NAME		

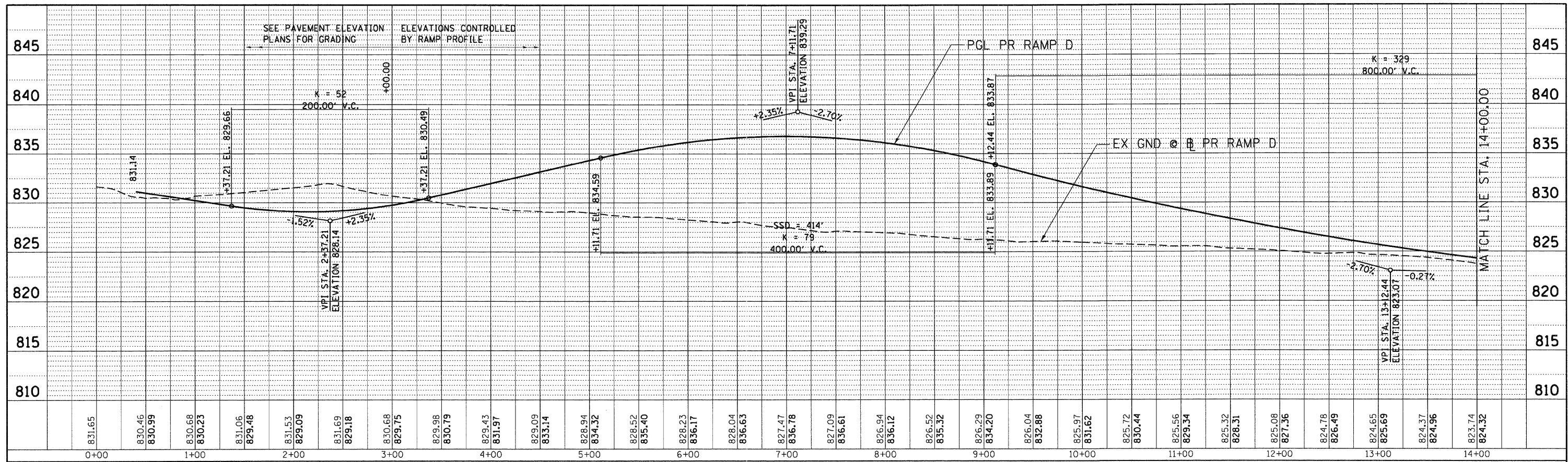

PROFILE	SURVEYED	BY	DATE
	PLOTTED		
	NOTE BOOK		
	NO.		
	STRUCTURE NOTATIONS CHKD		

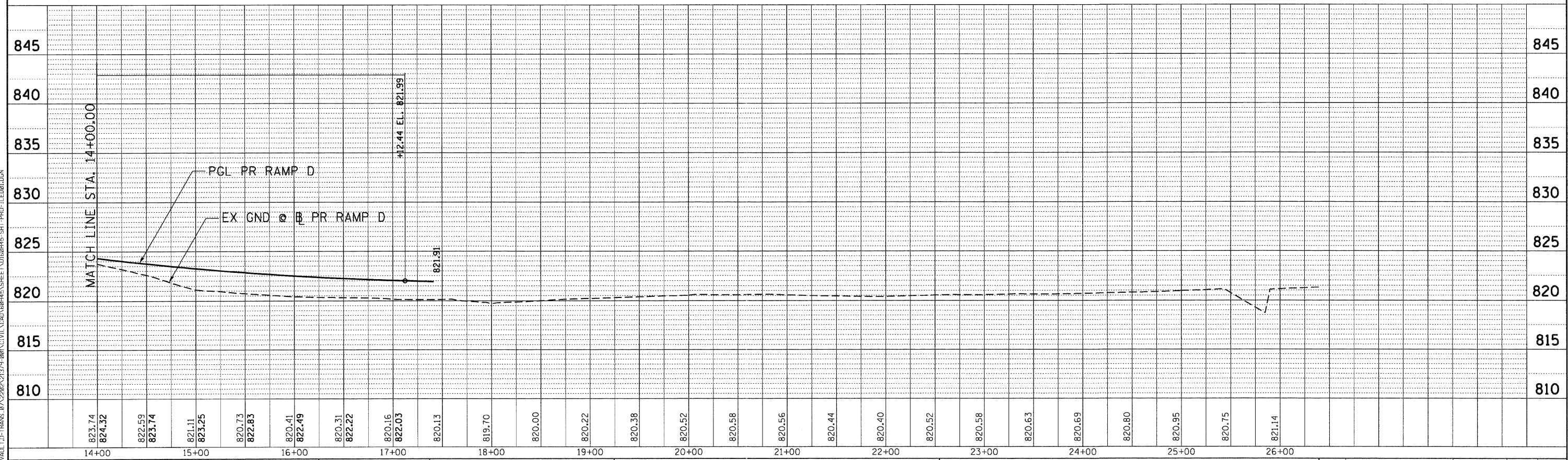

12-12-2011 12:42:23 8A7E5KJ
 \\FS-024\AVALI_T-D\TRANS_07A2202\21379-00\CIVIL\ROAD\WB\45\SHEET\01\WB-RAMP-D\WB-RAMP-D.DGN

FILE NAME =	USER NAME = *USER#	DESIGNED - MRK	REVISED -
*FILEL#		DRAWN - MRK	REVISED -
	PLOT SCALE = *SCALE#	CHECKED - DDH	REVISED -
	PLOT DATE = *DATE#	DATE - 12/16/11	REVISED -

STATE OF ILLINOIS
DEPARTMENT OF TRANSPORTATION
 FAP ROUTE 345 / US ROUTE 20

ROADWAY PROFILE
U.S. ROUTE 20
WB ENTRANCE RAMP D

SCALE: HORIZ. 1"=50' VERT. 1"=5'
 STA. 0+00.00 TO STA. 26+41.18

F.A.P. RTE.	SECTION	COUNTY	TOTAL SHEETS	SHEET NO.
345	8R-R	KANE	794	75
CONTRACT NO. 60H45				
FED. ROAD DIST. NO. ILLINOIS FED. AID PROJECT				