

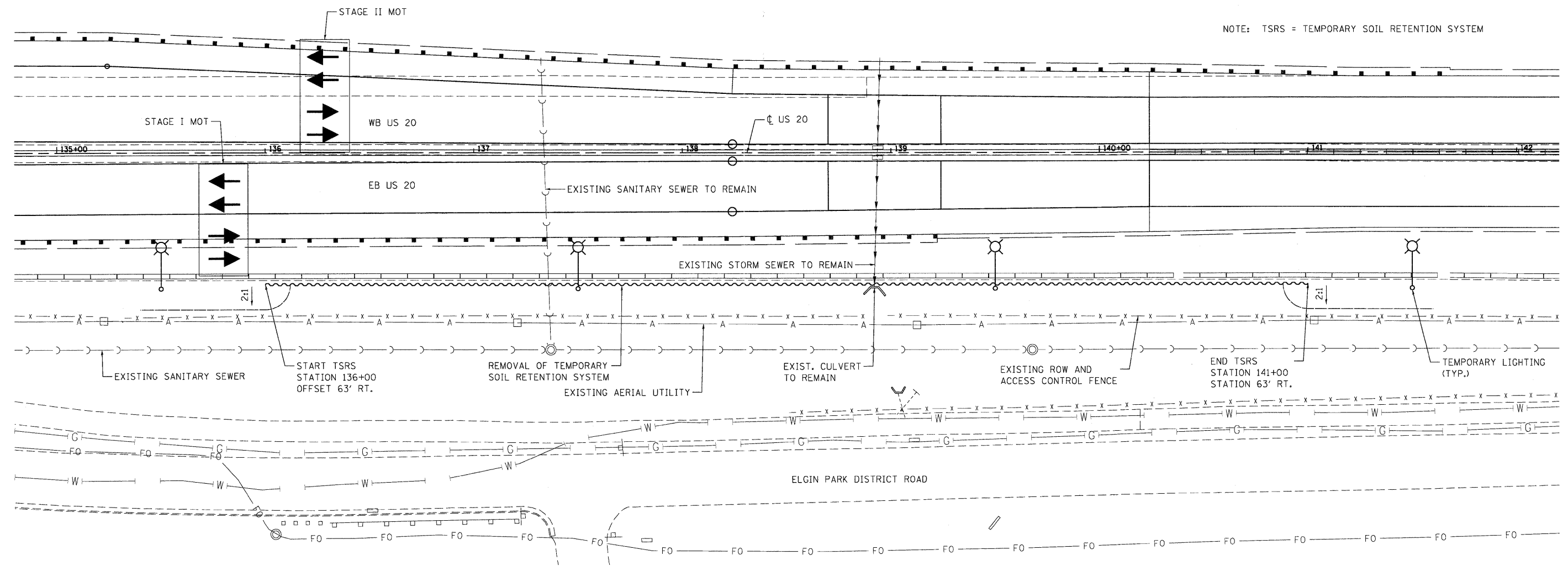

NOTE: TSRS = TEMPORARY SOIL RETENTION SYSTEM

PLAN	SURVEYED	DATE
	PLOTTED	
	CHECKED	
	BY	
	NO.	
	FILE NAME	

PROFILE	SURVEYED	DATE
	PLOTTED	
	CHECKED	
	BY	
	NO.	
	FILE NAME	



PLAN

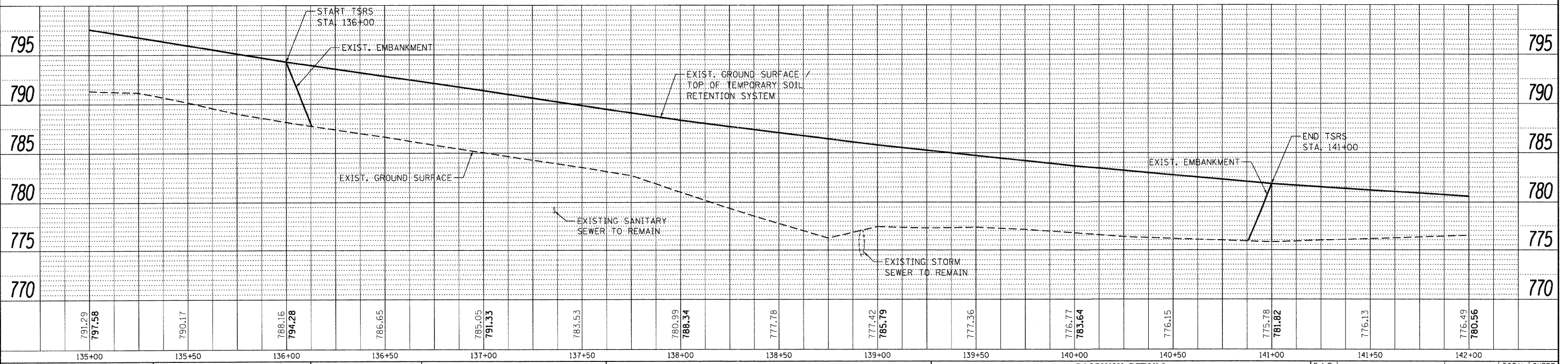

12-15-2011 12:46:10 BAI.ZEKI
N:\15-6044\MAIN\1.D-TRANS.BY 2282\21379-001\STRUCTURE\TEMP\60445-001-RET WALL SHL.DGN

FILE NAME =
#FILEL#

USER NAME = #USER#

DESIGNED - MDB
DRAWN - MDB
CHECKED - VCP
DATE - 12/16/11

REVISD -
REVISED -
REVISED -
REVISED -

PLOT SCALE = #SCALE#

PLOT DATE = #DATE#

STATE OF ILLINOIS
DEPARTMENT OF TRANSPORTATION
FAP ROUTE 345 / US ROUTE 20

ROADWAY DETAILS
REMOVAL OF TEMPORARY SOIL RETENTION SYSTEM

SCALE: HORIZ. 1" = 25' VERT. 1" = 5'

STA. 135+00.00 TO STA. 142+00.00

F.A.P. RTE.	SECTION	COUNTY	TOTAL SHEETS	SHEET NO.
345	BR-R	KANE	794	102
CONTRACT NO. 60445				
FED. ROAD DIST. NO. 7 ILLINOIS FED. AID PROJECT				

