

\\D:\160H45-BORDER\160H45-LEGEND.DGN, \\D:\160H45-STAGING2-2.DGN, \\D:\160H45-ORAINP\160H45-LEGEND.DGN, \\D:\160H45-ORAINP\160H45-STAGING.DGN, \\D:\160H45-ORAINP\160H45-SHT-STAGINGM4.DGN  
 \\S:\160H45-ORAINP\160H45-LEGEND.DGN, \\S:\160H45-ORAINP\160H45-STAGING2-2.DGN, \\S:\160H45-ORAINP\160H45-STAGING.DGN, \\S:\160H45-ORAINP\160H45-SHT-STAGINGM4.DGN

**LEGEND**

- WORK AREA
- IMPACT ATTENUATOR
- TEMPORARY CONCRETE BARRIER
- TYPE II BARRICADES OR DRUMS WITH STEADY BURN MONODIRECTIONAL LIGHT (AT SPECIFIED SPACING)
- DIRECTION OF TRAFFIC FLOW
- SIGN
- VERTICAL PANELS WITH STEADY BURNING LIGHTS (AT SPECIFIED SPACING)
- ARROW BOARD
- TYPE III BARRICADE
- TEMPORARY PAVEMENT, CURRENT STAGE
- TEMPORARY PAVEMENT, PREVIOUS STAGES

**PAVEMENT MARKING LEGEND-MCLEAN AND SIDESTREETS STAGING**

- (A) TEMP PVT MK LINE 4 (SOLID, WHITE)
- (B) TEMP PVT MK LINE 4 (SOLID, YELLOW)
- (C) TEMP PVT MK LINE 4 (SOLID, DOUBLE WHITE)
- (D) TEMP PVT MK LINE 4 (SOLID, DOUBLE YELLOW)
- (E) TEMP PVT MK LINE 4 (10' DASH - 30' SKIP, WHITE)
- (F) TEMP PVT MK LINE 4 (10' DASH - 30' SKIP, YELLOW)
- (G) TEMP PVT MK LINE 6 (SOLID, WHITE)
- (H) TEMP PVT MK LINE 6 (2' DASH - 6' SKIP, WHITE)
- (I) TEMP PVT MK LINE 8 (SOLID, WHITE)
- (J) TEMP PVT MK LINE 12 (SOLID, YELLOW)
- (K) TEMP PVT MK LINE 24 (SOLID, WHITE)
- (L) TEMP PVT MK LINE 12 (SOLID, WHITE)

**NOTE:**

1) THE CONTRACTOR SHALL PROVIDE PAVEMENT MARKING LETTERS AND SYMBOLS ACCORDING TO THE DETAILS OF DISTRICT ONE DETAILS TC-13 AND TC-16.

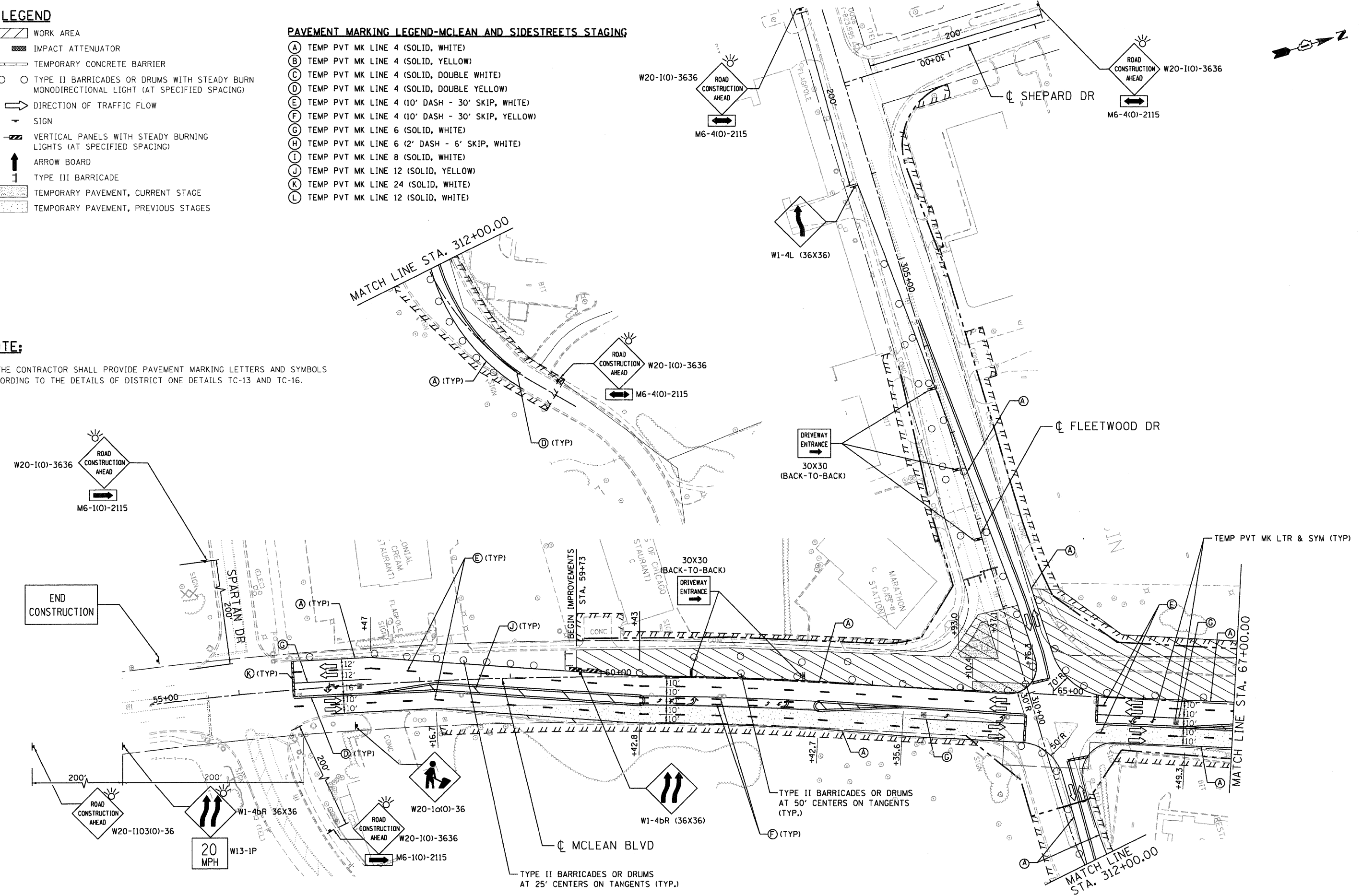

FILE NAME = #FILEL#	USER NAME = #USER# PLOT SCALE = #SCALE# PLOT DATE = #DATE#	DESIGNED - MM	REVISED -	<b>STATE OF ILLINOIS</b> <b>DEPARTMENT OF TRANSPORTATION</b> FAP ROUTE 345 / US ROUTE 20	<b>STAGING AND TRAFFIC CONTROL</b> <b>STAGE II.2A</b> <b>MCLEAN BOULEVARD</b>	F.A.P. RTE. 345	SECTION 8R-R	COUNTY KANE	TOTAL SHEETS 794	SHEET NO. 207
		CHECKED - PB	REVISED -			SCALE: 1"=50'    SHEET NO.    OF    STA. 55+00.00 TO STA. 67+00.00    FED. ROAD DIST. NO.    ILLINOIS FED. AID PROJECT				
		DATE - 12/16/11	REVISED -			CONTRACT NO. 60H45				