

\D:\60445-BORDER\01.DGN, \D:\60445-ALIGN\01.DGN, \D:\60445-LEGEND\01.DGN, \D:\60445-ROW\01.DGN, \D:\60445-STAGING\01.DGN, \D:\60445-SHT-5\01.DGN, \D:\60445-SHT-6\01.DGN, \D:\60445-SHT-7\01.DGN, \D:\60445-SHT-8\01.DGN, \D:\60445-SHT-9\01.DGN, \D:\60445-SHT-10\01.DGN, \D:\60445-SHT-11\01.DGN, \D:\60445-SHT-12\01.DGN, \D:\60445-SHT-13\01.DGN, \D:\60445-SHT-14\01.DGN, \D:\60445-SHT-15\01.DGN, \D:\60445-SHT-16\01.DGN, \D:\60445-SHT-17\01.DGN, \D:\60445-SHT-18\01.DGN, \D:\60445-SHT-19\01.DGN, \D:\60445-SHT-20\01.DGN, \D:\60445-SHT-21\01.DGN, \D:\60445-SHT-22\01.DGN, \D:\60445-SHT-23\01.DGN, \D:\60445-SHT-24\01.DGN, \D:\60445-SHT-25\01.DGN, \D:\60445-SHT-26\01.DGN, \D:\60445-SHT-27\01.DGN, \D:\60445-SHT-28\01.DGN, \D:\60445-SHT-29\01.DGN, \D:\60445-SHT-30\01.DGN, \D:\60445-SHT-31\01.DGN, \D:\60445-SHT-32\01.DGN, \D:\60445-SHT-33\01.DGN, \D:\60445-SHT-34\01.DGN, \D:\60445-SHT-35\01.DGN, \D:\60445-SHT-36\01.DGN, \D:\60445-SHT-37\01.DGN, \D:\60445-SHT-38\01.DGN, \D:\60445-SHT-39\01.DGN, \D:\60445-SHT-40\01.DGN, \D:\60445-SHT-41\01.DGN, \D:\60445-SHT-42\01.DGN, \D:\60445-SHT-43\01.DGN, \D:\60445-SHT-44\01.DGN, \D:\60445-SHT-45\01.DGN, \D:\60445-SHT-46\01.DGN, \D:\60445-SHT-47\01.DGN, \D:\60445-SHT-48\01.DGN, \D:\60445-SHT-49\01.DGN, \D:\60445-SHT-50\01.DGN, \D:\60445-SHT-51\01.DGN, \D:\60445-SHT-52\01.DGN, \D:\60445-SHT-53\01.DGN, \D:\60445-SHT-54\01.DGN, \D:\60445-SHT-55\01.DGN, \D:\60445-SHT-56\01.DGN, \D:\60445-SHT-57\01.DGN, \D:\60445-SHT-58\01.DGN, \D:\60445-SHT-59\01.DGN, \D:\60445-SHT-60\01.DGN, \D:\60445-SHT-61\01.DGN, \D:\60445-SHT-62\01.DGN, \D:\60445-SHT-63\01.DGN, \D:\60445-SHT-64\01.DGN, \D:\60445-SHT-65\01.DGN, \D:\60445-SHT-66\01.DGN, \D:\60445-SHT-67\01.DGN, \D:\60445-SHT-68\01.DGN, \D:\60445-SHT-69\01.DGN, \D:\60445-SHT-70\01.DGN, \D:\60445-SHT-71\01.DGN, \D:\60445-SHT-72\01.DGN, \D:\60445-SHT-73\01.DGN, \D:\60445-SHT-74\01.DGN, \D:\60445-SHT-75\01.DGN, \D:\60445-SHT-76\01.DGN, \D:\60445-SHT-77\01.DGN, \D:\60445-SHT-78\01.DGN, \D:\60445-SHT-79\01.DGN, \D:\60445-SHT-80\01.DGN, \D:\60445-SHT-81\01.DGN, \D:\60445-SHT-82\01.DGN, \D:\60445-SHT-83\01.DGN, \D:\60445-SHT-84\01.DGN, \D:\60445-SHT-85\01.DGN, \D:\60445-SHT-86\01.DGN, \D:\60445-SHT-87\01.DGN, \D:\60445-SHT-88\01.DGN, \D:\60445-SHT-89\01.DGN, \D:\60445-SHT-90\01.DGN, \D:\60445-SHT-91\01.DGN, \D:\60445-SHT-92\01.DGN, \D:\60445-SHT-93\01.DGN, \D:\60445-SHT-94\01.DGN, \D:\60445-SHT-95\01.DGN, \D:\60445-SHT-96\01.DGN, \D:\60445-SHT-97\01.DGN, \D:\60445-SHT-98\01.DGN, \D:\60445-SHT-99\01.DGN, \D:\60445-SHT-100\01.DGN

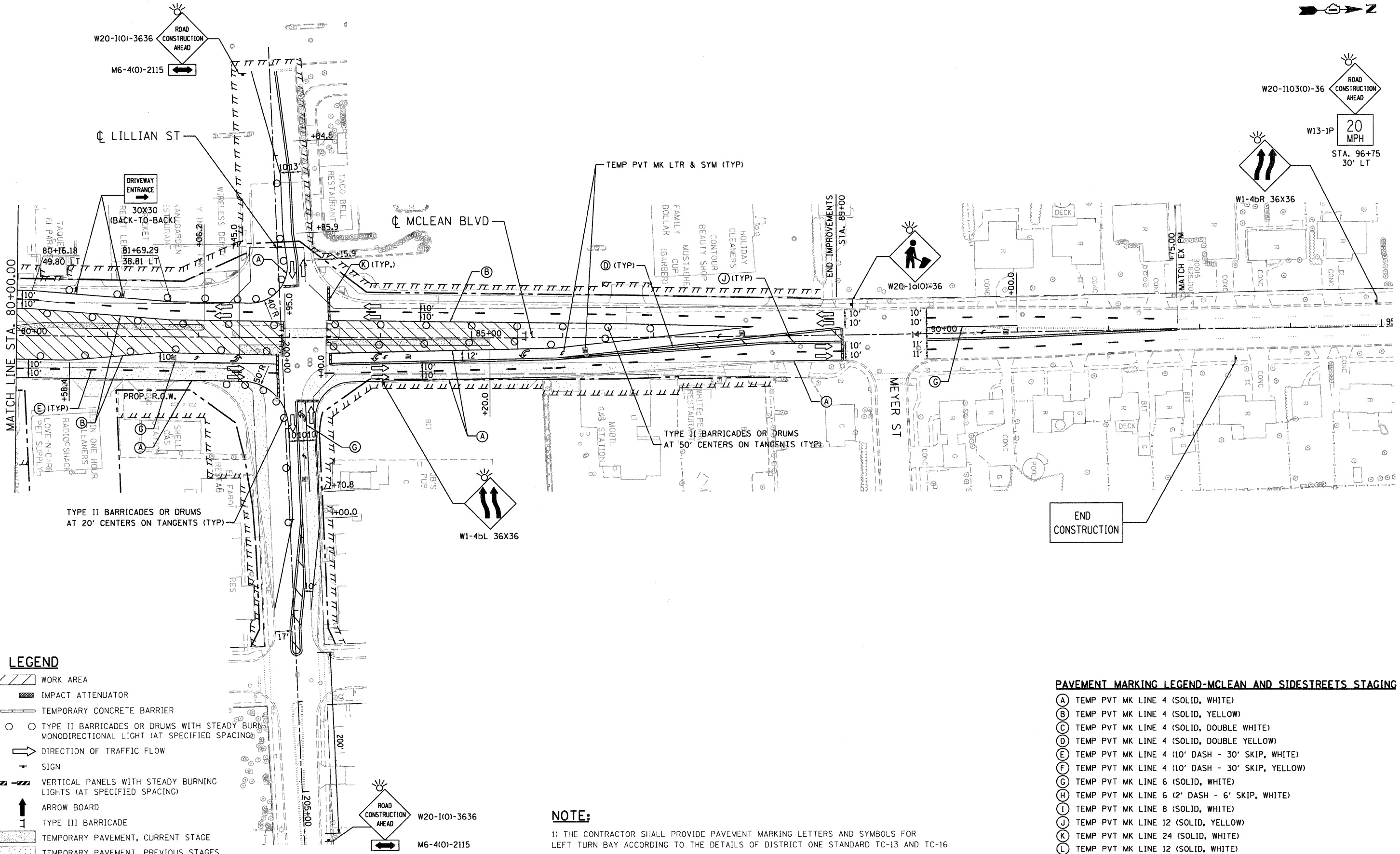

LEGEND

- WORK AREA
- IMPACT ATTENUATOR
- TEMPORARY CONCRETE BARRIER
- TYPE II BARRICADES OR DRUMS WITH STEADY BURNING MONODIRECTIONAL LIGHT (AT SPECIFIED SPACING)
- DIRECTION OF TRAFFIC FLOW
- SIGN
- VERTICAL PANELS WITH STEADY BURNING LIGHTS (AT SPECIFIED SPACING)
- ARROW BOARD
- TYPE III BARRICADE
- TEMPORARY PAVEMENT, CURRENT STAGE
- TEMPORARY PAVEMENT, PREVIOUS STAGES

PAVEMENT MARKING LEGEND-MCLEAN AND SIDESTREETS STAGING

- (A) TEMP PVT MK LINE 4 (SOLID, WHITE)
- (B) TEMP PVT MK LINE 4 (SOLID, YELLOW)
- (C) TEMP PVT MK LINE 4 (SOLID, DOUBLE WHITE)
- (D) TEMP PVT MK LINE 4 (SOLID, DOUBLE YELLOW)
- (E) TEMP PVT MK LINE 4 (10' DASH - 30' SKIP, WHITE)
- (F) TEMP PVT MK LINE 4 (10' DASH - 30' SKIP, YELLOW)
- (G) TEMP PVT MK LINE 6 (SOLID, WHITE)
- (H) TEMP PVT MK LINE 6 (2' DASH - 6' SKIP, WHITE)
- (I) TEMP PVT MK LINE 8 (SOLID, WHITE)
- (J) TEMP PVT MK LINE 12 (SOLID, YELLOW)
- (K) TEMP PVT MK LINE 24 (SOLID, WHITE)
- (L) TEMP PVT MK LINE 12 (SOLID, WHITE)

NOTE:

1) THE CONTRACTOR SHALL PROVIDE PAVEMENT MARKING LETTERS AND SYMBOLS FOR LEFT TURN BAY ACCORDING TO THE DETAILS OF DISTRICT ONE STANDARD TC-13 AND TC-16

FILE NAME =	USER NAME = #USER#	DESIGNED - JP	REVISED -
#FILEL#		DRAWN - SA	REVISED -
	PLOT SCALE = #SCALE#	CHECKED - PB	REVISED -
	PLOT DATE = #DATE#	DATE - 12/16/11	REVISED -

STATE OF ILLINOIS
DEPARTMENT OF TRANSPORTATION
 FAP ROUTE 345 / US ROUTE 20

STAGING AND TRAFFIC CONTROL			
STAGE II.3A			
MCLEAN BOULEVARD			
SCALE: 1"=50'	SHEET NO. OF	STA. 80+00.00 TO STA. 91+00.00	

F.A.P. RTE. 345	SECTION 8R-R	COUNTY KANE	TOTAL SHEETS 794	SHEET NO. 215
CONTRACT NO. 60H45				
FED. ROAD DIST. NO. ILLINOIS FED. AID PROJECT				

