

DATE	
BY	
PLAN	
NO.	
NO. OF WAY CHECKED	
DATE	
FILE NAME	

LEGEND

- EX. INLET
- EX. CATCH BASIN
- EX. MANHOLE
- EX. DRYWELL
- ▽ EX. CULVERT END SECTION
- ⊕ EX. FIRE HYDRANT
- EX. STORM SEWER
- EX. SANITARY SEWER
- PAVED DITCH REMOVAL
- PIPE REMOVAL
- [R] STRUCTURE TO BE REMOVED
- [ADJ] STRUCTURE TO BE ADJUSTED
- [REC] STRUCTURE TO BE RECONSTRUCTED

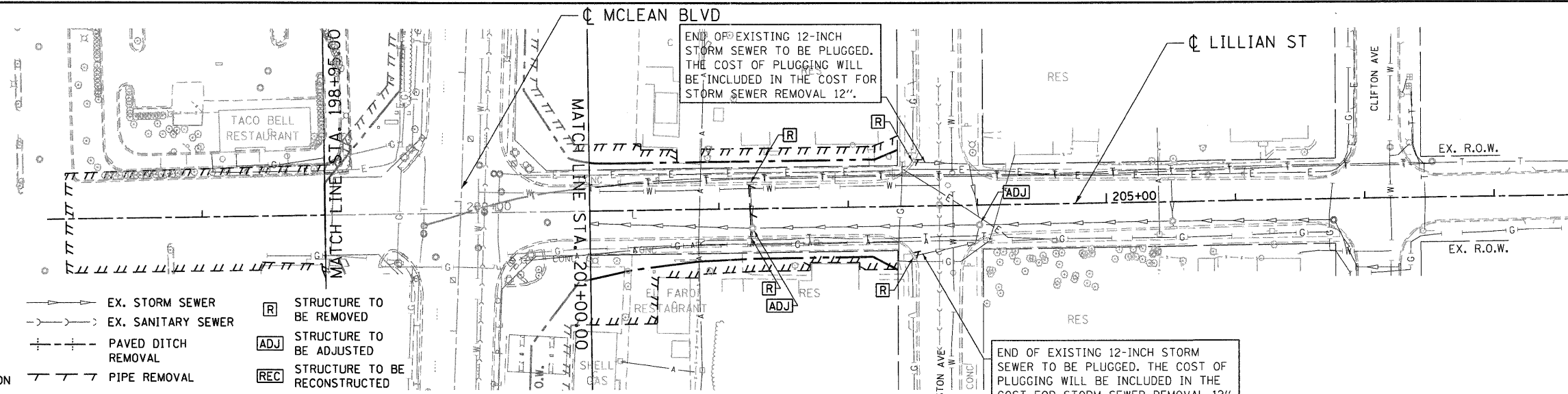

DATE	
BY	
PROFILE	
NO.	
NO. OF WAY CHECKED	
DATE	
FILE NAME	

LEGEND

- PR. MANHOLE
- PR. CATCH BASIN
- ▽ PR. CULVERT END SECTION
- ⊕ PR. INLET
- ▭ PR. HEADWALL FOR PIPE DRAIN
- PR. DRYWELL
- PR. STORM SEWER
- PR. CULVERT
- PR. PIPE UNDERDRAIN
- PR. DITCH
- ⊕ PR. SWALE
- ⊕ PR. PIPE
- ⊕ PR. STRUCTURE
- ▭ RIPRAP APRON

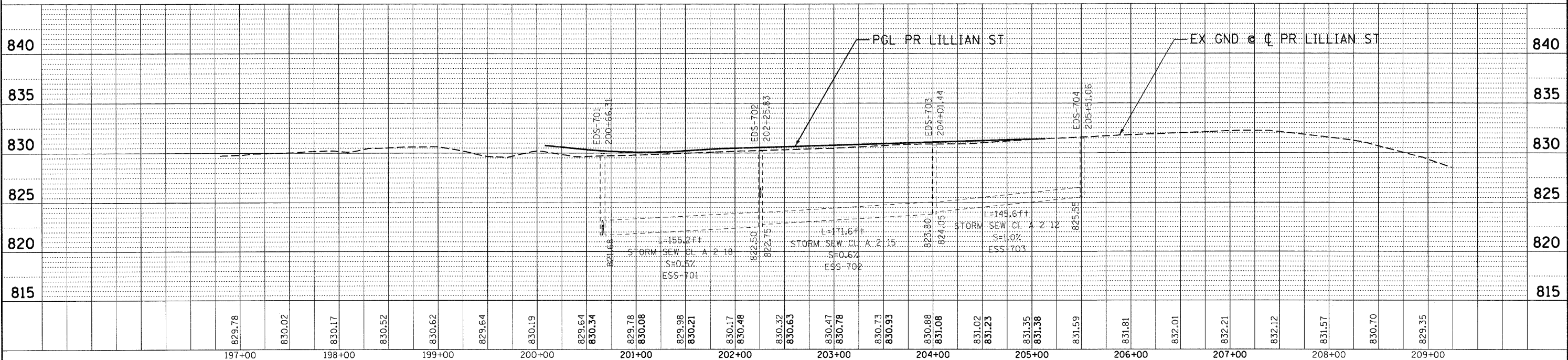
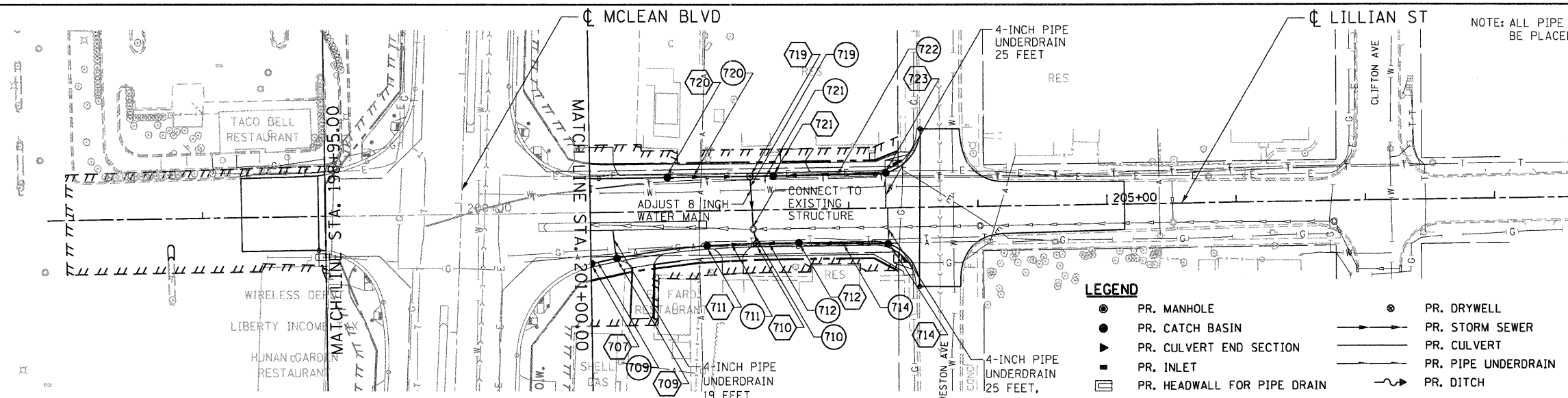

FILE NAME = #FILE#	USER NAME = #USER#	DESIGNED - SLH	REVISED -	STATE OF ILLINOIS DEPARTMENT OF TRANSPORTATION FAP ROUTE 345 / US ROUTE 20					DRAINAGE PLAN AND PROFILE LILLIAN STREET					F.A.P. RTE. 345	SECTION 8R-R	COUNTY KANE	TOTAL SHEETS 794	SHEET NO. 273
PLLOT SCALE = #SCALE#	PLLOT DATE = #DATE#	CHECKED - TKL	REVISED -						SCALE: HORIZ. 1"=50'	VERT. 1"=5'	STA. 198+30.00 TO STA. 207+50.00	FED. ROAD DIST. NO. [ILLINOIS] FED. AID PROJECT	CONTRACT NO. 60H45					

12-15-2011 13:18:22
 B:\176761
 \FES\884\WAY\VAL.L.D - TRANE.07\2082\21379-001\CIVIL\CAD\GEM45\SHEET\0162945-SHT-01.DWG

