



TEMPORARY RADIO INTERCONNECT TO SPARTAN DRIVE (SEE TEMPORARY INTERCONNECT PLANS)

TEMPORARY RADIO INTERCONNECT TO SPARTAN DRIVE (SEE TEMPORARY INTERCONNECT PLANS)

TEMPORARY RADIO INTERCONNECT TO SOUTH RAMP OF US RTE. 20 (SEE TEMPORARY INTERCONNECT PLANS)

TEMPORARY RADIO INTERCONNECT TO SOUTH RAMP OF US RTE. 20 (SEE TEMPORARY INTERCONNECT PLANS)

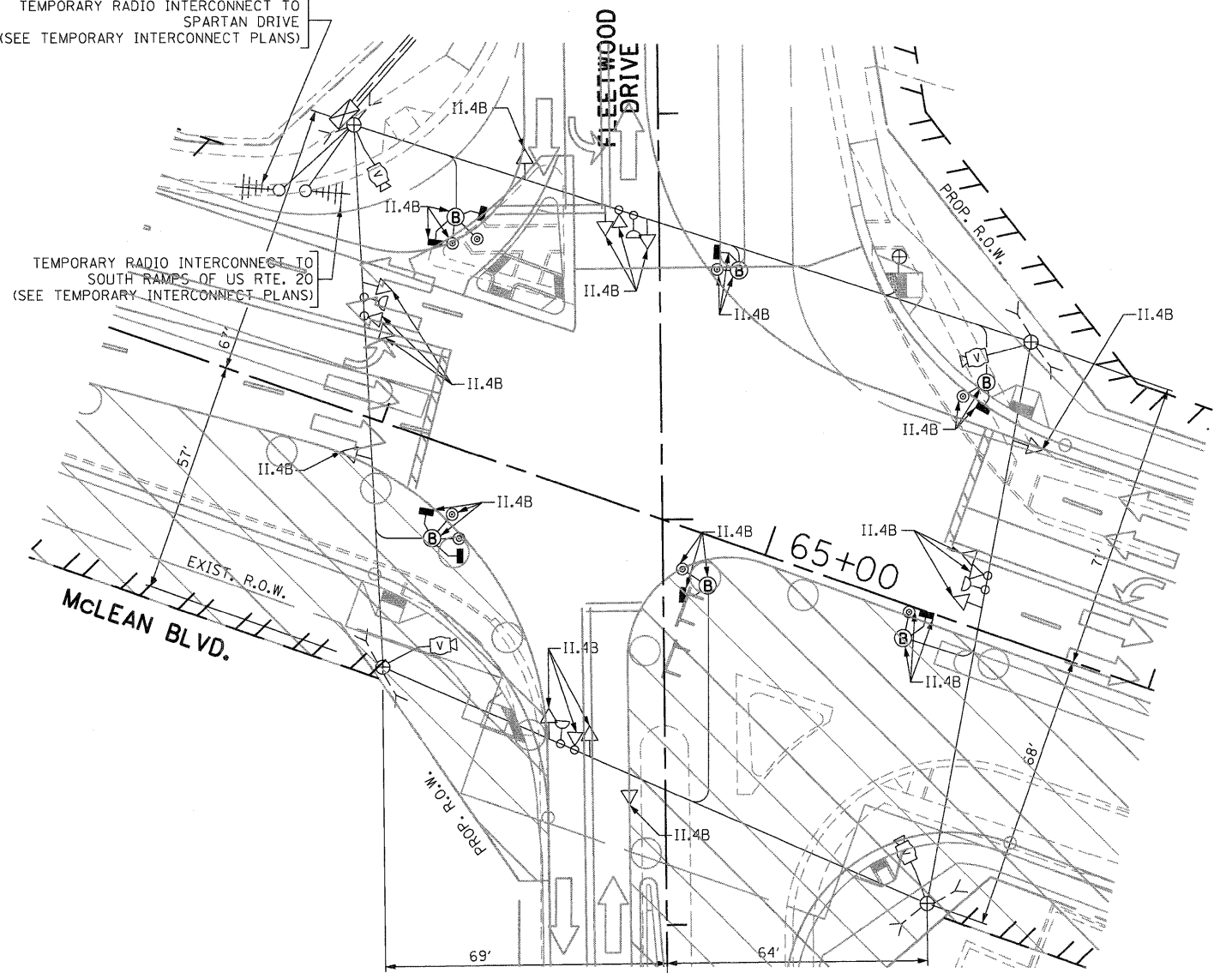
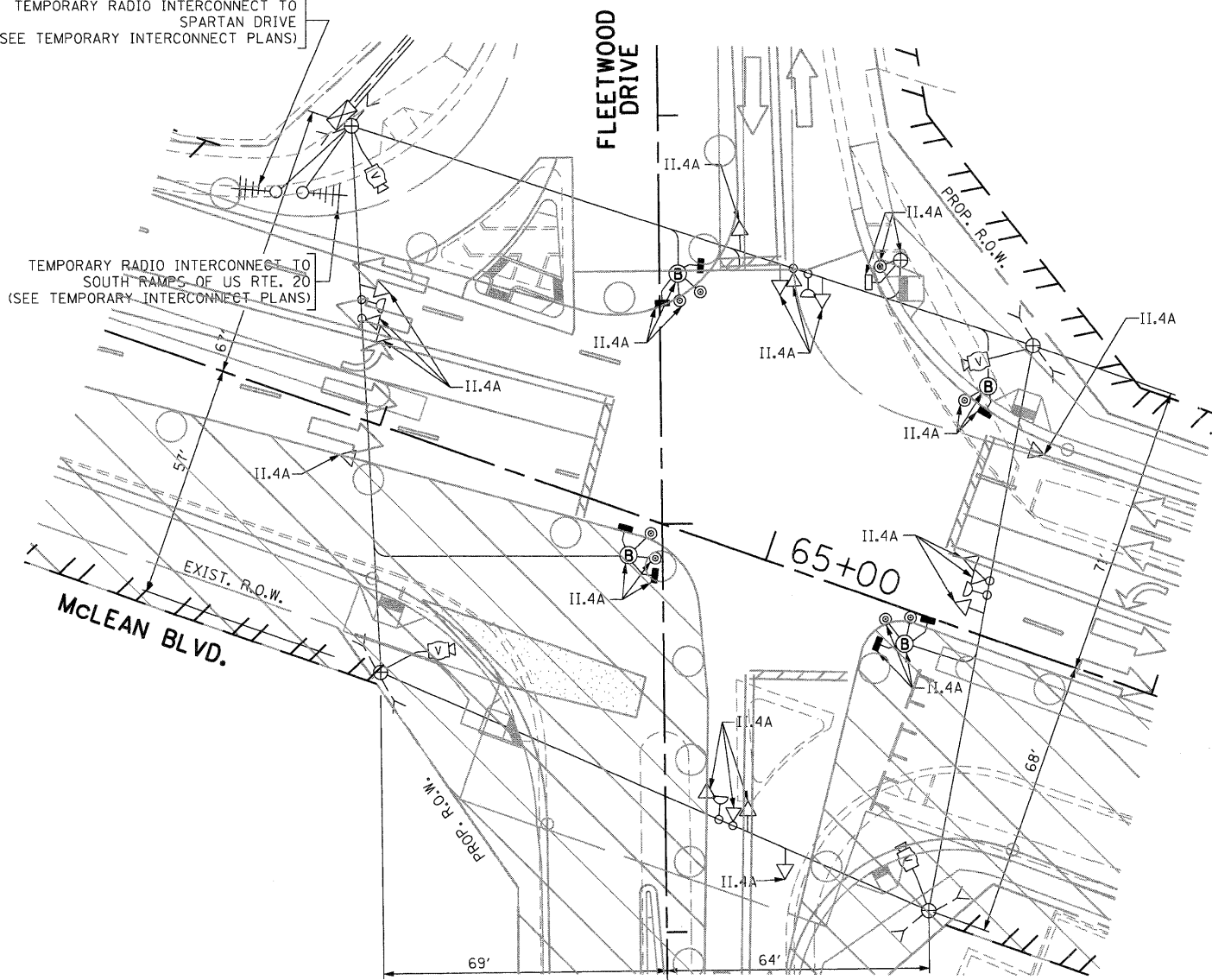

SIGNAL HEAD PLACEMENTS FOR STAGE: II.4A

SIGNAL HEAD PLACEMENTS FOR STAGE: II.4B

LEGEND

TEMPORARY CONCRETE BARREL WITH POST FOR PEDESTRIAN SIGNALS AND PUSH-BUTTONS (B)

LEGEND

TEMPORARY CONCRETE BARREL WITH POST FOR PEDESTRIAN SIGNALS AND PUSH-BUTTONS (B)

THE TRAFFIC SIGNAL CONTROL EQUIPMENT FOR THIS PROJECT SHALL BE "EAGLE" TO MATCH THE EXISTING ADJACENT SYSTEM.

FILE NAME *	USER NAME * #USER#	DESIGNED - PKG	REVISED -	STATE OF ILLINOIS DEPARTMENT OF TRANSPORTATION	TEMPORARY TRAFFIC SIGNAL PLAN McLEAN BOULEVARD AT FLEETWOOD DRIVE STAGE II.4A AND STAGE II.4B (SHEET 8 OF 10)			F.A.P. RTE. 345	SECTION 8R-R	COUNTY KANE	TOTAL SHEETS 794	SHEET NO. 400
#FILE#	PLOT SCALE * #SCALE#	DRAWN - MAA, EA	REVISED -		SCALE: 1"=20'	SHEET NO.	OF SHEETS	STA.	TO STA.	CONTRACT NO. 60H45		
	PLOT DATE * #DATE#	CHECKED - PKG	REVISED -							FED. ROAD DIST. NO. - [ILLINOIS] FED. AID PROJECT		
		DATE - 12/16/2011	REVISED -									