

**TEMPORARY CABLE PLAN**  
(NOT TO SCALE)  
STAGE II.3B

NOTE 1: DURING CONSTRUCTION STAGE II.3B THE GREEN AND YELLOW LEFT ARROW INDICATION SECTIONS FOR THE NORTHBOUND DIRECTION OF TRAFFIC SHALL BE BAGGED AND DISCONNECTED AT THE CONTROLLER.

**SIGNAL HEAD PLACEMENTS FOR STAGE II.3B**

**LEGEND**  
TEMPORARY CONCRETE BARREL WITH POST FOR SIGNAL HEAD, PEDESTRIAN SIGNALS AND PUSH-BUTTONS

I.D.O.T. TRAFFIC SIGNAL INSTALLATION ELECTRICAL SERVICE REQUIREMENTS					
TYPE	NO LAMPS	WATTAGE		%OPERATION	TOTAL WATTAGE
		INCAND.	LED		
SIGNAL (RED)	11	135	17	0.50	93.5
(YELLOW)	11	135	25	0.25	68.75
(GREEN)	11	135	15	0.25	41.25
ARROW		135	12	0.10	
PED. SIGNAL	2	90	25	1.00	50
CONTROLLER	1	100	100	1.00	100
ILLUM. SIGN				0.05	
VIDEO SYSTEM	1	150		1.00	150
FLASHER				0.50	
TOTAL =					503.5

ENERGY COSTS TO:  
CITY OF ELGIN  
150 DEXTER COURT  
ELGIN, ILLINOIS 60120-5570

ENERGY SUPPLY CONTACT: **ELLIE SARALLO**  
PHONE: (630) 424 5124  
COMPANY: COMMONWEALTH EDISON

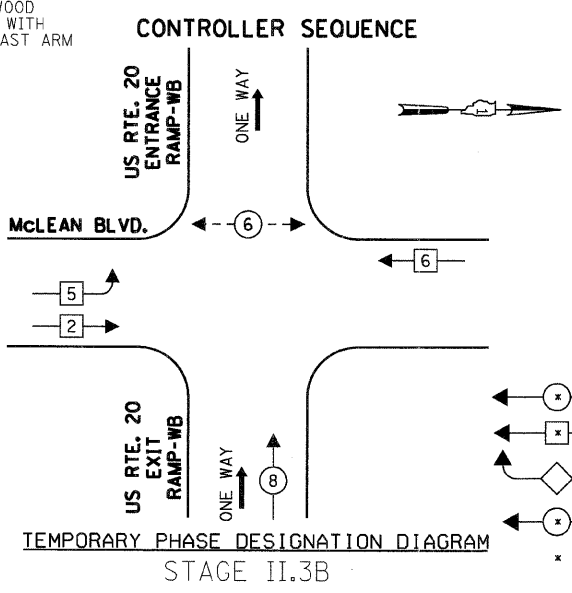

**TEMPORARY PHASE DESIGNATION DIAGRAM**  
STAGE II.3B

**LEGEND**

- DUAL ENTRY PHASE
- SINGLE ENTRY PHASE
- OVERLAP
- PEDESTRIAN PHASE
- NUMBER REFERS TO ASSOCIATED PHASE

**TEMPORARY EMERGENCY VEHICLE PREEMPTION SEQUENCE**

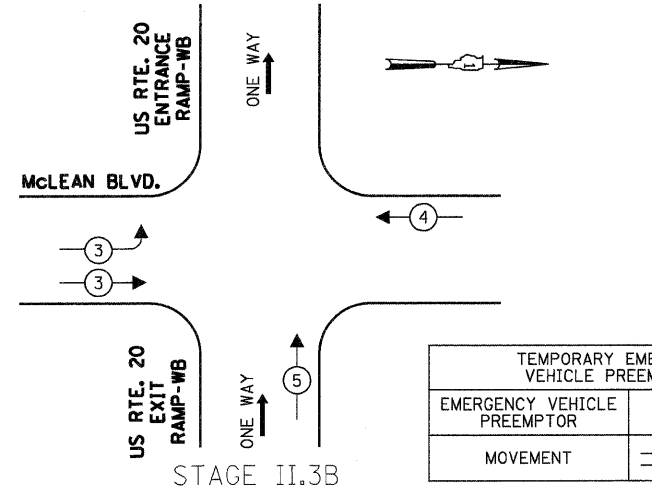

**TEMPORARY EMERGENCY VEHICLE PREEMPTION SEQUENCE**  
STAGE II.3B

THE TRAFFIC SIGNAL CONTROL EQUIPMENT FOR THIS PROJECT SHALL BE "EAGLE" TO MATCH THE EXISTING ADJACENT SYSTEM.

TEMPORARY EMERGENCY VEHICLE PREEMPTORS			
EMERGENCY VEHICLE PREEMPTOR	3	4	5
MOVEMENT	→	←	↑