

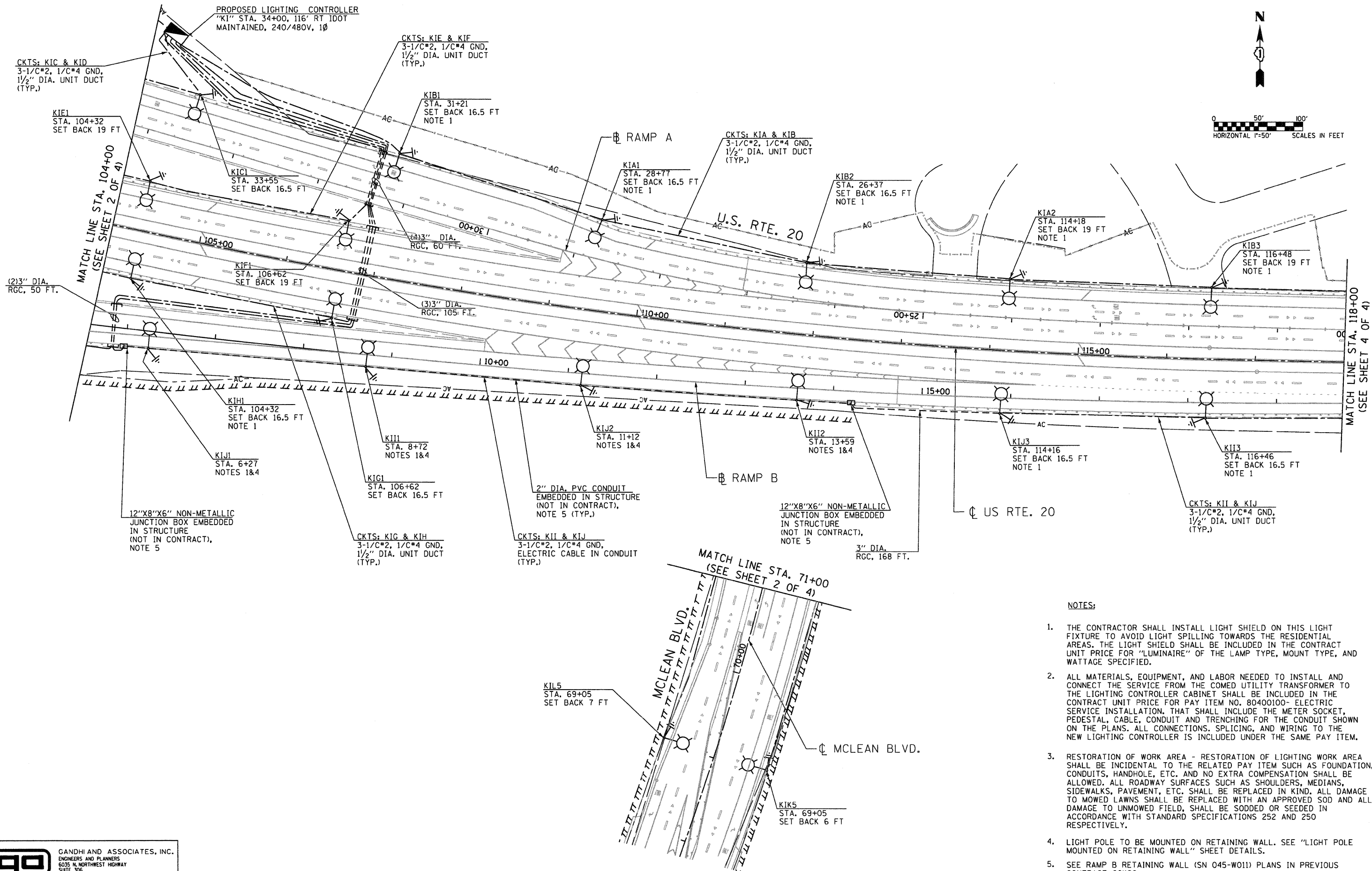

0 50' 100'
HORIZONTAL 1"=50' SCALES IN FEET



NOTES:

1. THE CONTRACTOR SHALL INSTALL LIGHT SHIELD ON THIS LIGHT FIXTURE TO AVOID LIGHT SPILLING TOWARDS THE RESIDENTIAL AREAS. THE LIGHT SHIELD SHALL BE INCLUDED IN THE CONTRACT UNIT PRICE FOR "LUMINAIRE" OF THE LAMP TYPE, MOUNT TYPE, AND WATTAGE SPECIFIED.
2. ALL MATERIALS, EQUIPMENT, AND LABOR NEEDED TO INSTALL AND CONNECT THE SERVICE FROM THE COMED UTILITY TRANSFORMER TO THE LIGHTING CONTROLLER CABINET SHALL BE INCLUDED IN THE CONTRACT UNIT PRICE FOR PAY ITEM NO. 80400100- ELECTRIC SERVICE INSTALLATION. THAT SHALL INCLUDE THE METER SOCKET, PEDESTAL, CABLE, CONDUIT AND TRENCHING FOR THE CONDUIT SHOWN ON THE PLANS. ALL CONNECTIONS, SPLICING, AND WIRING TO THE NEW LIGHTING CONTROLLER IS INCLUDED UNDER THE SAME PAY ITEM.
3. RESTORATION OF WORK AREA - RESTORATION OF LIGHTING WORK AREA SHALL BE INCIDENTAL TO THE RELATED PAY ITEM SUCH AS FOUNDATION, CONDUITS, HANDHOLE, ETC. AND NO EXTRA COMPENSATION SHALL BE ALLOWED. ALL ROADWAY SURFACES SUCH AS SHOULDERS, MEDIANS, SIDEWALKS, PAVEMENT, ETC. SHALL BE REPLACED IN KIND. ALL DAMAGE TO MOWED LAWNS SHALL BE REPLACED WITH AN APPROVED SOD AND ALL DAMAGE TO UNMOWED FIELD, SHALL BE SODDED OR SEEDED IN ACCORDANCE WITH STANDARD SPECIFICATIONS 252 AND 250 RESPECTIVELY.
4. LIGHT POLE TO BE MOUNTED ON RETAINING WALL. SEE "LIGHT POLE MOUNTED ON RETAINING WALL" SHEET DETAILS.
5. SEE RAMP B RETAINING WALL (SN 045-W011) PLANS IN PREVIOUS CONTRACT 60K90.

GO GANDHI AND ASSOCIATES, INC.
ENGINEERS AND PLANNERS
6035 N. NORTHWEST HIGHWAY
SUITE 306
CHICAGO, ILLINOIS 60631 TEL. 47731774-5910

FILE NAME =	USER NAME = .GAI.	DESIGNED - PKG	REVISED -
#FILE#		DRAWN - MAA, SHM	REVISED -
	PLOT SCALE = 1"=50'	CHECKED - PKG	REVISED -
	PLOT DATE = 12/8/2011	DATE - 12/16/11	REVISED -

STATE OF ILLINOIS
DEPARTMENT OF TRANSPORTATION

PROPOSED LIGHTING PLAN
(SHEET 3 OF 4)

SCALE: 1"= 50' SHEET NO. OF SHEETS STA. TO STA.

F.A.P. RTE.	SECTION	COUNTY	TOTAL SHEETS	SHEET NO.
345	8R-R	KANE	794	446
CONTRACT NO. 60H45				
FED. ROAD DIST. NO. 1 ILLINOIS FED. AID PROJECT				