

- EXISTING LEGEND**
- PAVEMENT REMOVAL
  - MEDIAN REMOVAL
  - DRIVEWAY PAVEMENT REMOVAL
  - SIDEWALK REMOVAL
  - PAVEMENT REMOVAL (BY OTHERS)
  - TREE REMOVAL WITH UNIT DIAMETER TRUNK
  - TREE TO BE PROTECTED VIA TEMPORARY FENCE
  - LINEAL REMOVAL ITEM

- NOTES:**
1. SEE ELECTRICAL PLANS FOR LIGHTING REMOVALS.
  2. SEE DRAINAGE PLANS FOR DRAINAGE REMOVALS.
  3. FOR STANDARD SYMBOLS AND PATTERN NOT SHOWN SEE STANDARD 000001-05.

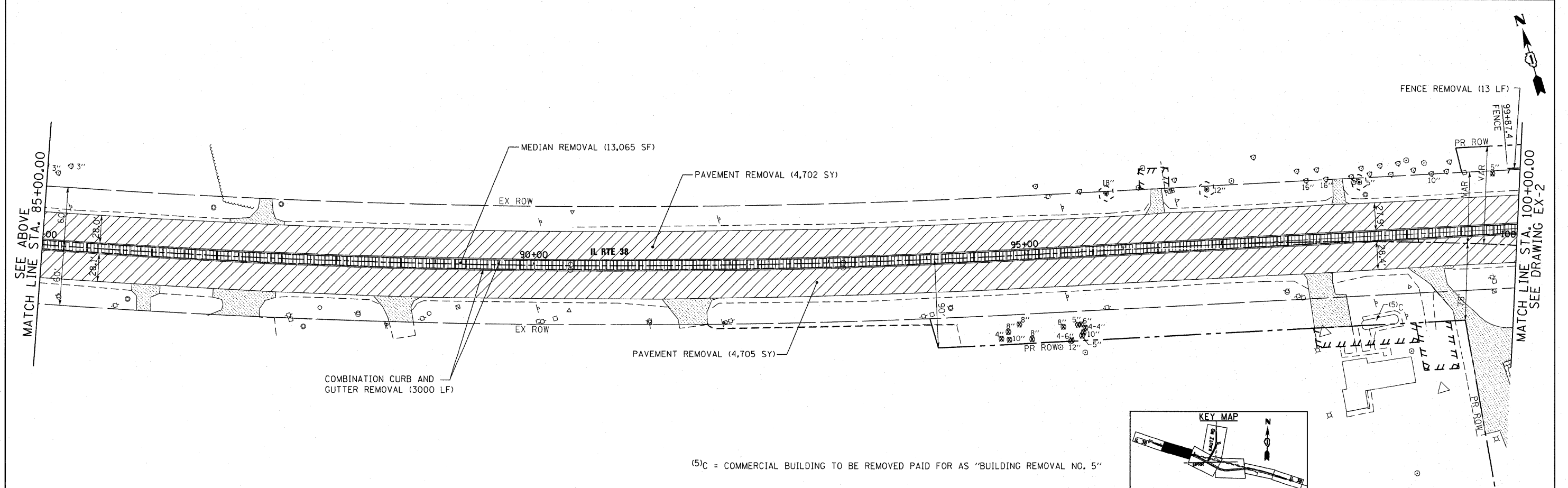

(5)C = COMMERCIAL BUILDING TO BE REMOVED PAID FOR AS "BUILDING REMOVAL NO. 5"

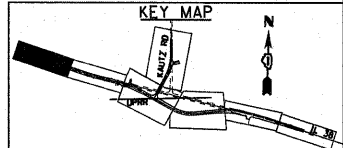
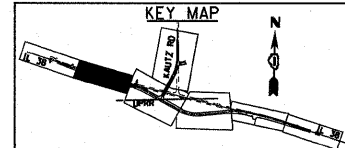

**McDonough Associates Inc.**  
 Engineers / Architects  
 130 East Randolph Street, Chicago, Illinois 60601

FILE NAME = D160122-SHT-REM01.dgn	USER NAME = EricG	DESIGNED - JTF	REVISED -
		DRAWN - JTF	REVISED -
		CHECKED - EJC	REVISED -
		DATE - 01/06/12	REVISED -

**STATE OF ILLINOIS  
DEPARTMENT OF TRANSPORTATION**

<b>IL 38 EXISTING AND REMOVAL PLAN</b>			
SCALE: 1"=50'	SHEET NO. 1 OF 4 SHEETS	STA. BEGIN TO STA. 100+00	

F.A.P. RTE. 347	SECTION LY (HB & VB)	COUNTY DUPAGE/KANE	TOTAL SHEETS 421	SHEET NO. 26
<b>EX-1</b>			<b>CONTRACT NO. 60122</b>	
FED. ROAD DIST. NO. 1 ILLINOIS FED. AID PROJECT				