

- NOTES:
1. FOR CURVE DATA SEE ALIGNMENTS, TIES AND BENCHMARKS, SEE DRAWINGS AT-1 & AT-2.
 2. FOR DRIVEWAY DETAILS SEE DRAWINGS DE-1 AND DISTRICT 1 STANDARD BD-01.
 3. FOR ROW CALL-OUTS SEE PLAT OF HIGHWAY SHEETS.
 4. DC = DEPRESSED CURB (PAID FOR AS COMB CC&G TB6.24)
 5. OFFSETS SHOWN ARE TO EDGE OF PAVEMENT.

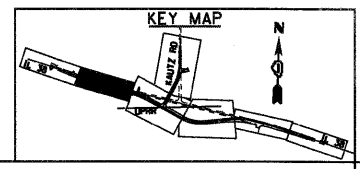
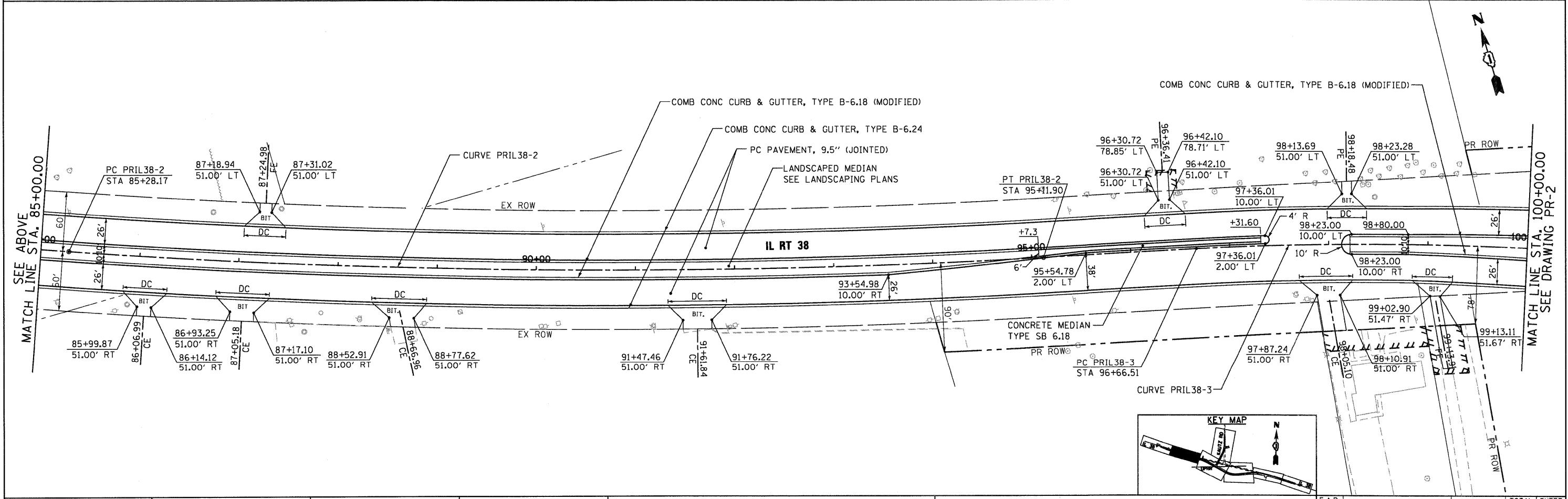
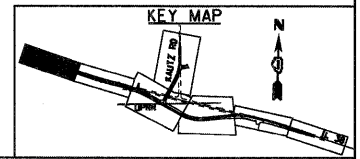

McDonough Associates Inc.
Engineers/Architects
130 East Randolph Street Chicago, Illinois 60601

FILE NAME = D:\168122-SHT-PLAN\01.dgn	USER NAME = YKjm	DESIGNED - JTF	REVISED -
		DRAWN - JTF	REVISED -
		CHECKED - EUG	REVISED -
		DATE - 10/14/11	REVISED -

**STATE OF ILLINOIS
DEPARTMENT OF TRANSPORTATION**

IL 38 PROPOSED PLAN			
SCALE: 1"=50'	SHEET NO. 1 OF 4 SHEETS	STA. BEGIN TO STA. 100+00	

F.A.P. RTE. 347	SECTION LY (HB & VB)	COUNTY DUPAGE/KANE	TOTAL SHEETS 421	SHEET NO. 31
PR-1		CONTRACT NO. 60122		
FED. ROAD DIST. NO. 1 ILLINOIS FED. AID PROJECT				