

SEE DRAWING MOT-15
MATCH LINE STA. 1104+00.00

MATCH LINE STA. 100+00.00
SEE DRAWING MOT-11

MATCH LINE STA. 115+00.00
SEE DRAWING MOT-13

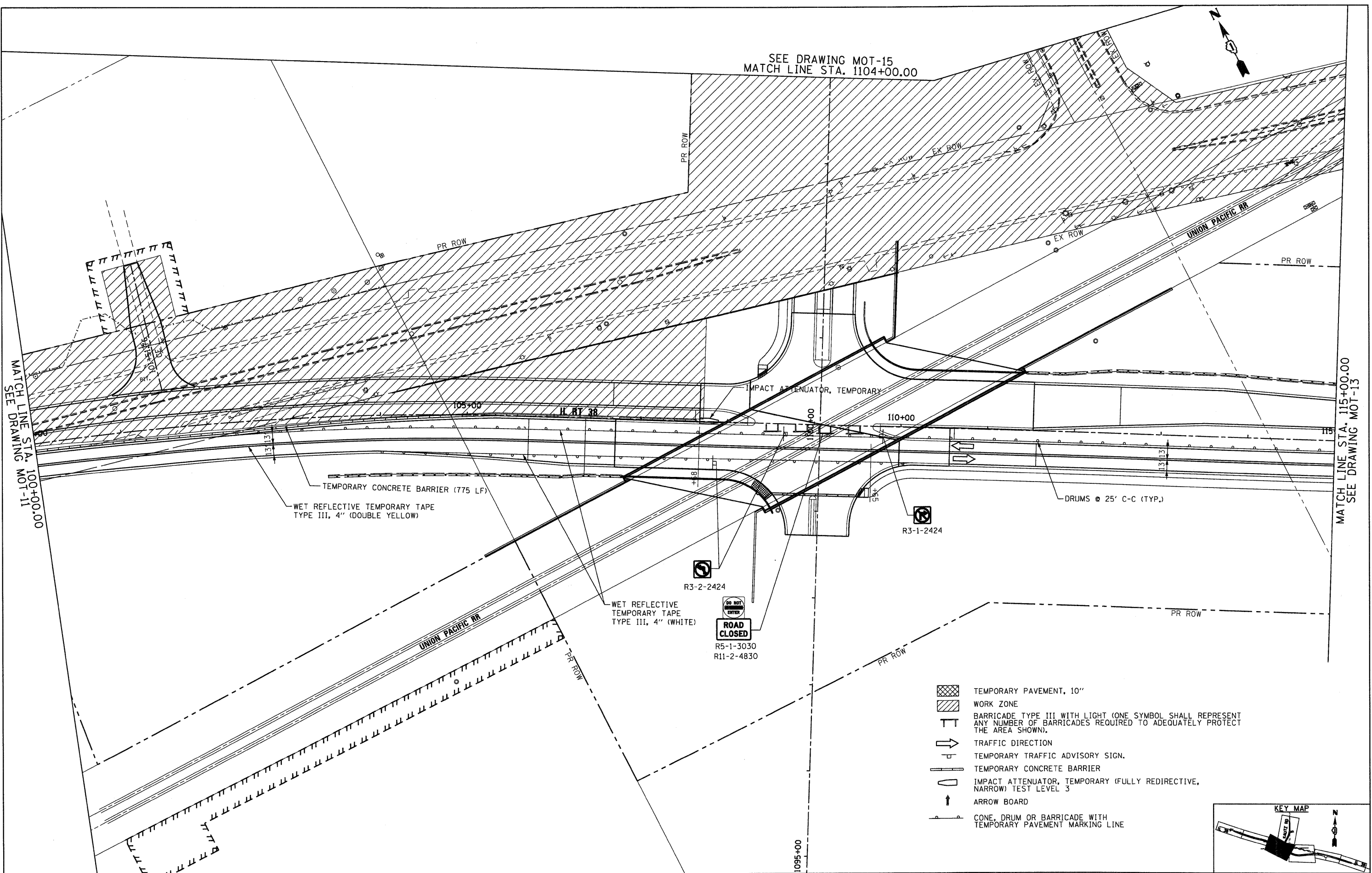

TEMPORARY CONCRETE BARRIER (775 LF)
WET REFLECTIVE TEMPORARY TAPE
TYPE III, 4" (DOUBLE YELLOW)

WET REFLECTIVE
TEMPORARY TAPE
TYPE III, 4" (WHITE)
R3-2-2424
R5-1-3030
R11-2-4830
ROAD CLOSED

R3-1-2424

- TEMPORARY PAVEMENT, 10"
- WORK ZONE
- BARRICADE TYPE III WITH LIGHT (ONE SYMBOL SHALL REPRESENT ANY NUMBER OF BARRICADES REQUIRED TO ADEQUATELY PROTECT THE AREA SHOWN).
- TRAFFIC DIRECTION
- TEMPORARY TRAFFIC ADVISORY SIGN.
- TEMPORARY CONCRETE BARRIER
- IMPACT ATTENUATOR, TEMPORARY (FULLY REDIRECTIVE, NARROW) TEST LEVEL 3
- ARROW BOARD
- CONE, DRUM OR BARRICADE WITH TEMPORARY PAVEMENT MARKING LINE

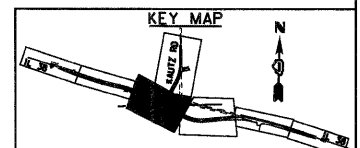

McDonough Associates Inc.
Engineers/Architects
130 East Randolph Street Chicago, Illinois 60601

FILE NAME = D:\68122-SHT-STAG1\G12.dgn	USER NAME = Ykim	DESIGNED - KBN	REVISED -
		DRAWN - KBN	REVISED -
		CHECKED - EJC	REVISED -
		DATE - 10/14/11	REVISED -

STATE OF ILLINOIS
DEPARTMENT OF TRANSPORTATION

MAINTENANCE OF TRAFFIC
STAGE 3

SCALE: 1"=50' SHEET NO. 12 OF 17 SHEETS STA. 100+00 TO STA. 115+00

F.A.P. RTE. 347	SECTION LY (HB & VB)	COUNTY DUPAGE/KANE	TOTAL SHEETS 421	SHEET NO. 53
MOT-12			CONTRACT NO. 60122	
FED. ROAD DIST. NO. 1 [ILLINOIS] FED. AID PROJECT				