

- NOTES**
- ELEVATIONS ARE SHOWN AT 25' INTERVALS AND ARE FOR INFORMATION ONLY. THE CONTRACTOR SHALL VERIFY ALL ELEVATIONS PRIOR TO CONSTRUCTION.
 - TRANSVERSE CONTRACTION JOINTS ARE TYPICALLY SPACED AT 15'. REFER TO IDOT STANDARDS 420001, 420101, 420106, 420201 AND 420401 FOR JOINT DETAILS AND SPACING.

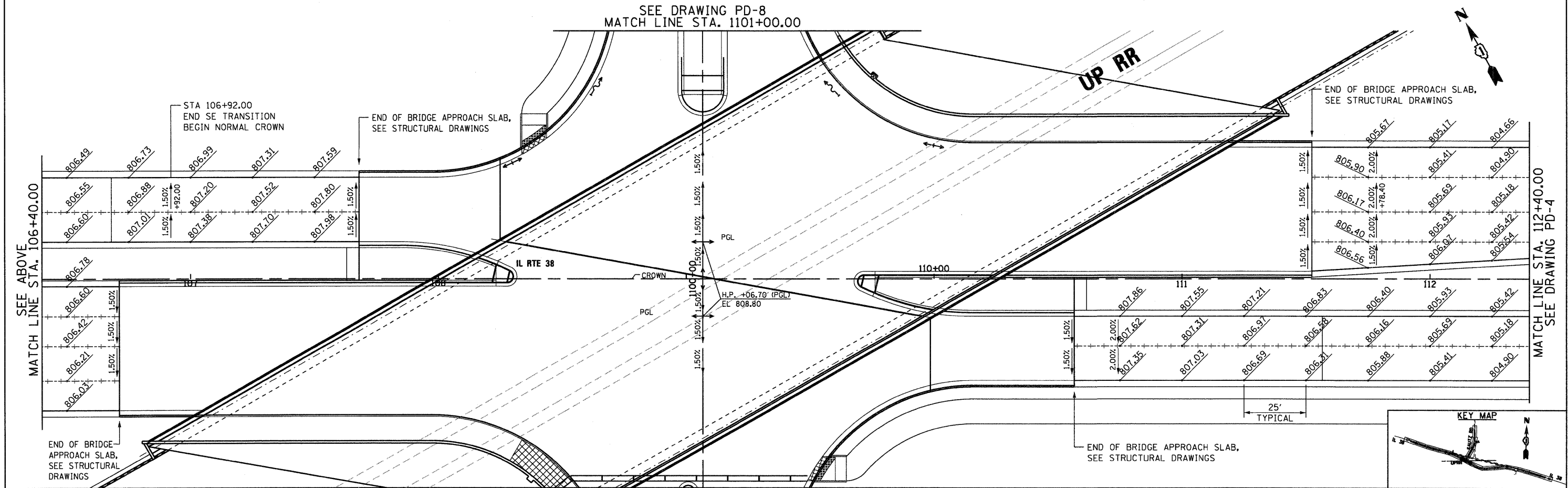

McDonough Associates Inc.
Engineers / Architects
130 East Randolph Street Chicago, Illinois 60601

FILE NAME =
D168122-SHT-PAVEMENT-DETAILS03.dgn

USER NAME = EricG
DESIGNED - JTF
DRAWN - JTF
CHECKED - EUG
PLOT SCALE = 1/2"=1'
PLOT DATE = 12/9/2011

REVISOR -
REVISION -
REVISION -
DATE - 12/09/11

**STATE OF ILLINOIS
DEPARTMENT OF TRANSPORTATION**

IL 38 PAVEMENT DETAILS

SCALE: 1"=20' SHEET NO. 3 OF 7 SHEETS STA. 100+40 TO STA. 112+40

F.A.P. RTE.	SECTION	COUNTY	TOTAL SHEETS	SHEET NO.
347	LY (HB & VB)	DUPAGE/KANE	421	117
PD-3		CONTRACT NO. 60122		
FED. ROAD DIST. NO. 1 ILLINOIS FED. AID PROJECT				