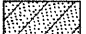
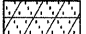

**PAVEMENT MARKING LEGEND:**

- TWO-WAY AMBER
- ONE-WAY AMBER
- ONE-WAY CRYSTAL

**LANDSCAPING LEGEND**

-  SEEDING, CLASS 2A
-  SEEDING, CLASS 4A (MODIFIED)
-  SEEDING, CLASS 4B

**NOTES:**

1. REFER TO DISTRICT 1 DETAILS "TYPICAL APPLICATIONS RAISED REFLECTIVE PAVEMENT MARKERS (SNOW-PLOW RESISTANT)" AND "TYPICAL PAVEMENT MARKING" FOR ADDITIONAL INFORMATION.
2. THE PROPOSED PAVEMENT MARKING SHALL BE PLACED IN THE SAME LOCATIONS AS THE EXISTING PAVEMENT MARKING OR AS DIRECTED BY THE ENGINEER.
3. THE SEEDING DATES FOR BARE EARTH SEEDING OF MIXTURE CLASS 4A (MODIFIED) SHALL BE FROM NOVEMBER 15 TO MARCH 15. ALL SEEDING NOT SOWN ACCORDING TO THE SPECIFIED SEASONAL DATE SHALL REQUIRE PRIOR WRITTEN APPROVAL FROM THE ENGINEER. FAILURE TO SECURE SUCH APPROVAL SHALL RESULT IN THE REJECTION OF THE SEEDING AND REPLACEMENT BY THE CONTRACTOR AT HIS/HER EXPENSE.

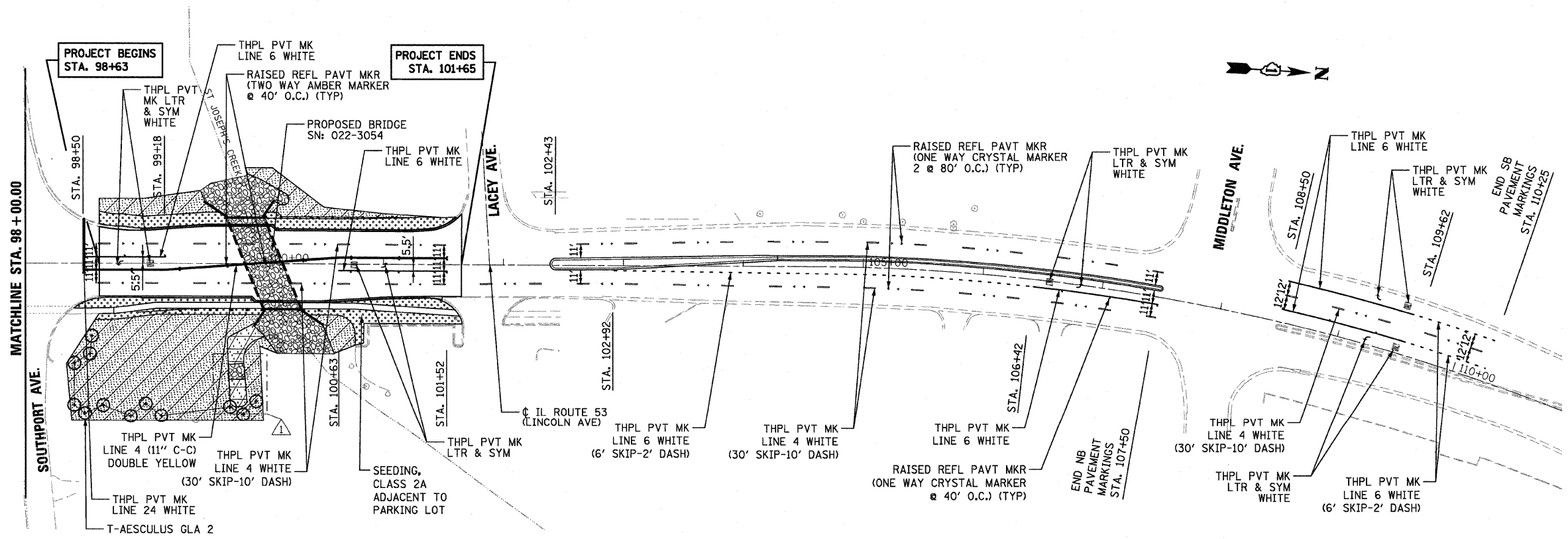
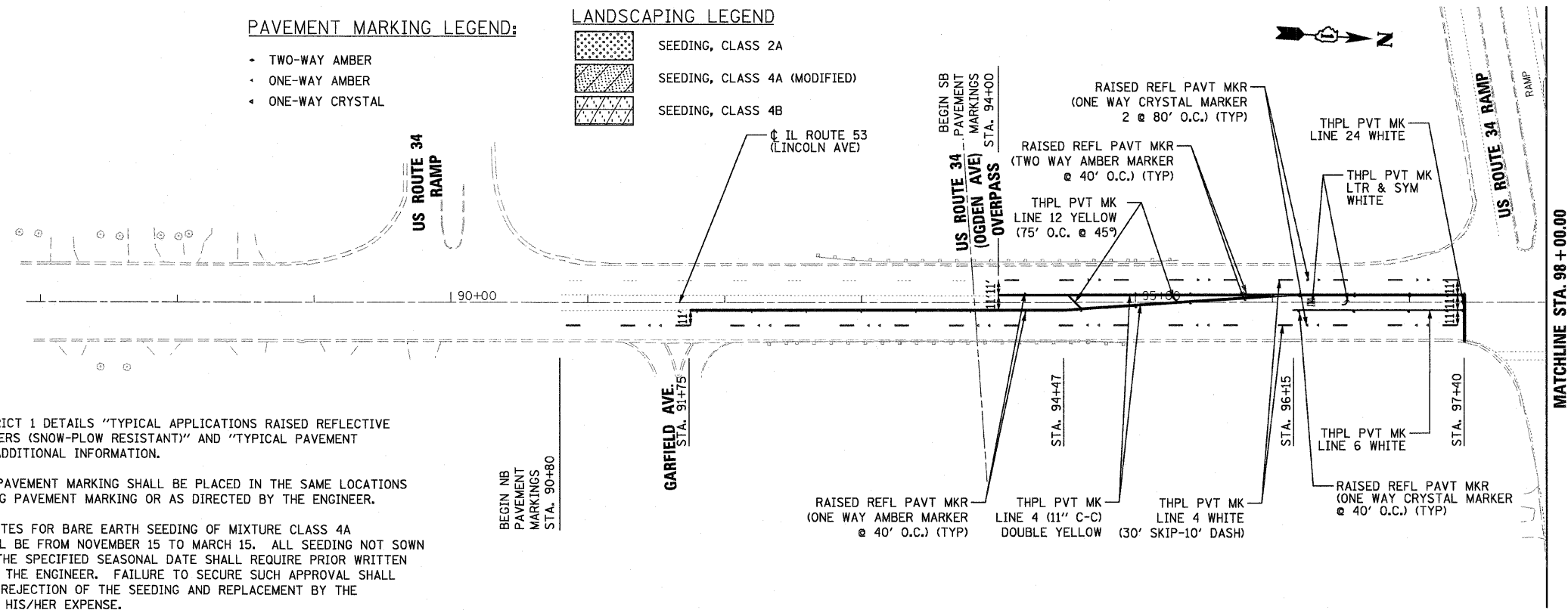

FILE NAME = ...\\D16M83-sht-pmk.dgn



DESIGNED - MHL  
 DRAWN - MHL  
 CHECKED - RJD  
 DATE - 12/12/2011

REVISED - 12/6/2011 N.W.S.  
 REVISED - 3/27/2012 JRB  
 REVISED -  
 REVISED -

**STATE OF ILLINOIS  
 DEPARTMENT OF TRANSPORTATION**

**IL ROUTE 53 OVER ST JOSEPH'S CREEK  
 PAVEMENT MARKING AND LANDSCAPING PLAN**

SCALE: 1" = 50' SHEET NO. 1 OF 1 SHEETS STA. 90+80 TO STA. 110+25

F.A.P. RTE. 870	SECTION 534R-B	COUNTY DuPAGE	TOTAL SHEETS 51	SHEET NO. 18
			CONTRACT NO. 60M83	
[ILLINOIS] FED. AID PROJECT				