

DATE	
BY	
SURVEYED	
PLOTTED	
DATE	
AREAS CHECKED	
NO.	

DATE	
BY	
SURVEYED	
PLOTTED	
DATE	
AREAS CHECKED	
NO.	

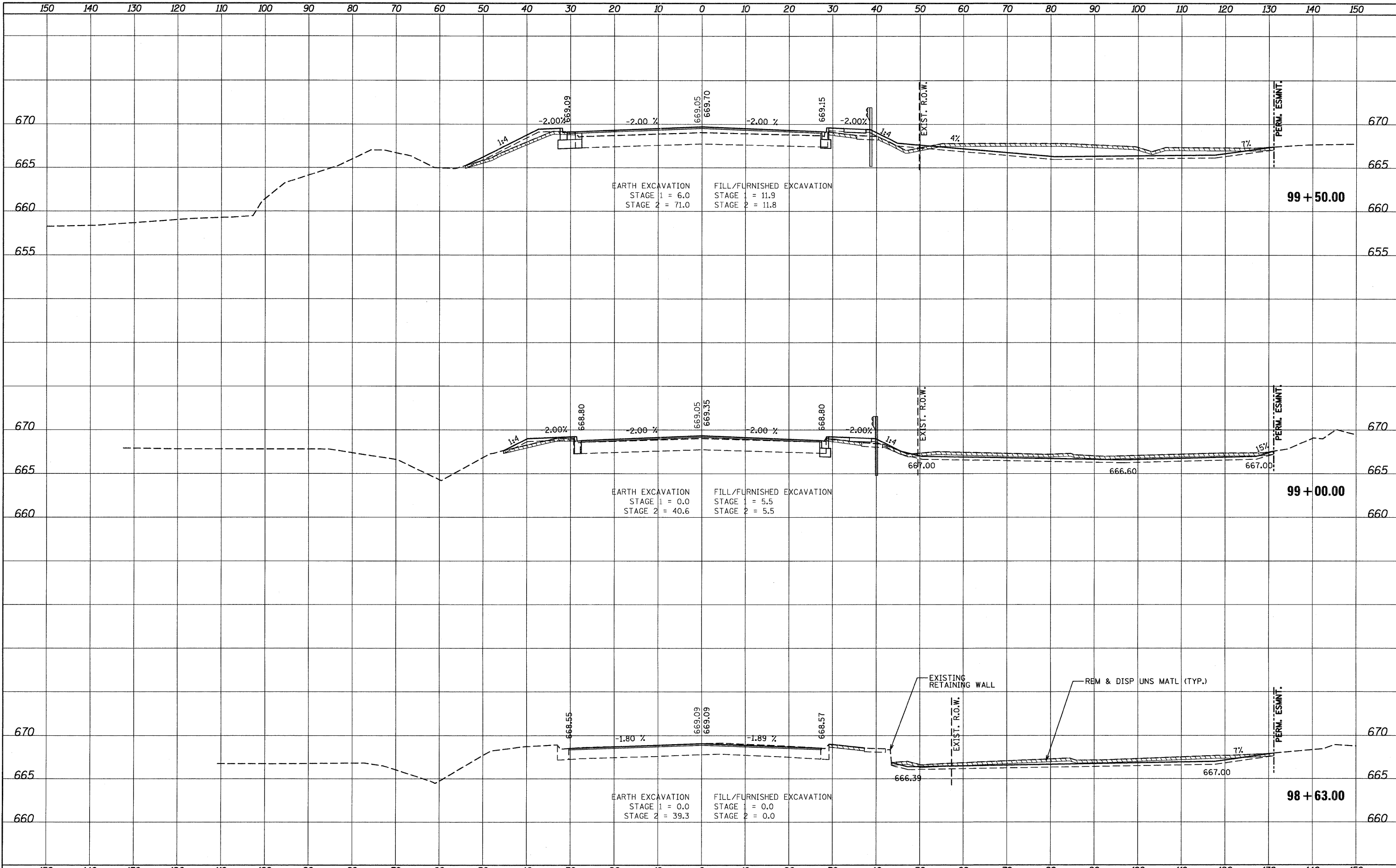

FILE NAME =
 ...\\D16083-ah-t-xssht.dgn



DESIGNED - ADW
 DRAWN - GEW
 CHECKED - RJD
 DATE - 10/4/2011

REVISED -
 REVISED -
 REVISED -
 REVISED -

STATE OF ILLINOIS
 DEPARTMENT OF TRANSPORTATION

IL ROUTE 53 OVER ST. JOSEPH'S CREEK
 CROSS SECTIONS

SCALE: SHEET NO. OF SHEETS STA. 98+63.00 TO STA. 99+50.00

F.A.P. RTE.	SECTION	COUNTY	TOTAL SHEETS	SHEET NO.
870	534R-B	DUPAGE	51	43
CONTRACT NO. 60M83			ILLINOIS FED. AID PROJECT	