

COPYRIGHT 2009 BY BAXTER & WOODMAN, INC. ...:Stondor-05.plt.dwg, v:04f-ED1.plt
 STATE OF ILLINOIS PROFESSIONAL DESIGN FIRM
 23LUKB
 4466E PM/7/2012 kcof-pbawood.com\nproj\jects\CT-system\Loc\LDOT\00053-40-Design\WP-27 IL-53 Signing\CADD-SURVEY\DRAWINGS\DGNS\00053-WO-27-SOUTH-SHT-FLN.dwg

GUIDE SIGN SEQUENCE NUMBERING CODE

EXAMPLE

NB - TR - 100 SIGN PANEL NUMBER

DIRECTION OF TRAFFIC

NB - NORTHBOUND I-290 (I-53)
 SB - SOUTHBOUND I-290 (I-53)
 R** - RAMPS AA - JH
 THR - THORNDALE AVENUE
 ROH - ROHLWING ROAD
 BIE - BIESTERFIELD ROAD
 HIG - HIGGINS ROAD (IL RT 72)
 EFR - E FRONTAGE ROAD
 WOD - WOODFIELD ROAD
 WFR - W FRONTAGE ROAD
 GLF - GOLF ROAD (IL RT 58)
 ALG - ALGONQUIN ROAD (IL RT 62)
 KIR - KIRCHOFF ROAD
 HIC - HICKS ROAD
 EUC - EUCLID ROAD
 NWH - NORTHWEST HWY (US 14)
 PAL - PALATINE ROAD

MOUNTING TYPE

TR - TRUSS
 CL - CANTILEVER
 TS - TELESCOPING STEEL POST
 WP - WOOD POST
 MP - METAL POST
 PM - POLE MOUNTED
 GM - GROUND MOUNTED

REMOVE AND REPLACE SIGN PANEL
 EXISTING LUMINAIRE TO BE REMOVED
 REMOVE SIGN PANEL & SUPPORT (NO REPLACEMENT)

* NEW SIGN PANEL AND SUPPORT(S)
 # REMOVE AND REPLACE SIGN PANEL WITH NEW SUPPORT(S)

USER NAME = 23lukb
 PLOT SCALE = 50.0000' / in.
 PLOT DATE = 3/7/2012

DESIGNED - DJS
 DRAWN - UKB
 CHECKED - RWL
 DATE - 12-13-11

REVISED -
 REVISED -
 REVISED -
 REVISED -

STATE OF ILLINOIS DEPARTMENT OF TRANSPORTATION

I-290 (IL-53) THORNDALE ROAD TO US 12 (RAND ROAD)

SCALE: 1"=50'

SHEET NO. OF SHEETS STA. TO STA.

F.A.I. RTE.	SECTION	COUNTY	TOTAL SHEETS	SHEET NO.
	2011-024-SG	DUPAGE/COOK	132	27
FED. ROAD DIST. NO. 1 ILLINOIS FED. AID PROJECT			CONTRACT NO. 60P24	

*F.A.I. 290 (INTERSTATE 290)
 *F.A.U. 342 (IL ROUTE 53)

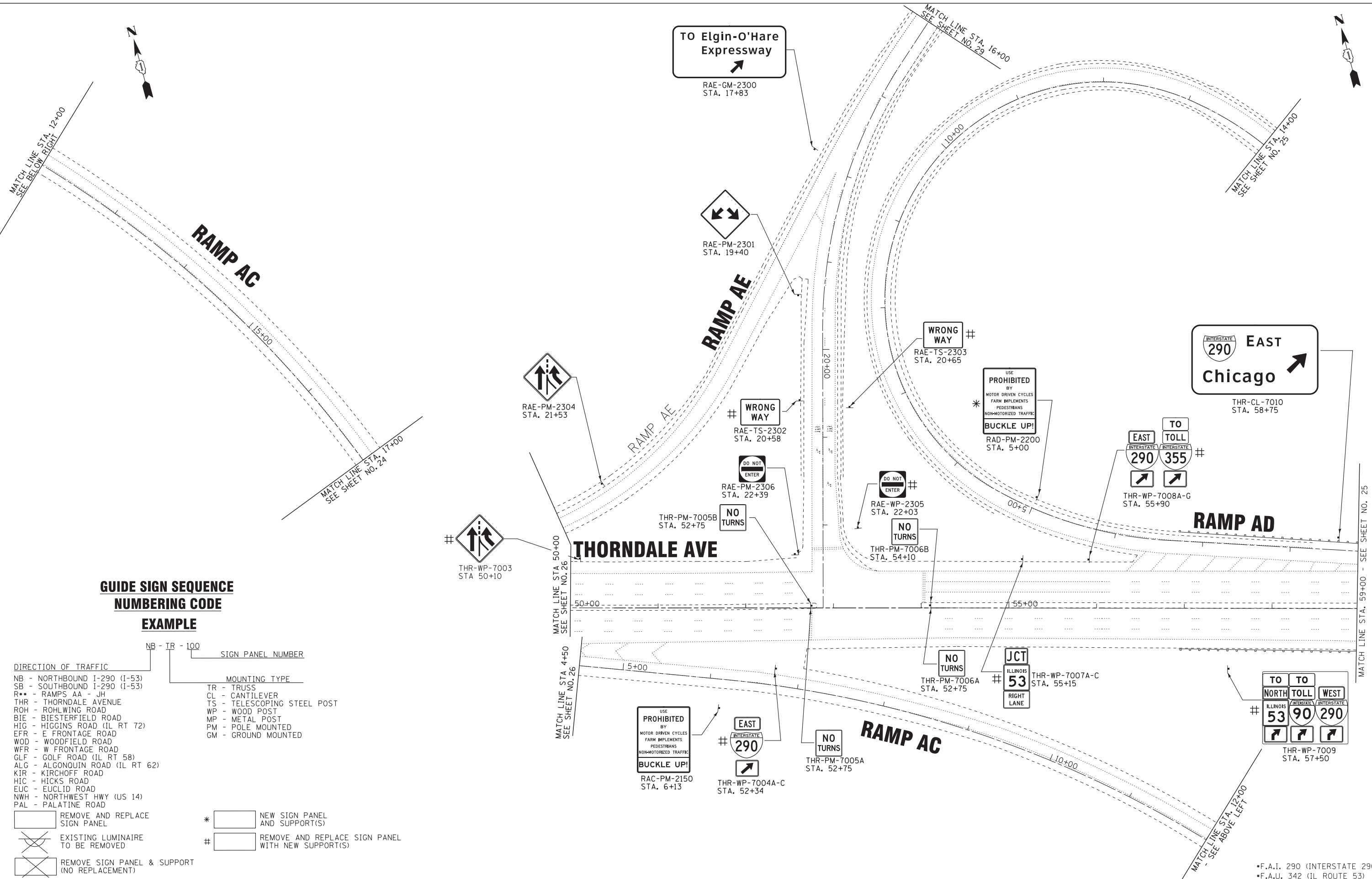

MATCH LINE STA. 59+00 - SEE SHEET NO. 25

MATCH LINE STA. 12+00 - SEE ABOVE LEFT