

- LEGEND**
- ① TEMPORARY CONCRETE BARRIER
  - ② PAVEMENT MARKING TAPE, TYPE III 4" (WHITE)
  - ③ WET REFLECTIVE TEMPORARY TAPE, TYPE III 5" (WHITE)  
10' DASH 30' SKIP
  - ④ PAVEMENT MARKING TAPE, TYPE III 4" (YELLOW)
  - ⑤ WET REFLECTIVE TEMPORARY TAPE, TYPE III 8" (WHITE)
  - ⑥ WET REFLECTIVE TEMPORARY TAPE, TYPE III 8" (YELLOW)
  - ⑦ PAVEMENT MARKING TAPE, TYPE III 12" (WHITE)  
30' OFFSET C-C (TYP.)
  - ⑧ IMPACT ATTENUATORS, TEMPORARY (FULLY REDIRECTIVE  
NARROW), TEST LEVEL 3

**NOTE:**  
EXISTING GUARDRAIL TO BE REMOVED  
AND REERECTED AS NEEDED FOR  
CONSTRUCTION ACCESS.

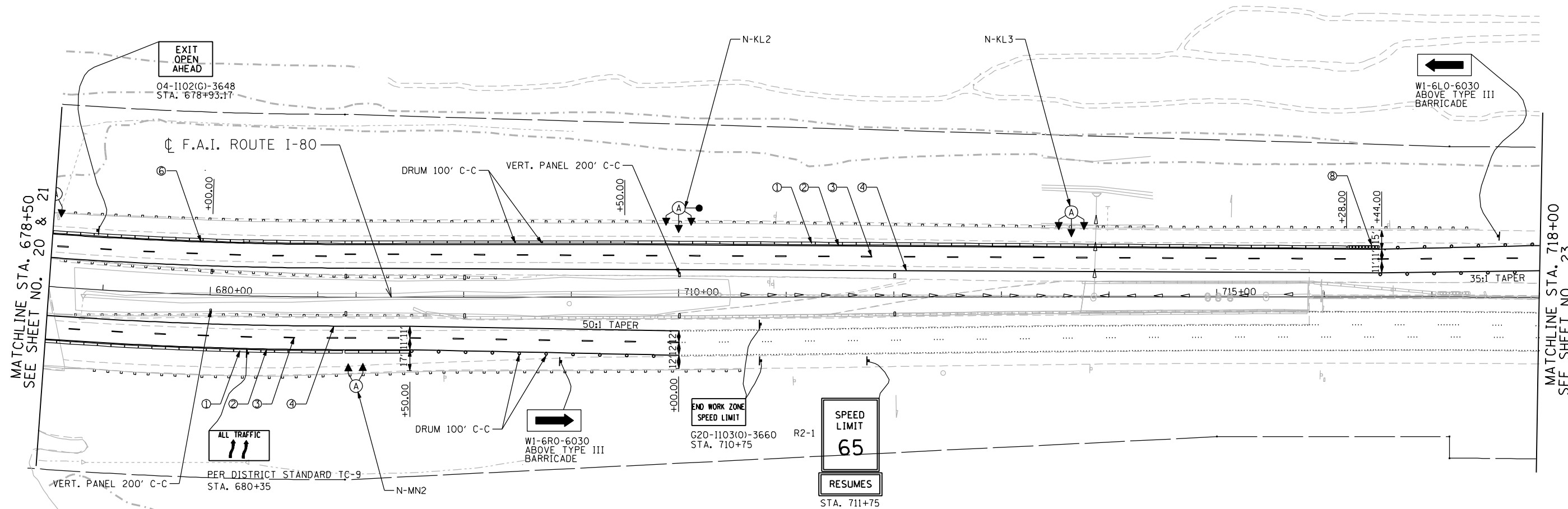
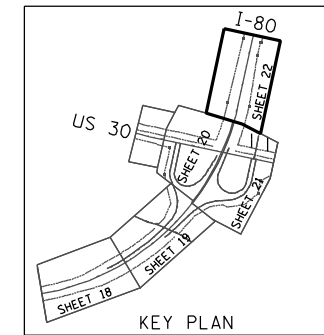

\\svr202\public\pco\10002384\006\_high\_mast\design\MOI\3384\_6\_US30\_High\_Mast.mcd05.dgn

**ENGINEERING CONSULTANT**  
  
**Corba Group, Inc.**  
 CONSULTING ENGINEERS  
 8007 North Cumberland Avenue, Suite 402  
 Chicago, Illinois 60630  
 Tel. 773.778.4008 Fax 773.778.4914  
 Email: info@corba.com

USER NAME = jk.jeilman	DESIGNED - JMK	REVISED -
PLLOT SCALE = 100.0000' / IN.	DRAWN - JMK	REVISED -
PLLOT DATE = 3/22/2012	CHECKED - MJL	REVISED -
	DATE - 02-14-2012	REVISED -

**STATE OF ILLINOIS  
DEPARTMENT OF TRANSPORTATION**

**F.A.I. ROUTE 80 AT U.S. ROUTE 30 LIGHTING  
STAGING AND TRAFFIC CONTROL PLAN**

SCALE: 1" = 50' SHEET NO. OF SHEETS STA. TO STA.

F.A.I. RTE. 80	SECTION 2011-046-L	COUNTY WILL	TOTAL SHEETS 106	SHEET NO. 22
ILLINOIS FED. AID PROJECT			CONTRACT NO. 60P56	