

- NOTES:**
1. THIS TEMPORARY LIGHTING IS ONLY NECESSARY IF THE RECONSTRUCTION OF THE I-80/US 30 INTERCHANGE OCCURS SIMULTANEOUSLY WITH THIS PROJECT.
 2. ONLY THE ITEMS SHOWN BOLD SHALL BE PART OF THE TEMPORARY LIGHTING SYSTEM.
 3. SEE LIGHTING PLAN FOR WOOD POLES TO REMAIN AFTER COMPLETION OF THIS CONTRACT.

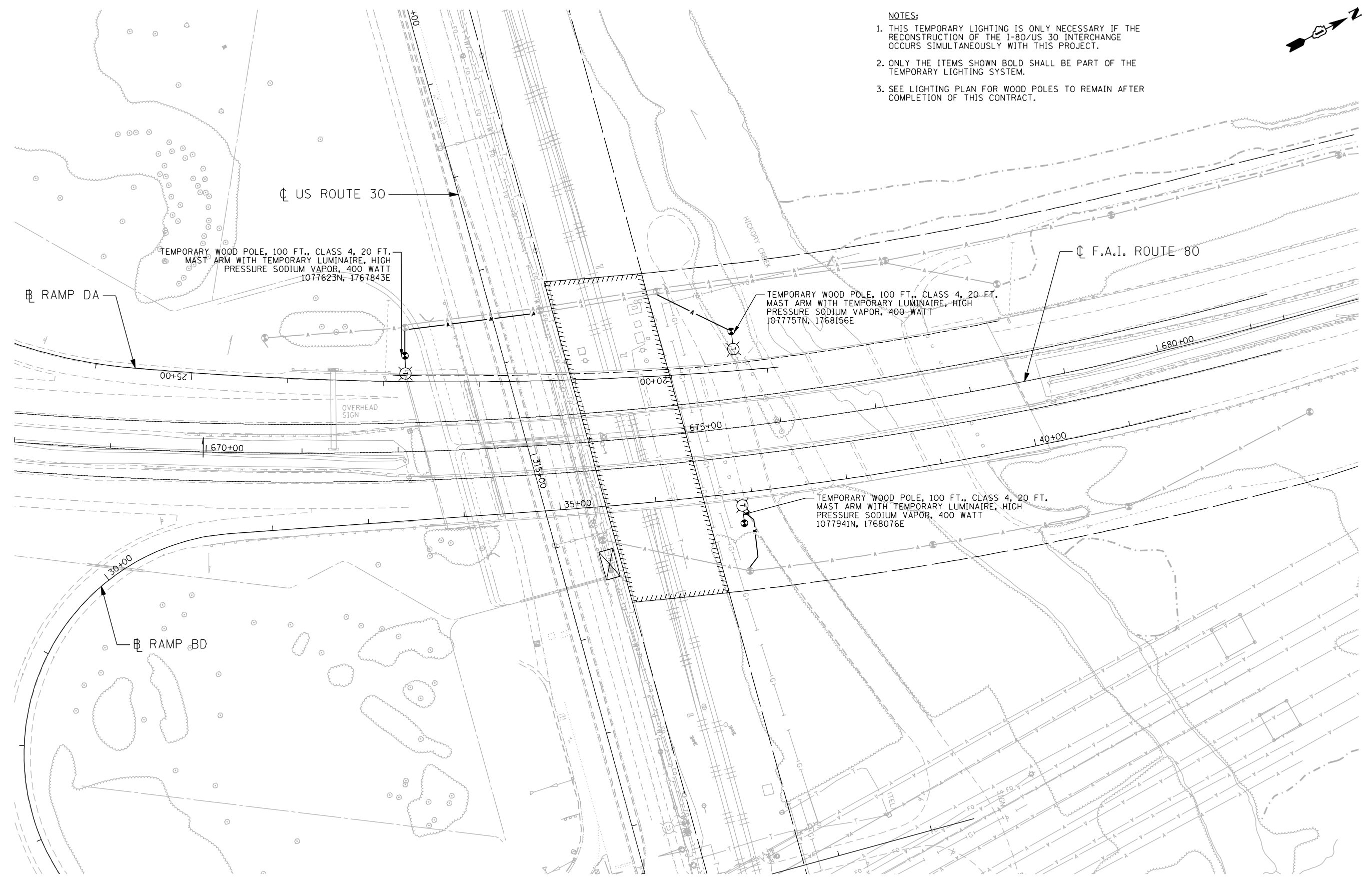

m:\proj\2009384\0016_high_mast_design\Lighting\384-L6_US30_High_Mast_Light_00_TempLight.dgn

ENGINEERING CONSULTANT
Ciorba Group, Inc.
 CONSULTING ENGINEERS
 8007 North Cumberland Avenue, Suite 402
 Chicago, Illinois 60638
 Tel. 773.778.4008 Fax 773.778.4914
 Email: ciorba@ciorba.com

USER NAME = jvandra
PLT SCALE = 100.0000' / IN.
PLT DATE = 2/13/2012

DESIGNED - RJR	DRAWN - RJR	CHECKED - JMV	DATE - 02-14-2012
----------------	-------------	---------------	-------------------

REVISED -	REVISED -	REVISED -	REVISED -
-----------	-----------	-----------	-----------

**STATE OF ILLINOIS
 DEPARTMENT OF TRANSPORTATION**

**F.A.I. ROUTE 80 AT U.S. ROUTE 30 LIGHTING
 TEMPORARY LIGHTING PLAN**

SCALE: 1" = 50' SHEET NO. OF SHEETS STA. TO STA.

F.A.I. RTE.	SECTION	COUNTY	TOTAL SHEETS	SHEET NO.
80	2011-046-L	WILL	106	26
CONTRACT NO. 60P56				
ILLINOIS FED. AID PROJECT				