

PLANS SHOW THE FUTURE RECONSTRUCTION AND WIDENING OF THE I-80 AT US 30 INTERCHANGE FOR INFORMATION PURPOSES ONLY.

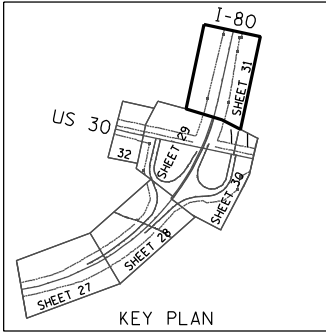

MATCHLINE STA. 678+50
SEE SHEET NO. 29 & 30

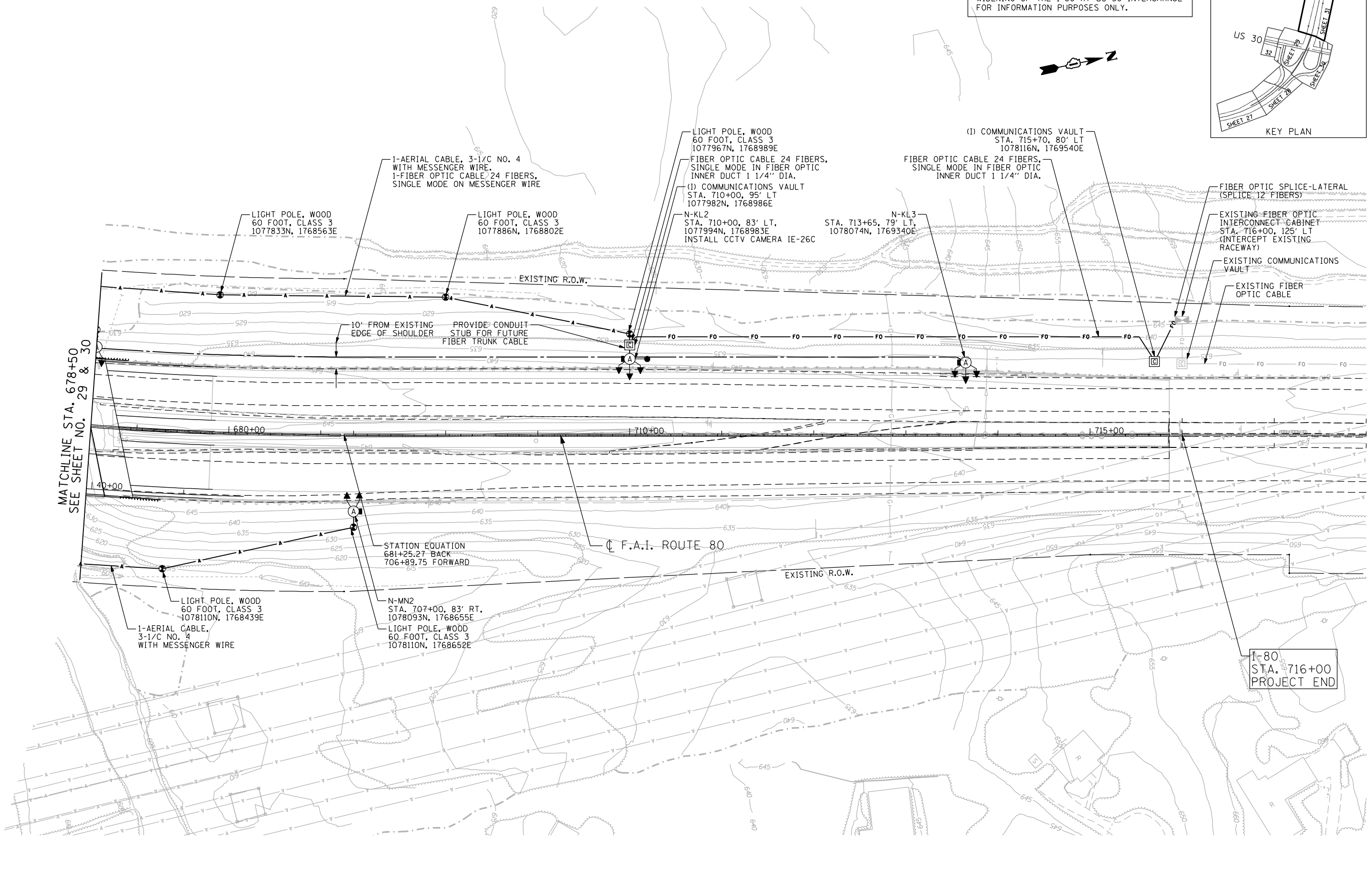

- 1-AERIAL CABLE, 3-1/C NO. 4 WITH MESSENGER WIRE. 1-FIBER OPTIC CABLE 24 FIBERS, SINGLE MODE ON MESSENGER WIRE
- LIGHT POLE, WOOD 60 FOOT, CLASS 3 1077833N, 1768563E
- LIGHT POLE, WOOD 60 FOOT, CLASS 3 1077886N, 1768802E
- 10' FROM EXISTING EDGE OF SHOULDER PROVIDE CONDUIT STUB FOR FUTURE FIBER TRUNK CABLE
- LIGHT POLE, WOOD 60 FOOT, CLASS 3 1077967N, 1768989E
- FIBER OPTIC CABLE 24 FIBERS, SINGLE MODE IN FIBER OPTIC INNER DUCT 1 1/4" DIA.
- (I) COMMUNICATIONS VAULT STA. 710+00, 95' LT 1077982N, 1768986E
- N-KL2 STA. 710+00, 83' LT, 1077994N, 1768983E INSTALL CCTV CAMERA IE-26C
- N-KL3 STA. 713+65, 79' LT, 1078074N, 1769340E
- (I) COMMUNICATIONS VAULT STA. 715+70, 80' LT 1078116N, 1769540E
- FIBER OPTIC CABLE 24 FIBERS, SINGLE MODE IN FIBER OPTIC INNER DUCT 1 1/4" DIA.
- FIBER OPTIC SPLICE-LATERAL (SPLICE 12 FIBERS)
- EXISTING FIBER OPTIC INTERCONNECT CABINET STA. 716+00, 125' LT (INTERCEPT EXISTING RACEWAY)
- EXISTING COMMUNICATIONS VAULT
- EXISTING FIBER OPTIC CABLE
- STATION EQUATION 681+25.27 BACK 706+89.75 FORWARD
- N-MN2 STA. 707+00, 83' RT, 1078093N, 1768655E
- LIGHT POLE, WOOD 60 FOOT, CLASS 3 1078110N, 1768652E
- 1-AERIAL CABLE, 3-1/C NO. 4 WITH MESSENGER WIRE
- LIGHT POLE, WOOD 60 FOOT, CLASS 3 1078110N, 1768439E
- I-80 STA. 716+00 PROJECT END



ENGINEERING CONSULTANT	USER NAME = jk.jeilman	DESIGNED - RJR	REVISED -
		DRAWN - RJR	REVISED -
	PLDT SCALE = 100.0000' / IN.	CHECKED - JMV	REVISED -
	PLDT DATE = 3/22/2012	DATE - 02-14-2012	REVISED -

**STATE OF ILLINOIS
DEPARTMENT OF TRANSPORTATION**

**F.A.I. ROUTE 80 AT U.S. ROUTE 30 LIGHTING
LIGHTING AND I.T.S. PLAN**

SCALE: 1" = 50' SHEET NO. OF SHEETS STA. TO STA.

F.A.I. RTE.	SECTION	COUNTY	TOTAL SHEETS	SHEET NO.
80	2011-046-L	WILL	106	31
			CONTRACT NO. 60P56	
ILLINOIS FED. AID PROJECT				

\\svr202\public\proj\10002384\006_high_mast\design\Lighting\3384_6_US30_high_mast_ligh105.dgn