

PLANS SHOW THE FUTURE RECONSTRUCTION AND WIDENING OF THE I-80 AT US 30 INTERCHANGE FOR INFORMATION PURPOSES ONLY.

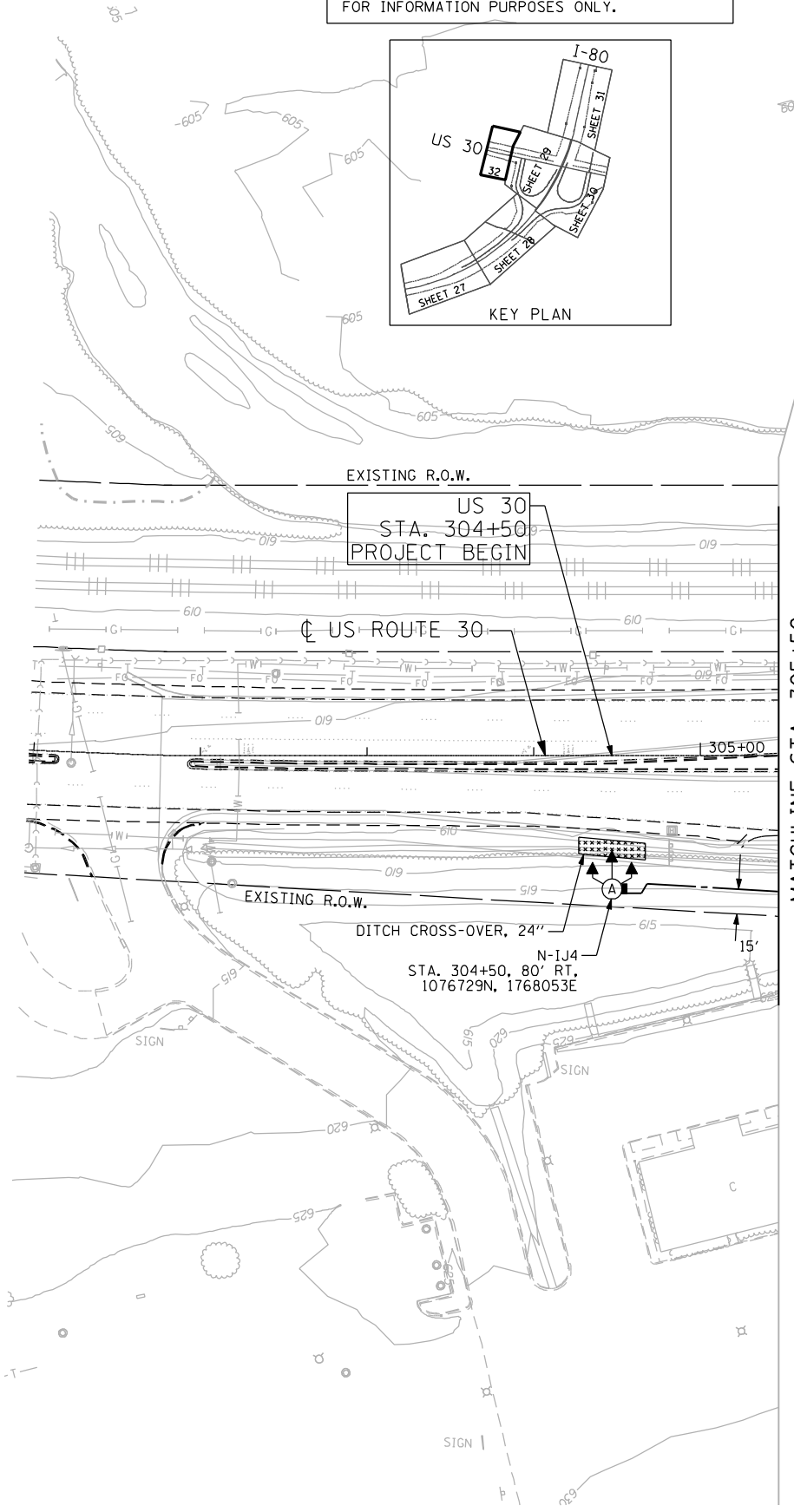
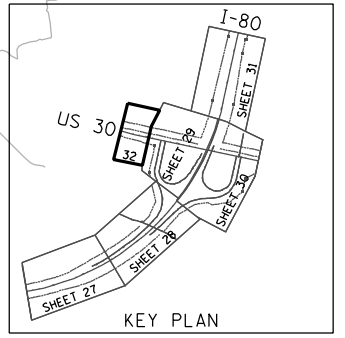

MATCHLINE STA. 305+50
SEE SHEET NO. 29

m:\proj\10003384.dwg\high_mast\design\Lighting\3384-6_US30_High_Mast_Light.dwg_3-5.dgn

ENGINEERING CONSULTANT
Ciorba Group, Inc.
 CONSULTING ENGINEERS
 8607 North Cumberland Avenue, Suite 402
 Chicago, Illinois 60636
 Tel. 773.778.4008 Fax 773.778.4914
 Email: ciorba@ciorba.com

USER NAME = jvandra
 PLDT SCALE = 100.0000' / IN.
 PLDT DATE = 2/13/2012

DESIGNED - RJR
 DRAWN - RJR
 CHECKED - JMV
 DATE - 02-14-2012

REVISED -
 REVISED -
 REVISED -
 REVISED -

**STATE OF ILLINOIS
 DEPARTMENT OF TRANSPORTATION**

**F.A.I. ROUTE 80 AT U.S. ROUTE 30 LIGHTING
 LIGHTING AND I.T.S. PLAN**

SCALE: 1" = 50' SHEET NO. OF SHEETS STA. TO STA.

F.A.I. RTE.	SECTION	COUNTY	TOTAL SHEETS	SHEET NO.
80	2011-046-L	WILL	106	32
CONTRACT NO. 60P56				
ILLINOIS FED. AID PROJECT				