

LOCATION 1

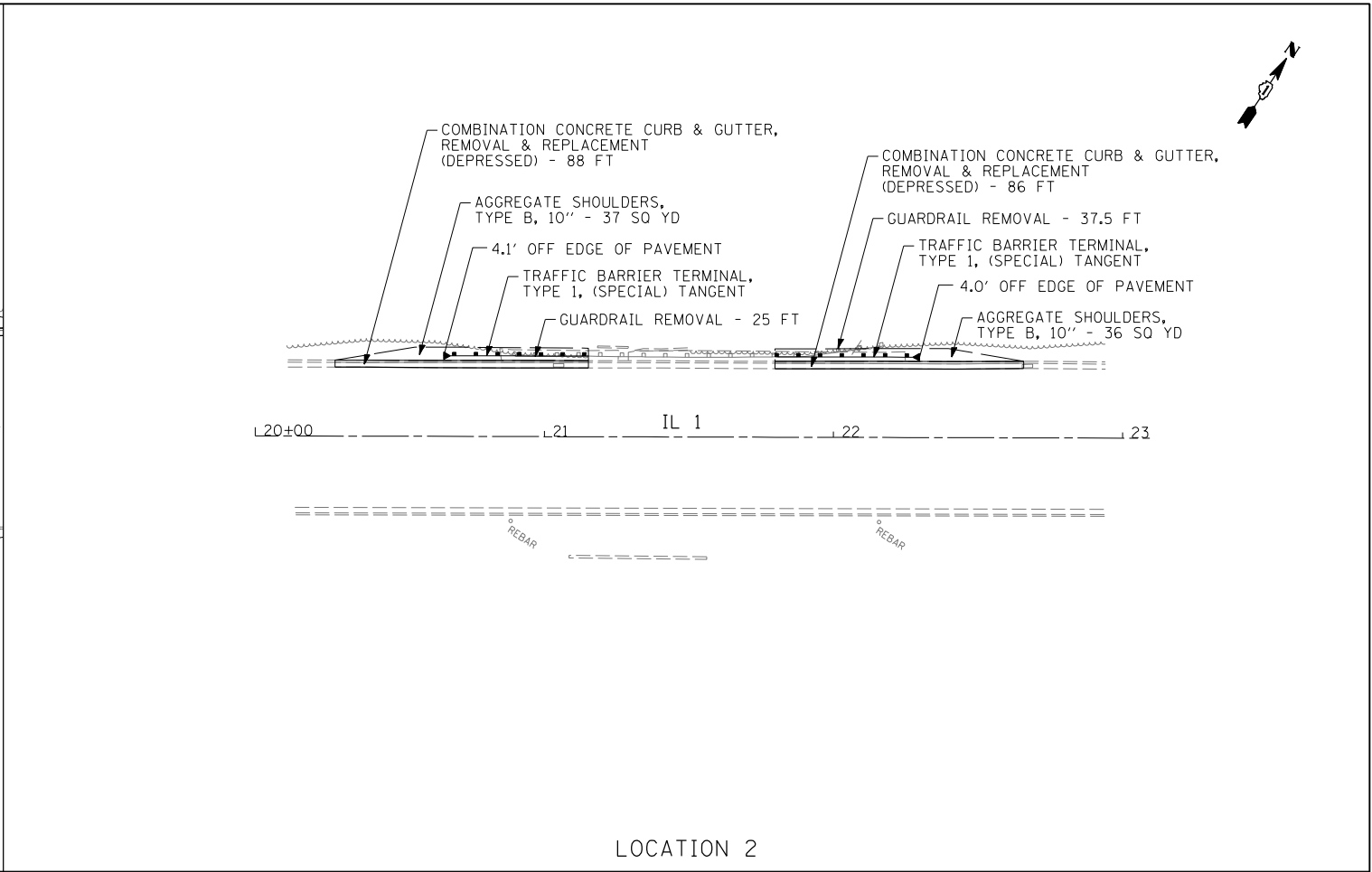

LOCATION 2

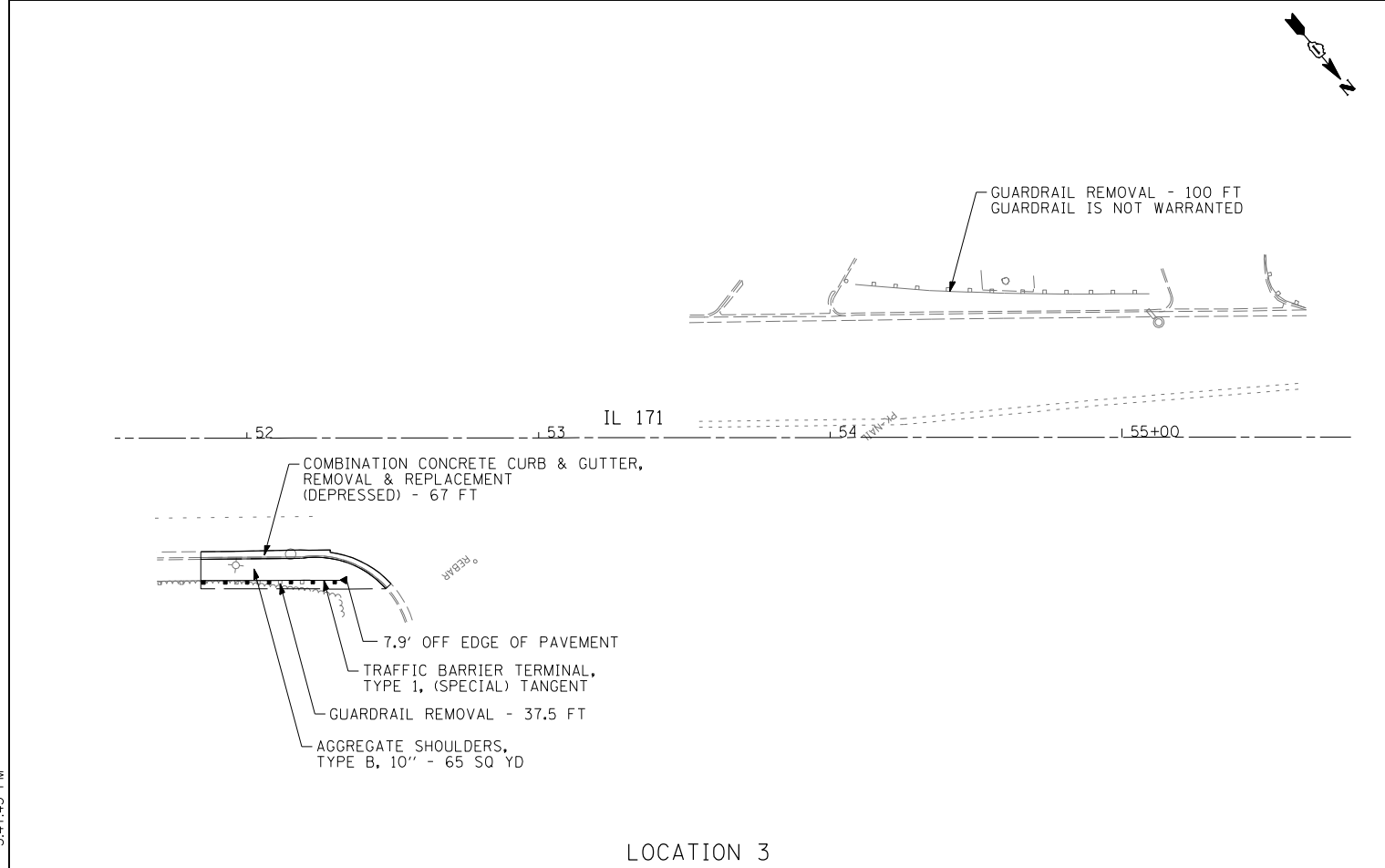

LOCATION 3

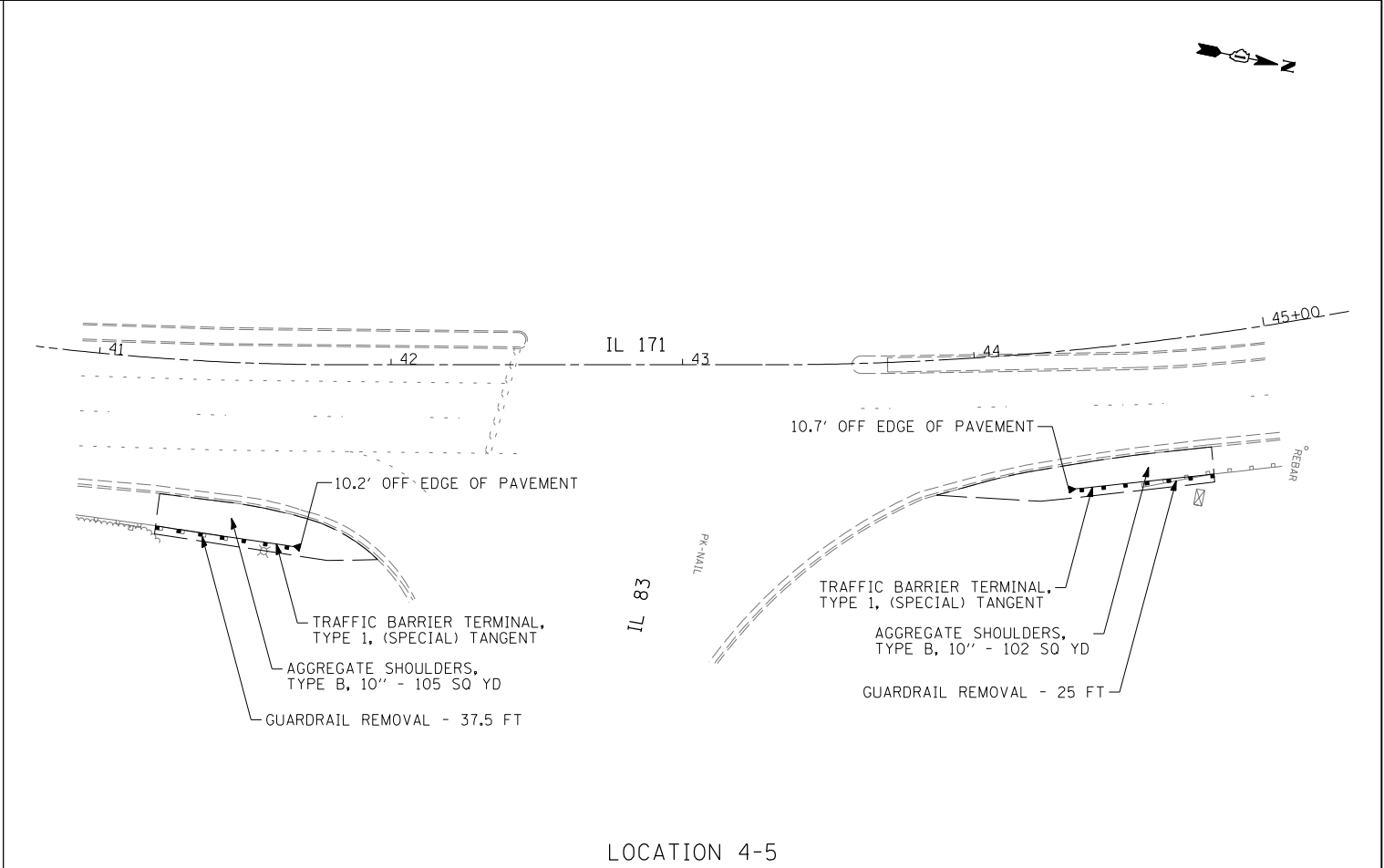

LOCATION 4-5

F:\jobs\2011\201103012-14\cod\site\dn\00\160R22-sht-plan01.dgn 2/6/2012 3:41:45 PM

| | | | |
|-------------|-----------------------------|-------------------|-----------|
| FILE NAME = | USER NAME = .USER. | DESIGNED - EAF | REVISED - |
| #FILE# | | DRAWN - EAF | REVISED - |
| | PLOT SCALE = 60.0000' / IN. | CHECKED - RS | REVISED - |
| | PLOT DATE = 2/6/2012 | DATE - 02-07-2012 | REVISED - |

**STATE OF ILLINOIS
DEPARTMENT OF TRANSPORTATION**

**GUARDRAIL IMPROVEMENTS - SOUTHERN COOK COUNTY
ROADWAY PLANS**

SCALE: 30 SHEET NO. 1 OF 22 SHEETS STA. TO STA.

| F.A. RTE. | SECTION | COUNTY | TOTAL SHEETS | SHEET NO. |
|---------------------------|----------------|--------------------|--------------|-----------|
| • | 2011-094-GRR | COOK | 30 | 5 |
| • | VARIOUS ROUTES | CONTRACT NO. 60R22 | | |
| ILLINOIS FED. AID PROJECT | | | | |