

F.A.P. RTE.	SECTION	COUNTY	TOTAL SHEETS	SHEET NO.
336	112R-N	McHENRY	266	215
STA.	TO STA.			
FED. ROAD DIST. NO.	ILLINOIS	FED. AID PROJECT		
CONTRACT NO. 62537				

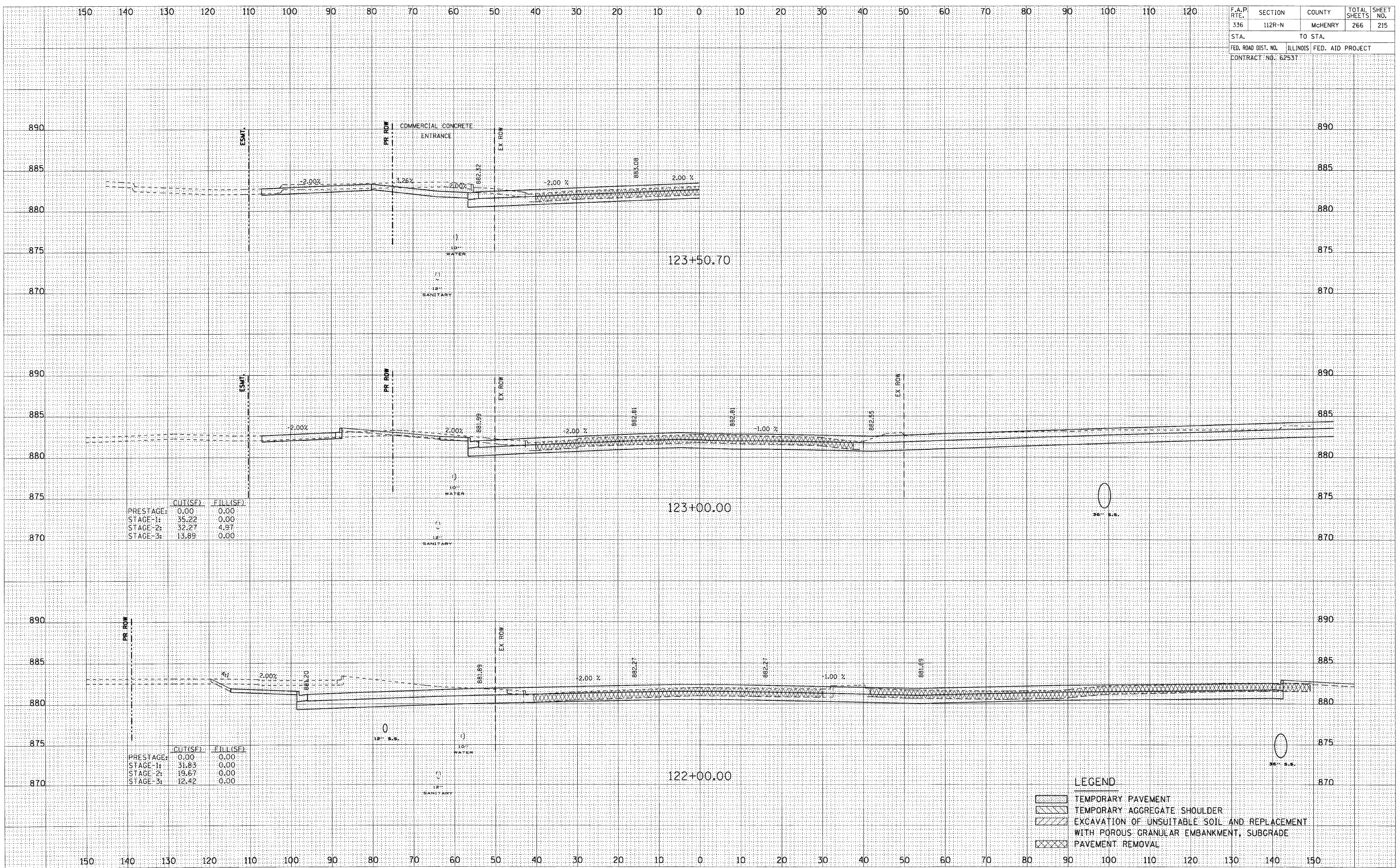

	CUT(SF)	FILL(SF)
PRESTAGE:	0.00	0.00
STAGE-1:	35.22	0.00
STAGE-2:	32.27	4.97
STAGE-3:	13.89	0.00

	CUT(SF)	FILL(SF)
PRESTAGE:	0.00	0.00
STAGE-1:	31.85	0.00
STAGE-2:	19.67	0.00
STAGE-3:	12.42	0.00

- LEGEND**
- TEMPORARY PAVEMENT
 - TEMPORARY AGGREGATE SHOULDER
 - EXCAVATION OF UNSUITABLE SOIL AND REPLACEMENT WITH POROUS GRANULAR EMBANKMENT, SUBGRADE
 - PAVEMENT REMOVAL

BY	DATE

BY	DATE