

F.A.P. RTE.	SECTION	COUNTY	TOTAL SHEETS	SHEET NO.
336	112R-N	McHENRY	266	263
STA. TO STA.		FED. ROAD DIST. NO. ILLINOIS FED. AID PROJECT		
CONTRACT NO. 62537				

DATE	
BY	
FINAL SURVEY	SUPERVED
NOTE BOOK	PLOTTED
	TEMPLATE
	AREAS CHECKED

DATE	
BY	
ORIGINAL SURVEY	SUPERVED
NOTE BOOK	PLOTTED
	TEMPLATE
	AREAS CHECKED

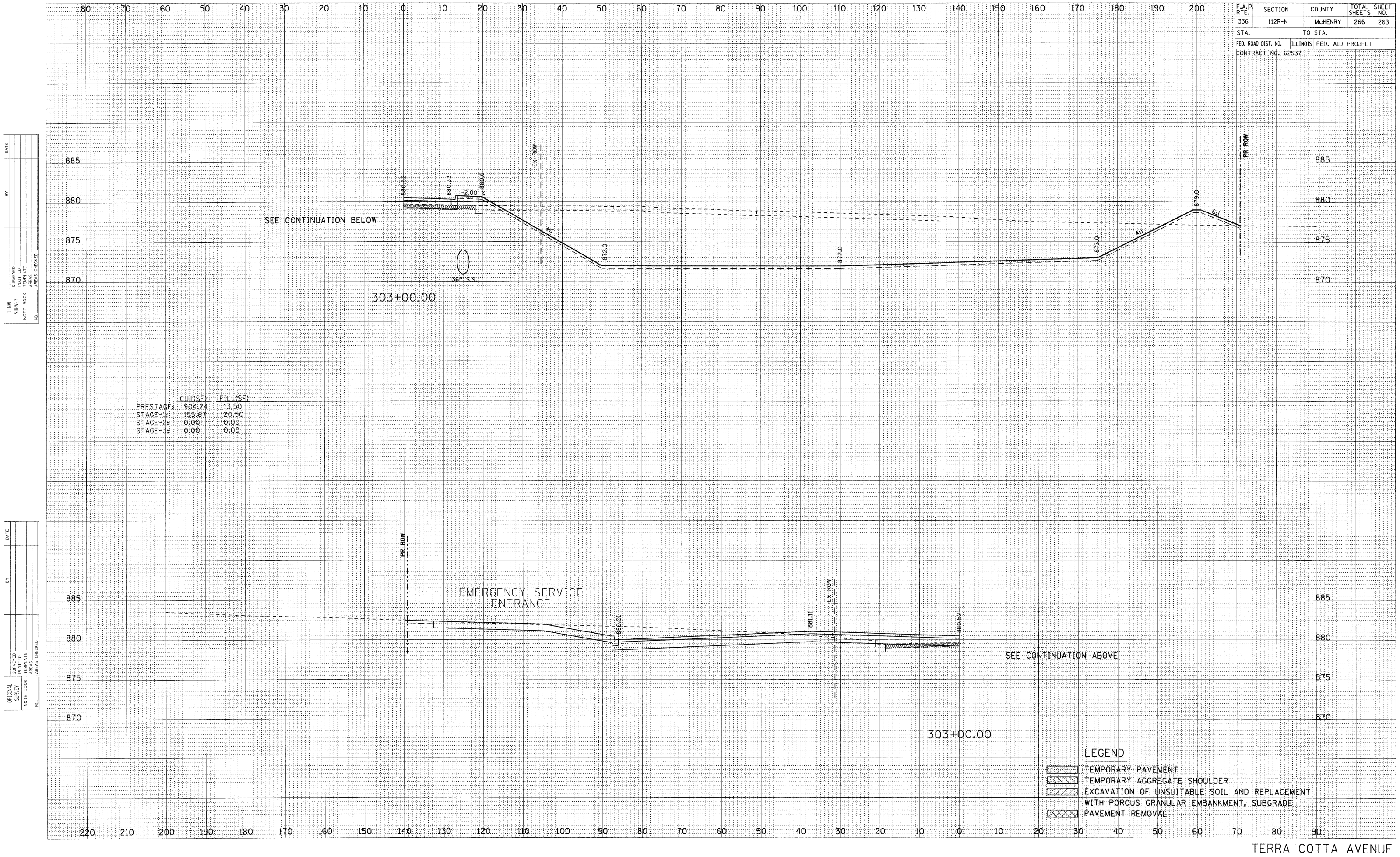



SEE CONTINUATION BELOW

SEE CONTINUATION ABOVE

	CUT(SF)	FILL(SF)
PRESTAGE	904.24	13.50
STAGE-1	155.87	20.50
STAGE-2	0.00	0.00
STAGE-3	0.00	0.00

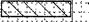
LEGEND

-  TEMPORARY PAVEMENT
-  TEMPORARY AGGREGATE SHOULDER
-  EXCAVATION OF UNSUITABLE SOIL AND REPLACEMENT WITH POROUS GRANULAR EMBANKMENT, SUBGRADE
-  PAVEMENT REMOVAL