

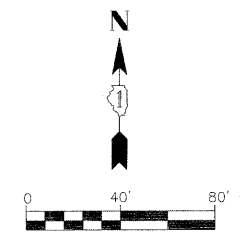

- SECTION LINE
- QUARTER SECTION LINE
- QUARTER, QUARTER SECTION LINE
- PLATTED LOT LINE
- PROPERTY (DEED) LINE
- APL APPARENT PROPERTY LINE
- CENTERLINE
- EXISTING RIGHT OF WAY LINE
- PROPOSED RIGHT OF WAY LINE
- PROPOSED EASEMENT
- MEASURED DIMENSION
- 129.32'(COMP.) COMPUTED DIMENSION
- () RECORD DATA
- EXISTING BUILDING

- IRON PIPE OR ROD FOUND ⊗ "MAG" NAIL SET
- + CUT CROSS FOUND OR SET ● ?" REBAR SET
- II THESE STAKES REFERENCE FOUND OR SET MONUMENTATION. SET ? INCH IRON ROD FLUSH WITH GROUND TO THE FOUND IRON STAKE. IDENTIFIED BY COLORED PLASTIC CAP BEARING SURVEYORS REGISTRATION NUMBER.
- 12
- 13 THESE STAKES, IN CULTIVATED AREAS, REFERENCE FOUND OR SET MONUMENTATION. BURIED ? INCH IRON ROD 20 INCHES BELOW GROUND TO THE FOUND IRON STAKE. IDENTIFIED BY COLORED PLASTIC CAP BEARING SURVEYORS REGISTRATION NUMBER.
- 811
- 812
- 813
- STAKING OF PROPOSED RIGHT OF WAY. SET DIVISION OF HIGHWAYS SURVEY MARKER TO MONUMENT THE POSITION SHOWN. IDENTIFIED BY INSCRIPTION DATA AND SURVEYORS REGISTRATION NUMBER.
- M STAKING OF PROPOSED RIGHT OF WAY IN CULTIVATED AREAS. BURIED ? INCH IRON ROD 20 INCHES BELOW GROUND TO MARK FUTURE SURVEY MARKER POSITION. IDENTIFIED BY COLORED PLASTIC CAP BEARING SURVEYORS
- PERMANENT SURVEY MARKER, I.D.O.T. STD 2135 (TO BE SET BY OTHERS). RIGHT OF WAY STAKING PROPOSED TO BE SET.

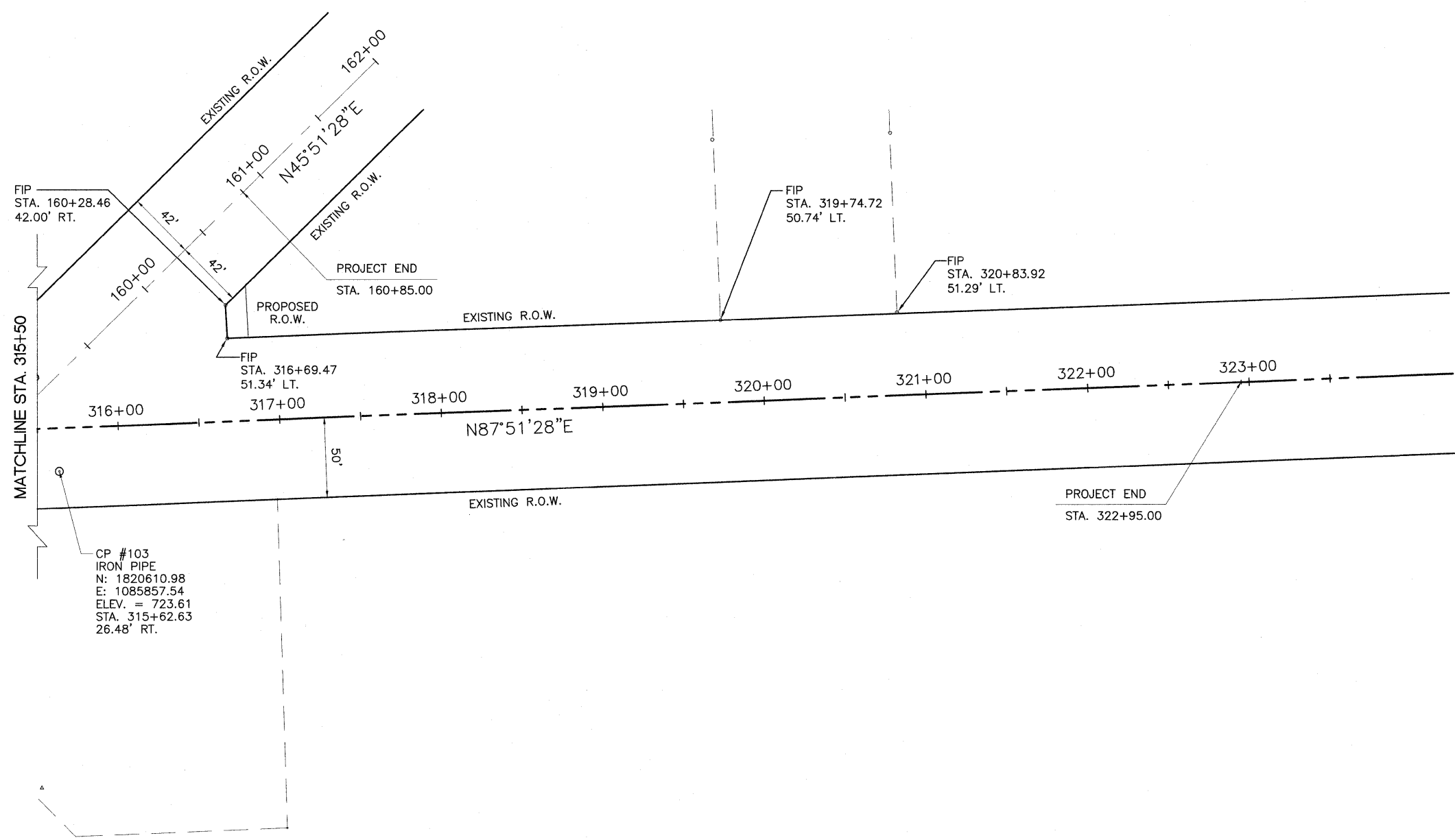

CMT
 CRAWFORD, MURPHY & TILLY, INC.
 CONSULTING ENGINEERS
 550 N. COMMONS DR., STE 116 AURORA, IL 60504
 (License No. 154-000613)

USER NAME =CMH	DESIGNED - CEW	REVISED -
PLOT SCALE =	DRAWN - CMH	REVISED -
PLOT DATE =03/11/10	CHECKED - CEW	REVISED -
	DATE - 03/11/10	REVISED -

**ILLINOIS DEPARTMENT OF TRANSPORTATION
ALIGNMENT AND TIES**

ROUTE: VILLAGE OF LEMONT/ MCGARTHY ROAD	SECTION: 27
SEC: 02-00055-00-WR	T 37 N, R 11 E OF 3RD P.M.
SCALE: 1"=50'	SHEET NO. 11 OF 79 SHEETS

COUNTY: COOK	JOB#
PROJECT#	
STA	TO STA
CONTRACT NO. 63557	

TOTAL SHEETS	SHEET NO.
84	13