

F. A. S. NO.	SECTION	COUNTY	TOTAL SHEETS	SHEET NO.
3596	11-00150-00-RS	COOK	11	1
STA. 10+00		TO STA. 50+74.26		
FED. ROAD DIST. NO.		ILLINOIS	FED. AID PROJECT TCSP-IL11(036)	

CONTRACT #63674

STATE OF ILLINOIS  
DEPARTMENT OF TRANSPORTATION  
DIVISION OF HIGHWAYS

# PLANS FOR PROPOSED FEDERAL AID HIGHWAY

STATE STREET (FAU 3596)  
LINCOLN AVENUE TO STATE-LINE ROAD (FAU 2947)  
RESURFACING

SECTION NO.: 11-00150-00-RS  
PROJECT NO.: TCSP-IL11(036)  
CITY OF CALUMET CITY  
COOK COUNTY  
JOB NO. C-91-099-12

### INDEX OF SHEETS

1. COVER SHEET, INDEX OF SHEETS & STATE STANDARDS
2. SUMMARY OF QUANTITIES & GENERAL NOTES
3. TYPICAL CROSS SECTIONS
4. PAVEMENT PLANS
5. PAVEMENT MARKING PLANS
- 6-11. IDOT DISTRICT 1 STANDARD DETAILS

### HIGHWAY STANDARDS

000001-06	STANDARD SYMBOLS, ABBREVIATIONS, AND PATTERNS
424001-06	PERPENDICULAR CURB RAMPS FOR SIDEWALKS
424006-00	DIAGONAL CURB RAMPS FOR SIDEWALKS
424011-00	CORNER PARALLEL CURB RAMPS FOR SIDEWALKS
424016-00	MID-BLOCK CURB RAMPS FOR SIDEWALKS
424021-00	DEPRESSED CORNER FOR SIDEWALKS
424026-00	ENTRANCE / ALLY PEDESTRIAN CROSSINGS
442201-03	CLASS C AND D PATCHES
606001-04	CONCRETE CURB TYPE AND COMBINATION CURB AND GUTTER
701501-06	URBAN LANE CLOSURE, 2L, 2W, UNDIVIDED
701701-08	URBAN LANE CLOSURE, MULTILANE INTERSECTION
701801-05	SIDEWALK, CORNER OR CROSSWALK CLOSURE
701901-02	TRAFFIC CONTROL DEVICES
780001-03	TYPICAL PAVEMENT MARKINGS
781001-03	TYPICAL APPLICATIONS RAISED REFLECTIVE PAVEMENT MARKERS

	STATE STREET
2011 ADT -	10,900
2030 ADT -	10,900
POSTED SPEED LIMIT -	30 mph
DESIGN PERIOD -	20 YEARS
DESIGN SPEED LIMIT -	30 mph
STREET CLASSIFICATION -	CLASS III

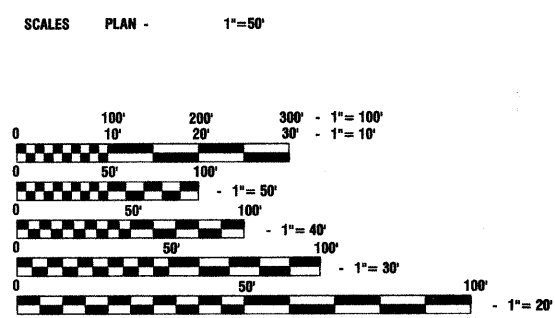

FULL SIZE PLANS HAVE BEEN PREPARED USING STANDARD ENGINEERING SCALES, REDUCED SIZED PLANS WILL NOT CONFORM TO STANDARD SCALES, IN MAKING MEASUREMENTS ON REDUCED PLANS, THE ABOVE SCALES MAY BE USED.

J. U. L. I. E.  
JOINT UTILITY LOCATION INFORMATION FOR EXCAVATION  
1-800-892-0123 or 811

CONTRACT NO. 63674

PROGRAM AND OFFICE ENGINEER: CHARLES F. RIDDLE, P.E. (847) 705-4406, SCHAUMBURG, IL  
CONSULTANTS: ROBINSON ENGINEERING, LTD. 708-331-6700

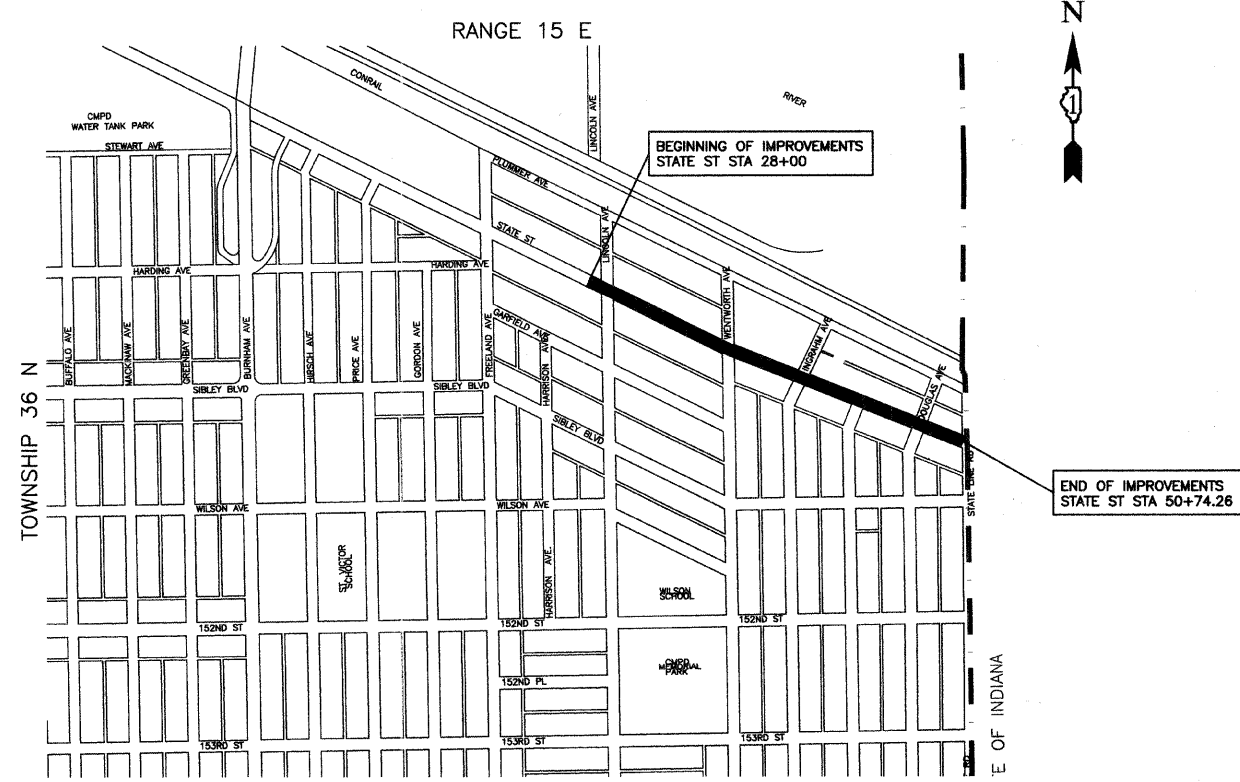
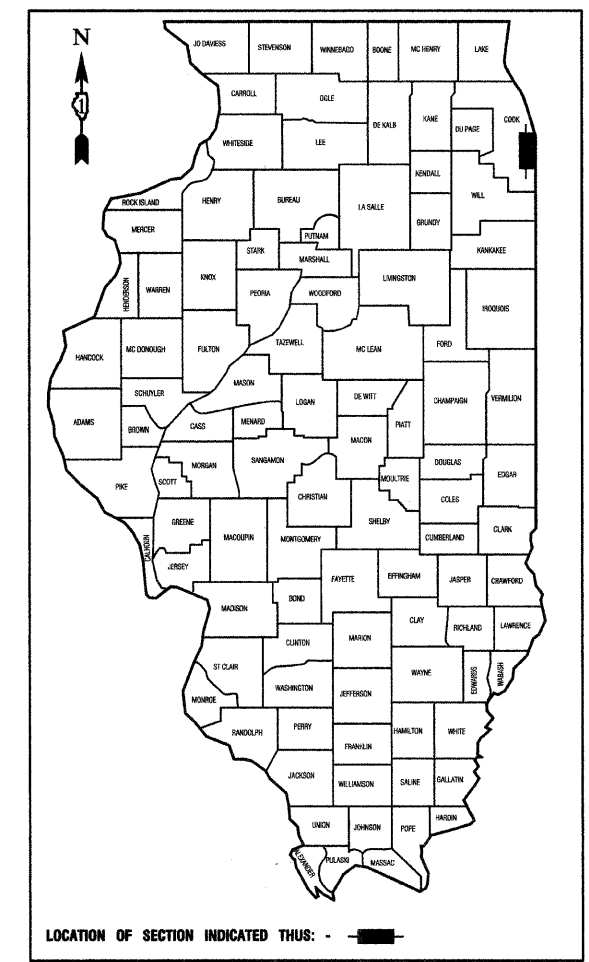

**LOCATION MAP**  
GROSS LENGTH=2,274 FEET=0.43 MILES  
NET LENGTH=2,274 FEET=0.43 MILES

STATE OF ILLINOIS DEPARTMENT OF TRANSPORTATION  
DIVISION OF HIGHWAYS

Approved: January 20, 2012  
*Michelle M. Murray*  
Mayor, City of Calumet City

Passed: FEBRUARY 14, 2012  
*C. H. CHOI*  
District 1 Engineer of Local Roads & Streets

Released for Bid Based on Limited Review: FEBRUARY 14, 2012  
*Diana M. O'Keefe*  
Deputy Director of Highways, Region 1 Engineer

PRINTED BY THE AUTHORITY OF THE STATE OF ILLINOIS

PREPARED BY OR UNDER THE DIRECT SUPERVISION OF:  
*[Signature]*  
02/03/12  
LICENSE EXPIRES: 11/30/13

