

DEMOLITION LEGEND

- PAVEMENT REMOVAL
- SIDEWALK REMOVAL
- REMOVE AND REPLACE BRICK PAVEMENT DRIVEWAY
- HOT-MIX ASPHALT SURFACE REMOVAL, 2"
- STRUCTURE REMOVAL
- CATCH BASIN REMOVAL
- INLET REMOVAL
- COMBINATION CURB AND GUTTER REMOVAL
- FULL DEPTH SAW CUT

GRAPHIC SCALE

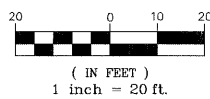

N



PLAN LEGEND

- HMA PAVEMENT HOT-MIX ASPHALT SURFACE COURSE, MIX D, NSD
- PORTLAND CEMENT CONCRETE BASE COURSE, 10"
- HMA RESURFACING HOT-MIX ASPHALT SURFACE COURSE, MIX D, NSD
- DRIVEWAY PAVEMENT 3"
- CONCRETE SIDEWALK PORTLAND CEMENT CONCRETE SIDEWALK, 5" & 8"
- COLORED CONCRETE SIDEWALK 5" PCC RED CONCRETE
- REMOVE AND REPLACE BRICK PAVEMENT DRIVEWAY
- COMB. CC&G TYPE B-6.12
- DEPRESSED CURB & GUTTER
- DETECTABLE WARNINGS

DRAINAGE & UTILITY PLAN LEGEND

- EXISTING COMBINED STRUCTURE
- EXISTING COMBINED SEWER
- EXISTING WATERMAIN STRUCTURE
- EXISTING WATERMAIN
- EXISTING STORM SEWER STRUCTURE
- EXISTING STORM SEWER
- PROPOSED STORM SEWER STRUCTURE
- PROPOSED STORM SEWER
- PROPOSED STORM SEWER PIPE
- PROPOSED STORM SEWER CATCHBASIN
- PROPOSED STORM SEWER INLET

GRAPHIC SCALE

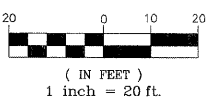

N

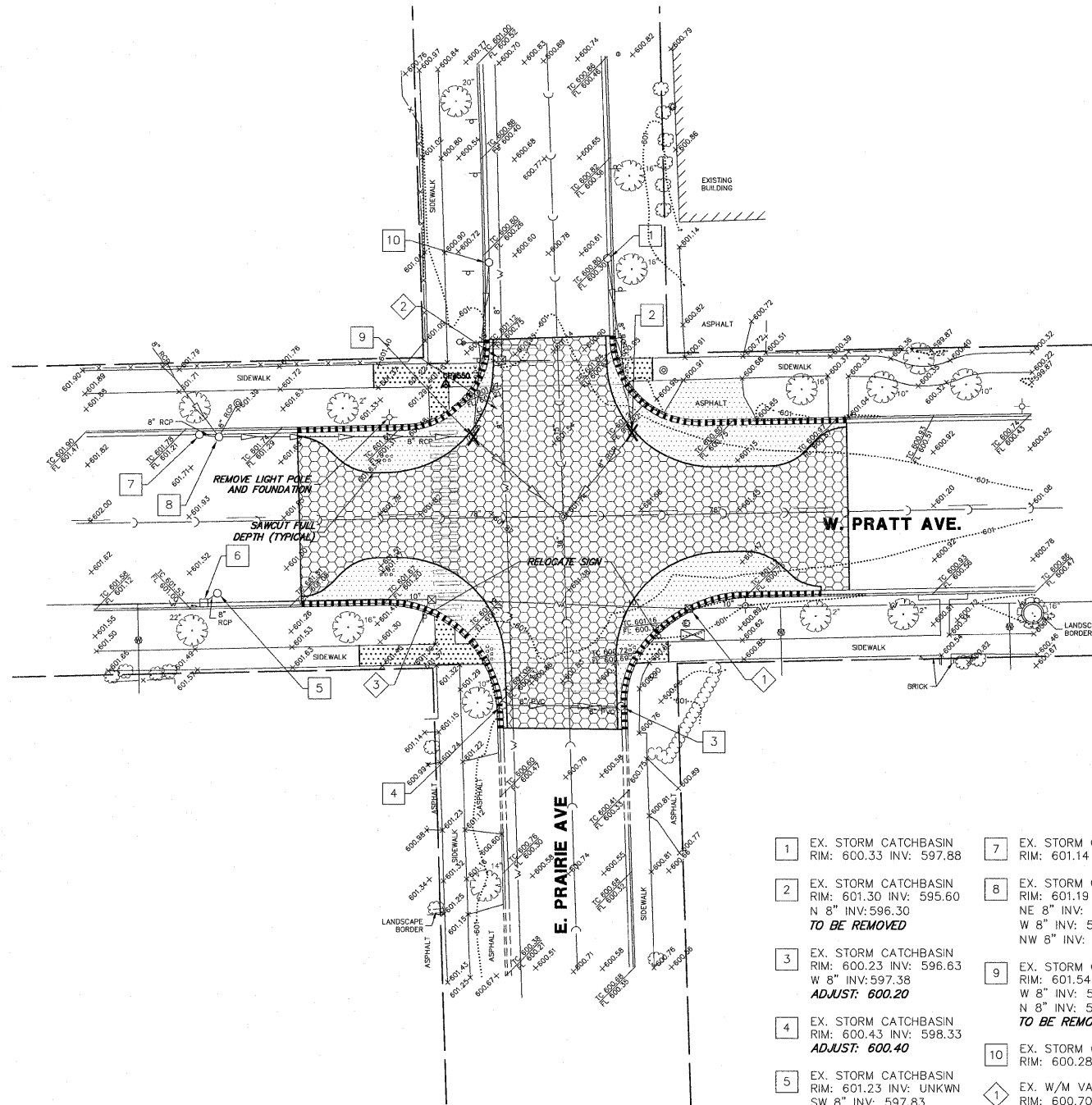

DEMOLITION PLAN

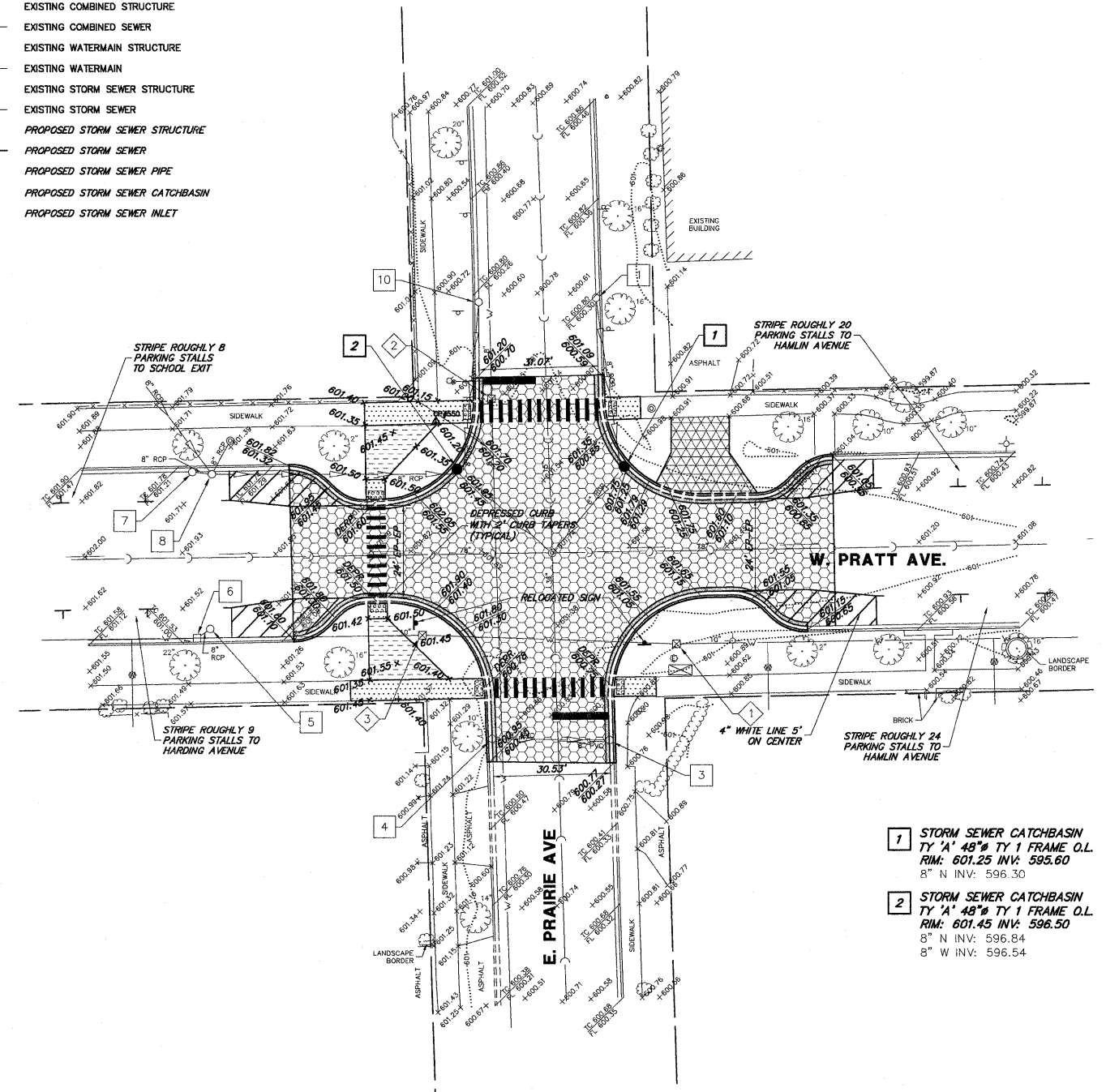

GEOMETRIC/GRADING PLAN

- | | |
|------------------------------------------------------------------------------------------------|------------------------------------------------------------------------------------------------------------------|
| 1 EX. STORM CATCHBASIN
RIM: 600.33 INV: 597.88 | 7 EX. STORM CATCHBASIN
RIM: 601.14 INV: 598.79 |
| 2 EX. STORM CATCHBASIN
RIM: 601.30 INV: 595.60
N 8" INV: 596.30
TO BE REMOVED | 8 EX. STORM CATCHBASIN
RIM: 601.19 INV: UNKWN
NE 8" INV: 598.19
W 8" INV: 598.24
NW 8" INV: 598.24 |
| 3 EX. STORM CATCHBASIN
RIM: 600.23 INV: 596.63
W 8" INV: 597.38
ADJUST: 600.20 | 9 EX. STORM CATCHBASIN
RIM: 601.54 INV: UNKWN
W 8" INV: 596.54
N 8" INV: 596.84
TO BE REMOVED |
| 4 EX. STORM CATCHBASIN
RIM: 600.43 INV: 598.33
ADJUST: 600.40 | 10 EX. STORM CATCHBASIN
RIM: 600.28 INV: 597.78 |
| 5 EX. STORM CATCHBASIN
RIM: 601.23 INV: UNKWN
SW 8" INV: 597.83 | 1 EX. W/M VALVE VAULT
RIM: 600.70 T/P: 595.80
ADJUST: 601.20 |
| 6 EX. STORM CATCHBASIN
RIM: 601.00 INV: 597.95 | 2 EX. W/M VALVE VAULT
RIM: 600.95 T/P: 595.60 |
| | 3 EX. W/M VALVE VAULT
RIM: 601.24 T/P: 595.34
ADJUST: 601.55 |

- | |
|---------------------------------------------------------------------------------------------------------------------------|
| 1 STORM SEWER CATCHBASIN
TY 'A' 48" TY 1 FRAME O.L.
RIM: 601.25 INV: 595.60
8" N INV: 596.30 |
| 2 STORM SEWER CATCHBASIN
TY 'A' 48" TY 1 FRAME O.L.
RIM: 601.45 INV: 596.50
8" N INV: 596.84
8" W INV: 596.54 |

FILE NAME = 9232.386 PR-2 (IDOT).dwg

USER NAME = BJW
PLOT SCALE = 1:1
PLOT DATE = 2/2/2012

DESIGNED - BJW
DRAWN - BJW
CHECKED - SDB
DATE - 12/9/2011

REVISED - BJW - 2/2/2012
REVISED - BJW - 2/21/2012
REVISED -
REVISED -

**STATE OF ILLINOIS
DEPARTMENT OF TRANSPORTATION**

**VILLAGE OF LINCOLNWOOD - SAFE ROUTE TO SCHOOLS
PRATT & EAST PRAIRIE TRAFFIC CALMING**

SCALE 1"=20' SHEET NO. 5 OF 8 SHEETS STA. N/A TO STA. N/A

FAU RTE.	SECTION	COUNTY	TOTAL SHEETS	SHEET NO.
1353	10-00055-00-SP	COOK	8	5
CONTRACT #: 63685				
ILLINOIS FED. AID PROJECT				