

FOR INDEX OF SHEETS, SEE SHEET NO. 2

FOR INDEX OF HIGHWAY STANDARDS, SEE SHEET NO. 2

PROJECT LOCATED IN THE VILLAGE OF RICHTON PARK

STATE OF ILLINOIS  
 DEPARTMENT OF TRANSPORTATION  
 DIVISION OF HIGHWAYS  
**PLANS FOR PROPOSED  
 FEDERAL AID HIGHWAY**  
 FAU 1682 (POPLAR AVENUE)  
 CICERO AVENUE TO GOVERNOR'S HIGHWAY  
 RESURFACING  
 PROJECT No.: M-9003(976)  
 VILLAGE OF RICHTON PARK  
 SECTION 11-00053-00-RS  
 COOK COUNTY  
 JOB No.: C-91-319-12

F.A.U. RTE.	SECTION	COUNTY	TOTAL SHEETS	SHEET NO.
1682	11-00053-00-RS	COOK	15	1
STA.	TO STA.			
FED. ROAD DIST. NO.	ILLINOIS	FED AID PROJECT		
CONTRACT NO. 63691				

**TRAFFIC DATA**

POPLAR AVENUE  
 POSTED SPEED LIMIT = 25 MPH  
 DESIGN SPEED LIMIT = 25 MPH  
 2011 ADT = 1,100 VPD

**DESIGN DESIGNATION**

COLLECTOR



FAU 1682 POPLAR AVENUE  
 OMISSION BEGINS  
 STA 58+72

FAU 1682 POPLAR AVENUE  
 IMPROVEMENTS BEGIN  
 STA 10+50

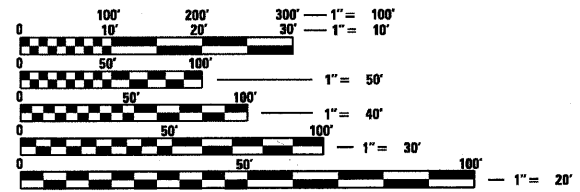
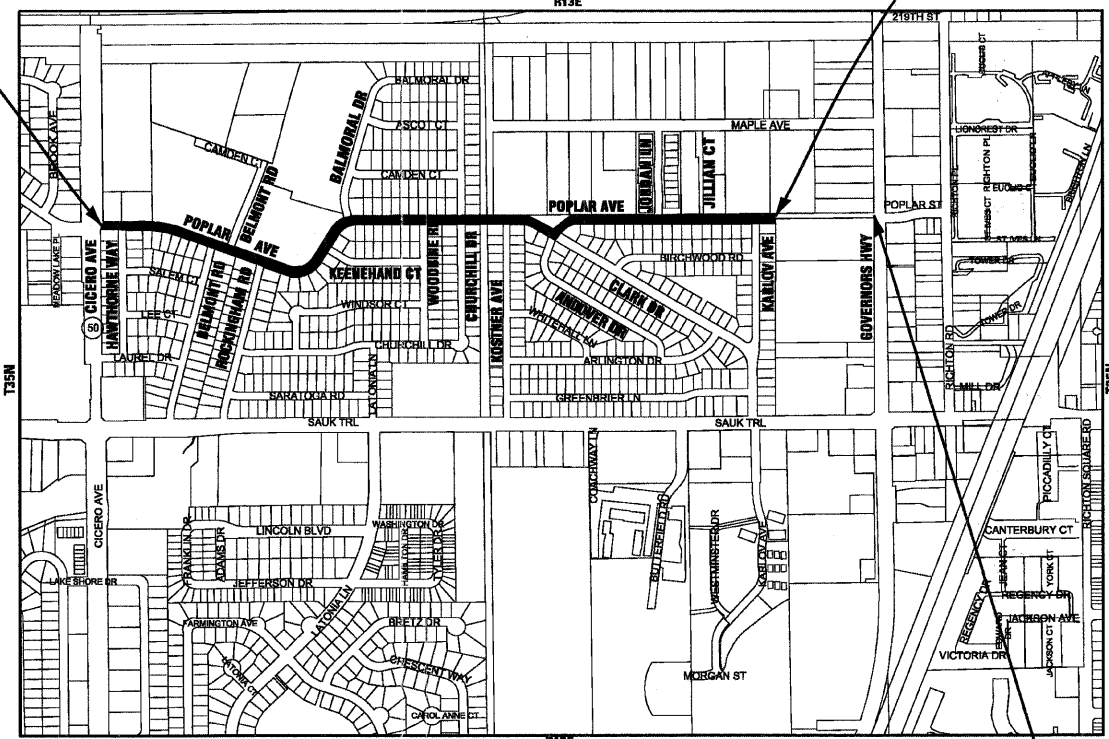

FULL SIZE PLANS HAVE BEEN PREPARED USING STANDARD ENGINEERING SCALES. REDUCED SIZED PLANS WILL NOT CONFORM TO STANDARD SCALES. IN MAKING MEASUREMENTS ON REDUCED PLANS, THE ABOVE SCALES MAY BE USED.

JULI.E. DESIGN STAGE REQUEST  
 DIG. No. X3351154



CONTACT JULIE AT 811 OR 800-892-0123 WITH THE FOLLOWING:  
 COUNTY = COOK  
 CITY-TWNSHP. = RICHTON PARK - RICH  
 SEC. & 1/4 SEC. NO. = T35N R13E  
 48 HOURS (2 working days) BEFORE YOU DIG

RICH TOWNSHIP  
 GROSS LENGTH OF IMPROVEMENT = 5,517 LF OR 1.045 MILES  
 NET LENGTH OF IMPROVEMENT = 4,822 LF OR 0.913 MILES



THOMAS M. SLATTERY  
 62-050844  
 LICENSED PROFESSIONAL ENGINEER  
 PROJECT MANAGER  
 "LICENSE EXPIRES 11-30-2013"

FAU 1682 POPLAR AVENUE  
 IMPROVEMENTS END  
 STA 65+67

STATE OF ILLINOIS DEPARTMENT OF TRANSPORTATION DIVISION OF HIGHWAYS	
APPROVED	<i>[Signature]</i> VILLAGE OF RICHTON PARK, DIRECTOR OF PUBLIC WORKS
PASSED	FEBRUARY 14, 2012 <i>[Signature]</i> DISTRICT 1 ENGINEER OF LOCAL ROADS AND STREETS
RELEASING FOR BID BASED ON LIMITED REVIEW	FEBRUARY 14, 2012 <i>[Signature]</i> DEPUTY DIRECTOR OF HIGHWAYS, REGION 1 ENGINEER

PRINTED BY THE AUTHORITY  
 OF THE STATE OF ILLINOIS

CONTRACT NO. 63691

B&W PROJECT NO.: 110805 DATE: 12-05-11

COPYRIGHT © 2011 BY BAXTER & WOODMAN, INC.  
 STATE OF ILLINOIS - PROFESSIONAL DESIGN FIRM  
 LICENSE NO. 021-0000000-000000000  
 PROGRAM AND OFFICE ENGINEER: CHARLES RIDDLE, P.E. (847) 705-4406 SCHAUMBURG, IL

**GENERAL NOTES**

1. THE CONTRACTOR SHALL PROTECT AND CAREFULLY PRESERVE ALL SECTION OR SUBSECTION MONUMENTS OR PROPERTY OR REFERENCE MARKERS UNTIL THE OWNER, HIS AGENT OR AN AUTHORIZED SURVEYOR HAS WITNESSED OR OTHERWISE REFERENCED THEIR LOCATIONS.
2. ALL LOCATIONS OF PUBLIC AND PRIVATE UTILITIES SHOWN ON PLANS ARE APPROXIMATE. THE CONTRACTOR SHALL BE RESPONSIBLE FOR CONTACTING THE OWNERS OF ALL EXISTING UTILITIES SO THAT THE UTILITIES AND THEIR APPURTENANCES MAY BE LOCATED AND ADJUSTED OR MOVED, IF NECESSARY, PRIOR TO THE START OF CONSTRUCTION OPERATIONS. THE CONTRACTOR SHALL COOPERATE WITH ALL UTILITY OWNERS AS PROVIDED IN THE STANDARD SPECIFICATIONS.
3. THE CONTRACTOR SHALL BE RESPONSIBLE FOR THE PROTECTION OF ALL UNDERGROUND OR SURFACE UTILITIES EVEN THOUGH THEY MAY NOT BE SHOWN ON THE PLANS. ANY UTILITY THAT IS DAMAGED DURING CONSTRUCTION SHALL BE REPAIRED TO THE SATISFACTION OF THE ENGINEER OR THE OWNER OR REPLACED. THIS WORK SHALL BE AT THE CONTRACTOR'S EXPENSE.

4. ALL SAW CUTTING SHALL BE INCLUDED IN THE UNIT COST OF THE PAY ITEM INDICATED FOR REMOVAL.

5. ALL CONSTRUCTION PERSONNEL WILL BE REQUIRED TO WEAR A FLUORESCENT VEST PER ARTICLE 701.12 AND 701.13 OF THE STANDARD SPECIFICATIONS AT ALL TIMES WHILE ON THE CONSTRUCTION SITE. COMPLIANCE WITH THIS REQUIREMENT SHALL BE INCLUDED IN THE CONTRACT.

6. NO STREET CLOSURES WILL BE ALLOWED.

7. THE CONTRACTOR SHALL REPLACE ALL STREET SIGNS AND MAIL BOXES REMOVED DURING CONSTRUCTION AS NEAR AS POSSIBLE TO THEIR ORIGINAL LOCATION OR AS DETERMINED BY THE ENGINEER. THIS WORK SHALL BE INCLUDED IN THE CONTRACT.

8. ALL OPEN HOLE, BROKEN PAVEMENT AND TRENCHES RESULTING FROM STRUCTURE ADJUSTMENTS, OR CURB REPAIRS WORK SHALL BE BACKFILLED TO GRADE BY THE END OF THE DAY.

9. BEFORE STARTING ANY EXCAVATION, THE CONTRACTOR SHALL CALL "JULIE" AT 800-892-0123 FOR FIELD LOCATIONS OF BURIED ELECTRIC, TELEPHONE AND GAS FACILITIES. (48 HOURS NOTIFICATION IS REQUIRED)

10. THE CONTRACTOR SHALL COORDINATE CONSTRUCTION ACTIVITIES WITH THE UTILITY COMPANIES AND THE VILLAGE OF RICHTON PARK PUBLIC WORKS DEPARTMENT, AND BAXTER AND WOODMAN, INC.

11. BARRICADE: THE CONTRACTOR SHALL PROVIDE AND INSTALL TWO (2) WEIGHTED SANDBAGS ON EACH TYPE I OR TYPE II BARRICADE USED - ONE (1) WEIGHTED SANDBAGS ACROSS EACH BOTTOM RAIL.

12. BUTT JOINTS WILL BE INSTALLED AT THE ENDS OF ALL RESURFACING (WHERE RESURFACING MEETING EXISTING PAVEMENT), IN ACCORDANCE WITH THE "BUTT JOINT AND HMA TAPER DETAILS" SHEET INCLUDED IN THE PLANS, UNLESS OTHERWISE SPECIFIED.

13. DRIVEWAYS SHALL REMAIN ACCESSIBLE DURING THE ENTIRE DURATION OF THE PROJECT.

14. THE CONTRACTOR SHALL NOTIFY VILLAGE PUBLIC WORKS AT LEAST 48 HOURS IN ADVANCE OF BEGINNING WORK TO OBTAIN VILLAGE UTILITY LOCATIONS AND SHALL COORDINATE ALL CONSTRUCTION OPERATIONS WITH THE ENGINEER.

15. MATERIALS RESULTING FROM THE REMOVAL OF PAVEMENT, DRIVEWAYS, CURB AND GUTTER, HOT-MIX ASPHALT SURFACES, ETC. SHALL BE REMOVED AT THE END OF EACH DAY TO AN APPROVED SITE. IN THE JUDGMENT OF THE VILLAGE, SHOULD IT BE NECESSARY TO REMOVE SUCH MATERIALS, THE VILLAGE WILL HAVE THE MATERIAL REMOVED AND THE CONTRACTOR WILL BE BILLED (CHARGED) ACCORDINGLY.

16. THE CONTRACTOR MAY OBTAIN MUNICIPAL WATER IN BULK, AT NO CHARGE, AS LONG AS THERE IS NOT A "WATERING" BAN IN EFFECT. THE INDISCRIMINATE USE OF FIRE HYDRANTS IS STRICTLY PROHIBITED. WATER FOR CONSTRUCTION SHALL BE METERED OR OTHERWISE ACCOUNTED FOR AND A DAILY LOG MAINTAINED. THE CONTRACTOR SHALL PROVIDE THE WATER TRUCK AND DRIVER REQUIRED TO OBTAIN AND TRANSPORT THIS WATER. THE VILLAGE RESERVES THE RIGHT TO RESTRICT OR REFUSE THE USE OF VILLAGE OF RICHTON PARK WATER IF DEEMED NECESSARY.

17. IT WILL BE THE CONTRACTOR'S RESPONSIBILITY TO NOTIFY RESIDENTS AND THE VILLAGE WHEN ACCESS TO THEIR DRIVEWAYS WILL BE TEMPORARILY CLOSED DUE TO CURB AND GUTTER AND/OR DRIVEWAY REPLACEMENT. THE CONTRACTOR SHALL DISTRIBUTE NOTICES PROVIDED BY THE VILLAGE TO RESIDENTS. EVERY EFFORT SHALL BE MADE TO ACCOMMODATE ACCESS TO THESE PROPERTIES INCLUDING KNOCKING ON DOORS WHEN DRIVEWAYS ARE ABOUT TO BE CLOSED.

18. IN AREAS WHERE THE EXISTING DRIVEWAY OR SIDEWALK IS TO BE REMOVED AND REPLACED, THE REMOVAL AND DISPOSAL OF ANY ADDITIONAL MATERIAL REQUIRED TO ESTABLISH THE PROPOSED SUBGRADE ELEVATION SHALL BE INCLUDED IN THE COST OF THE APPLICABLE PAY ITEM.

19. THE CONTRACTOR SHALL LIMIT THE WORK TO ONE SIDE OF THE STREET UNLESS AS DIRECTED OTHERWISE BY THE ENGINEER.

20. ALL CONSTRUCTION SHALL BE DONE IN ACCORDANCE WITH THE DETAILS IN THE PLANS, THE SPECIAL PROVISIONS INCLUDED IN THE CONTRACT DOCUMENTS, AND THE LATEST EDITION OF THE FOLLOWING STATE OF ILLINOIS SPECIFICATIONS: "THE STANDARD SPECIFICATIONS FOR ROAD AND BRIDGE CONSTRUCTION" (REFERRED TO AS THE "STANDARD SPECIFICATIONS"), THE "SUPPLEMENTAL SPECIFICATIONS AND RECURRING SPECIAL PROVISIONS", THE "MANUAL ON UNIFORM TRAFFIC CONTROL DEVICES FOR STREETS AND HIGHWAYS", THE "MANUAL OF TEST PROCEDURES FOR MATERIALS" AND THE "STANDARD SPECIFICATIONS FOR WATER AND SEWER MAIN CONSTRUCTION IN ILLINOIS".

21. THE PRIME COAT APPLICATION RATE SHALL BE 0.1 GAL/SY. THE CONTRACTOR SHALL PRIME IMMEDIATELY PRECEDING THE PAVING OPERATION.

22. THE LOCATIONS OF THE CLASS D PATCHES SHALL BE DETERMINED BY THE ENGINEER IN THE FIELD.

23. THE DAYS PAVING OPERATION SHALL RESULT IN A SINGLE TRANSVERSE JOINT. ANY COLD LONGITUDINAL JOINTS WILL NOT BE ACCEPTED. PROVIDING A SINGLE TRANSVERSE JOINT SHALL BE ACCOMPLISHED BY PAVING ONE LANE OF SUFFICIENT LENGTH THAT WILL ALLOW FOR THE PAVING OF THE ADJACENT LANE IN THE SAME DAY.

24. ANY ANTI-STRIPPING ADDITIVE REQUIRED SHALL BE INCLUDED IN THE COST OF THE SURFACE COURSE.

25. THE CONTRACTOR SHALL NOTIFY IDOT BUREAU OF MATERIALS (PHONE 847-705-4337) AT LEAST 24 HOURS PRIOR TO THE PLACEMENT OF HOT-MIX ASPHALT OR PORTLAND CEMENT CONCRETE.

26. EXISTING PAVEMENT, DRIVEWAY PAVEMENT, CURB AND GUTTER AND SIDEWALK TO REMAIN IN PLACE SHALL BE SAW CUT FULL DEPTH TO PROVIDE A NEAT VERTICAL FACE BETWEEN THE PROPOSED AND EXISTING AND SHALL BE INCLUDED IN THE PRICE OF THE APPROPRIATE REMOVAL PAY ITEM.

27. CURB AND GUTTER SHALL BE DEPRESSED AT DRIVEWAYS AND SIDEWALK RAMPS IN ACCORDANCE WITH THE IDOT HIGHWAY STANDARDS. SIDEWALK RAMPS FOR ACCESS FOR THE DISABLED SHALL BE PROVIDED AT THE PROPOSED CROSSWALKS IN ACCORDANCE WITH THE IDOT HIGHWAY STANDARDS OR AS DETERMINED BY THE ENGINEER.

28. THE FINISHED HOT-MIX ASPHALT SURFACE SHALL BE CONSTRUCTED 0.25-INCH ABOVE THE GUTTER FLAC.

29. ALL CRACKS AND JOINTS SHALL BE CLEANED PRIOR TO FILLING THEM. THIS WORK SHALL BE INCLUDED IN THE ITEM "MIXTURE FOR CRACKS, JOINTS AND FLANGEWAYS."

30. ANY DAMAGE TO PAVEMENT, SIDEWALK, CURB OR ANY OTHER PORTION OF THE ROADWAY NOT SPECIFICALLY TO BE REMOVED AND REPLACED SHALL BE REPAIRED OR REPLACED BY THE CONTRACTOR AT NO ADDITIONAL CHARGE.

31. CURB AND GUTTER AND DRIVEWAYS PROVIDING ACCESS SHALL BE REMOVED AND REPLACED WITHIN 3 DAYS.

32. FOR STEEL BARS CERTIFICATION, PLEASE CONTACT IDOT BUREAU OF MATERIALS AT (847) 705-4337.

33. ON STREETS TO BE FULL WIDTH MILLED (2" OR MORE), THE EXISTING STRUCTURES IN THE PAVEMENT SHALL BE ADJUSTED IN ACCORDANCE WITH THE IDOT DETAIL "DETAILS FOR FRAMES AND LIDS ADJUSTMENT WITH MILLING". THIS WORK SHALL BE PAID FOR AT THE CONTRACT UNIT PRICE FOR FRAMES AND LIDS TO BE ADJUSTED, SPECIAL.

34. PORTLAND CEMENT CONCRETE SIDEWALK SHALL BE THICKENED TO 6-INCHES AT LOCATIONS WHERE THE SIDEWALK CROSSES DRIVEWAYS. TRANSVERSE EXPANSION JOINTS 3/4" SHALL BE PLACED EVERY 50 FEET OR AS DETERMINED BY THE ENGINEER. TRANSVERSE CONTRACTION JOINTS SHALL BE PLACED EVERY 5-FEET.

35. A 1/2-INCH EXPANSION JOINT SHALL BE PROVIDED AT THE JUNCTION OF THE DRIVEWAY APRON AND CURB, AND AT THE JUNCTION OF THE DRIVEWAY APRON AND THE SIDEWALK. THIS WORK WILL BE INCLUDED IN THE COST OF PORTLAND CEMENT CONCRETE DRIVEWAY PAVEMENT.

36. DETECTABLE WARNINGS SHALL BE CONSTRUCTED WITH THE INSTALLATION OF A CAST-IN-PLACE "ARMOR-TILE" 24"x48" NOMINAL PANEL WIDTH AS MANUFACTURED BY "ENGINEERED PLASTICS INC." (800) 682-2525 OF WILLIAMSVILLE, NY OR AN APPROVED EQUAL. THE PANEL SHALL BE A POLYMER COMPOSITE AND COMPLY WITH ADA REQUIREMENTS. THE PANEL COLOR SHALL BE SELECTED BY THE ENGINEER. INSTALLATION SHALL OCCUR IN ACCORDANCE WITH THE MANUFACTURERS RECOMMENDATIONS.

37. ALL AGGREGATE USED ON PROJECT SHALL BE CRUSHED MATERIALS.

38. IN AREAS WHERE EXISTING BIKE PATH IS TO BE REMOVED AND REPLACED WITH PCC SIDEWALK, 6-INCH, THE COST OF REMOVING THE HMA BIKE PATH PAVEMENT AND ADDITIONAL MATERIAL REQUIRED TO ESTABLISH THE PROPOSED SUBGRADE ELEVATION SHALL BE INCLUDED IN THE PAY ITEM FOR EARTH EXCAVATION.

39. AGGREGATE SHOULDER, TYPE B SHALL MEET THE REQUIREMENTS OF ARTICLE 1004.4 OF THE STANDARD SPECIFICATIONS. RECLAIMED ASPHALT PAVEMENT (RAP) SHALL NOT BE ALLOWED AS AN ACCEPTABLE MATERIAL FOR AGGREGATE SHOULDER, TYPE B.

40. FOR WORK OUTSIDE THE LIMITS OF BRIDGE APPROACH PAVEMENT, ALL REFERENCES IN THE HIGHWAY STANDARDS AND STANDARD SPECIFICATIONS FOR REINFORCEMENT, DOWEL BARS AND TIE BARS IN PAVEMENT, SHOULDERS, CURB, GUTTER, COMBINATION CURB AND GUTTER AND MEDIAN, AND CHAIR SUPPORTS FOR CRC PAVEMENT, SHALL BE EPOXY COATED, UNLESS NOTED ON THE PLAN.

**INDEX OF SHEETS**

SHEET NO.	TITLE
1	COVER SHEET
2	INDEX OF SHEETS, HIGHWAY STANDARDS AND GENERAL NOTES
3	SUMMARY OF QUANTITIES AND SCHEDULE OF MATERIALS
4	TYPICAL SECTIONS AND HMA MIXTURE REQUIREMENTS
5 - 9	PLAN SHEETS
10	DISTRICT 1 DETAIL - BD-08 DETAILS FOR FRAMES AND LIDS ADJUSTMENT WITH MILLING
11	DISTRICT 1 DETAIL - BD-24 CURB OR CURB AND GUTTER REMOVAL AND REPLACEMENT
12	DISTRICT 1 DETAIL - BD-32 BUTT JOINTS AND HMA TAPER DETAILS
13	DISTRICT 1 DETAIL - TC-10 TRAFFIC CONTROL AND PROTECTION FOR SIDE ROADS, INTERSECTIONS, AND DRIVEWAYS
14	DISTRICT 1 DETAIL - TC-13 DISTRICT ONE TYPICAL PAVEMENT MARKINGS
15	DISTRICT 1 DETAIL - TC-22 ARTERIAL ROAD INFORMATION SIGN

**HIGHWAY STANDARDS**

000001-06	STANDARD SYMBOLS, ABBREVIATIONS, AND PATTERNS
424001-06	PERPENDICULAR CURB RAMPS FOR SIDEWALKS
424006	DIAGONAL CURB RAMPS FOR SIDEWALKS
424016	MID-BLOCK CURB RAMPS FOR SIDEWALKS
424021	DEPRESSED CORNER FOR SIDEWALKS
442201-03	CLASS C AND D PATCHES
606001-04	CONCRETE CURB TYPE B AND COMBINATION CONCRETE CURB AND GUTTER
701501-06	URBAN LANE CLOSURE, 2L 2W UNDIVIDED
701801-05	LANE CLOSURE MULTILANE 1W OR 2W CROSSWALK OR SIDEWALK CLOSURE
701901-02	TRAFFIC CONTROL DEVICES
720001-01	SIGN PANEL MOUNTING DETAILS
720006-03	SIGN PANEL ERECTION DETAILS
720011-01	METAL POSTS FOR SIGNS, MARKERS AND DELINEATORS
729001-01	APPLICATIONS OF TYPES A & B METAL POSTS (FOR SIGNS & MARKERS)

COPYRIGHT © 2011 BY BAXTER & WOODMAN INC.  
 STATE OF ILLINOIS - PROFESSIONAL DESIGN FIRM  
 LICENSE NO. 184-00027 - EXPIRES 6/30/2015  
 500 N. LAUREL ST., SUITE 200, CHICAGO, IL 60610-4444  
 TEL: 312.461.1234 FAX: 312.461.1235



DESIGNED - TMS	REVISED -
DRAWN - KAR	REVISED -
CHECKED - JJF	REVISED -
DATE - 12-05-11	FILE - 110805-GenNotes.sht

**STATE OF ILLINOIS  
DEPARTMENT OF TRANSPORTATION**

**INDEX OF SHEETS, HIGHWAY STANDARDS  
AND GENERAL NOTES**

SCALE: NONE

STA.

TO STA.

F.A.U. RTE.	SECTION	COUNTY	TOTAL SHEETS	SHEET NO.
1682	11-00053-00-RS	COOK	15	2
CONTRACT NO. 63691				
FED. ROAD DIST. NO. 1   ILLINOIS   FED. AID PROJECT				

**SCHEDULE OF MATERIALS**

SIDEWALK SCHEDULE				
STA	O/S	SIDEWALK REMOVAL (SQ FT)	PCC SIDEWALK, 5 INCH (SPECIAL) (SQ FT)	DETECTABLE WARNINGS (SQ FT)
11+73	RT	80.0	80.0	20.0
11+78	LT		40.0	16.0
12+15	RT	88.0	55.0	10.0
18+02	LT		40.0	16.0
18+10	RT	103.0	103.0	20.0
18+48	RT	84.0	50.0	10.0
21+58	RT	138.0	83.0	10.0
21+91	LT		50.0	16.0
21+99	RT	125.0	125.0	20.0
26+80	RT	111.0	59.0	10.0
27+20	RT	28.0		
27+20	RT	64.0	64.0	10.0
29+25	LT		192.0	36.0
29+65	LT	109.0	66.0	10.0
34+28	LT		35.0	10.0
34+70	RT	29.0		
36+80	LT	119.0	119.0	20.0
36+80	RT	119.0	119.0	20.0
37+20	LT	119.0	119.0	20.0
37+20	RT	119.0	119.0	20.0
38+50	LT		40.0	16.0
38+50	RT		40.0	16.0
39+82	LT	63.0	40.0	10.0
40+20	LT	63.0	40.0	10.0
41+65	LT		162.5	72.0
ANDOVER DRIVE	LT	97.0	51.0	10.0
ANDOVER DRIVE	LT	53.0	53.0	20.0
43+72	RT	128.0	85.0	10.0
50+70	LT		100.0	16.0
51+07	LT		100.0	16.0
53+58	LT		60.0	16.0
53+87	LT		40.0	16.0
57+20	RT	57.0	38.0	10.0
57+57	RT	57.0	38.0	10.0
<b>TOTALS:</b>		1953.0	2405.5	542.0

DRIVEWAY SCHEDULE				
Station	o/s	Driveway Pavement Removal (SQ YD) (PCC DRIVES ONLY)	PCC Driveway Pavement, 6" (SQ YD)	HMA Driveway Surface R&R (SQ YD)
12+25	RT			9.3
13+12	RT	17.1	17.1	
13+42	RT			19.4
14+99	RT	11.7	11.7	
16+31	RT			9.3
18+74	RT			10.1
20+41	RT	19.4	19.4	
20+96	RT	10.9	10.9	
22+32	RT			9.7
23+03	RT	17.1	17.1	
23+65	RT			15.6
23+96	RT	15.6	15.6	
25+10	RT	9.3	9.3	
30+02	RT	11.7	11.7	
30+90	LT	10.1	10.1	
33+33	LT	15.6	15.6	
47+92	RT	10.1	10.1	
50+61	RT	9.3	9.3	
52+00	RT	10.9	10.9	
52+65	RT	10.9	10.9	
55+92	RT	10.9	10.9	
<b>TOTALS:</b>		190.6	190.6	73.4

INLETS TO BE ADJUSTED	
LOCATION	O/S
11+81	RT
16+13	RT
16+13	LT
20+06	RT
20+06	LT
29+31	LT
29+54	LT
29+70	LT
45+55	RT
55+90	RT
<b>TOTAL:</b>	10

FRAMES AND LIDS TO BE ADJUSTED (SPECIAL)	
LOCATION	O/S
30+97	RT
37+12	RT
43+37	LT
<b>TOTAL:</b>	3

**SUMMARY OF QUANTITIES**

ITEM NO.	PAY ITEM	UNIT	CONSTRUCTION TYPE CODE
			0005
			TOTAL QUANTITY
20200100	EARTH EXCAVATION	CU YD	31
35101600	AGGREGATE BASE COURSE, TYPE B 4"	SQ YD	21
40600200	BITUMINOUS MATERIALS (PRIME COAT)	TON	7
40600300	AGGREGATE (PRIME COAT)	TON	34
40600400	MXTURE FOR CRACKS, JOINTS, AND FLANGEWAYS	TON	3
40600827	POLYMERIZED LEVELING BINDER (MACHINE METHOD), IL-4.75, N50	TON	683
40600895	CONSTRUCTING TEST STRIP	EACH	1
40600982	HOT-MX ASPHALT SURFACE REMOVAL-BUTT JOINT	SQ YD	127
40603335	HOT-MX ASPHALT SURFACE COURSE, MX "D", N50	TON	1,366
40800050	INCIDENTAL HOT-MX ASPHALT SURFACING	TON	7
42300200	PORTLAND CEMENT CONCRETE DRIVEWAY PAVEMENT, 6 INCH	SQ YD	192
42400800	DETECTABLE WARNINGS	SQ FT	542
44000158	HOT-MX ASPHALT SURFACE REMOVAL, 2 1/4"	SQ YD	16,245
44000200	DRIVEWAY PAVEMENT REMOVAL	SQ YD	192
44000600	SIDEWALK REMOVAL	SQ FT	1,953
44201723	CLASS D PATCHES, TYPE IV, 6 INCH	SQ YD	378
48101200	AGGREGATE SHOULDERS, TYPE B	TON	62
60260100	INLETS TO BE ADJUSTED	EACH	10
60603800	COMBINATION CONCRETE CURB AND GUTTER, TYPE B-6.12	FOOT	73
63200310	GUARDRAIL REMOVAL	FOOT	25
67100100	MOBILIZATION	L SUM	1
# 70102620	TRAFFIC CONTROL AND PROTECTION, STANDARD 701501	L SUM	1
# 70102640	TRAFFIC CONTROL AND PROTECTION, STANDARD 701801	L SUM	1
70300100	SHORT TERM PAVEMENT MARKING	FOOT	606
70301000	WORK ZONE PAVEMENT MARKING REMOVAL	SQ FT	101
72000100	SIGN PANEL - TYPE 1	SQ FT	40
72900100	METAL POST - TYPE A	FOOT	184
* 78000100	THERMOPLASTIC PAVEMENT MARKING - LETTERS AND SYMBOLS	SQ FT	30
* 78000200	THERMOPLASTIC PAVEMENT MARKING - LINE 4"	FOOT	329
* 78000400	THERMOPLASTIC PAVEMENT MARKING - LINE 6"	FOOT	1,466
* 78000600	THERMOPLASTIC PAVEMENT MARKING - LINE 12"	FOOT	509
* 78000650	THERMOPLASTIC PAVEMENT MARKING - LINE 24"	FOOT	104
# X2020110	GRADING AND SHAPING SHOULDERS	UNIT	14
# X4240430	PORTLAND CEMENT CONCRETE SIDEWALK 5 INCH, SPECIAL	SQ FT	2,406
# X6030310	FRAMES AND LIDS TO BE ADJUSTED (SPECIAL)	EACH	3
# XX006947	HOT-MX ASPHALT DRIVEWAY REMOVAL AND REPLACEMENT	SQ YD	74
# XX007278	PARKWAY RESTORATION	SQ YD	803
# Z0004562	COMBINATION CONCRETE CURB AND GUTTER REMOVAL AND REPLACEMENT	FOOT	2,125
# Z0030850	TEMPORARY INFORMATION SIGNING	SQ FT	52

# INDICATES ITEM COVERED BY SPECIAL PROVISION

\* INDICATES SPECIALTY ITEM

COPYRIGHT © 2012 BY BAXTER & WOODMAN, INC. ...  
 LICENSE NO. 184-00121-EXPRES 4/30/2013  
 56362r



DESIGNED - TMS	REVISED -
DRAWN - KAR	REVISED -
CHECKED - JJF	REVISED -
DATE - 12-05-11	FILE - 110805-S00.sht

**STATE OF ILLINOIS  
DEPARTMENT OF TRANSPORTATION**

**SUMMARY OF QUANTITIES AND SCHEDULE OF MATERIALS**

SCALE: NONE STA. TO STA.

F.A.U. RTE. 1682	SECTION 11-00053-00-RS	COUNTY COOK	TOTAL SHEETS 15	SHEET NO. 3
FED. ROAD DIST. NO. 1 ILLINOIS FED. AID PROJECT				
CONTRACT NO. 63691				

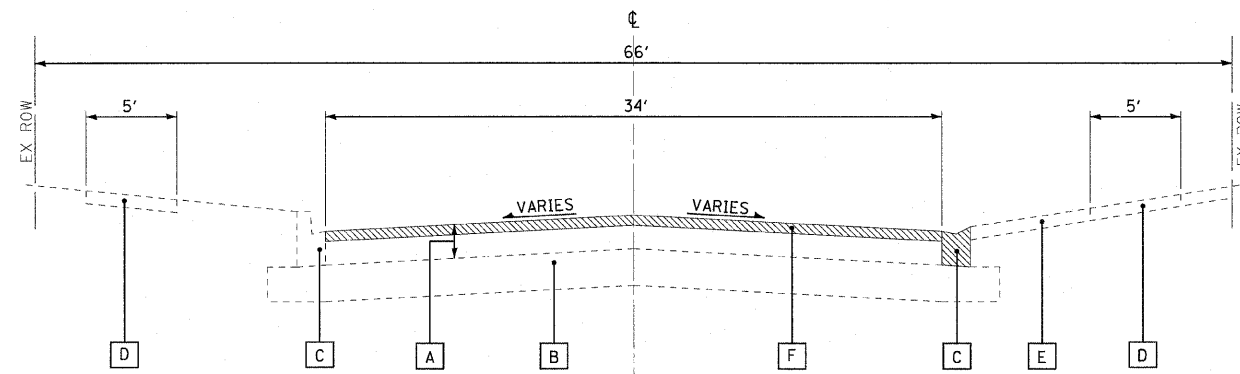

**EXISTING TYPICAL SECTION**  
**POPLAR AVENUE STA 10+50 TO STA 43+61**

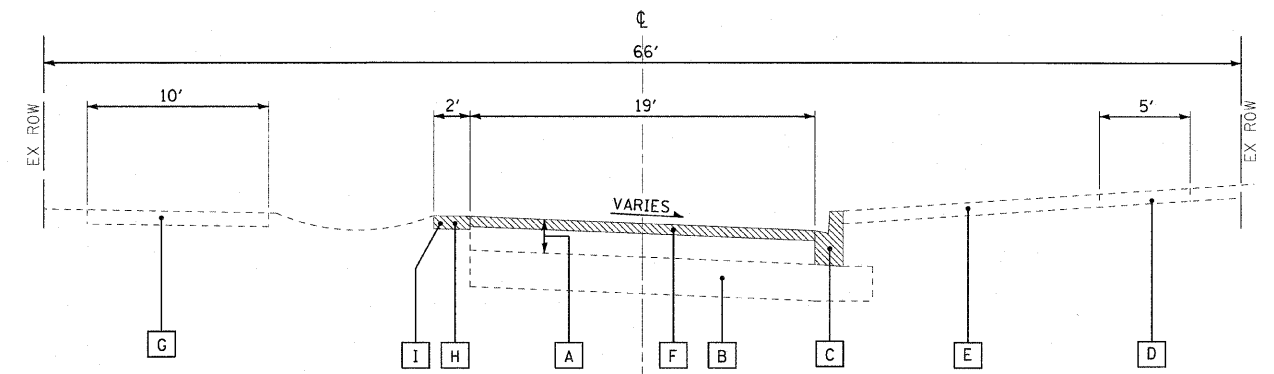

**EXISTING TYPICAL SECTION**  
**POPLAR AVENUE STA 43+61 TO STA 58+72**

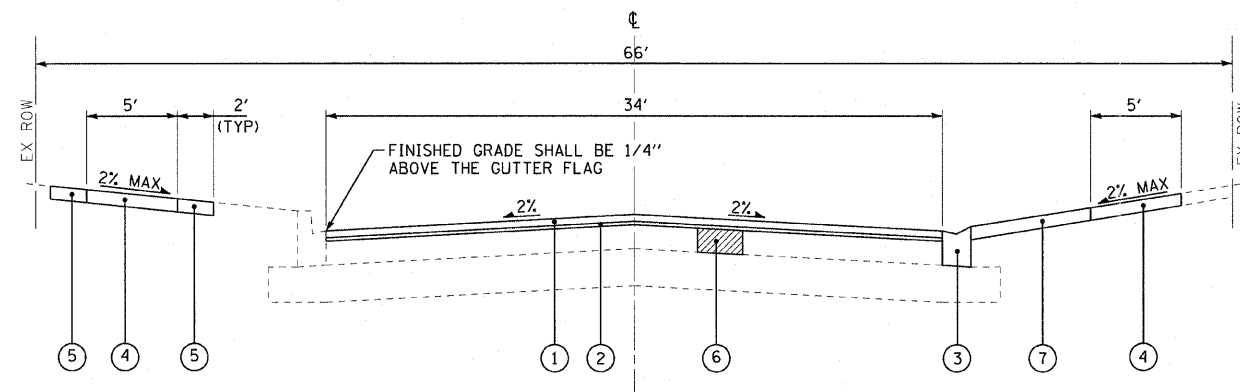

**PROPOSED TYPICAL SECTION**  
**POPLAR AVENUE STA 10+50 TO STA 43+61**

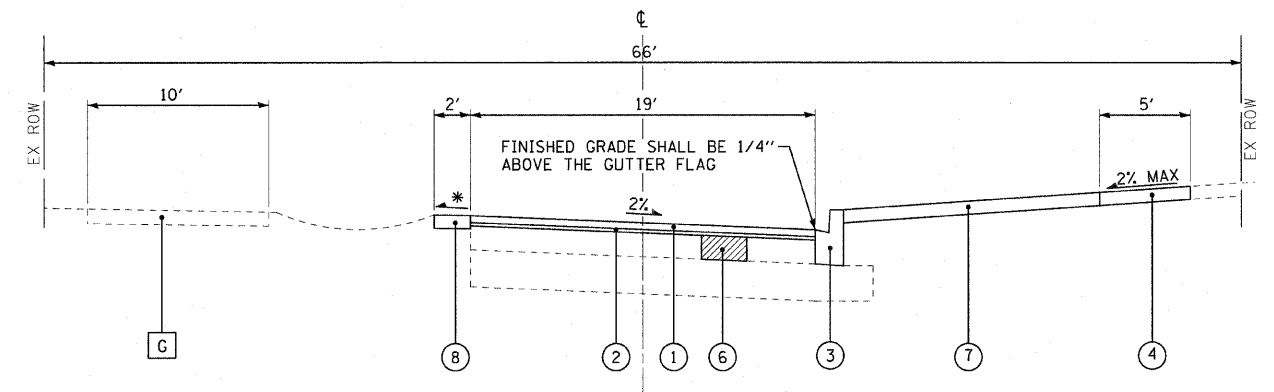

**PROPOSED TYPICAL SECTION**  
**POPLAR AVENUE STA 43+61 TO STA 58+72**

\* SLOPE VARIES - AS DIRECTED BY THE ENGINEER

**LEGEND**

**EXISTING**

- A HOT-MIX ASPHALT PAVEMENT
- B AGGREGATE BASE COURSE
- C COMBINATION CONCRETE CURB AND GUTTER
- D SIDEWALK
- E DRIVEWAY
- F HOT-MIX ASPHALT SURFACE REMOVAL, 2 1/4"
- G BIKE PATH
- H AGGREGATE SHOULDER
- I GRADING AND SHAPING SHOULDERS

**PROPOSED**

- 1 HOT-MIX ASPHALT SURFACE COURSE, MIX "D", N50 - 1 1/2"
- 2 POLYMERIZED LEVELING BINDER (MACHINE METHOD), N50 - 3/4"
- 3 COMBINATION CONCRETE CURB AND GUTTER REMOVAL AND REPLACEMENT (AS DETERMINED BY THE ENGINEER)
- 4 SIDEWALK REMOVAL PCC SIDEWALK, 5-INCH (SPECIAL) (AS DETERMINED BY THE ENGINEER)
- 5 PARKWAY RESTORATION
- 6 CLASS D PATCHES - 6" (AS DETERMINED BY THE ENGINEER)
- 7 DRIVEWAY PAVEMENT REMOVAL PCC DRIVEWAY PAVEMENT, 6" (AS DETERMINED BY THE ENGINEER) OR HOT-MIX ASPHALT DRIVEWAY PAVEMENT REMOVAL AND REPLACEMENT (AS DETERMINED BY THE ENGINEER)
- 8 AGGREGATE SHOULDERS, TYPE B

**HOT-MIX ASPHALT MIXTURE REQUIREMENTS**

NOTE: CONTRACTOR SHALL MILL BEFORE PATCHING

ITEM	AIR VOIDS @ Ndes
<b>RESURFACING</b>	
HOT-MIX ASPHALT SURFACE COURSE, MIX "D", N50 (IL-9.5 mm), 1 1/2"	4% @ 50 Gyr
POLYMERIZED LEVELING BINDER (MACHINE METHOD) IL-4.75 mm, N50, 3/4"	3.5% @ 50 Gyr
<b>PATCHING</b>	
CLASS D PATCHES HOT-MIX ASPHALT BINDER IL-19mm, N70, 6" (3 LIFTS)	4% @ 70 Gyr
<b>DRIVEWAY</b>	
HOT-MIX ASPHALT SURFACE COURSE, MIX "D", N50 (IL-9.5 mm), 3" (2 LIFTS)	4% @ 50 Gyr
1. THE UNIT WEIGHT USED TO CALCULATE ALL HOT-MIX ASPHALT SURFACE MIXTURE QUANTITIES IS 112 LBS/SQ YD/IN. 2. THE "AC TYPE" FOR POLYMERIZED HMA MIXES SHALL BE "SBS/SBR PG 70-22 AND FOR NON-POLYMERIZED HMA THE "AC TYPE" SHALL BE "PG 64-22" UNLESS MODIFIED BY DISTRICT ONE SPECIAL PROVISIONS." FOR "PERCENT OF RAP" SEE DISTRICT ONE SPECIAL PROVISIONS.	

COPYRIGHT © 2011 BY BAXTER & WOODMAN, INC.  
 STATE OF ILLINOIS - PROFESSIONAL DESIGN FIRM  
 LICENSE NO. 184-00121 - EXPIRES 4/30/2015  
 2/25/2011 10:45 AM



DESIGNED - TMS	REVISED -
DRAWN - KAR	REVISED -
CHECKED - JJF	REVISED -
DATE - 12-05-11	FILE - 110805-TypSec.sht

**STATE OF ILLINOIS**  
**DEPARTMENT OF TRANSPORTATION**

**TYPICAL SECTIONS AND**  
**HMA MIXTURE REQUIREMENTS**

SCALE: NONE STA. TO STA.

F.A.J. RTE.	SECTION	COUNTY	TOTAL SHEETS	SHEET NO.
1682	11-00053-00-RS	COOK	15	4
CONTRACT NO. 63691				
FED. ROAD DIST. NO. 1   ILLINOIS   FED. AID PROJECT				

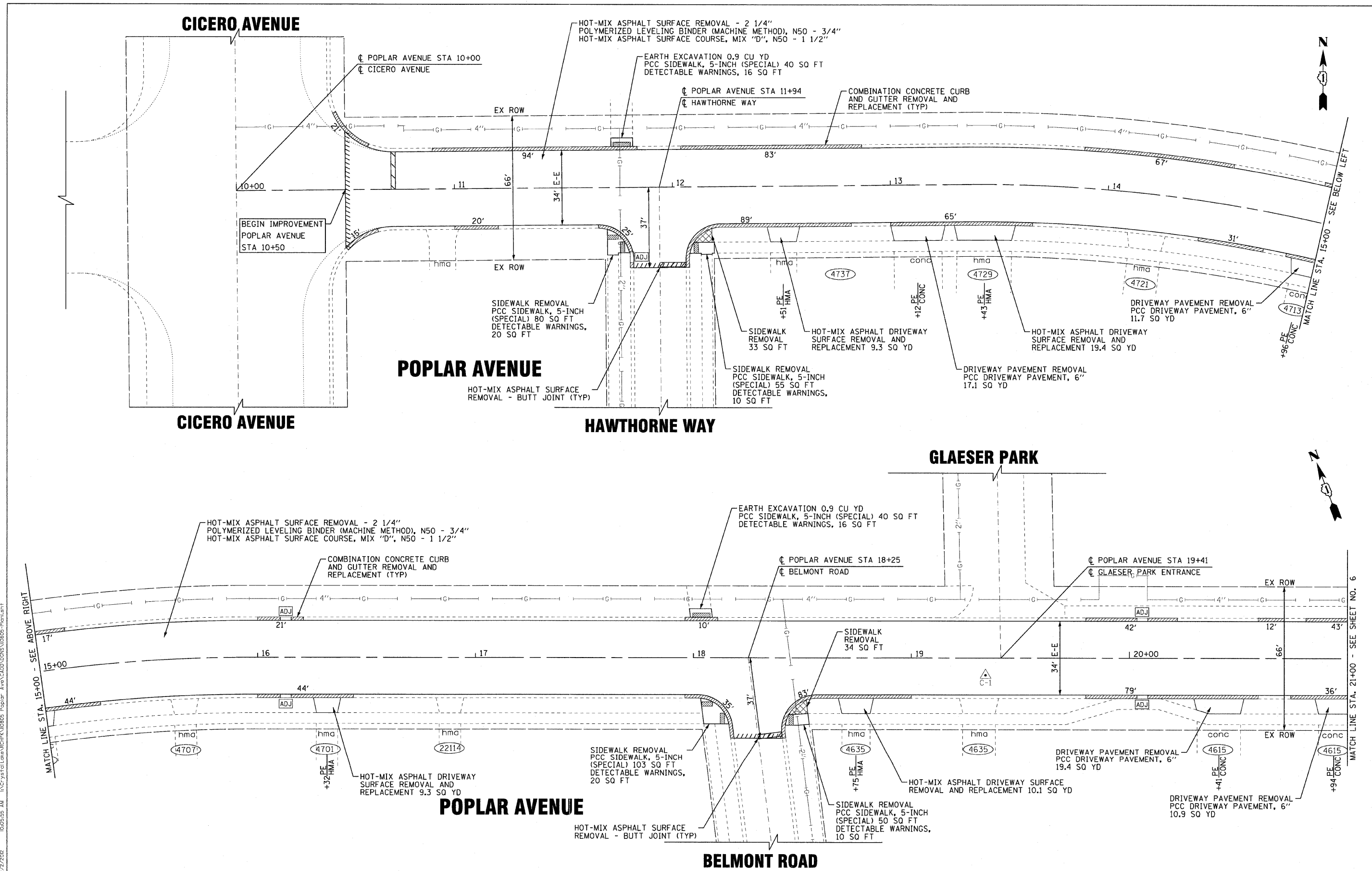

COPYRIGHT © 2011 BY BAXTER & WOODMAN, INC.  
 ALL RIGHTS RESERVED. PROFESSIONAL LICENSE NO. 063270333  
 5000 N. WILSON AVENUE, SUITE 100, CHICAGO, IL 60642  
 TEL: (773) 661-1000 FAX: (773) 661-1001  
 WWW.BAXTERANDWOODMAN.COM



DESIGNED - TMS	REVISED -
DRAWN - KAR	REVISED -
CHECKED - JJF	REVISED -
DATE - 12-05-11	FILE - 110805-Plan1.shx

**STATE OF ILLINOIS  
DEPARTMENT OF TRANSPORTATION**

**POPLAR AVENUE PLAN**

SCALE: 1" = 20'

STA. 10+00 TO STA. 21+00

F.A.U. RTE.	SECTION	COUNTY	TOTAL SHEETS	SHEET NO.
1682	11-00053-00-RS	COOK	15	5
CONTRACT NO. 63691				
FED. ROAD DIST. NO. 1 ILLINOIS FED. AID PROJECT				

COMBINATION CONCRETE CURB AND GUTTER REMOVAL AND REPLACEMENT (TYP)

POPLAR AVENUE STA 21+72  
ROCKINGHAM ROAD

END OF ROADWAY MARKERS (3)  
OM4-2 (18" X 18") (TYP)

EARTH EXCAVATION 1.1 CU YD  
PCC SIDEWALK, 5-INCH (SPECIAL) 50 SQ FT  
DETECTABLE WARNINGS, 16 SQ FT

THERMOPLASTIC PAVEMENT MARKING, 6" WHITE (TYP)

THERMOPLASTIC PAVEMENT MARKING, 24" WHITE (TYP)

HOT-MIX ASPHALT SURFACE REMOVAL - 2 1/4"  
POLYMERIZED LEVELING BINDER (MACHINE METHOD), N50 - 3/4"  
HOT-MIX ASPHALT SURFACE COURSE, MIX "D", N50 - 1 1/2"

MATCH LINE STA. 21+00 - SEE SHEET NO. 5

SIDEWALK REMOVAL  
55 SQ FT

SIDEWALK REMOVAL  
PCC SIDEWALK, 5-INCH (SPECIAL) 83 SQ FT  
DETECTABLE WARNINGS, 10 SQ FT

HOT-MIX ASPHALT SURFACE REMOVAL - BUTT JOINT (TYP)

SIDEWALK REMOVAL  
PCC SIDEWALK, 5-INCH (SPECIAL) 125 SQ FT  
DETECTABLE WARNINGS, 20 SQ FT

ROCKINGHAM ROAD

HOT-MIX ASPHALT DRIVEWAY SURFACE REMOVAL AND REPLACEMENT 9.7 SQ YD

DRIVEWAY PAVEMENT REMOVAL  
PCC DRIVEWAY PAVEMENT, 6" 17.1 SQ YD

HOT-MIX ASPHALT DRIVEWAY SURFACE REMOVAL AND REPLACEMENT 15.6 SQ YD

POPLAR AVENUE

HOT-MIX ASPHALT SURFACE REMOVAL - 2 1/4"  
POLYMERIZED LEVELING BINDER (MACHINE METHOD), N50 - 3/4"  
HOT-MIX ASPHALT SURFACE COURSE, MIX "D", N50 - 1 1/2"

THERMOPLASTIC PAVEMENT MARKING, 12" WHITE (3' C-C) (TYP)

EARTH EXCAVATION 4.2 CU YD  
PCC SIDEWALK, 5-INCH (SPECIAL) 192 SQ FT  
DETECTABLE WARNINGS, 36 SQ FT

END OF ROADWAY MARKERS (3)  
OM4-2 (18" X 18") (TYP)

POPLAR AVENUE STA 27+01  
KEENEHAND COURT

MATCH LINE STA. 25+00 - SEE ABOVE RIGHT

SIDEWALK REMOVAL  
52 SQ FT

SIDEWALK REMOVAL  
PCC SIDEWALK, 5-INCH (SPECIAL) 59 SQ FT  
DETECTABLE WARNINGS, 10 SQ FT

HOT-MIX ASPHALT SURFACE REMOVAL - BUTT JOINT (TYP)

POPLAR AVENUE

KEENEHAND COURT

SIDEWALK REMOVAL 28 SQ FT  
SIDEWALK REMOVAL  
PCC SIDEWALK, 5-INCH (SPECIAL) 64 SQ FT  
DETECTABLE WARNINGS, 10 SQ FT

THERMOPLASTIC PAVEMENT MARKING, 24" WHITE (TYP)

THERMOPLASTIC PAVEMENT MARKING, 6" WHITE (TYP)

POPLAR AVENUE STA 29+44  
BALMORAL DRIVE

THERMOPLASTIC PAVEMENT MARKING, 4" YELLOW SKIP-DASH (10' LINE, 30' SKIP) (TYP)

BALMORAL DRIVE

SIDEWALK REMOVAL  
PCC SIDEWALK, 5-INCH (SPECIAL) 66 SQ FT  
DETECTABLE WARNINGS, 10 SQ FT

SIDEWALK REMOVAL  
43 SQ FT

MATCH LINE STA. 30+00 - SEE SHEET NO. 7

COPYRIGHT © 2011 BY BAXTER & WOODMAN, INC.  
 STATE OF ILLINOIS - PROFESSIONAL DESIGN FIRM  
 No. 042-011-0001  
 2/27/2011  
 PROJECT: POPLAR AVENUE RECONSTRUCTION  
 FILE: 110805-Plan2.rvt



DESIGNED - TMS	REVISED -
DRAWN - KAR	REVISED -
CHECKED - JJF	REVISED -
DATE - 12-05-11	FILE - 110805-Plan2.rvt

STATE OF ILLINOIS  
DEPARTMENT OF TRANSPORTATION

<b>POPLAR AVENUE PLAN</b>	
SCALE: 1" = 20'	STA. 21+00 TO STA. 30+00

F.A.U. RTE. 1682	SECTION 11-00053-00-RS	COUNTY COOK	TOTAL SHEETS 15	SHEET NO. 6
CONTRACT NO. 63691				
FED. ROAD DIST. NO. 1 ILLINOIS FED. AID PROJECT				

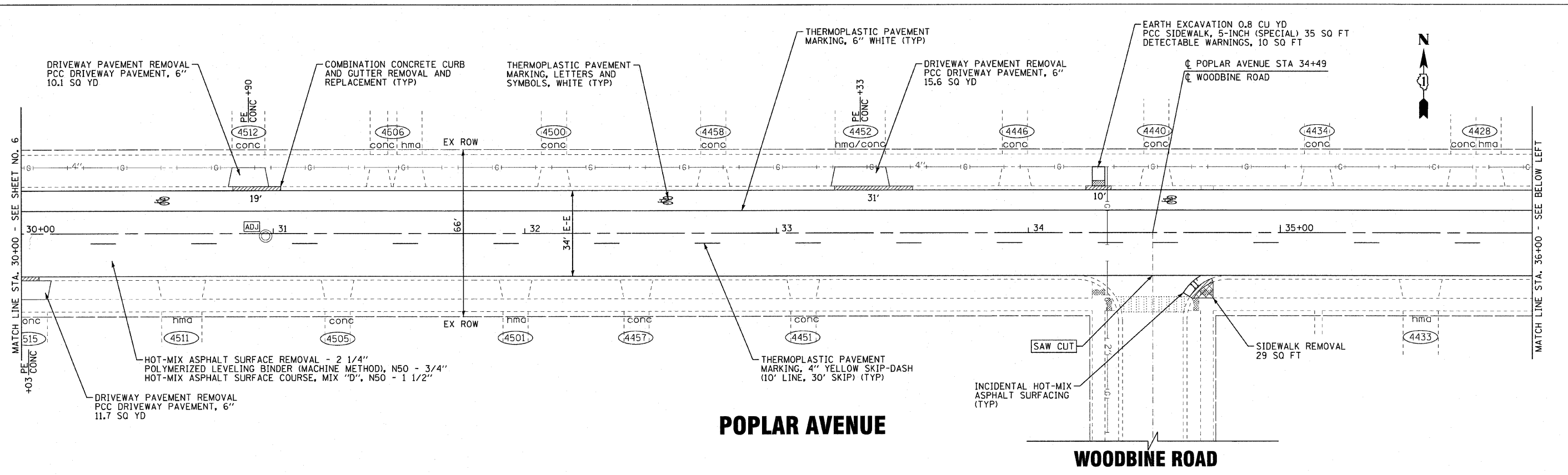

**POPLAR AVENUE**

**WOODBINE ROAD**

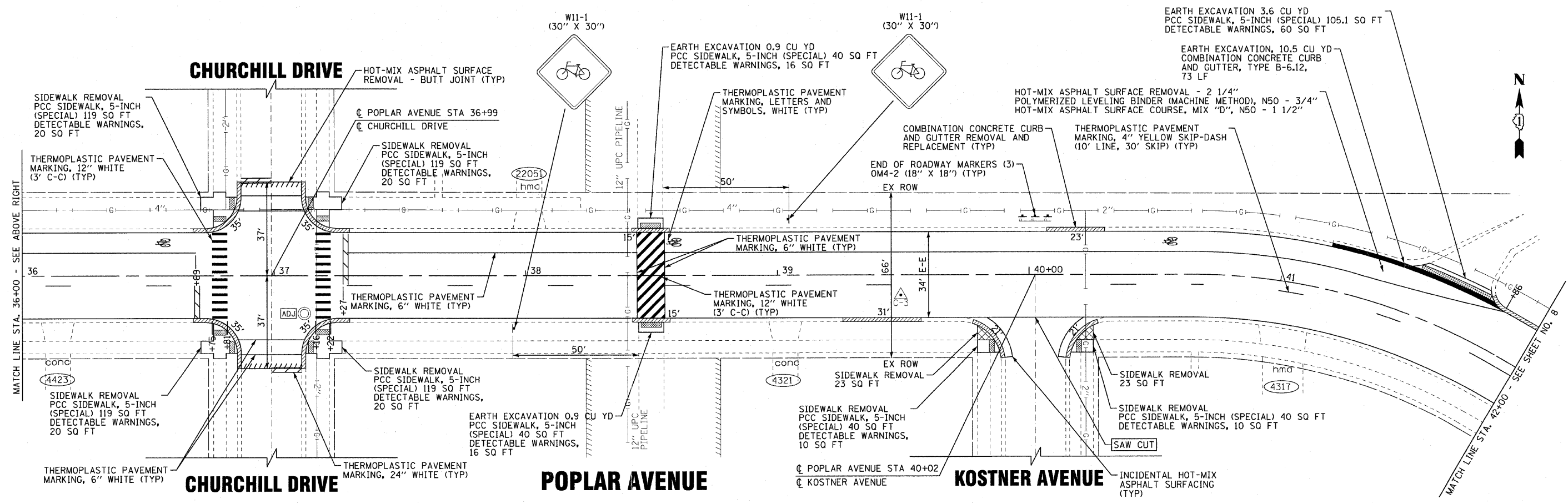

**POPLAR AVENUE**

**KOSTNER AVENUE**

COPYRIGHT © 2011 BY BAXTER & WOODMAN, INC.  
 STATE OF ILLINOIS - PROFESSIONAL DESIGN FIRM  
 LICENSE NO. 111-00053-00-RS EXPIRES 4/30/2015  
 1300 PULASKI AVENUE, SUITE 1000, CHICAGO, IL 60610  
 312.467.2200 FAX 312.467.2202



DESIGNED - TMS	REVISED -
DRAWN - KAR	REVISED -
CHECKED - JJF	REVISED -
DATE - 12-05-11	FILE - 110805-Plan3.sht

**STATE OF ILLINOIS  
DEPARTMENT OF TRANSPORTATION**

**POPLAR AVENUE PLAN**

SCALE: 1" = 20'  
 STA. 30+00 TO STA. 42+00

F.A.U. RTE.	SECTION	COUNTY	TOTAL SHEETS	SHEET NO.
1682	11-00053-00-RS	COOK	15	7
CONTRACT NO. 63691				
FED. ROAD DIST. NO. 1   ILLINOIS FED. AID PROJECT				

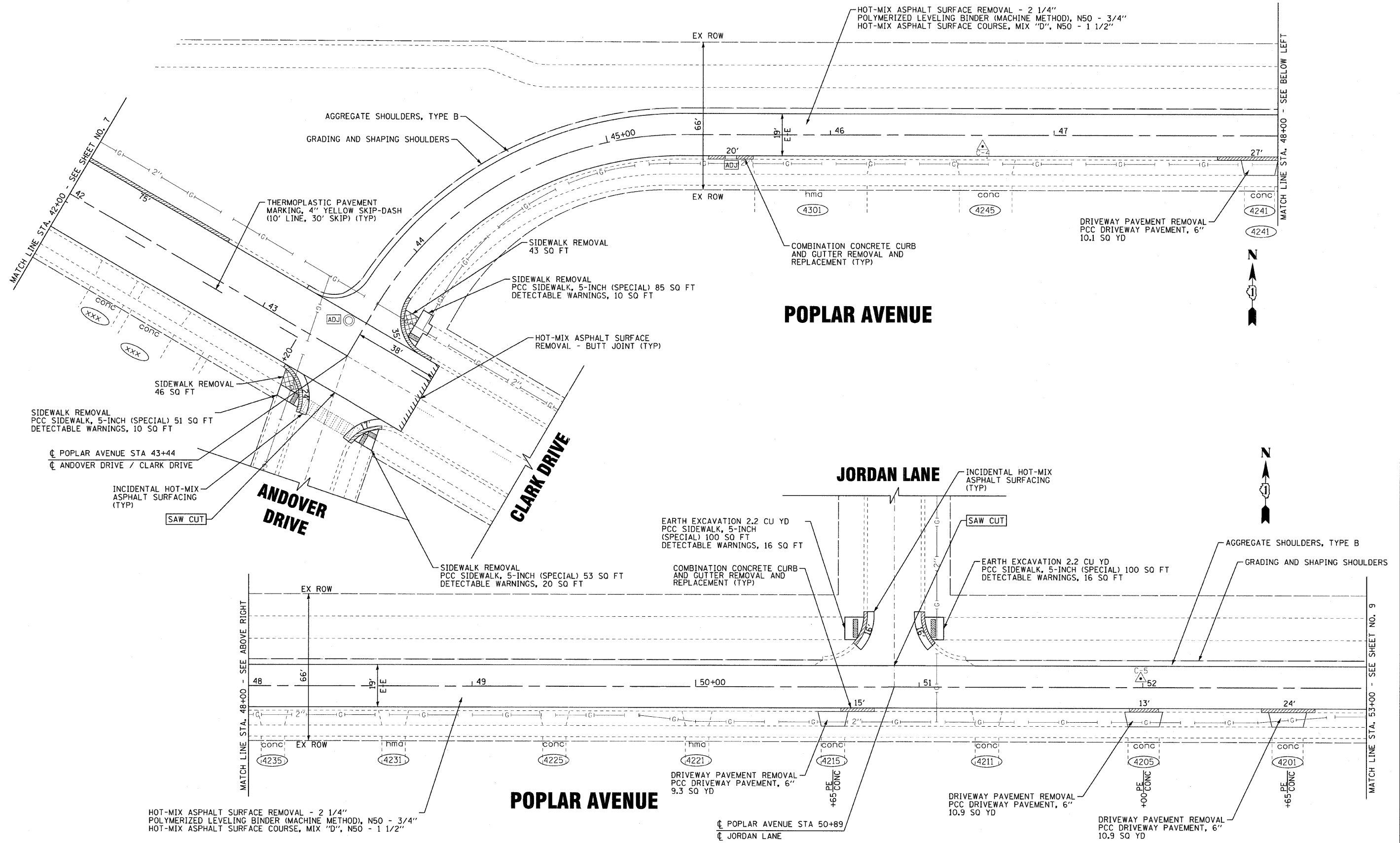

COPYRIGHT © 2011 BY BAXTER & WOODMAN, INC.  
 ALL RIGHTS RESERVED. NO PART OF THIS DOCUMENT IS TO BE REPRODUCED OR TRANSMITTED IN ANY FORM OR BY ANY MEANS, ELECTRONIC OR MECHANICAL, INCLUDING PHOTOCOPYING, RECORDING, OR BY ANY INFORMATION STORAGE AND RETRIEVAL SYSTEM.  
 DATE: 2/27/2012  
 PROJECT: 11-00053-00-RS  
 SHEET: 8 OF 15  
 FILE: 110805-Plan4.rvt



DESIGNED - TMS	REVISED -
DRAWN - KAR	REVISED -
CHECKED - JJF	REVISED -
DATE - 12-05-11	FILE - 110805-Plan4.rvt

**STATE OF ILLINOIS  
DEPARTMENT OF TRANSPORTATION**

**POPLAR AVENUE PLAN**

SCALE: 1" = 20'

STA. 42+00 TO STA. 53+00

F.A.U. RTE. 1682	SECTION 11-00053-00-RS	COUNTY COOK	TOTAL SHEETS 15	SHEET NO. 8
CONTRACT NO. 63691				
FED. ROAD DIST. NO. 1 ILLINOIS FED. AID PROJECT				







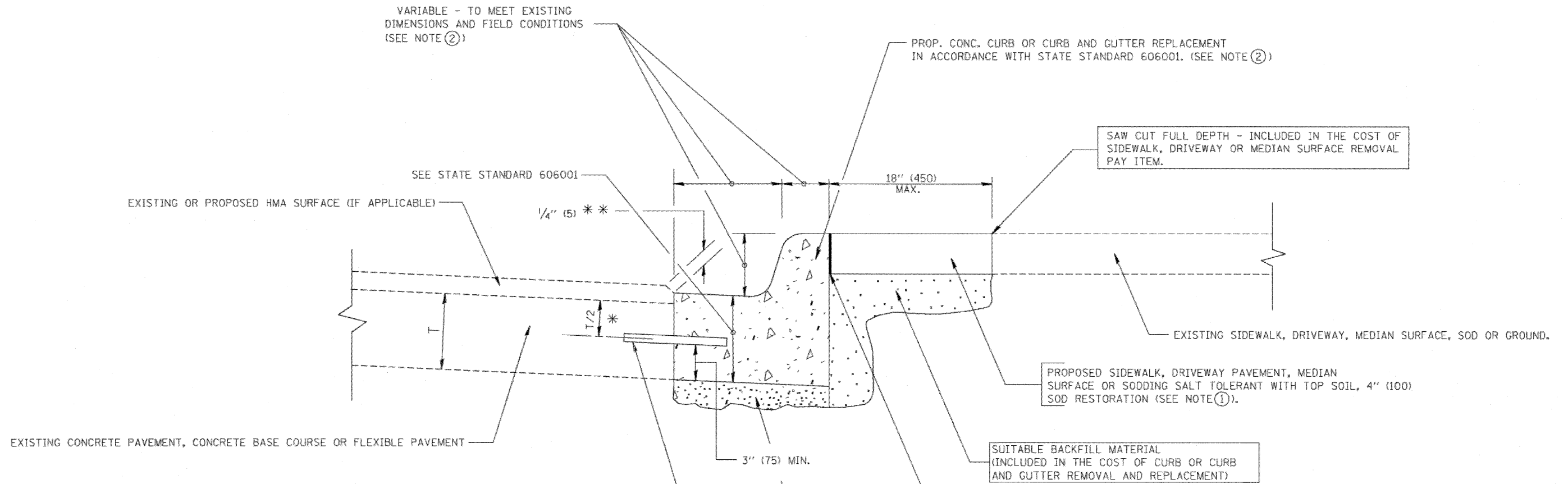

- \* 3" (75) MINIMUM FROM TOP AND BOTTOM OF THE CONCRETE PAVEMENT OR BASE COURSE.
  - \*\* IF THE FINAL SURFACE OF THE PAVEMENT IS CONCRETE, THE GUTTER IS TO BE FLUSH WITH THE PAVEMENT.
- NOTE: ① SIDEWALK, DRIVEWAY PAVEMENT OR MEDIAN SURFACE SHALL BE SIMILAR TO THE MATERIAL BEING REMOVED AND WILL BE PAID FOR SEPARATELY.  
SODDING, SALT TOLERANT AND TOP SOIL, FURNISH AND PLACE 4" WILL BE PAID FOR SEPARATELY.
- ② FERTILIZER FOR THE PLACEMENT OF THE SOD IS NOT REQUIRED
- ③ CURB OR CURB AND GUTTER REPLACEMENT SHALL MATCH THE SHAPE OF THE EXISTING CURB OR CURB AND GUTTER UNLESS OTHERWISE SPECIFIED.
- ④ FOR CURB OR CURB AND GUTTER REMOVAL AND REPLACEMENT ADJACENT TO FLEXIBLE PAVEMENT DELETE EPOXY COATED TIE BARS.
- ⑤ LONGITUDINAL BARS, IF ENCOUNTERED IN THE EXISTING CURB OR CURB AND GUTTER, ARE NOT TO BE REPLACED. CUTTING AND REMOVING LONGITUDINAL BARS SHALL BE INCLUDED IN THE COST OF CURB OR CURB AND GUTTER REMOVAL AND REPLACEMENT.
- ⑥ THE COST OF HMA SURFACE REMOVAL IN THE EXISTING GUTTER FLAG SHALL BE INCLUDED IN THE COST OF THE CURB AND GUTTER REMOVAL AND REPLACEMENT.
- ⑦ THE REMOVAL AND REPLACEMENT OF THE EXISTING CURB OR CURB AND GUTTER SHALL BE DONE IN ACCORDANCE WITH THE APPLICABLE PORTIONS OF SECTION 440 AND 606 OF THE STANDARD SPECIFICATIONS.
- ⑧ THE LOCATIONS OF REMOVAL AND REPLACEMENT OF EXISTING CURB OR CURB AND GUTTER SHALL BE DETERMINED BY THE RESIDENT ENGINEER AT THE TIME OF CONSTRUCTION.

- SUITABLE BACKFILL MATERIAL (INCLUDED IN THE COST OF CURB OR CURB AND GUTTER REMOVAL AND REPLACEMENT)
- PROPOSED 3/4" (20) PREFORMED EXPANSION JOINT AT CONCRETE SIDEWALKS, DRIVEWAYS, AND MEDIANS. (INCLUDED IN THE COST OF CURB OR CURB AND GUTTER REMOVAL AND REPLACEMENT.)
- UNSUITABLE SUB-BASE MATERIAL TO BE REMOVED, IF DIRECTED BY THE ENGINEER, SHALL BE REPLACED WITH EITHER SUB-BASE GRANULAR MATERIAL, TYPE B OR ADDITIONAL THICKNESS OF CONCRETE.
- REMOVAL AND REPLACEMENT 4" (100) OR LESS IS INCLUDED IN THE COST OF CURB OR CURB AND GUTTER REMOVAL AND REPLACEMENT.
- REMOVAL AND REPLACEMENT IN EXCESS OF 4" (100) WILL BE PAID FOR IN ACCORDANCE WITH ARTICLE 109.04 OF THE STANDARD SPECIFICATIONS.
- PROPOSED #6 (20) EPOXY COATED TIE BARS 24" (600) LONG AT 24" (600) CENTERS WILL NOT BE PAID FOR SEPARATELY. DELETE EPOXY COATED TIE BARS IF EXISTING TIE BARS ARE USUABLE AS DETERMINED BY THE ENGINEER. (SEE NOTE ③).

**BASIS OF PAYMENT:**  
THIS WORK WILL BE PAID FOR AT THE CONTRACT UNIT PRICE PER FOOT (METER) FOR "CURB REMOVAL AND REPLACEMENT" OR "COMBINATION CONCRETE CURB AND GUTTER REMOVAL AND REPLACEMENT".

## CURB OR CURB AND GUTTER REMOVAL AND REPLACEMENT

ALL DIMENSIONS ARE IN INCHES (MILLIMETERS) UNLESS OTHERWISE SHOWN.

COPYRIGHT © 2010 BY BAXTER & WOODMAN, INC.  
 STATE OF ILLINOIS PROFESSIONAL DESIGN FIRM  
 5600 N. STATE ST., SUITE 100, CHICAGO, IL 60646  
 2/27/2010 10:05:46 AM

FILE NAME =	USER NAME = drsvakosgn	DESIGNED - A. HOUSEH	REVISED - R. SHAH 10-03-96	<b>STATE OF ILLINOIS DEPARTMENT OF TRANSPORTATION</b>	<b>CURB OR CURB AND GUTTER REMOVAL AND REPLACEMENT</b>	F.A.U. RTE.	SECTION	COUNTY	TOTAL SHEETS	SHEET NO.	
ce:\p\work\p\dot\drsvakosgn\10188315\bd24.dgn	PLOT SCALE = 50.000' / IN.	CHECKED -	REVISED - A. ABBAS 03-21-97			1682	11-00053-00-RS	COOK	15	11	
PLOT DATE = 12/15/2009	DATE = 03-11-94	REVISED - M. GOMEZ 01-22-01	REVISED - R. BORO 12-15-09			<b>BD600-06 (BD-24)</b>					
						SCALE: NONE	SHEET NO. 1 OF 1 SHEETS		STA.	TO STA.	CONTRACT NO. 63691
FED. ROAD DIST. NO. 1 (ILLINOIS) FED. AID PROJECT											

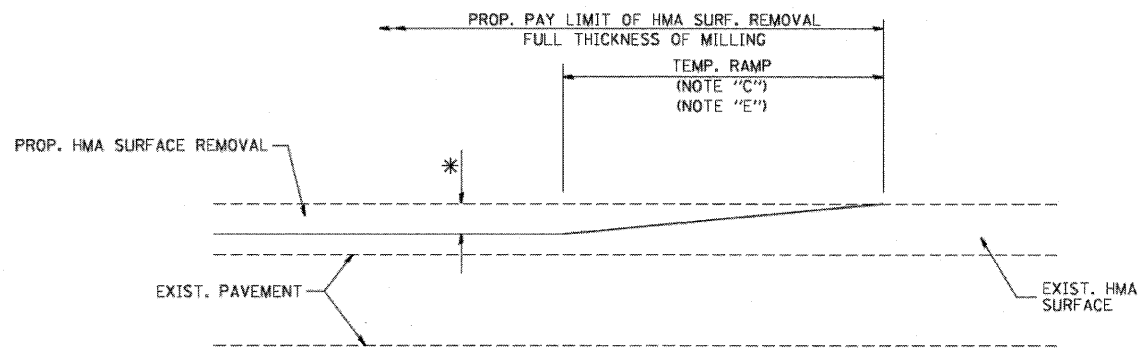

MILLED TEMPORARY RAMP  
(FOR BUTT JOINT AND HMA TAPER SEE DETAIL BELOW)

OPTION 1

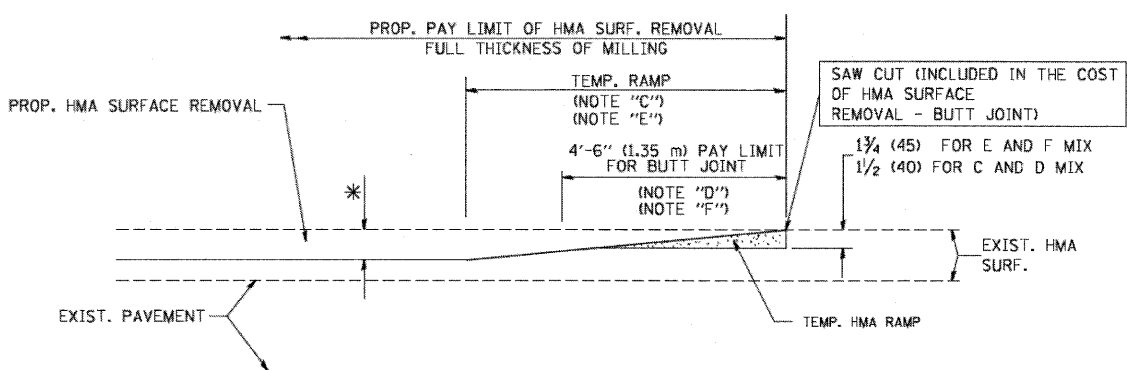

HMA CONSTRUCTED TEMPORARY RAMP  
(FOR BUTT JOINT AND HMA TAPER SEE DETAIL BELOW)

OPTION 2

TYPICAL TEMPORARY RAMP

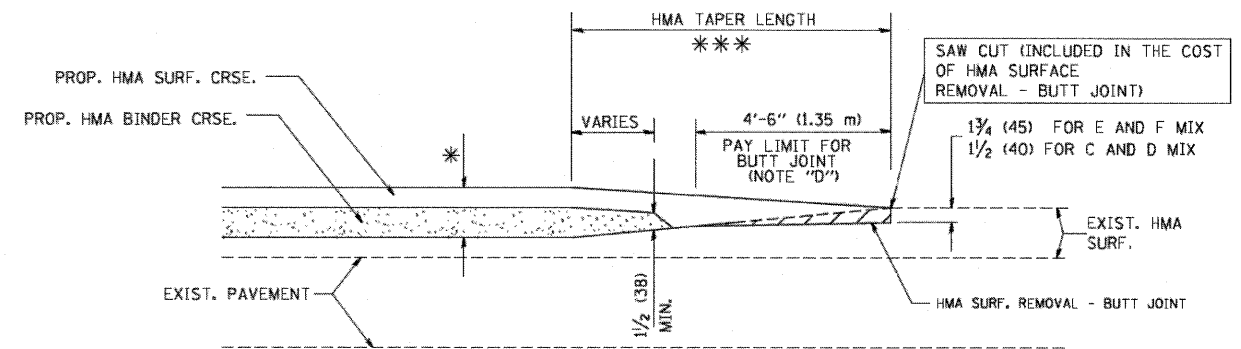

BUTT JOINT AND  
HMA TAPER

TYPICAL BUTT JOINT AND HMA TAPER  
FOR MILLING AND RESURFACING

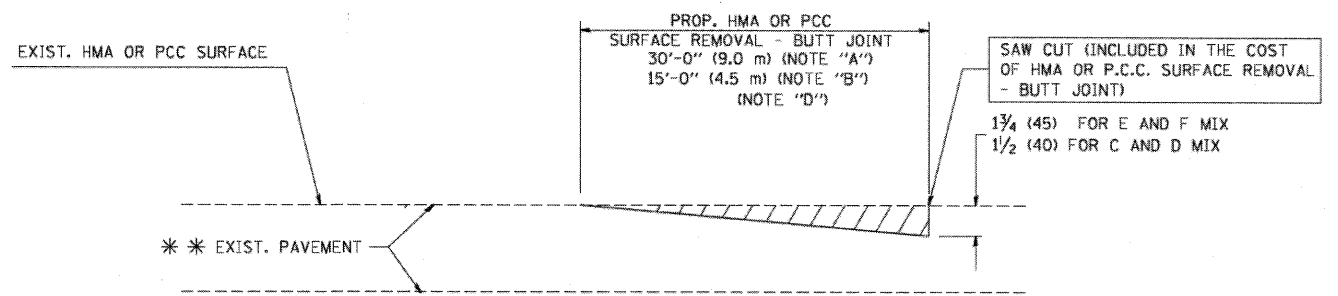

BUTT JOINT DETAIL

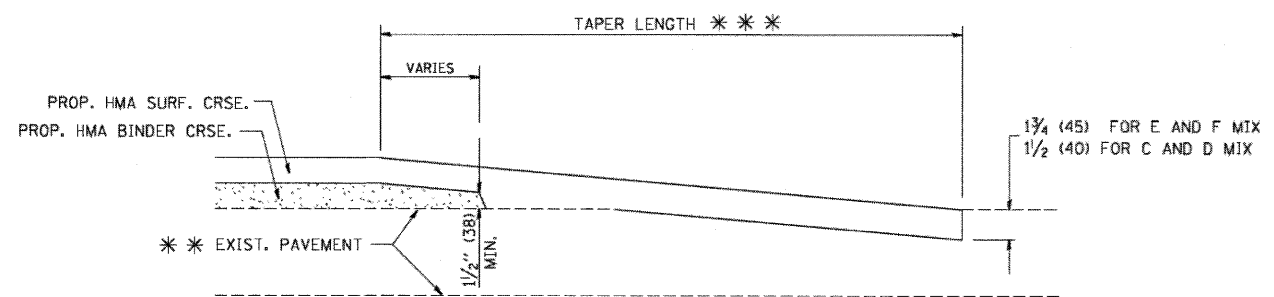

HMA TAPER DETAIL

TYPICAL BUTT JOINT AND HMA TAPER  
FOR RESURFACING ONLY

\*\* PC CONCRETE, HMA OR HMA RESURFACED PAVEMENT.

NOTES

- A: MAINLINE ROADWAYS AND MAJOR SIDE ROADS.
  - B: MINOR SIDE ROADS.
  - C: THE TEMP. RAMP SHALL BE CONSTRUCTED IMMEDIATELY UPON REMOVAL OF THE EXISTING HMA SURFACE.
  - D: THE BUTT JOINT SHALL BE CONSTRUCTED IMMEDIATELY PRIOR TO PLACING THE PROPOSED HMA COURSES.
  - E: TAPER THE TEMP. RAMP AT A RATE OF 3'-0" (900 mm) PER 1 INCH (25 mm) OF MILLING THICKNESS.
  - F: INSTALLATION AND REMOVAL OF THE 4'-6" (1.35 m) TEMP. RAMP IS INCLUDED IN COST OF HMA SURFACE REMOVAL - BUTT JOINT
  - G: SEE ARTICLE 406.08 AND 406.14 OF THE STANDARD SPECIFICATIONS FOR "HMA AND/OR PCC SURFACE REMOVAL, BUTT JOINT".
- \* SEE TYPICAL SECTIONS FOR MILLING THICKNESS.
- \*\*\* 20'-0" (6.1 m) PER 1 (25) RESURFACING (NOTE "A")  
10'-0" (3.0 m) PER 1 (25) RESURFACING (NOTE "B")

BASIS OF PAYMENT:

THE BUTT JOINT WILL BE PAID FOR AT THE CONTRACT UNIT PRICE PER SQUARE YARD (SQUARE METER) FOR "HOT-MIX ASPHALT SURFACE REMOVAL - BUTT JOINT" OR FOR "PORTLAND CEMENT CONCRETE SURFACE REMOVAL - BUTT JOINT".

ALL DIMENSIONS ARE IN INCHES (MILLIMETERS) UNLESS OTHERWISE SHOWN.

COPYRIGHT © 2011 BY BAXTER & WOODMAN, INC.  
 ALL RIGHTS RESERVED. NO PART OF THIS DOCUMENT MAY BE REPRODUCED OR TRANSMITTED IN ANY FORM OR BY ANY MEANS, ELECTRONIC OR MECHANICAL, INCLUDING PHOTOCOPYING, RECORDING, OR BY ANY INFORMATION STORAGE AND RETRIEVAL SYSTEM.  
 FILE NAME: \\s01c01\p01\proj\11-00053\00-RS\11-00053-00-RS-01.dgn  
 PLOT SCALE: 50.0000' / IN.  
 PLOT DATE: 1/4/2008

FILE NAME: \\s01c01\p01\proj\11-00053\00-RS\11-00053-00-RS-01.dgn	USER NAME: geglino	DESIGNED: M. DE YONG	REVISED: R. SHAH 10-25-94
		DRAWN: -	REVISED: A. ABBAS 03-21-97
		CHECKED: -	REVISED: M. GOMEZ 04-06-01
		DATE: 06-13-90	REVISED: R. BORO 01-01-07

STATE OF ILLINOIS  
DEPARTMENT OF TRANSPORTATION

SCALE: NONE		SHEET NO. 1 OF 1 SHEETS		STA.	TO STA.
-------------	--	-------------------------	--	------	---------

F.A.U. RTE. 1682	SECTION 11-00053-00-RS	COUNTY COOK	TOTAL SHEETS 15	SHEET NO. 12
BD400-05 BD32		CONTRACT NO. 63691		
FED. ROAD DIST. NO. 1 ILLINOIS FED. AID PROJECT				

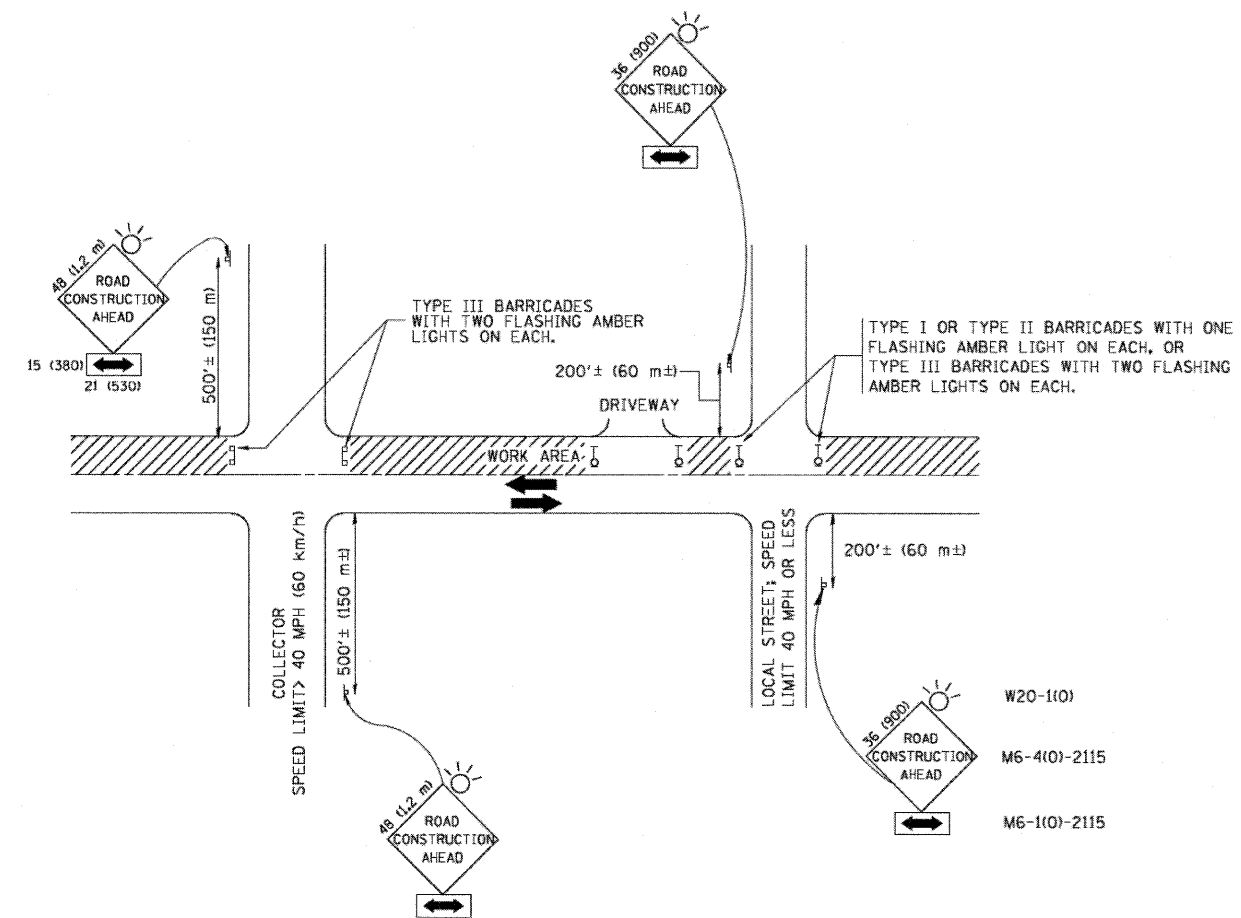

TRAFFIC CONTROL AND PROTECTION FOR SIDE ROADS, INTERSECTIONS, AND DRIVEWAYS

NOTES:

- A. FOR NO LANE RESTRICTION ON THE SIDE ROAD OR DRIVEWAYS
- B. FOR A LANE CLOSURE ON A SIDE ROAD OR DRIVEWAY:
- 1. SIDE ROAD WITH A SPEED LIMIT OF 40 MPH (60 km/h) OR LESS AS SHOWN ON THE DRAWING AND AS DIRECTED BY THE ENGINEER:
  - a) ONE ROAD CONSTRUCTION AHEAD SIGN 36 x 36 (900x900) WITH A FLASHER AND FLAG MOUNTED ON IT APPROXIMATELY 200' (60 m) IN ADVANCE OF THE MAIN ROUTE.
  - b) THE CLOSED PORTION OF THE MAIN ROUTE SHALL BE PROTECTED BY BLOCKING WITH TYPE I, TYPE II OR TYPE III BARRICADES, 1/3 OF THE CROSS SECTION OF THE CLOSED PORTION.
- 2. SIDE ROAD WITH A SPEED LIMIT GREATER THAN 40 MPH (60 km/h) AS SHOWN ON THE DRAWING AND AS DIRECTED BY THE ENGINEER:
  - a) ONE ROAD CONSTRUCTION AHEAD SIGN 48 x 48 (1.2 m x 1.2 m) WITH A FLASHER MOUNTED ON IT APPROXIMATELY 500' (150 m) IN ADVANCE OF THE MAIN ROUTE.
  - b) THE CLOSED PORTION OF THE MAIN ROUTE SHALL BE PROTECTED BY BLOCKING WITH TYPE III BARRICADES, 1/2 OF THE CROSS SECTION OF THE CLOSED PORTION.
- 3. WHEN THE SIDE ROAD LIES BETWEEN THE BEGINNING OF THE MAINLINE SIGNING AND THE WORK ZONE, A SINGLE HEADED ARROW (M6-1) SHALL BE USED IN LIEU OF THE DOUBLE HEADED ARROW (M6-4).
- USE APPLICABLE PORTIONS OF THE TYPICAL APPLICATION OF TRAFFIC CONTROL DEVICES (STD. 701501, STD. 701606 OR THE APPROPRIATE STANDARD). THE SPACING OF SIGNS AND BARRICADES SHALL BE ADJUSTED FOR FIELD CONDITIONS AS DIRECTED BY THE ENGINEER. THE DIRECTIONAL ARROW SHALL BE COVERED OR REMOVED WHEN NO LONGER CONSISTENT WITH THE SIDE ROAD LANE CLOSURE.
- C. ADVANCE WARNING SIGNS ARE TO BE OMITTED ON DRIVEWAY UNLESS OTHERWISE NOTED.
- D. THE TRAFFIC CONTROL AND PROTECTION FOR SIDE ROADS, INTERSECTIONS, AND DRIVEWAYS SHALL BE INCIDENTAL TO THE COST OF SPECIFIED TRAFFIC CONTROL STANDARDS OR ITEMS.

All dimensions are in millimeters (inches) unless otherwise shown.

COPYRIGHT © 2011 BY BAXTER & WOODMAN, INC. ALL RIGHTS RESERVED. PROFESSIONAL DESIGN AND DRAWING NO. 11-00053-00-RS. DATE: 2/2/2012. PROJECT: Ave. CADDUCKINS, DISTRICT ONE DETAILS - TC.dgn.

FILE NAME =	USER NAME = geglanoib	DESIGNED - LHA	REVISED - J. OBERLE 10-18-95
W:\diststd\22x34\1\1018.dgn		DRAWN -	REVISED - A. HOUSEH 03-06-96
		CHECKED -	REVISED - A. HOUSEH 10-15-96
		DATE - 06-89	REVISED - T. RAMMACHER 01-06-00

STATE OF ILLINOIS  
DEPARTMENT OF TRANSPORTATION

TRAFFIC CONTROL AND PROTECTION FOR  
SIDE ROADS, INTERSECTIONS, AND DRIVEWAYS

SCALE: NONE SHEET NO. 1 OF 1 SHEETS STA. TO STA.

F.A.U. RTE.	SECTION	COUNTY	TOTAL SHEETS	SHEET NO.
1682	11-00053-00-RS	COOK	15	13
TC-10			CONTRACT NO. 63691	
FED. ROAD DIST. NO. 1 (ILLINOIS) FED. AID PROJECT				

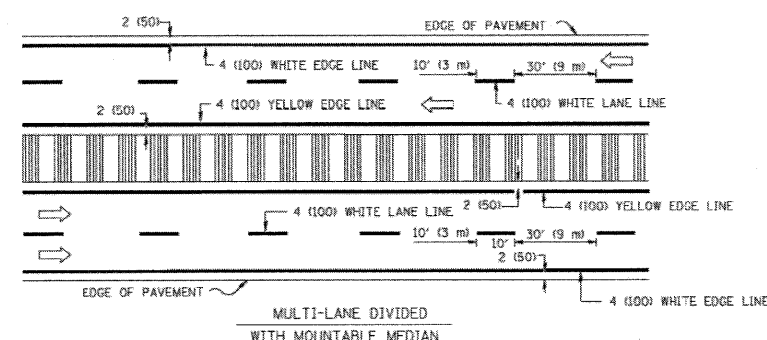
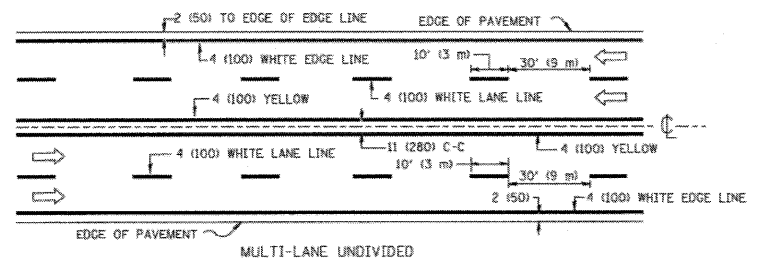
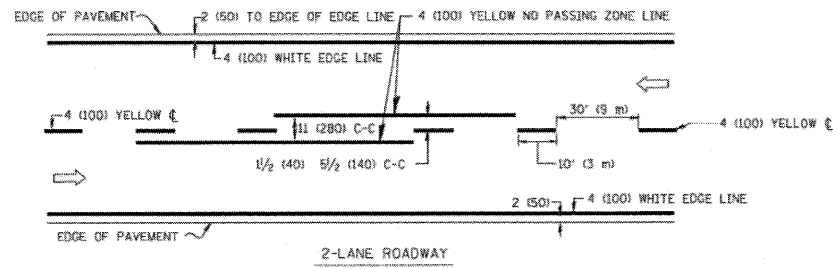

NOTE: MEDIANS WITH BARRIER CURB DO NOT REQUIRE AN EDGE LINE

TYPICAL LANE AND EDGE LINE MARKING

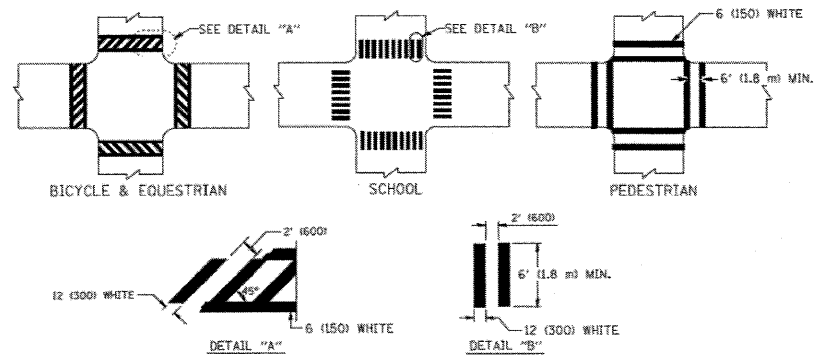

TYPICAL CROSSWALK MARKING

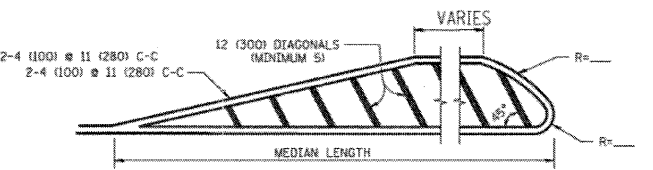
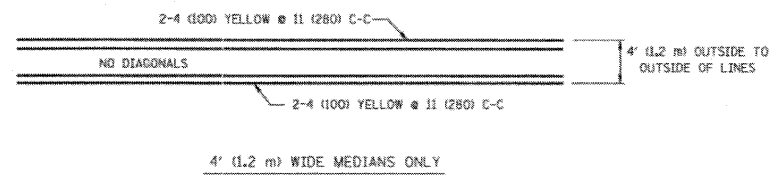

FOR MEDIAN LENGTHS WHERE DIAGONAL SPACING CANNOT BE ATTAINED, USE 5 (FIVE) EQUALLY SPACED DIAGONAL LINES.  
 DIAGONAL LINE SPACING: 50' (15 m) C-C (LESS THAN 30MPH (50 km/h))  
 75' (25 m) C-C 30MPH (50 km/h) TO 45MPH (70 km/h)  
 150' (45 m) C-C (MORE THAN 45MPH (70 km/h))

MEDIANS OVER 4' (1.2 m) WIDE

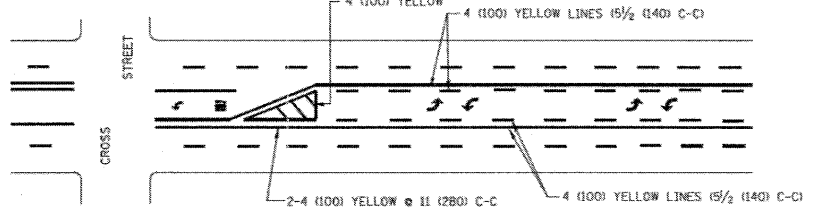

A MINIMUM OF TWO PAIRS OF TURN ARROWS SHALL BE USED, WHITE IN COLOR. ADDITIONAL PAIRS SHALL BE PLACED AT 200' (60 m) TO 300' (90 m) INTERVALS.

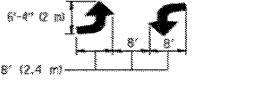

TYPICAL PAINTED MEDIAN MARKING

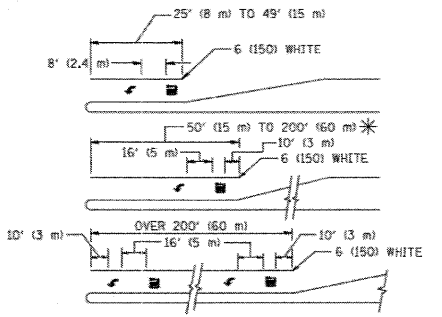

FULL SIZE LETTERS 8' (2.4 m) AND ARROWS SHALL BE USED.  
 AREA = 15.6 SQ. FT. (1.5 m<sup>2</sup>) [Symbol] AREA = 20.8 SQ. FT. (1.9 m<sup>2</sup>)  
 \* TURN LANES IN EXCESS OF 400' (120 m) IN LENGTH MAY HAVE AN ADDITIONAL SET OF ARROW - "ONLY" INSTALLED MIDWAY BETWEEN THE OTHER TWO SETS OF ARROW - "ONLY".

TYPICAL LEFT (OR RIGHT) TURN LANE

TYPICAL TURN LANE MARKING

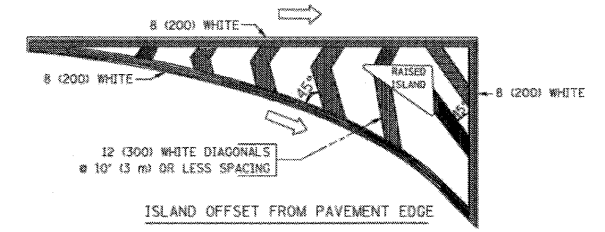

ISLAND OFFSET FROM PAVEMENT EDGE

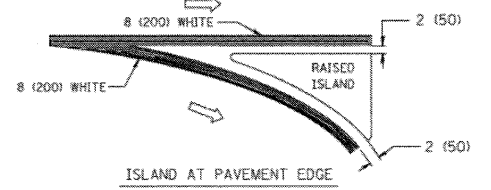

ISLAND AT PAVEMENT EDGE

TYPICAL ISLAND MARKING

TYPE OF MARKING	WIDTH OF LINE	PATTERN	COLOR	SPACING / REMARKS
CENTERLINE ON 2 LANE PAVEMENT	4 (100)	SKIP-DASH	YELLOW	10' (3 m) LINE WITH 30' (9 m) SPACE
CENTERLINE ON MULTI-LANE UNDIVIDED PAVEMENT	2 @ 4 (100)	SOLID	YELLOW	11 (280) C-C
NO PASSING ZONE LINES: FOR ONE DIRECTION FOR BOTH DIRECTIONS	4 (100) 2 @ 4 (100)	SOLID SOLID	YELLOW YELLOW	5 1/2 (140) C-C FROM SKIP-DASH CENTERLINE 11 (280) C-C OMIT SKIP-DASH CENTERLINE BETWEEN
LANE LINES	4 (100) 5 (125) ON FREEWAYS	SKIP-DASH SKIP-DASH	WHITE WHITE	10' (3 m) LINE WITH 30' (9 m) SPACE
DOTTED LINES (EXTENSIONS OF CENTER, LANE OR TURN LANE MARKINGS)	SAME AS LINE BEING EXTENDED	SKIP-DASH	SAME AS LINE BEING EXTENDED	2' (600) LINE WITH 6' (1.8 m) SPACE
EDGE LINES	4 (100)	SOLID	YELLOW-LEFT WHITE-RIGHT	OUTLINE MOUNTABLE MEDIANS IN YELLOW; FOG LINES ARE NOT USED NEXT TO BARRIER CURB
TURN LANE MARKINGS	6 (150) LINE; FULL SIZE LETTERS & SYMBOLS 18" (4.4m)	SOLID	WHITE	SEE TYPICAL TURN LANE MARKING DETAIL
TWO WAY LEFT TURN MARKING	2 @ 4 (100) EACH DIRECTION 8' (2.4m) LEFT ARROW	SKIP-DASH AND SOLID IN PAIRS	YELLOW WHITE	10' (3 m) LINE WITH 30' (9 m) SPACE FOR SKIP-DASH; 5 1/2 (140) C-C BETWEEN SOLID LINE AND SKIP-DASH LINE SEE TYPICAL TWO-WAY LEFT TURN MARKING DETAIL
CROSSWALK LINES (PEDESTRIAN) A. DIAGONALS (BIKE & EQUESTRIAN) B. LONGITUDINAL BARS (SCHOOL)	2 @ 6 (150) 12 (300) @ 45° 12 (300) @ 90°	SOLID SOLID SOLID	WHITE WHITE WHITE	NOT LESS THAN 6' (1.8 m) APART 2' (600) APART 2' (600) APART SEE TYPICAL CROSSWALK MARKING DETAILS.
STOP LINES	24 (600)	SOLID	WHITE	PLACE 4' (1.2 m) IN ADVANCE OF AND PARALLEL TO CROSSWALK, IF PRESENT. OTHERWISE, PLACE AT DESIRED STOPPING POINT, PARALLEL TO CROSSROAD CENTERLINE, WHERE POSSIBLE
PAINTED MEDIANS	2 @ 4 (100) WITH 12 (300) DIAGONALS @ 45° NO DIAGONALS USED FOR 4' (1.2 m) WIDE MEDIANS	SOLID	YELLOW: TWO WAY TRAFFIC WHITE: ONE WAY TRAFFIC	11 (280) C-C FOR THE DOUBLE LINE SEE TYPICAL PAINTED MEDIAN MARKING.
GORE MARKING AND CHANNELIZING LINES	8 (200) WITH 12 (300) DIAGONALS @ 45°	SOLID	WHITE	DIAGONALS: 15' (4.5 m) C-C (LESS THAN 30MPH (50 km/h)) 20' (6 m) C-C 30MPH (50 km/h) TO 45MPH (70 km/h) 30' (9 m) C-C (OVER 45MPH (70 km/h))
RAILROAD CROSSING	24 (600) TRANSVERSE LINES; "RR" 15' (4.5 m) LETTERS; 16 (400) LINE FOR "X"	SOLID	WHITE	SEE STATE STANDARD 780001 AREA OF "RR": 3.6 SQ. FT. (0.33 m <sup>2</sup> ) EACH "X": 54.0 SQ. FT. (5.0 m <sup>2</sup> )
SHOULDER DIAGONALS	12 (300) @ 45°	SOLID	WHITE - RIGHT YELLOW - LEFT	50' (15 m) C-C (LESS THAN 30MPH (50 km/h)) 75' (25 m) C-C (30 MPH (50 km/h) TO 45MPH (70 km/h)) 150' (45 m) C-C (OVER 45MPH (70 km/h))

FOR FURTHER DETAILS ON PAVEMENT MARKING REFER TO STANDARD SPECIFICATIONS FOR ROAD AND BRIDGE CONSTRUCTION AND STATE STANDARD 780001.

All dimensions are in inches (millimeters) unless otherwise shown.

COPYRIGHT © 2011 BY BAYLER & WOODMAN, INC.  
 STATE OF ILLINOIS - PROFESSIONAL DESIGN FIRM  
 LICENSE NO. 186-2001-EXPRES 06/20/2011  
 2/2/2012 06:28:57 AM  
 \\snpdr\ad\in\Default\h...  
 CAD\DWG\105\105.DWG  
 IN:\P\105\105.DWG  
 Author: AAVECADD\DRS\WRODS\DISTRICT ONE DETAILS - TC-09P

FILE NAME =	USER NAME = drvakasn	DESIGNED - EVERS	REVISED - T. RAMMACHER 10-27-94
ca:\p\work\pavdot\drvakasn\105\105.dgn		DRAWN -	REVISED - C. JUCCUS 09-09-09
	PLOT SCALE = 50.000' / IN.	CHECKED -	REVISED -
	PLOT DATE = 9/9/2009	DATE - 03-19-90	REVISED -

STATE OF ILLINOIS  
DEPARTMENT OF TRANSPORTATION

DISTRICT ONE		F.A.U. RTE. 1682	SECTION 11-00053-00-RS	COUNTY COOK	TOTAL SHEETS 15	SHEET NO. 14
TYPICAL PAVEMENT MARKINGS		TC-13		CONTRACT NO. 63691		
SCALE: NONE	SHEET NO. 1 OF 1 SHEETS	STA. TO STA.	FED. ROAD DIST. NO. 1 ILLINOIS FED. AID PROJECT			

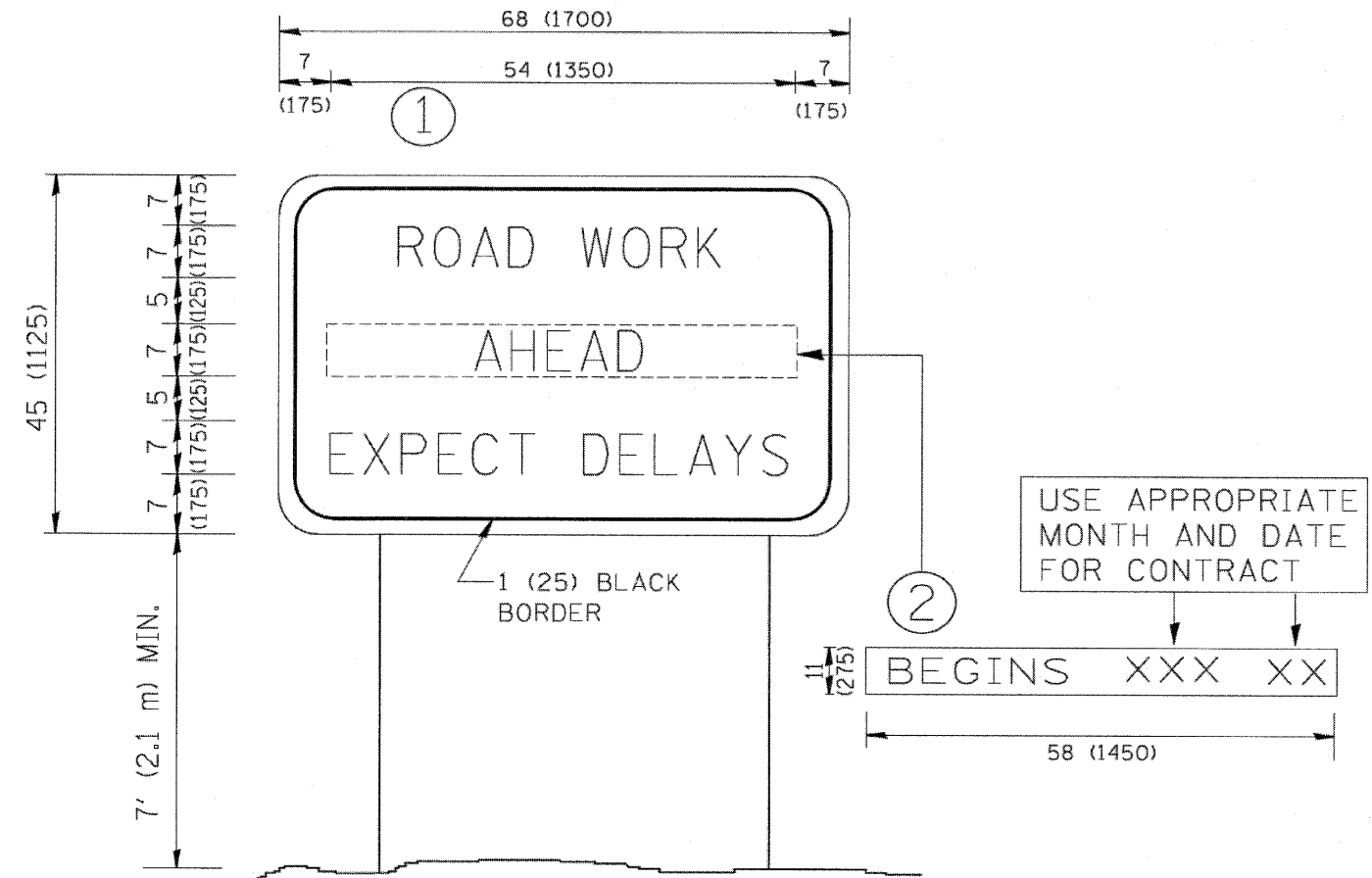

**NOTES:**

1. USE BLACK LETTERING ON ORANGE BACKGROUND.
2. ERECT SIGNS IN ADVANCE OF THE LOCATION FOR THE "ROAD CONSTRUCTION AHEAD" SIGN AT LOCATIONS AS DIRECTED BY THE ENGINEER.
3. ERECT SIGN ① WITH INSTALLED PANEL ② ONE WEEK PRIOR TO THE START OF CONSTRUCTION.
4. REMOVE PANEL ② SOON AFTER THE START OF CONSTRUCTION.
5. SEE SPECIAL PROVISION FOR "TEMPORARY INFORMATION SIGNING" FOR ADDITIONAL INFORMATION.
6. ONE SIGN ASSEMBLY EQUALS 25.70 SQ. FT. (2.3 SQ. M.)
7. SHALL BE PAID FOR AS TEMPORARY INFORMATION SIGNING.

ALL DIMENSIONS ARE IN INCHES (MILLIMETERS) UNLESS OTHERWISE SHOWN.

COPYRIGHT © 2011 BY BAXTER & WOODMAN, INC.  
 ALL RIGHTS RESERVED. NO PART OF THIS DOCUMENT MAY BE REPRODUCED OR TRANSMITTED IN ANY FORM OR BY ANY MEANS, ELECTRONIC OR MECHANICAL, INCLUDING PHOTOCOPYING, RECORDING, OR BY ANY INFORMATION STORAGE AND RETRIEVAL SYSTEM.  
 LICENSE NO. 184-00101 - EXPIRES 4/30/2011  
 2/2/2011 10:09:57 AM  
 W:\diststd\22x34\to22.dgn

FILE NAME *	USER NAME * geglennob	DESIGNED -	REVISED - R. MIRS 09-15-97
W:\diststd\22x34\to22.dgn		DRAWN -	REVISED - R. MIRS 12-11-97
	PLOT SCALE * 50.000 "/ IN.	CHECKED -	REVISED - T. RAMMACHER 02-02-99
	PLOT DATE * 1/4/2008	DATE -	REVISED - C. JUCLIS 01-31-07

**STATE OF ILLINOIS  
DEPARTMENT OF TRANSPORTATION**

**ARTERIAL ROAD  
INFORMATION SIGN**

SCALE: NONE SHEET NO. 1 OF 1 SHEETS STA. TO STA.

F.A.U. RTE.	SECTION	COUNTY	TOTAL SHEETS	SHEET NO.
1682	11-00053-00-RS	COOK	15	15
<b>TC-22</b>		<b>CONTRACT NO. 63691</b>		
FED. ROAD DIST. NO. 1 ILLINOIS FED. AID PROJECT				