

PAINTING DETAILS

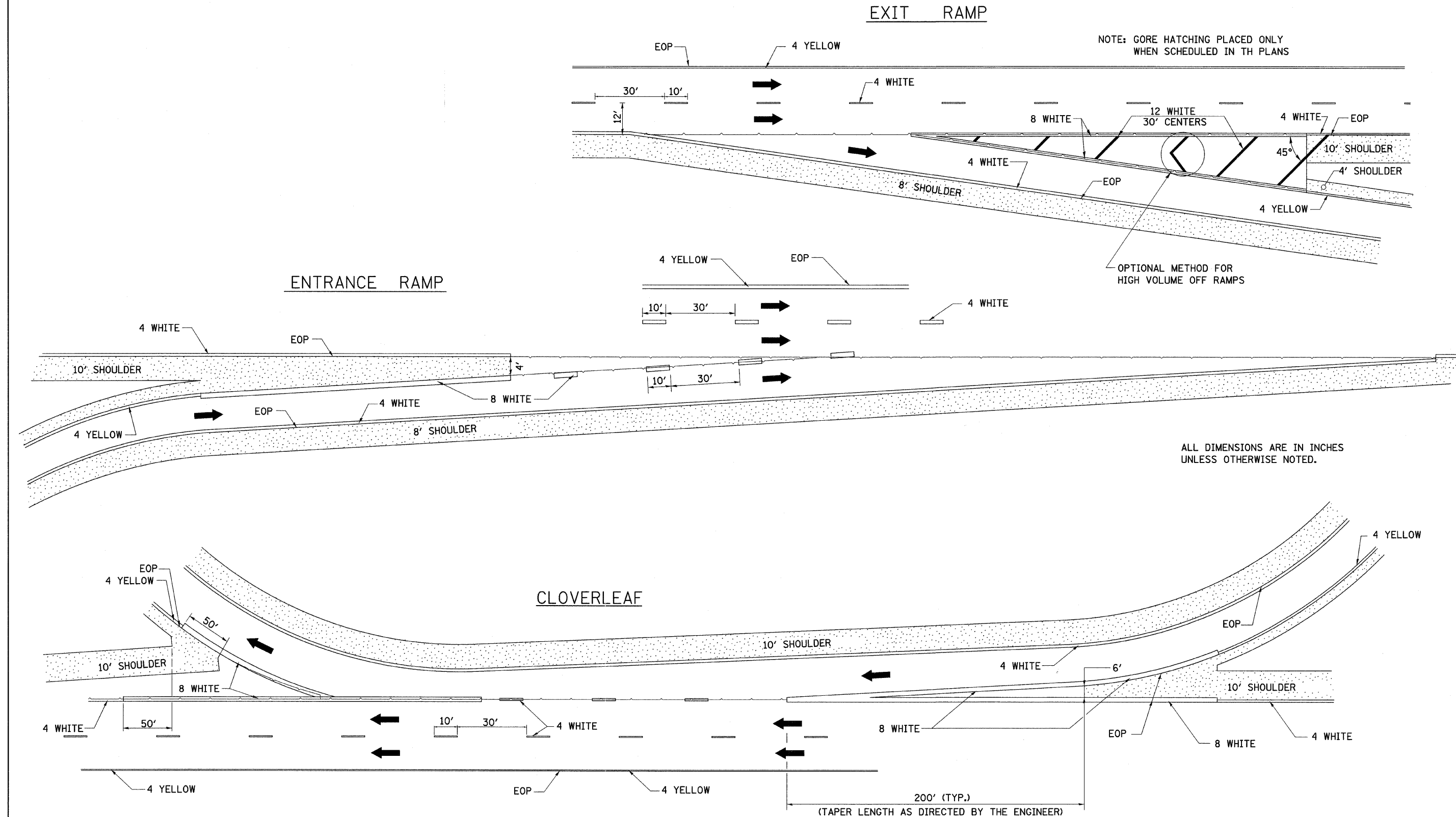

FILE NAME =	USER NAME = IDOT	DESIGNED -	REVISED - 10-18-11	STATE OF ILLINOIS DEPARTMENT OF TRANSPORTATION	REGION 2 / DISTRICT 2 STANDARD	F.A.S. RTE. 205	SECTION (81-2HB-1)M	COUNTY ROCK ISLAND	TOTAL SHEETS 29	SHEET NO. 29
1:\182704\Fas205\74\cadd sheets\0264H7	shd-STD44.dgn	DRAWN -	REVISED -	SCALE: SHEET NO. OF SHEETS STA. TO STA.		CONTRACT NO. 64H71				
	PLOT SCALE = 50,0000' / IN.	CHECKED -	REVISED -			FED. ROAD DIST. NO. 1 ILLINOIS FED. AID PROJECT				
	PLOT DATE = 1/24/2012	DATE -	REVISED -							