

EROSION AND SEDIMENT CONTROL NOTES

1. PLACE PERIMETER EROSION CONTROL BARRIER PRIOR TO ANY EARTH DISTURBING OR GRADING ACTIVITIES.
2. PLACE THE TURBIDITY CURTAIN IN BIG BUREAU CREEK PRIOR TO ANY EARTH DISTURBING OR GRADING ACTIVITIES IN THE VICINITY OF THE CREEK.
3. THE CONTRACTOR MUST TAKE MEASURES TO MINIMIZE SOIL TRACKED ONTO PUBLIC AND PRIVATE ROADS. ANY SEDIMENT REACHING A PUBLIC OR PRIVATE ROAD SHALL BE REMOVED BY SHOVELLING OR STREET CLEANING (NOT FLUSHING) BEFORE THE END OF EACH WORK DAY AND TRANSFERED TO A CONTROLLED SEDIMENT DISPOSAL AREA.
4. TEMPORARY SEED ANY BARE EARTH OR DISTURBED AREAS EVERY 7 DAYS (CRITICAL LOCATIONS WITHIN 48 HOURS) IN ACCORDANCE WITH ARTICLE 280.04 OF THE STANDARD SPECIFICATIONS.

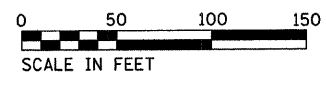
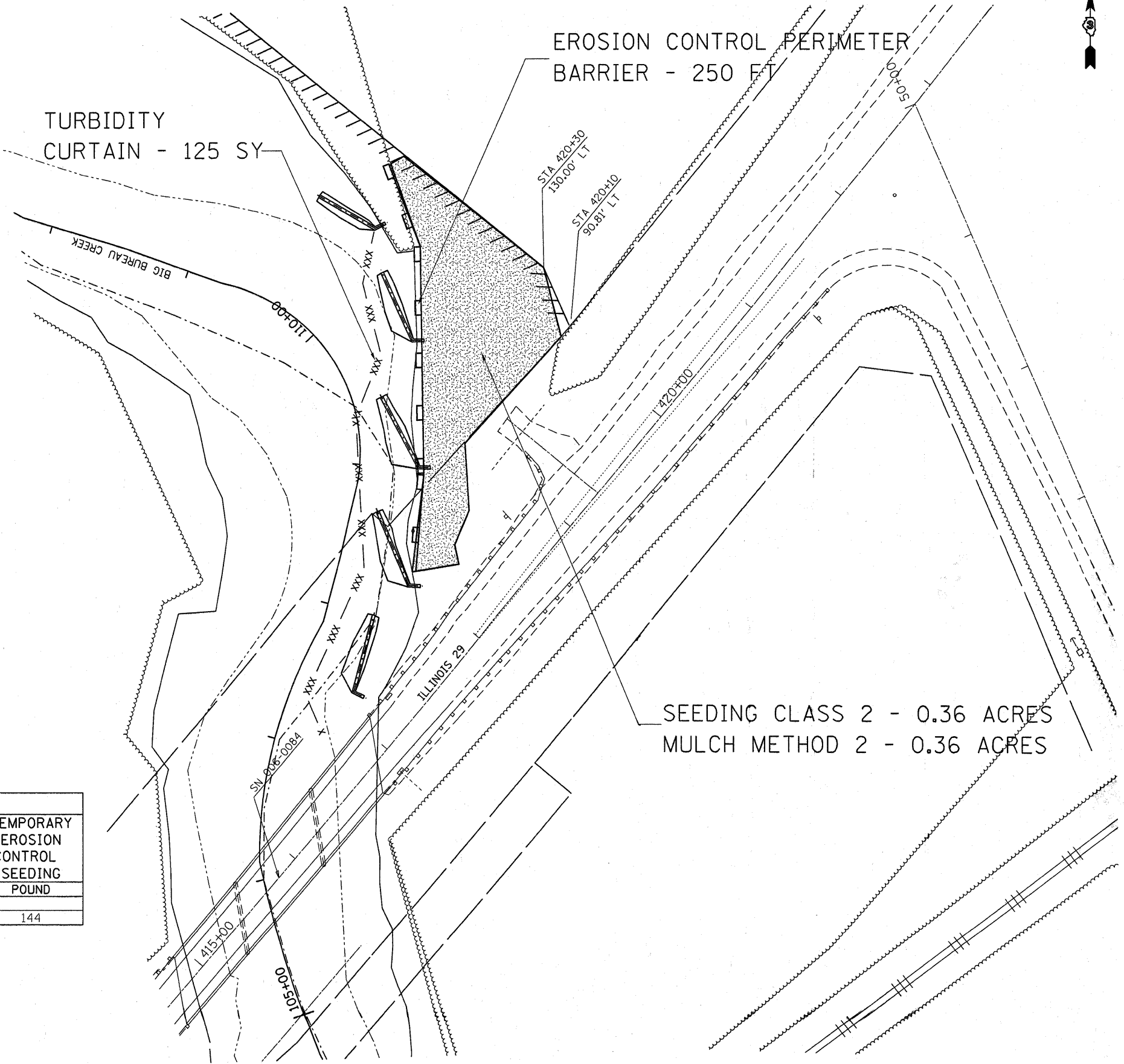

EROSION CONTROL AND LANDSCAPING SCHEDULE							
TURBIDITY CURTAIN	EROSION CONTROL PERIMETER BARRIER	SEEDING CLASS 2	MULCH METHOD 2	NITROGEN FERTILIZER NUTRIENT	PHOSPHORUS FERTILIZER NUTRIENT	POTASSIUM FERTILIZER NUTRIENT	TEMPORARY EROSION CONTROL SEEDING
SY	FOOT	ACRE	ACRE	POUND	POUND	POUND	POUND
110	250	0.36	0.36	33	33	33	144

- NOTE: TEMPORARY SEEDING QUANTITY INCLUDED FOR 4 APPLICATIONS
- SEE SPECIAL PROVISIONS FOR INSTALLATION OF TURBIDITY CURTAIN