

LOCATION 5
 I-39 (SB)
 0.18 MILES NORTH OF
 CO HWY 19 (N 3973 RD.)
 UTILITY PROVIDER: AMEREN
 OVERHEAD SIGN STR.
 (LAT: 41.50656, LONG: -89.05131)

LOCATION 2
 I-80 (EB)
 1.11 MI WEST
 OF CO HWY 56 (PLANK RD.)
 UTILITY PROVIDER: AMEREN
 OVERHEAD SIGN STR.
 (LAT: 41.36431, LONG: -89.17375)

LOCATION 9
 I-80 (WB)
 0.86 MILES EAST OF E. 10TH RD.
 UTILITY PROVIDER: AMEREN
 BUTTERFLY SIGN STR.
 (LAT: 41.36820, LONG: -88.95548)

LOCATION 1
 I-80 (WB)
 0.98 MILES EAST OF EAST 22ND RD.
 UTILITY PROVIDER: AMEREN
 OVERHEAD SIGN STR.
 (LAT: 41.37553, LONG: -88.72710)

LOCATION 8
 I-57 (SB)
 1.37 MILES NORTH
 OF 6000 N ROAD
 UTILITY PROVIDER: COM ED.
 OVERHEAD SIGN STR.
 (LAT: 41.22625, LONG: -87.86420)

LOCATION 6
 I-39 (SB)
 0.68 MILES NORTH OF
 US RT 6 AND I- 39 INTRCHG.
 UTILITY PROVIDER: AMEREN
 BUTTERFLY SIGN STR
 (LAT: 41.35098, LONG: -89.06390)

LOCATION 4
 I-39 (NB)
 0.35 MILES NORTH OF
 I-39 & IL 251 INTERCHANGE.
 UTILITY PROVIDER: AMEREN
 BUTTERFLY SIGN STR
 (LAT: 41.28120, LONG: -89.08177)

LOCATION 7
 I-57 (NB)
 0.13 MILES SOUTH OF
 W 5000 S RD. (OTTO RD.)
 UTILITY PROVIDER: COM ED.
 OVERHEAD SIGN STR.
 (LAT: 41.04551, LONG: -87.89155)

LOCATION 3
 I-39 (NB)
 0.58 MILES NORTH OF
 CO HWY 54 (N 20TH RD.)
 UTILITY PROVIDER: COM ED.
 OVERHEAD SIGN STR.
 (LAT: 41.22975, LONG: -89.07766)

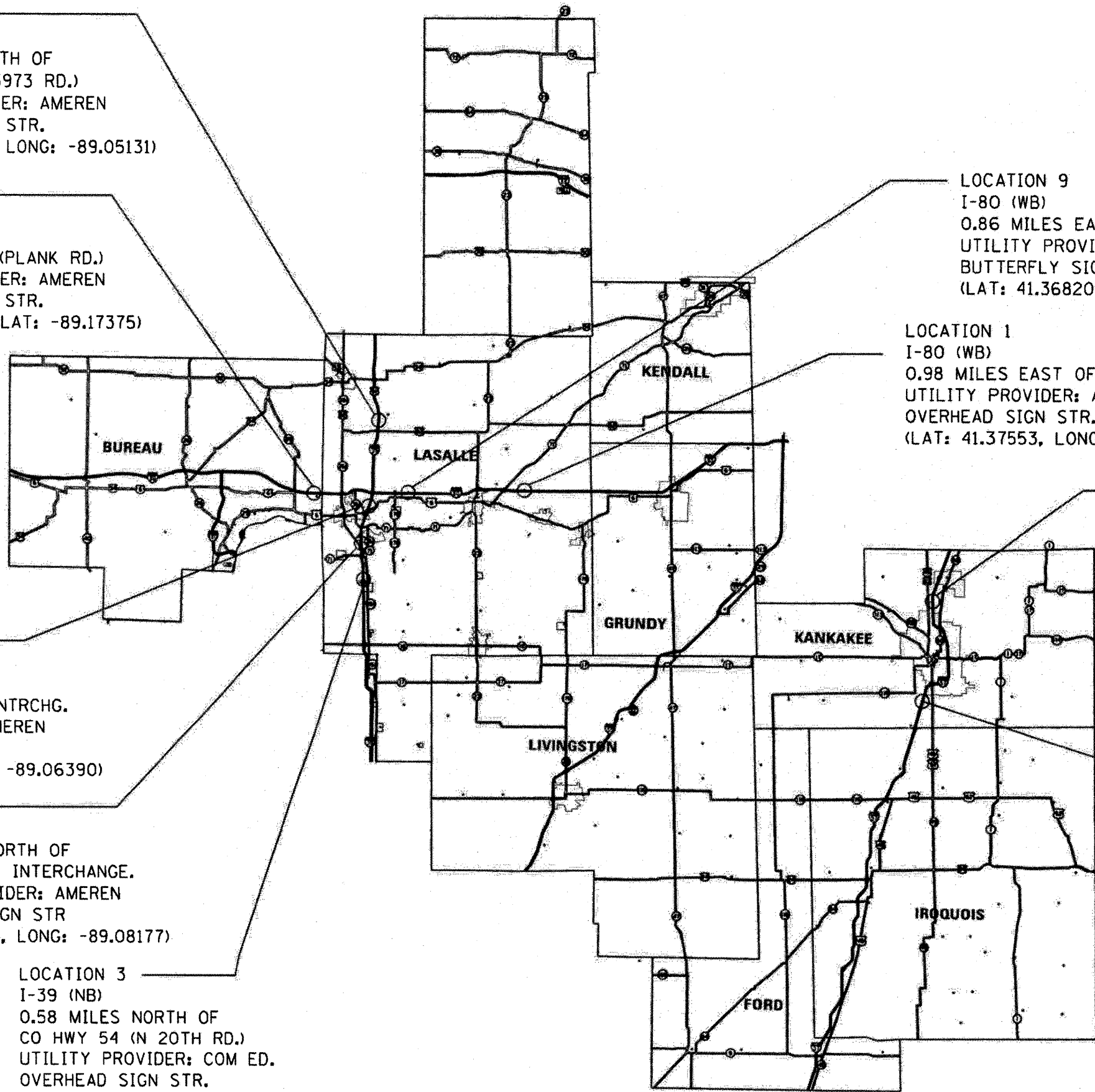

FILE NAME: 1	USER NAME: jpetely	DESIGNED: -	REVISED: -
0:\work\pilot\petely\02298292\0306	20-ent-data\1s.DGN	DRAWN: -	REVISED: -
		CHECKED: -	REVISED: -
		DATE: -	REVISED: -

STATE OF ILLINOIS
 DEPARTMENT OF TRANSPORTATION

LOCATION MAP
 SCALE: _____ SHEET NO. 1 OF 1 SHEETS STA. _____ TO STA. _____

F.A.I. RTE.	SECTION	COUNTY	TOTAL SHEETS	SHEET NO.
VAR	03 OVD MESSAGE SG - 2012	VAR	50	5
		CONTRACT NO. 66B28		
ILLINOIS				