

04-27-12 LETTING ITEM 097

STATE OF ILLINOIS
DEPARTMENT OF TRANSPORTATION
DIVISION OF HIGHWAYS

**PROPOSED
HIGHWAY PLANS**

FAS ROUTE 522 (SIDNEY-LONGVIEW RD.)
SECTION (41)RS

RESURFACING
CHAMPAIGN COUNTY

C-95-039-11

BLOCK RD. TO FAS 526 (BONGARD RD.)

F.A.S. RTE.	SECTION	COUNTY	TOTAL SHEETS	SHEET NO.
522	(41)RS	Champaign	23	1
		ILLINOIS	CONTRACT NO. 70930	

D-95-039-11

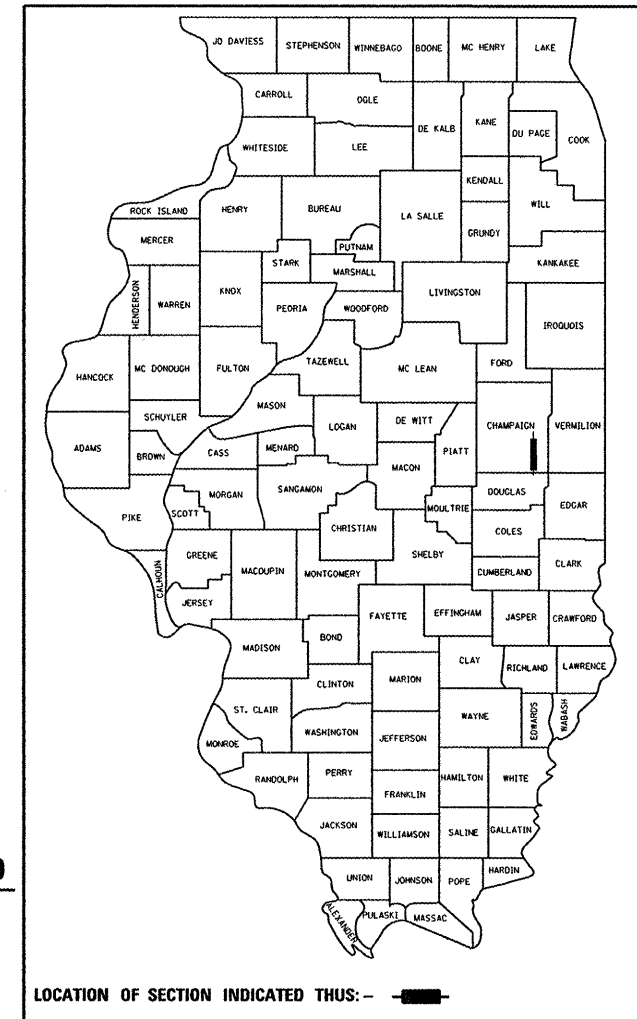

LOCATION OF SECTION INDICATED THIS: -

FOR INDEX OF SHEETS, SEE SHEET NO. 2
FOR SUMMARY OF QUANTITIES, SEE SHEET NO. 4

DESIGN DESIGNATION:
MAJOR COLLECTOR

CURRENT ADT: (2011)
550

BRIDGE OMISSION S.N. 010-0244
STA. 332 + 91 TO STA. 333 + 63

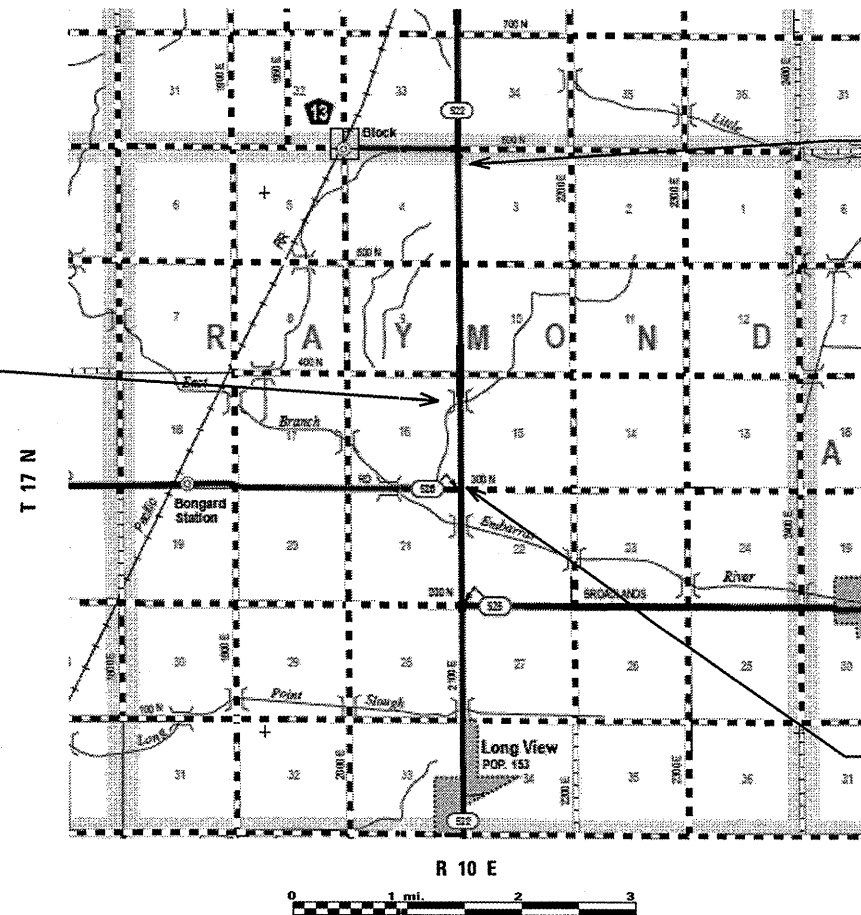

PROJECT BEGINS, STA. 217 + 49

PROJECT ENDS, STA. 372 + 12.5

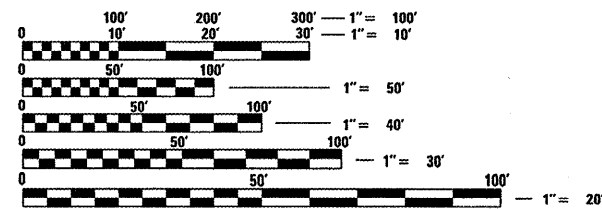

FULL SIZE PLANS HAVE BEEN PREPARED USING STANDARD ENGINEERING SCALES. REDUCED SIZED PLANS WILL NOT CONFORM TO STANDARD SCALES. IN MAKING MEASUREMENTS ON REDUCED PLANS, THE ABOVE SCALES MAY BE USED.

J.U.L.I.E.
JOINT UTILITY LOCATION INFORMATION FOR EXCAVATION
1-800-892-0123
OR 811 RAYMOND TOWNSHIP

PROJECT ENGINEER: JASON STULTS (217-465-4181)
PROJECT MANAGER: RUSTIN KEYS
DESIGNER : KARY DAWSON
CONTRACT NO. 70930

GROSS LENGTH = 15,463.50 FT. = 2.929 MILE
NET LENGTH = 15,391.50 FT. = 2.915 MILE

STATE OF ILLINOIS
DEPARTMENT OF TRANSPORTATION
DIVISION OF HIGHWAYS
SUBMITTED 0130 20 12
Joseph E. Lewis (HAW)
DEPUTY DIRECTOR OF HIGHWAYS, REGION ENGINEER
March 23 20 12
John D. Baranzelli, P.E. I&E
Acting ENGINEER OF DESIGN AND ENVIRONMENT
March 23 20 12
William R. Frey I&E
Acting DIRECTOR OF HIGHWAYS, CHIEF ENGINEER

PRINTED BY THE AUTHORITY
OF THE STATE OF ILLINOIS

INDEX OF SHEETS

<u>SHEET NO.</u>	<u>DESCRIPTION</u>
1	COVER SHEET
2	INDEX OF SHEETS & LIST OF HIGHWAY STANDARDS
3	GENERAL NOTES
4	SUMMARY OF QUANTITIES
5-8	EXISTING & PROPOSED TYPICAL SECTIONS
9-10	SCHEDULES OF QUANTITIES
11-16	PLAN SHEETS
17	BUTT JOINT AND RESURFACING TRANSITION DETAILS
18	PRIVATE ENTRANCE, FIELD ENTRANCE, AND MAILBOX TURNOUT DETAILS
19-22	PAVEMENT MARKING AND MARKERS (RURAL & URBAN APPLICATIONS) DETAIL
23	SURVEY MONUMENT COVER ASSEMBLY DETAIL

HIGHWAY STANDARDS

<u>STANDARD NO.</u>	<u>DESCRIPTION</u>
000001-06	STANDARD SYMBOLS, ABBREVIATIONS AND PATTERNS
001006	DECIMAL OF AN INCH AND OF A FOOT
667101-02	PERMANENT SURVEY MARKERS
701301-04	LANE CLOSURE, 2L, 2W, SHORT TIME OPERATIONS
701306-03	LANE CLOSURE, 2L, 2W, SLOW MOVING OPERATIONS DAY ONLY, FOR SPEEDS \geq 45 MPH
701311-03	LANE CLOSURE, 2L, 2W, MOVING OPERATIONS-DAY ONLY
701901-02	TRAFFIC CONTROL DEVICES
780001-03	TYPICAL PAVEMENT MARKINGS

FILE NAME =	USER NAME = dawsomb	DESIGNED -	REVISED -	STATE OF ILLINOIS DEPARTMENT OF TRANSPORTATION	INDEX OF SHEETS AND HIGHWAY STANDARDS	F.A.S. RTE.	SECTION	COUNTY	TOTAL SHEETS	SHEET NO.
c:\pwork\p\idat\dawsomb\0208666\050930-sht-genote.dgn	0930-sht-genote.dgn	DRAWN -	REVISED -			522	(4)RS	Champaign	23	2
PLOT SCALE = 48,0000' / in.	CHECKED -	REVISED -	REVISED -			CONTRACT NO. 70930				
PLOT DATE = 1/31/2012	DATE -	REVISED -	REVISED -		SCALE: _____	SHEET _____	OF _____	SHEETS	STA. _____	TO STA. _____
ILLINOIS FED. AID PROJECT										

GENERAL NOTES

G.N.-100
ENGLISH UNITS OF MEASUREMENT SHALL GOVERN OVER AND SUPERSEDE ANY METRIC UNITS SHOWN IN THIS CONTRACT. WHERE INCLUDED, METRIC UNITS ARE FOR INFORMATION ONLY.

G.N.-100A
ELECTRONIC FILES AND/OR ELECTRONIC SURVEY INFORMATION INCLUDING CADD FILES WILL NOT BE AVAILABLE TO THE CONTRACTOR.

G.N.-105.09A
ALL ELEVATIONS SHOWN IN THE PLANS ARE BASED ON NORTH AMERICAN VERTICAL DATUM OF 1988. (NAVD 88)

G.N.-107.37
UTILITY LINES WERE PLOTTED FROM INFORMATION FURNISHED BY THE VARIOUS UTILITY COMPANIES INVOLVED (QUALITY LEVEL C &/OR QUALITY LEVEL D) AND THE ACCURACY SHOULD BE CONSIDERED APPROXIMATE ONLY. UTILITY COMPANIES MAY BE ADJUSTING THEIR FACILITIES DURING CONSTRUCTION. THE CONTRACTOR SHALL COOPERATE WITH THESE ORGANIZATIONS WHILE THESE ADJUSTMENTS ARE BEING PERFORMED. J.U.L.I.E. - JOINT UTILITY LOCATION INFORMATION FOR EXCAVATORS SYSTEM (800)892-0123 OR 811.

G.N.-403 (SPEC.)
BITUMINOUS SURFACE TREATMENTS:
GRADATION CA-16 (MID-SPEC.) IS ASSUMED FOR SEAL COATS.

THE RESULTING TARGET APPLICATION RATES ARE AS FOLLOWS:

TYPE OF CONSTRUCTION	BITUMINOUS MATERIAL	APPLICATION RATE	AGGREGATE	APPLICATION RATE
A-1	HFP OR CRSP OIL	0.5 GAL/SQ.YD	CA-16	25 LB/SQ.YD

NOTE: THE ENGINEER RESERVES THE RIGHT TO ADJUST THE TARGET APPLICATION RATES AND THE QUANTITIES.

*NOTE: DO NOT PUDDLE PRIME.

G.N.-406 (SPEC.)
THE QUANTITIES INCLUDED IN THE PLANS FOR COLD-MIX ASPHALT RESURFACING ARE INTENDED TO GIVE THE COVERAGE SHOWN ON THE TYPICAL CROSS SECTIONS. IT IS NOT INTENDED TO INCREASE THE THICKNESS OF THE COLD-MIX ASPHALT MIXTURE IN ORDER TO USE ALL OF THE QUANTITIES INCLUDED IN THE CONTRACT.

G.N.-440 (SPEC.)
ALL EXISTING TYPE B MODIFIED GUTTER SHALL BE CLEANED OF ALL DEBRIS (MILLINGS, AGGREGATE MATERIAL, ETC.) BOTH PRIOR TO AND AFTER THE PAVING OPERATIONS TO ENSURE PROPER DRAINAGE. THE COSTS SHALL BE INCLUDED IN THE VARIOUS HOT-MIX ASPHALT SURFACE REMOVAL PAY ITEMS AND NO ADDITIONAL COMPENSATION WILL BE ALLOWED.

G.N.-667 THE RESIDENT ENGINEER SHALL CONTACT THE PROGRAM DEVELOPMENT CHIEF OF SURVEYS PRIOR TO THE PRE-CONSTRUCTION CONFERENCE FOR INSTRUCTION AS TO SETTING OF TEMPORARY OR PERMANENT TIES FOR CENTERLINE ALIGNMENT CONTROL SURVEY MARKERS (PC'S, PT'S, AND PI'S). PROJECT IMPLEMENTATION PERSONNEL WILL BE RESPONSIBLE FOR LAYOUT OF THESE MARKERS.

G.N.-703A
SHORT TERM PAVEMENT MARKING SHALL BE APPLIED TO THE PAVEMENT AFTER ANY OF THE FOLLOWING: COLD MILLING AND/OR PLACING BITUMINOUS MATERIALS (PRIME COAT), LEVELING BINDER (MACHINE METHOD), BINDER AND SURFACE COURSES. SHORT TERM PAVEMENT MARKING PLACED ON THE SURFACE, SHALL COINCIDE WITH THE FINAL PAVEMENT STRIPING. SHORT TERM PAVEMENT MARKING PLACED PRIOR TO THE SURFACE SHALL COINCIDE WITH THE EXISTING PAVEMENT MARKINGS. USE 4 FEET PER 40 FEET (OR 10% PER STATION).

G.N.-1004.01
COARSE AGGREGATE GRADATION CA-10 MAY BE USED WHENEVER COARSE AGGREGATE CA-6 IS SPECIFIED IN THE STANDARD SPECIFICATIONS.

THERE ARE NO COMMITMENTS ASSOCIATED WITH THIS PROJECT.

FILE NAME =	USER NAME = dawsomb	DESIGNED -	REVISED -	STATE OF ILLINOIS DEPARTMENT OF TRANSPORTATION	GENERAL NOTES	F.A.S. RTE.	SECTION	COUNTY	TOTAL SHEETS	SHEET NO.
ct:\pwork\pwork\dawsomb\0208066\020930-sht-gennote.dgn		DRAWN -	REVISED -			522	(4)RS	Champaign	23	3
	PLOT SCALE = 48.0000' / 1" =	CHECKED -	REVISED -							
	PLOT DATE = 1/31/2012	DATE -	REVISED -		SCALE: _____ SHEET _____ OF _____ SHEETS STA. _____ TO STA. _____					
ILLINOIS FED. AID PROJECT										

GUTTER LOCATIONS

DETAIL "A"

LT. STA. 269+04 TO STA. 272+42
 LT. STA. 278+85 TO STA. 284+93
 LT. STA. 298+10 TO STA. 301+92
 RT. STA. 278+87 TO STA. 284+92
 RT. STA. 298+10 TO STA. 302+30
 RT. STA. 311+07 TO STA. 317+94

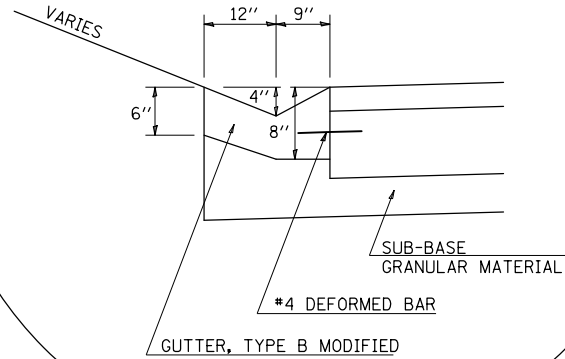

EXISTING TYPICAL CROSS SECTION

STA. 217+49 TO STA. 225+49
 STA. 230+49 TO STA. 236+99
 STA. 240+49 TO STA. 244+49
 STA. 265+49 TO STA. 322+99

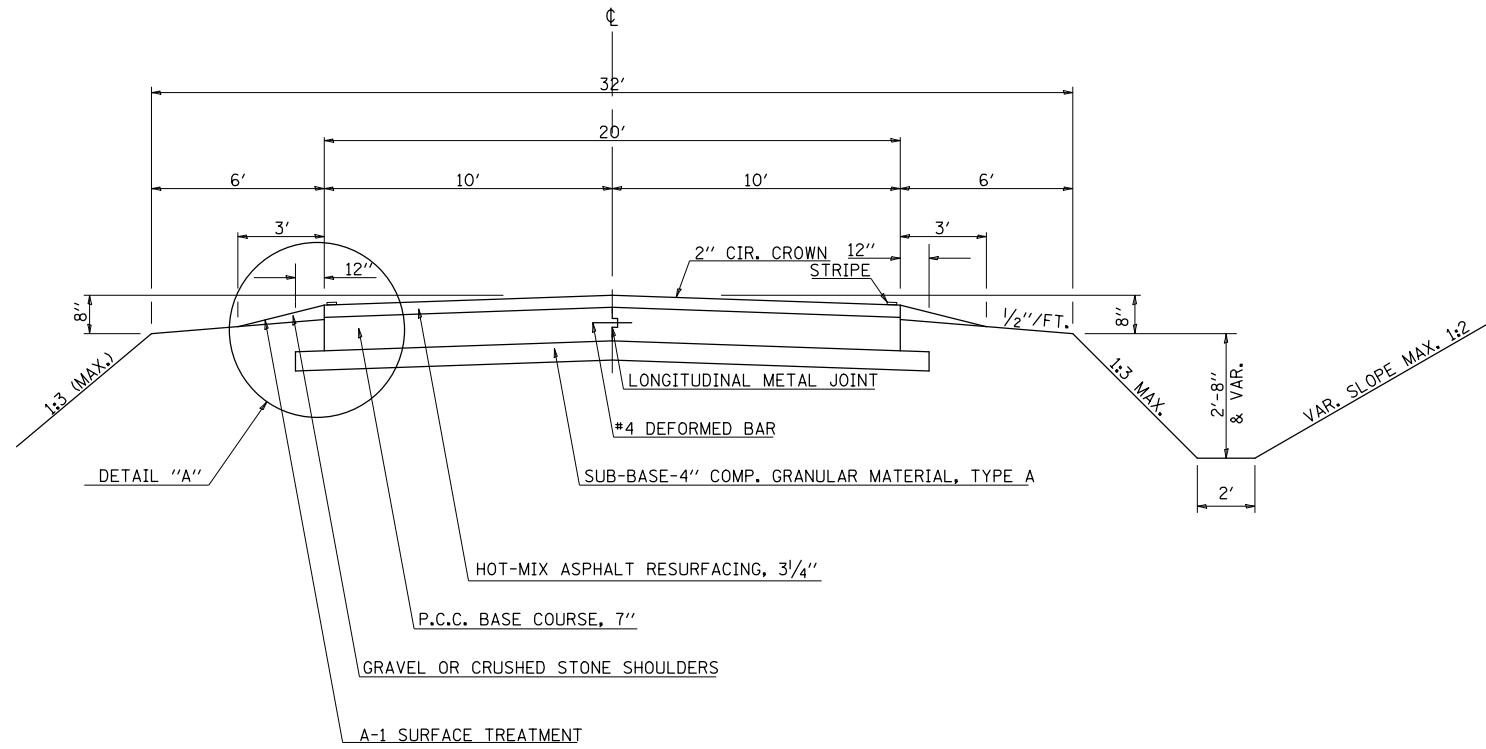

EXISTING TYPICAL CROSS SECTION

STA. 225+49 TO STA. 230+49
 STA. 236+99 TO STA. 240+49
 STA. 244+49 TO STA. 265+49
 STA. 322+99 TO STA. 331+41
 STA. 335+13 TO STA. 372+12.5

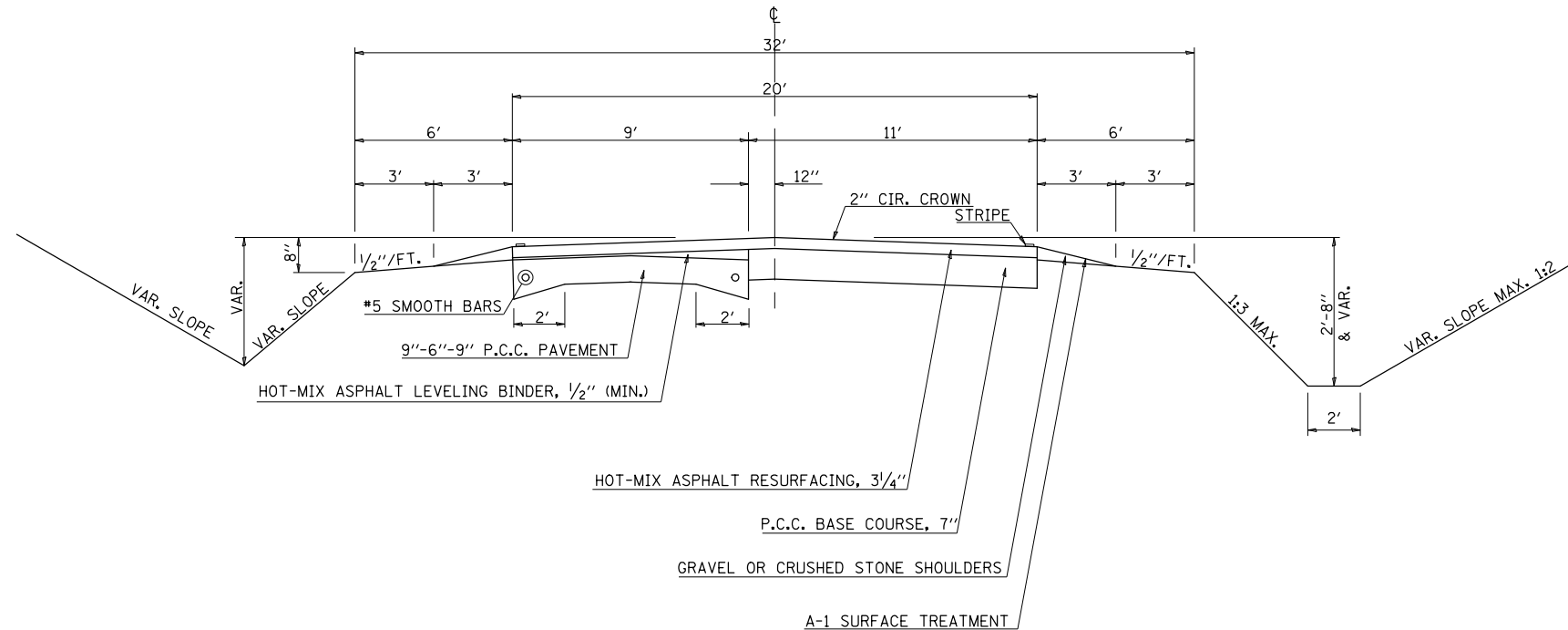

FILE NAME =	USER NAME = dawsonkb	DESIGNED -	REVISED -
ct:\pw\work\p1dot\dawsonkb\0288686\0570930-sh1-typical.dgn		DRAWN -	REVISED -
PLOT SCALE = 40.0000' / in.		CHECKED -	REVISED -
PLOT DATE = 1/31/2012		DATE -	REVISED -

**STATE OF ILLINOIS
 DEPARTMENT OF TRANSPORTATION**

EXISTING TYPICAL SECTION

SCALE: _____ SHEET _____ OF _____ SHEETS STA. _____ TO STA. _____

F.A.S. RTE.	SECTION	COUNTY	TOTAL SHEETS	SHEET NO.
522	(4)RS	Champaign	23	5
CONTRACT NO. 70930				
ILLINOIS FED. AID PROJECT				

EXISTING TYPICAL CROSS SECTION

STA. 331+41 TO STA. 332+91
 STA. 333+63 TO STA. 335+13

BRIDGE AND BRIDGE APPROACHES OMISSION:

S.N. 010-0244 STA. 332+91 TO STA. 333+63

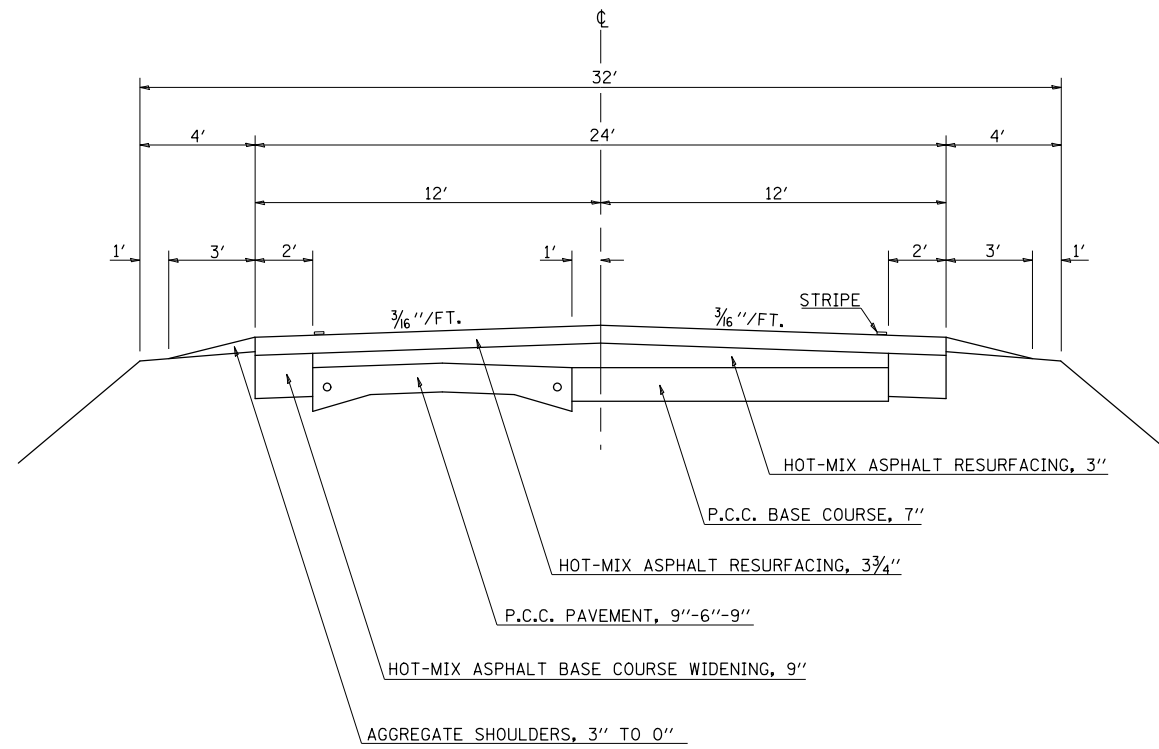

FILE NAME =	USER NAME = dawsonkb	DESIGNED -	REVISD -	STATE OF ILLINOIS DEPARTMENT OF TRANSPORTATION	EXISTING TYPICAL SECTION	F.A.S. RTE.	SECTION	COUNTY	TOTAL SHEETS	SHEET NO.
c:\pwwork\pwwork\dawsonkb\0288686\d570930-sh-typical.dgn		DRAWN -	REVISD -			522	(4)RS	Champaign	23	6
PLOT SCALE = 40.0000' / in.		CHECKED -	REVISD -			CONTRACT NO. 70930				
PLOT DATE = 1/31/2012		DATE -	REVISD -			ILLINOIS FED. AID PROJECT				

GUTTER LOCATIONS

DETAIL "A"

LT. STA. 269+04 TO STA. 272+42
 LT. STA. 278+85 TO STA. 284+93
 LT. STA. 298+10 TO STA. 301+92
 RT. STA. 278+87 TO STA. 284+92
 RT. STA. 298+10 TO STA. 302+30
 RT. STA. 311+07 TO STA. 317+94

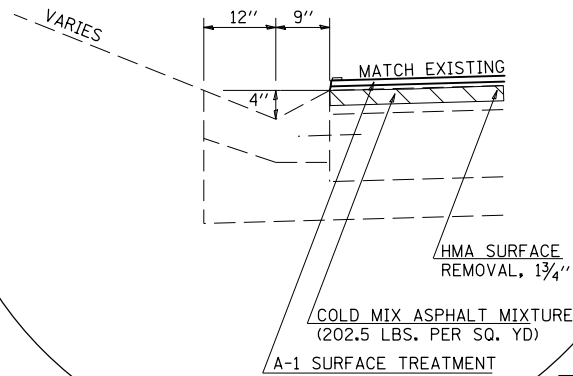

RATE OF APPLICATION FOR COLD MIX ASPHALT MIXTURE:
 90 LBS. PER SQ. YD. PER INCH

PROPOSED TYPICAL CROSS SECTION ①

STA. 217+49 TO STA. 225+49
 STA. 230+49 TO STA. 236+99
 STA. 240+49 TO STA. 244+49
 STA. 265+49 TO STA. 322+99

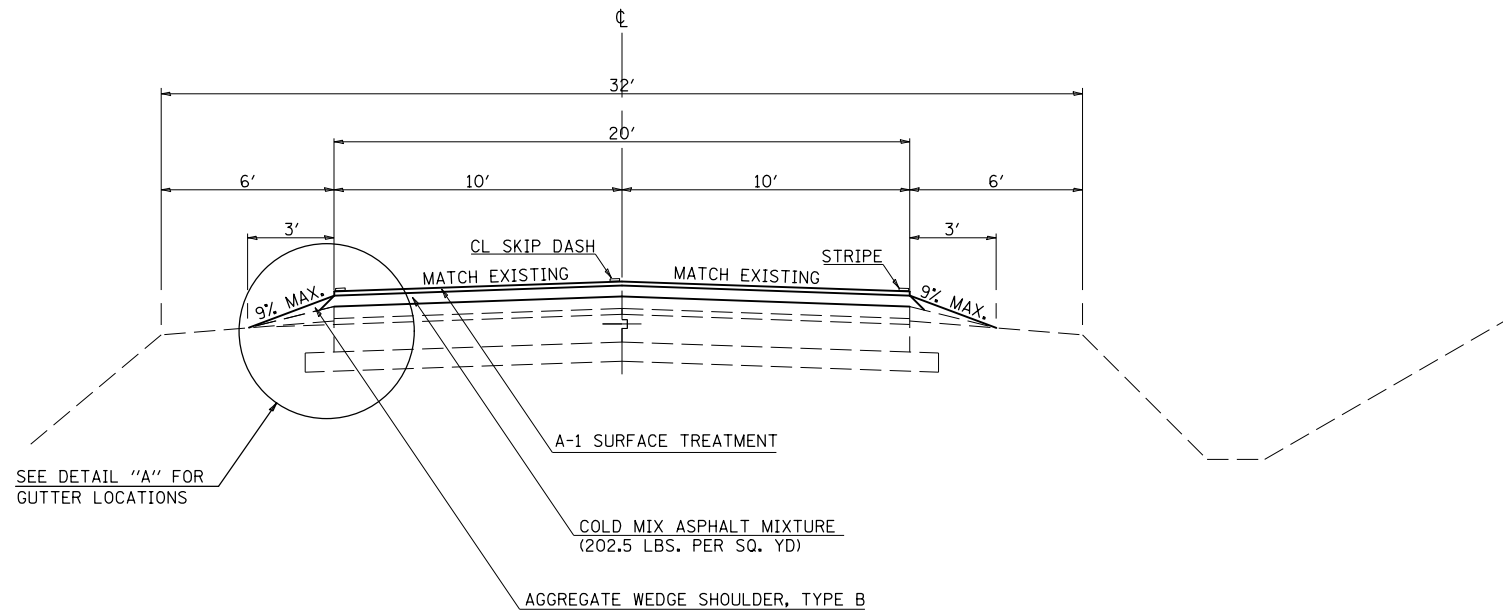

PROPOSED TYPICAL CROSS SECTION ②

STA. 225+49 TO STA. 230+49
 STA. 236+99 TO STA. 240+49
 STA. 244+49 TO STA. 265+49
 STA. 322+99 TO STA. 331+41
 STA. 335+13 TO STA. 372+12.5

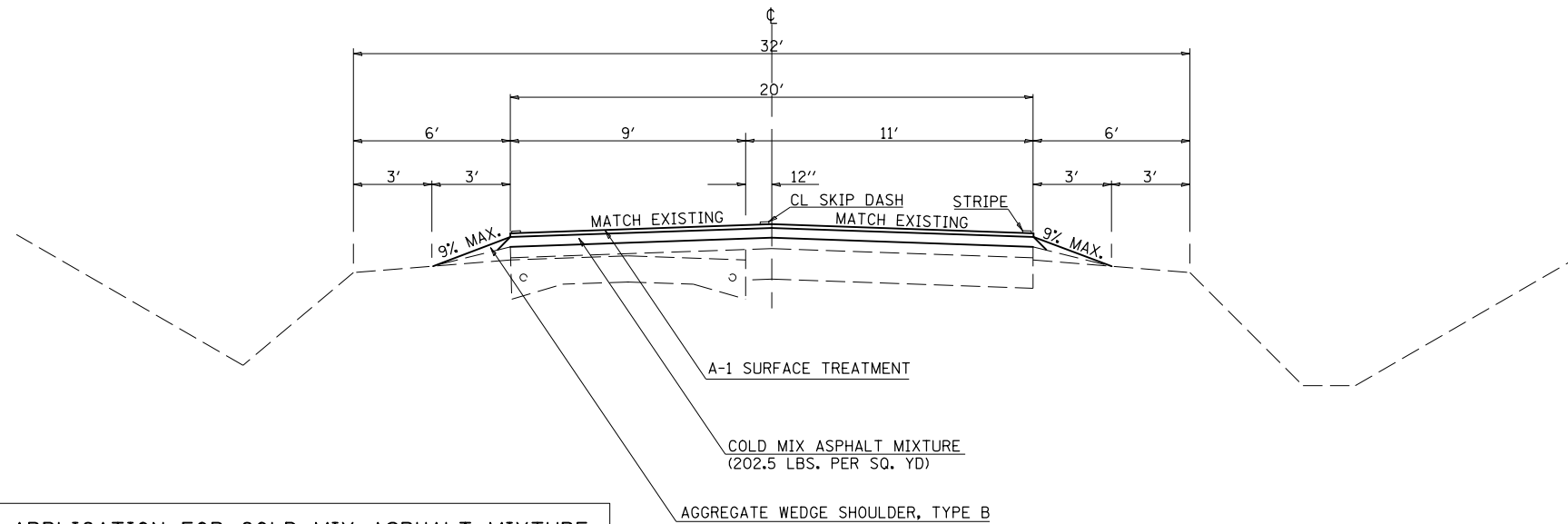

RATE OF APPLICATION FOR COLD MIX ASPHALT MIXTURE:
 90 LBS. PER SQ. YD. PER INCH

FILE NAME =	USER NAME = dawsonkb	DESIGNED -	REVISED -
c:\pwwork\pwwork\dawsonkb\02288686\0570930-sh1-typical.dgn		DRAWN -	REVISED -
PLOT SCALE = 40.0000' / in.		CHECKED -	REVISED -
PLOT DATE = 1/31/2012		DATE -	REVISED -

**STATE OF ILLINOIS
 DEPARTMENT OF TRANSPORTATION**

PROPOSED TYPICAL SECTION

SCALE: _____ SHEET _____ OF _____ SHEETS STA. _____ TO STA. _____

F.A.S. RTE.	SECTION	COUNTY	TOTAL SHEETS	SHEET NO.
522	(4)RS	Champaign	23	7
				CONTRACT NO. 70930
ILLINOIS FED. AID PROJECT				

PROPOSED TYPICAL CROSS SECTION ③

STA. 331+41 TO STA. 332+91
 STA. 333+63 TO STA. 335+13

BRIDGE AND APPROACH PAVEMENT OMISSION :
 S.N. 010-0244 STA. 332+91 TO STA. 333+63

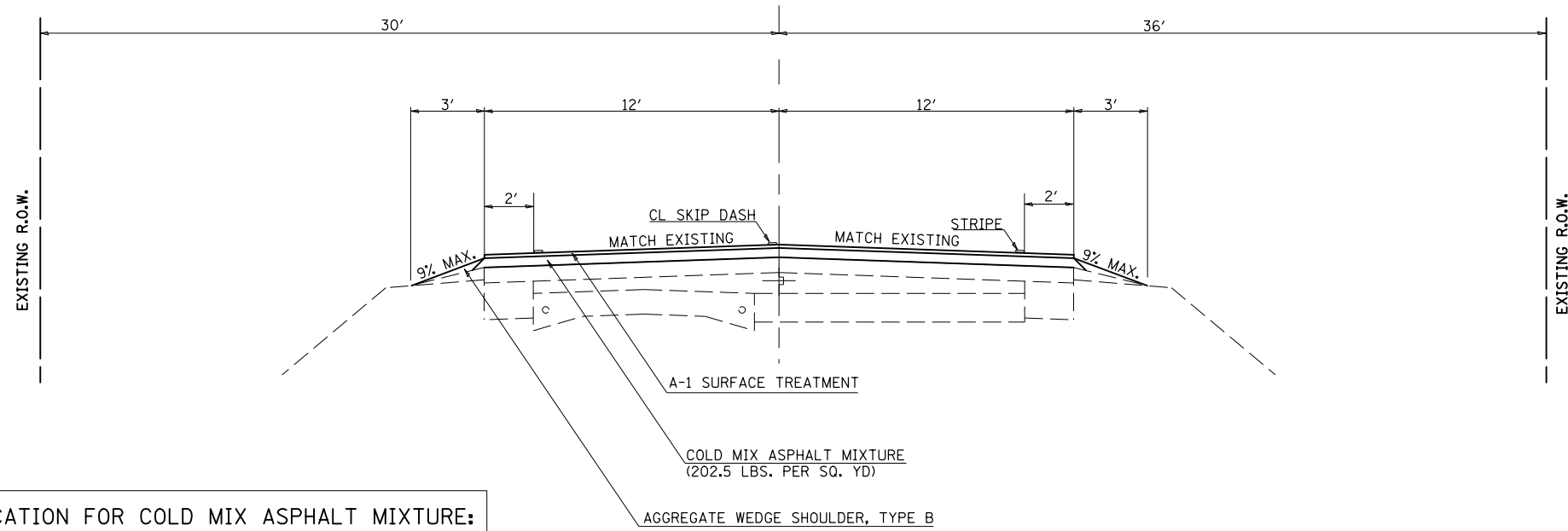

RATE OF APPLICATION FOR COLD MIX ASPHALT MIXTURE:
 90 LBS. PER SQ. YD. PER INCH

FILE NAME =	USER NAME = dawsonkb	DESIGNED -	REVISIONS -
et:\pwork\pwork\dawsonkb\02288686\d570930-sh-typical.dgn		DRAWN -	REVISIONS -
	PLOT SCALE = 40.0000' / in.	CHECKED -	REVISIONS -
	PLOT DATE = 1/31/2012	DATE -	REVISIONS -

**STATE OF ILLINOIS
 DEPARTMENT OF TRANSPORTATION**

PROPOSED TYPICAL SECTION

SCALE: _____ SHEET _____ OF _____ SHEETS STA. _____ TO STA. _____

F.A.S. RTE.	SECTION	COUNTY	TOTAL SHEETS	SHEET NO.
522	(4)RS	Champaign	23	8
			CONTRACT NO. 70930	
ILLINOIS FED. AID PROJECT				

SCHEDULE OF QUANTITIES

RESURFACING QUANTITIES												
LOCATION	STATION	TO	STATION	LENGTH (FOOT)	WIDTH (FOOT)	AREA (SQ YD)	COLD MIX AVG. THICKNESS (INCH)	40600100 BITUMINOUS MATERIALS PRIME COAT (GAL)	#5000400 COLD MIX ASPHALT MIXTURE (TON)	LR400300 BLOTTER AGGREGATE (TON)	40300305 POLY. BIT. MAT. (COVERS & SEAL COAT) (GAL)	40300600 SEAL COAT AGGREGATE (TON)
MAINLINE QUANTITIES												
	216+81.50	TO	269+04.00	5,222.5	20.0	11,605.6	2.25	1,160.6	1,175.1	87.0	6,383.1	145.1
	269+04.00	TO	272+42.00	338.0	20.0	751.1	2.25	75.1	76.1	5.6	413.1	9.4
	272+42.00	TO	278+85.00	643.0	20.0	1,428.9	2.25	142.9	144.7	10.7	785.9	17.9
	278+85.00	TO	284+93.00	608.0	20.0	1,351.1	2.25	135.1	136.8	10.1	743.1	16.9
	284+93.00	TO	298+10.00	1,317.0	20.0	2,926.7	2.25	292.7	296.3	22.0	1,609.7	36.6
	298+10.00	TO	302+30.00	420.0	20.0	933.3	2.25	93.3	94.5	7.0	513.3	11.7
	302+30.00	TO	311+07.00	877.0	20.0	1,948.9	2.25	194.9	197.3	14.6	1,071.9	24.4
	311+07.00	TO	317+94.00	687.0	20.0	1,526.7	2.25	152.7	154.6	11.5	839.7	19.1
	317+94.00	TO	331+41.00	1,347.0	20.0	2,993.3	2.25	299.3	303.1	22.5	1,646.3	37.4
	331+41.00	TO	332+91.00	150.0	24.0	400.0	2.25	40.0	40.5	3.0	220.0	5.0
	333+63.00	TO	335+13.00	150.0	24.0	400.0	2.25	40.0	40.5	3.0	220.0	5.0
	335+13.00	TO	372+80.00	3,767.0	20.0	8,371.1	2.25	837.1	847.6	62.8	4,604.1	104.6
SUB-TOTAL =								3,463.7	3,507.0	259.8	19,050.2	433.0
INCIDENTAL QUANTITIES												
PE	239+86.10	RT				46.1	1.875	4.6	3.9	0.3	25.4	0.6
FE	245+56.80	RT				33.3	1.875	3.3	2.8	0.2	18.3	0.4
FE	245+56.80	LT				25.6	1.875	2.6	2.2	0.2	14.1	0.3
PE/MBTO	257+39.70	RT				36.8	1.875	3.7	3.1	0.3	20.2	0.5
SIDEROAD	267+72.84	LT				45.6	1.875	4.6	3.8	0.3	25.1	0.6
SIDEROAD	267+75.68	RT				39.9	1.875	4.0	3.4	0.3	21.9	0.5
MBTO	271+20.00	RT				18.3	2.25	1.8	1.9	0.1	10.1	0.2
FE	279+73.80	LT				9.4	1.75	0.9	0.7	0.1	5.2	0.1
PE	280+79.70	RT				8.5	1.75	0.9	0.7	0.1	4.7	0.1
FE	294+02.00	RT				16.3	1.875	1.6	1.4	0.1	9.0	0.2
PE	300+45.90	LT				9.3	1.75	0.9	0.7	0.1	5.1	0.1
PE	300+74.60	RT				12.3	1.75	1.2	1.0	0.1	6.8	0.2
PE	301+11.00	RT				11.7	1.75	1.2	0.9	0.1	6.4	0.1
FE	307+40.70	RT				15.6	1.875	1.6	1.3	0.1	8.6	0.2
PE/MBTO	314+24.80	RT				18.2	1.75	1.8	1.4	0.1	10.0	0.2
SIDEROAD	320+54.02	LT				49.2	1.875	4.9	4.2	0.4	27.1	0.6
SIDEROAD	320+57.19	RT				40.4	1.875	4.0	3.4	0.3	22.2	0.5
PE/MBTO	323+36.60	RT				35.2	1.875	3.5	3.0	0.3	19.4	0.4
PE	324+48.00	RT				7.0	1.875	0.7	0.6	0.1	3.9	0.1
PE	335+47.90	LT				31.1	1.875	3.1	2.6	0.2	17.1	0.4
PE	340+93.60	RT				33.6	1.875	3.4	2.8	0.3	18.5	0.4
FE	340+93.60	LT				8.2	1.875	0.8	0.7	0.1	4.5	0.1
FE	368+12.00	RT				11.2	1.875	1.1	0.9	0.1	6.2	0.1
SUB-TOTAL =								56.3	47.4	4.2	309.5	7.0
TOTAL =								3,519.9	3,554.4	264.0	19,359.7	440.0
USE =								3,520.0	3,555.0	264.0	19,360.0	440.0

SCHEDULE OF QUANTITIES

40600982 HOT-MIX ASPHALT SURFACE REMOVAL - BUTT JOINT					
LOCATION	STATION	TO	STATION	WIDTH (FOOT)	AREA (SQ YD)
MAINLINE QUANTITIES					
BEGINNING OF SECTION	216+81.50	TO	217+49.00	20.0	150.0
APPROACH TO SN 010-0244	332+23.50	TO	332+91.00	24.0	180.0
DEPARTURE TO SN 010-0244	333+63.00	TO	334+30.50	24.0	180.0
END OF SECTION	372+12.50	TO	372+80.00	20.0	150.0
MAINLINE TOTAL =					660.0

44000156 HOT-MIX ASPHALT SURFACE REMOVAL 13/4"					
LOCATION	STATION	TO	STATION	WIDTH (FOOT)	AREA (SQ YD)
MAINLINE QUANTITIES					
	268+51.50	TO	272+94.50	20.0	984.4
	278+32.50	TO	285+45.50	20.0	1,584.4
	297+57.50	TO	302+82.50	20.0	1,166.7
	310+54.50	TO	318+46.50	20.0	1,760.0
MAINLINE TOTAL =					5,495.6
USE =					5,496.0

X4400196 HOT-MIX ASPHALT SURFACE REMOVAL, SPECIAL					
LOCATION	STATION	TO	STATION	WIDTH (FOOT)	AREA (SQ YD)
INCIDENTAL QUANTITIES					
PRIVATE ENTRANCE	239+86.10	RT		VAR	46.1
FIELD ENTRANCE	245+56.80	RT		VAR	33.3
FIELD ENTRANCE	245+56.80	LT		VAR	25.6
PRIVATE ENTRANCE/MBTO	257+39.70	RT		VAR	36.8
SIDEROAD	267+72.84	LT		VAR	45.6
SIDEROAD	267+75.68	RT		VAR	39.9
MAILBOX TURNOUT	271+20.00	RT		VAR	18.3
FIELD ENTRANCE	279+73.80	LT		VAR	9.4
PRIVATE ENTRANCE	280+79.70	RT		VAR	8.5
PRIVATE ENTRANCE	300+45.90	LT		VAR	9.3
PRIVATE ENTRANCE	300+74.60	RT		VAR	12.3
PRIVATE ENTRANCE	301+11.00	RT		VAR	11.7
PRIVATE ENTRANCE/MBTO	314+24.80	RT		VAR	27.0
SIDEROAD	320+54.02	LT		VAR	49.2
SIDEROAD	320+57.19	RT		VAR	40.4
PRIVATE ENTRANCE/MBTO	323+36.60	RT		VAR	35.2
PRIVATE ENTRANCE	335+47.90	LT		VAR	31.1
PRIVATE ENTRANCE	340+93.60	RT		VAR	33.6
INCIDENTAL TOTAL =					513.3
USE =					514.0

48102100 AGGREGATE WEDGE SHOULDER, TYPE B										
LOCATION	STATION	TO	STATION	LENGTH (FOOT)	WIDTH (FOOT)	AREA (SQ YD)	AVERAGE THICKNESS (INCHES)	48102100 AGG WEDGE SHLDR, TYPE B (TON)		
MAINLINE QUANTITIES										
	RT	216+81.50	TO	RT	269+04.00	5,222.5	3.0	1,740.8	2.125	185.0
	LT	216+81.50	TO	LT	269+04.00	5,222.5	3.0	1,740.8	2.125	185.0
	RT	272+42.00	TO	RT	278+85.00	643.0	3.0	214.3	2.125	22.8
	LT	272+42.00	TO	LT	278+85.00	643.0	3.0	214.3	2.125	22.8
	RT	284+93.00	TO	RT	298+10.00	1,317.0	3.0	439.0	2.125	46.6
	LT	284+93.00	TO	LT	298+10.00	1,317.0	3.0	439.0	2.125	46.6
	RT	302+30.00	TO	RT	311+07.00	877.0	3.0	292.3	2.125	31.1
	LT	302+30.00	TO	LT	311+07.00	877.0	3.0	292.3	2.125	31.1
	RT	317+94.00	TO	RT	332+91.00	1,497.0	3.0	499.0	2.125	53.0
	LT	317+94.00	TO	LT	332+91.00	1,497.0	3.0	499.0	2.125	53.0
	RT	333+63.00	TO	RT	372+80.00	3,917.0	3.0	1,305.7	2.125	138.7
	LT	333+63.00	TO	LT	372+80.00	3,917.0	3.0	1,305.7	2.125	138.7
MAINLINE TOTAL =									954.4	

INCIDENTAL QUANTITIES									
PE/MBTO	RT	257+39.70				VARIES	7.0	2.063	0.7
PE/MBTO	RT	323+36.60				VARIES	11.3	2.063	1.2
INCIDENTAL TOTAL =									1.9
TOTAL =									956.3
USE =									957.0

PAINT PAVEMENT MARKING - LINE 4" (78001110)					
WHITE -SOLID EDGE LINES					
STATION	TO	STATION	LOCATION	FEET	
216+81.50		267+50.00	10.0' LT	5,068.5	
216+81.50		267+50.00	10.0' RT	5,068.5	
268+00.00		320+30.00	10.0' LT	5,230.0	
268+00.00		320+30.00	10.0' RT	5,230.0	
320+80.00		372+80.00	10.0' LT	5,200.0	
320+80.00		372+80.00	10.0' RT	5,200.0	
SUB-TOTAL =				30,997.0	

YELLOW -SKIP DASH					
STATION	TO	STATION	LOCATION	FEET	
216+81.50		306+88.00	CL	2,251.6	
307+94.00		372+80.00	CL	1,621.5	
SUB-TOTAL =				3,873.1	

YELLOW -SOLID (NO PASSING ZONES)					
STATION	TO	STATION	DIRECTION	FEET	
230+16.00	*	238+08.00	SB	792.0	
243+89.00	*	250+23.00	NB	634.0	
264+64.00	*	274+14.00	SB	950.0	
274+67.00	*	285+76.00	NB	1,109.0	
292+10.00	*	297+38.00	SB	528.0	
302+13.00	*	307+94.00	NB	581.0	
306+88.00	*	314+28.00	SB	740.0	
317+45.00	*	325+90.00	NB	845.0	
SUB-TOTAL =				6,179.0	
TOTAL =				41,049.1	
USE =				41,049.0	

* STATIONS ARE APPROXIMATE

WORK ZONE PAVEMENT MARKING REMOVAL (70301000)						
SHORT TERM						
O/S	STATION	TO	STATION	LENGTH (FT)	WIDTH (FT)	SQ FT
CL-SKIP DASH	216+81.50		332+91.00	1164.0	0.33	384.1
CL-SKIP DASH	333+63.00		372+80.00	392.0	0.33	129.4
TOTAL =						513.5
USE =						514.0

SHORT TERM PAVEMENT MARKING (70300100)					
O/S	STATION	TO	STATION	# OF APPS.	LENGTH (FT)
CL-SKIP DASH	216+81.50		332+91.00	2	2,328.0
CL-SKIP DASH	333+63.00		372+80.00	2	784.0
TOTAL =					3,112.0

SURVEY MONUMENT COVER ASSEMBLY (Z0070100)			
STATION		EACH	
254+56.15	CL	1.0	
267+75.39	CL	1.0	
294+17.63	CL	1.0	
TOTAL =		3.0	

FILE NAME =	USER NAME = dawsonkb	DESIGNED -	REVISED -
ci:\pw\work\p1dot\dawsonkb\0288686\0570930-sh-t-schedule.dgn		DRAWN -	REVISED -
PLOT SCALE = 48.0000' / in.		CHECKED -	REVISED -
PLOT DATE = 1/31/2012		DATE -	REVISED -

**STATE OF ILLINOIS
DEPARTMENT OF TRANSPORTATION**

SCHEDULE OF QUANTITIES

SCALE: _____ SHEET _____ OF _____ SHEETS STA. _____ TO STA. _____

F.A.S. RTE.	SECTION	COUNTY	TOTAL SHEETS	SHEET NO.
522	(41)RS	Champaign	23	10
CONTRACT NO. 70930				
ILLINOIS FED. AID PROJECT				

SEC. 3 - T 17 N - R 10 E - 3RD PM

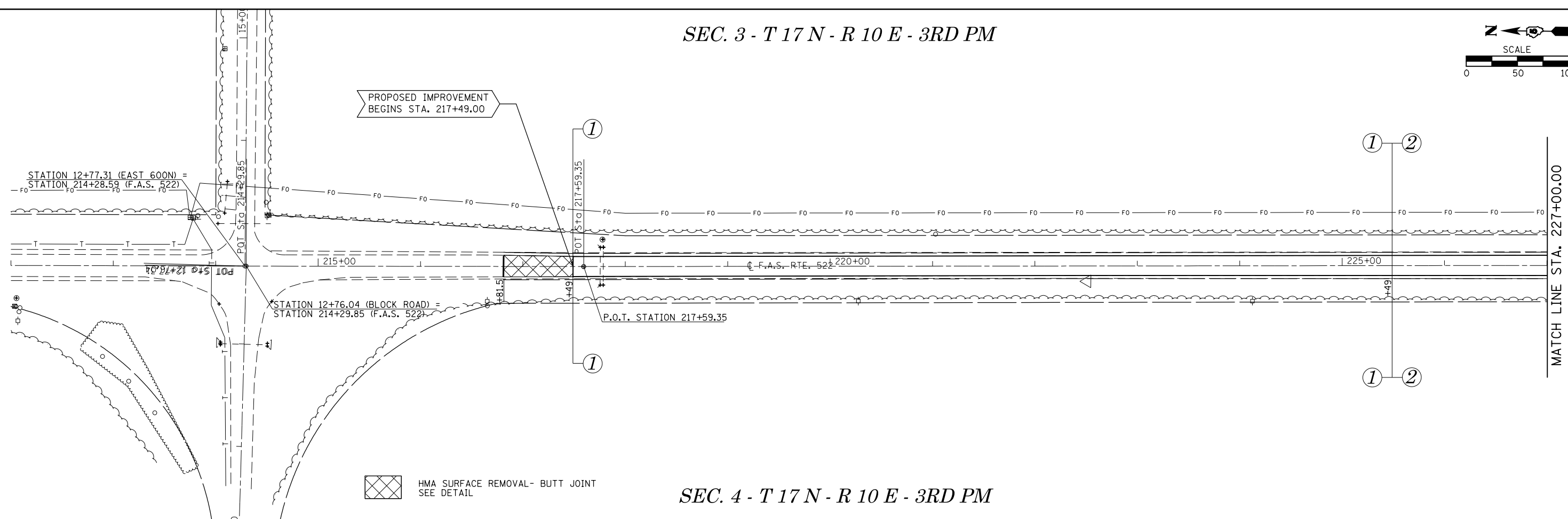
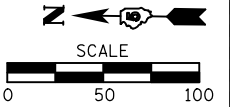

SEC. 4 - T 17 N - R 10 E - 3RD PM

SEC. 3 - T 17 N - R 10 E - 3RD PM

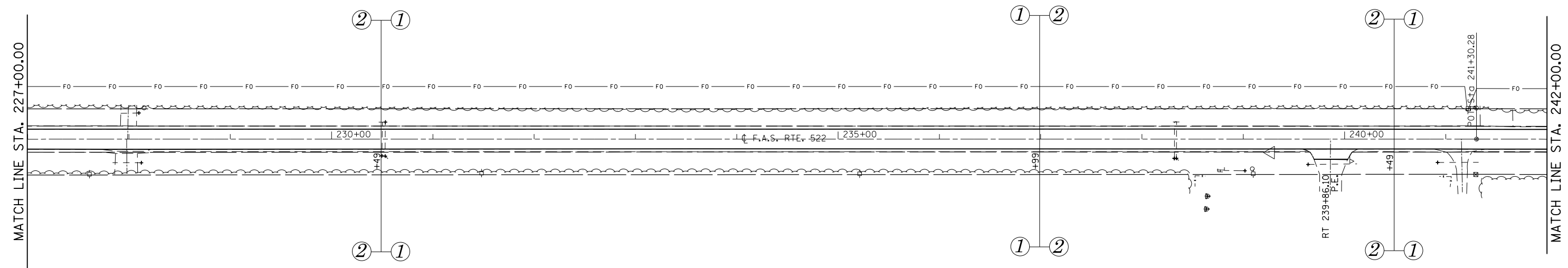
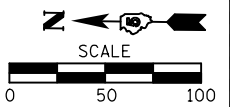

SEC. 4 - T 17 N - R 10 E - 3RD PM

FILE NAME =	USER NAME = dawsonkb	DESIGNED -	REVISED -	STATE OF ILLINOIS DEPARTMENT OF TRANSPORTATION	PLAN SHEET			F.A.S. RTE.	SECTION	COUNTY	TOTAL SHEETS	SHEET NO.
ei:\pw\work\p\dot\dawsonkb\0288686\0570930-sh1-dbl\p1n_50.dgn	PLOT SCALE = 100.0000' / in.	DRAWN -	REVISED -					522	(4)RS	Champaign	23	11
	PLOT DATE = 1/31/2012	CHECKED -	REVISED -		SCALE: SHEET OF SHEETS STA. 212+00.00 TO STA. 242+00.00			CONTRACT NO. 70930				
		DATE -	REVISED -		ILLINOIS FED. AID PROJECT							

SEC. 3 - T 17 N - R 10 E - 3RD PM

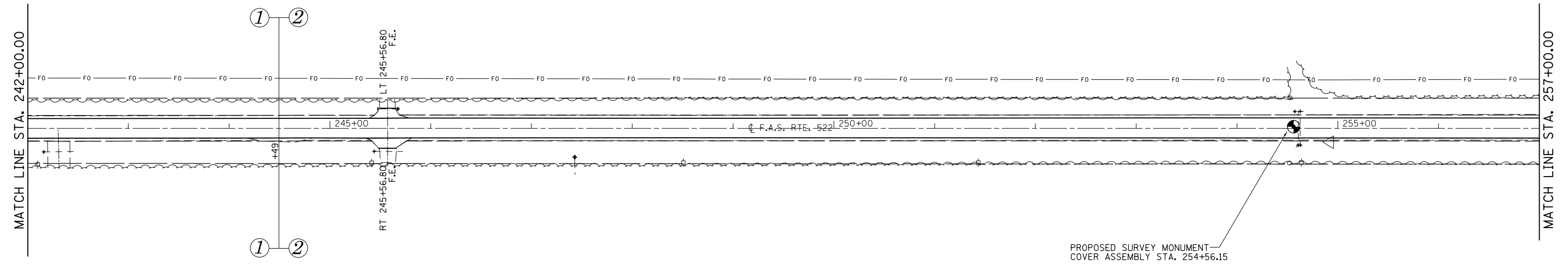
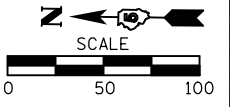

SEC. 4 - T 17 N - R 10 E - 3RD PM

SEC. 3 - T 17 N - R 10 E - 3RD PM

SEC. 10 - T 17 N - R 10 E - 3RD PM

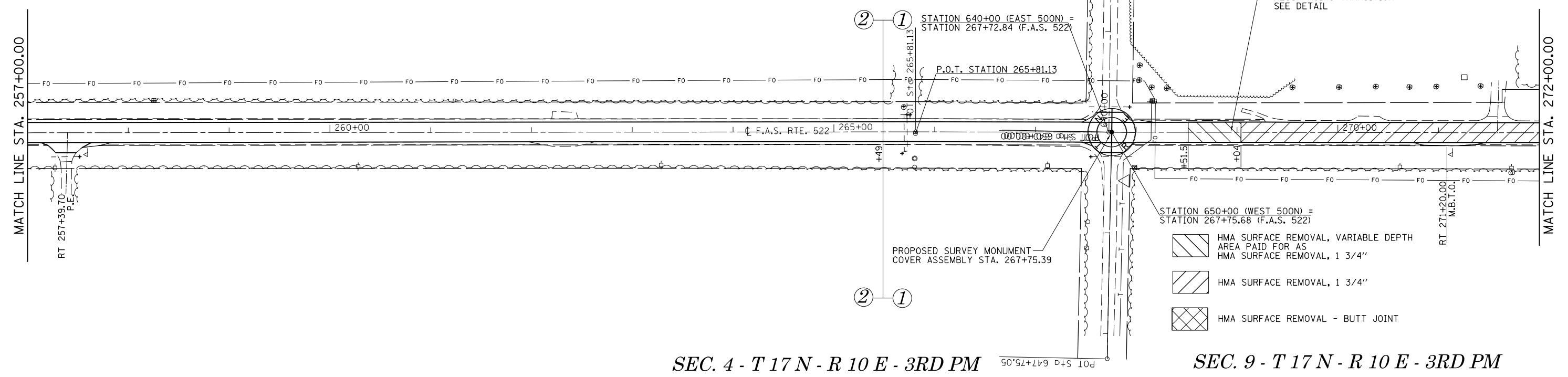
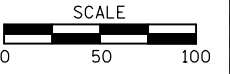

SEC. 4 - T 17 N - R 10 E - 3RD PM

SEC. 9 - T 17 N - R 10 E - 3RD PM

FILE NAME =	USER NAME = dawsonkb	DESIGNED -	REVISED -
ei:\pwork\pwork\dot\dawsonkb\0288686\0570930-sh1-dblpIn_50.dgn		DRAWN -	REVISED -
	PLOT SCALE = 100.0000' / in.	CHECKED -	REVISED -
	PLOT DATE = 1/31/2012	DATE -	REVISED -

STATE OF ILLINOIS
DEPARTMENT OF TRANSPORTATION

PLAN SHEET	
SCALE:	SHEET OF SHEETS STA. 242+00.00 TO STA. 272+00.00

F.A.S. RTE. 522	SECTION (4)RS	COUNTY Champaign	TOTAL SHEETS 23	SHEET NO. 12
CONTRACT NO. 70930				
ILLINOIS FED. AID PROJECT				

SEC. 10 - T 17 N - R 10 E - 3RD PM

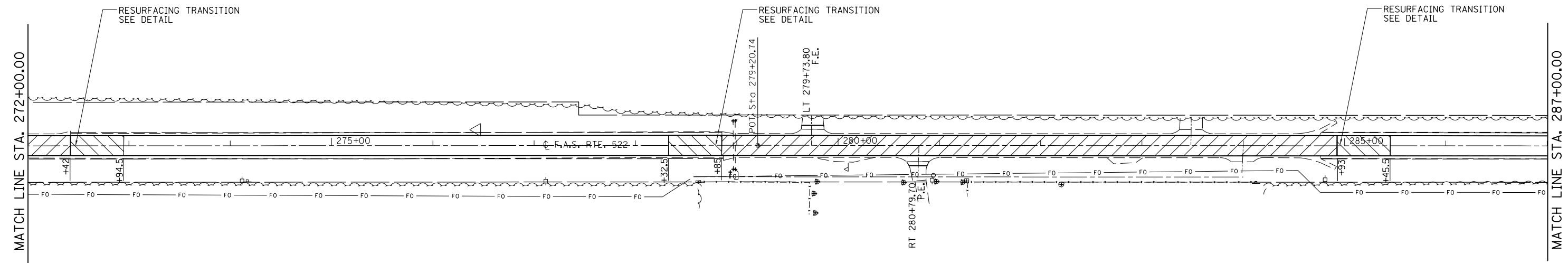
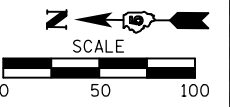

- HMA SURFACE REMOVAL, VARIABLE DEPTH
AREA PAID FOR AS
HMA SURFACE REMOVAL, 1 3/4"
- HMA SURFACE REMOVAL, 1 3/4"
- HMA SURFACE REMOVAL - BUTT JOINT

SEC. 9 - T 17 N - R 10 E - 3RD PM

SEC. 10 - T 17 N - R 10 E - 3RD PM

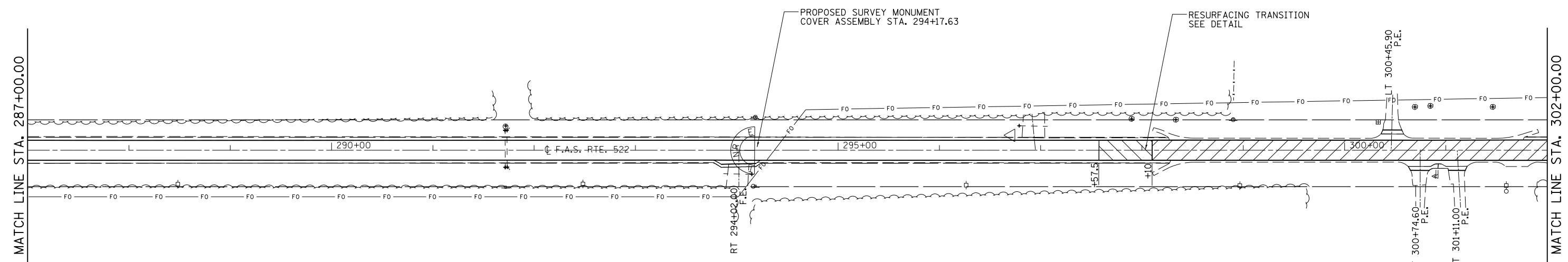
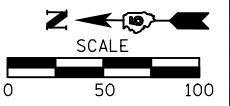

- HMA SURFACE REMOVAL, VARIABLE DEPTH
AREA PAID FOR AS
HMA SURFACE REMOVAL, 1 3/4"
- HMA SURFACE REMOVAL, 1 3/4"
- HMA SURFACE REMOVAL - BUTT JOINT

SEC. 9 - T 17 N - R 10 E - 3RD PM

FILE NAME =	USER NAME = dawsonkb	DESIGNED -	REVISED -	STATE OF ILLINOIS DEPARTMENT OF TRANSPORTATION	PLAN SHEET			F.A.S. RTE.	SECTION	COUNTY	TOTAL SHEETS	SHEET NO.	
	ei:\pwork\pwork\dot\dawsonkb\02288686\0570930-sh1-dblp1n_50.dgn	DRAWN -	REVISED -		SCALE:	SHEET	OF	SHEETS	522	(4)RS	Champaign	23	13
	PLOT SCALE = 100.0000' / in.	CHECKED -	REVISED -		STA. 272+00.00	TO STA. 302+00.00		ILLINOIS FED. AID PROJECT					
	PLOT DATE = 1/31/2012	DATE -	REVISED -		CONTRACT NO. 70930								

SEC. 10 - T 17 N - R 10 E - 3RD PM

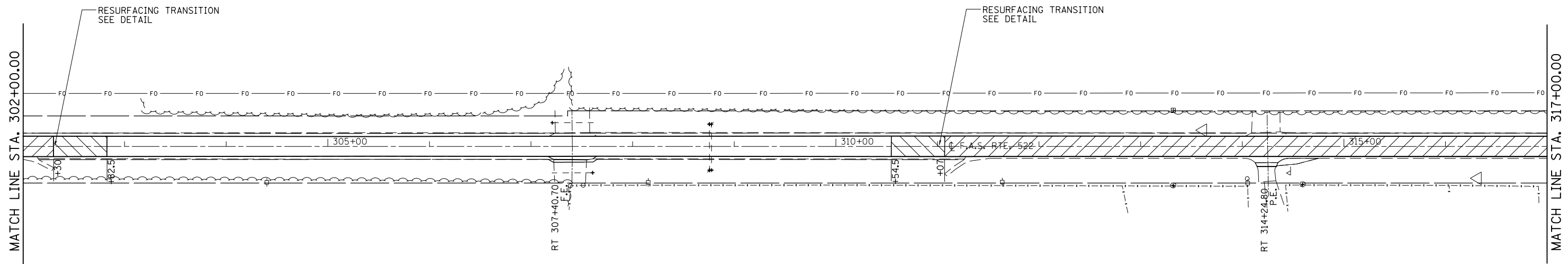
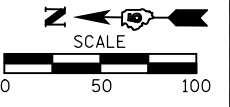

- HMA SURFACE REMOVAL, VARIABLE DEPTH
AREA PAID FOR AS
HMA SURFACE REMOVAL, 1 3/4"
- HMA SURFACE REMOVAL, 1 3/4"
- HMA SURFACE REMOVAL - BUTT JOINT

SEC. 9 - T 17 N - R 10 E - 3RD PM

SEC. 10 - T 17 N - R 10 E - 3RD PM

SEC. 15 - T 17 N - R 10 E - 3RD PM

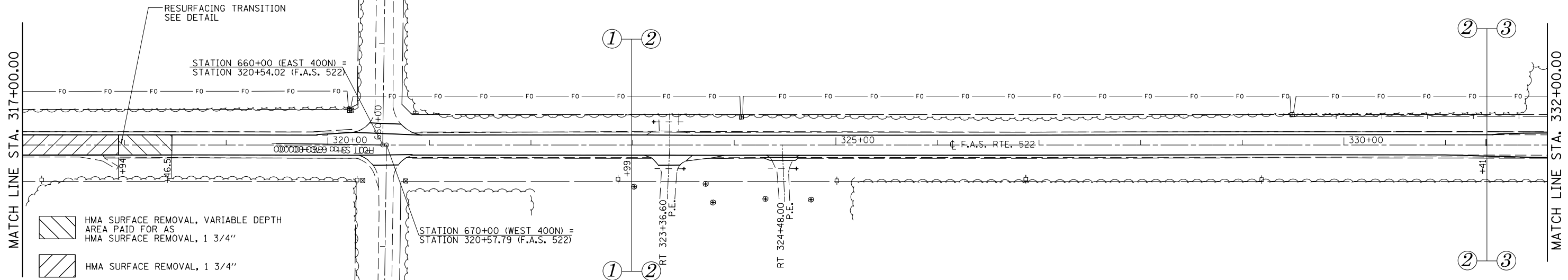
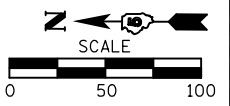

- HMA SURFACE REMOVAL, VARIABLE DEPTH
AREA PAID FOR AS
HMA SURFACE REMOVAL, 1 3/4"
- HMA SURFACE REMOVAL, 1 3/4"
- HMA SURFACE REMOVAL - BUTT JOINT

SEC. 9 - T 17 N - R 10 E - 3RD PM

SEC. 16 - T 17 N - R 10 E - 3RD PM

FILE NAME =	USER NAME = dawsonkb	DESIGNED -	REVISED -	STATE OF ILLINOIS DEPARTMENT OF TRANSPORTATION	PLAN SHEET				F.A.S. RTE.	SECTION	COUNTY	TOTAL SHEETS	SHEET NO.
ei:\pw\work\p\idot\dawsonkb\02288686\0570930-sh1-dblp\in_50.dgn		DRAWN -	REVISED -		522	(4)RS	Champaign	23	14				
PLOT SCALE = 100.0000' / in.		CHECKED -	REVISED -		SCALE: SHEET OF SHEETS STA. 302+00.00 TO STA. 332+00.00				CONTRACT NO. 70930				
PLOT DATE = 1/31/2012		DATE -	REVISED -		ILLINOIS FED. AID PROJECT								

SEC. 15 - T 17 N - R 10 E - 3RD PM

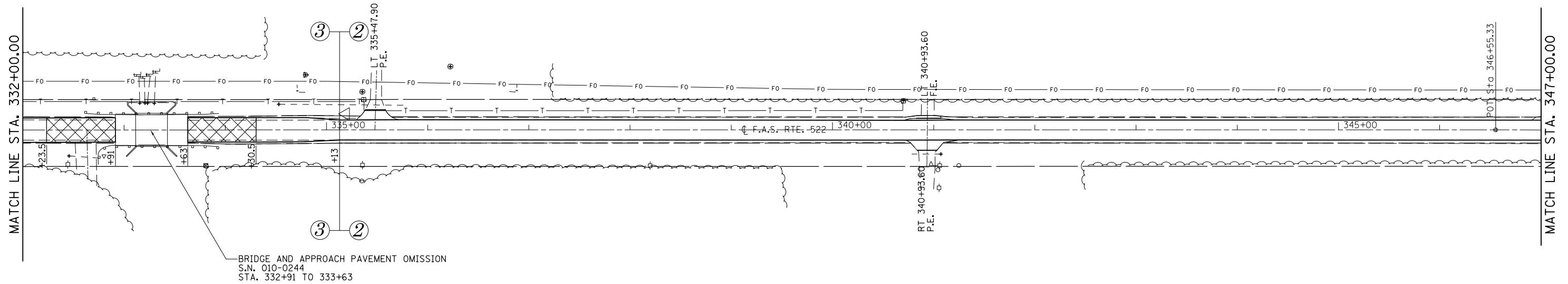
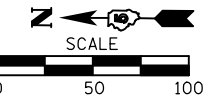

SEC. 16 - T 17 N - R 10 E - 3RD PM

SEC. 15 - T 17 N - R 10 E - 3RD PM

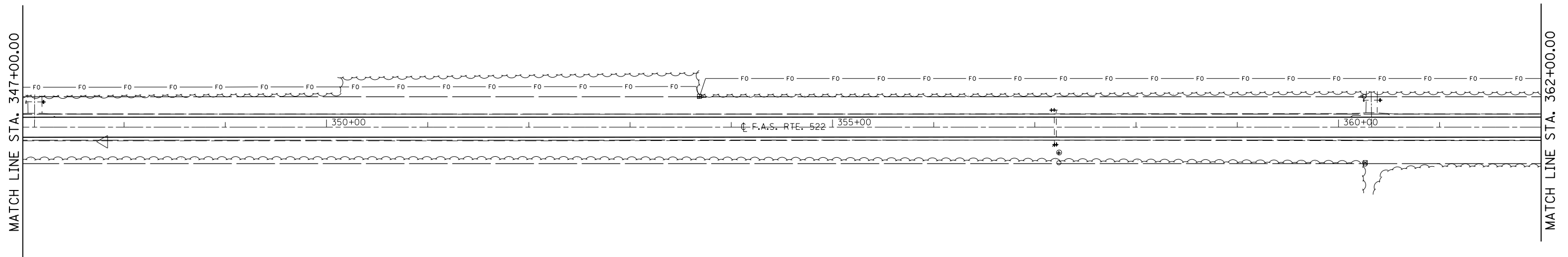
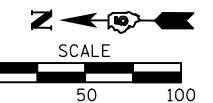

SEC. 16 - T 17 N - R 10 E - 3RD PM

FILE NAME =	USER NAME = dawsonkb	DESIGNED -	REVISED -	STATE OF ILLINOIS DEPARTMENT OF TRANSPORTATION	PLAN SHEET			F.A.S. RTE.	SECTION	COUNTY	TOTAL SHEETS	SHEET NO.
ei:\pwork\pwork\dot\dawsonkb\02288686\0570930-sh1-dblp1n_50.dgn	PLOT SCALE = 100.0000' / in.	DRAWN -	REVISED -					522	(4)RS	Champaign	23	15
PLOT DATE = 1/31/2012	DATE -	CHECKED -	REVISED -		SCALE: SHEET OF SHEETS STA. 332+00.00 TO STA. 362+00.00			CONTRACT NO. 70930				
		DATE -	REVISED -		ILLINOIS FED. AID PROJECT							

SEC. 15 - T 17 N - R 10 E - 3RD PM

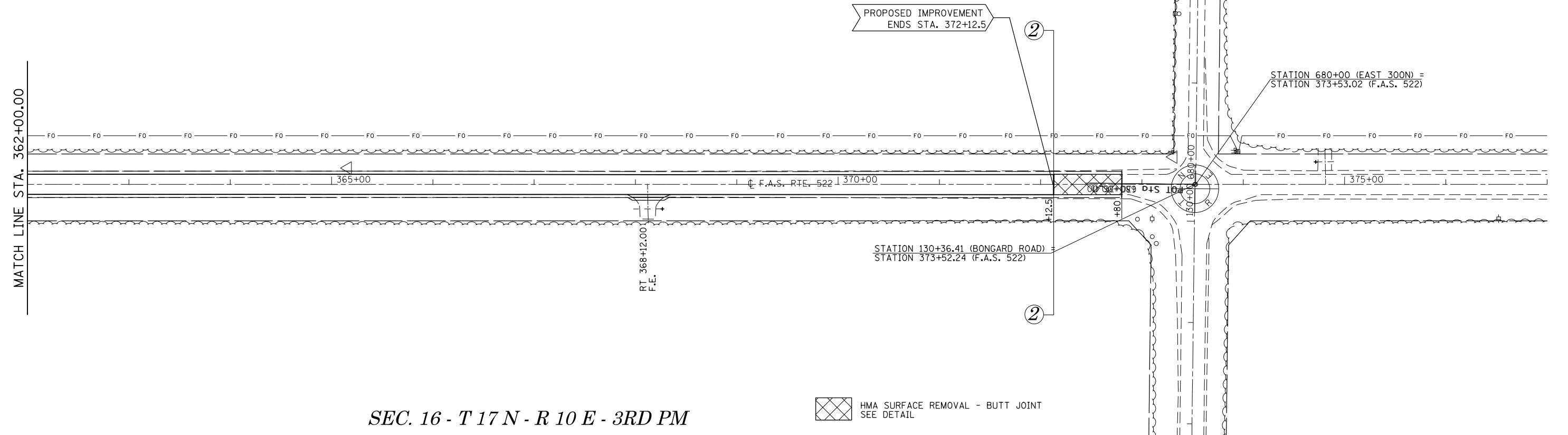
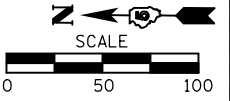

SEC. 16 - T 17 N - R 10 E - 3RD PM

FILE NAME = c:\pwwork\pwwork\dawsonkb\02288686\0570930-sh1-dblp1n_50.dgn	USER NAME = dawsonkb	DESIGNED -	REVISED -	STATE OF ILLINOIS DEPARTMENT OF TRANSPORTATION	PLAN SHEET				F.A.S. RTE.	SECTION	COUNTY	TOTAL SHEETS	SHEET NO.
	PLOT SCALE = 100.0000' / in.	DRAWN -	REVISED -		522	(4)RS	Champaign	23	16				
PLOT DATE = 1/31/2012	CHECKED -	REVISED -	SCALE: SHEET OF SHEETS STA. TO STA.					CONTRACT NO. 70930					
	DATE -	REVISED -	ILLINOIS FED. AID PROJECT										

BUTT JOINT DETAIL FOR BEGINNING AND END OF PROJECT

& NEAR S.N. 010-0244

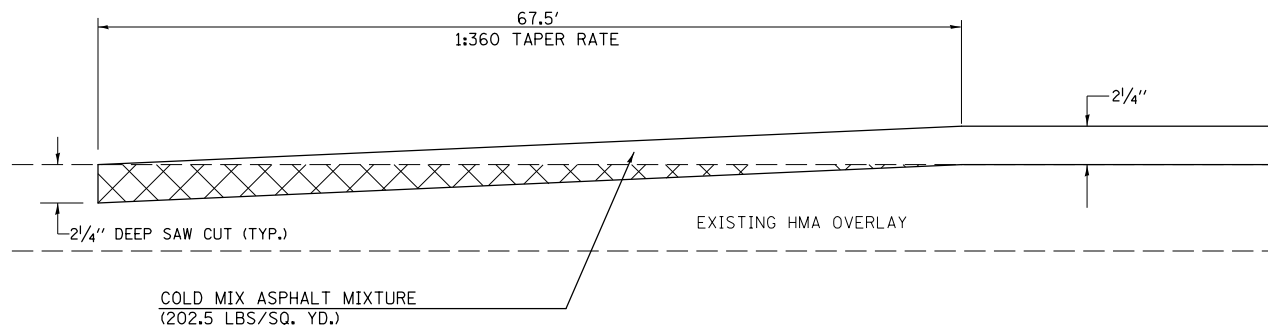

HMA SURFACE REMOVAL - BUTT JOINT

STATION	TO	STATION
216+81.50		217+49.00
332+23.50		332+91.00
333+63.00		334+30.50
372+12.50		372+80.00

HOT-MIX ASPHALT SURFACE REMOVAL - BUTT JOINT
NOTE:

SAW CUT IS INCLUDED IN THE COST OF HMA SURFACE REMOVAL - BUTT JOINT

RESURFACING TRANSITION DETAIL FOR FAS 522 (SIDNEY-LONGVIEW RD.)

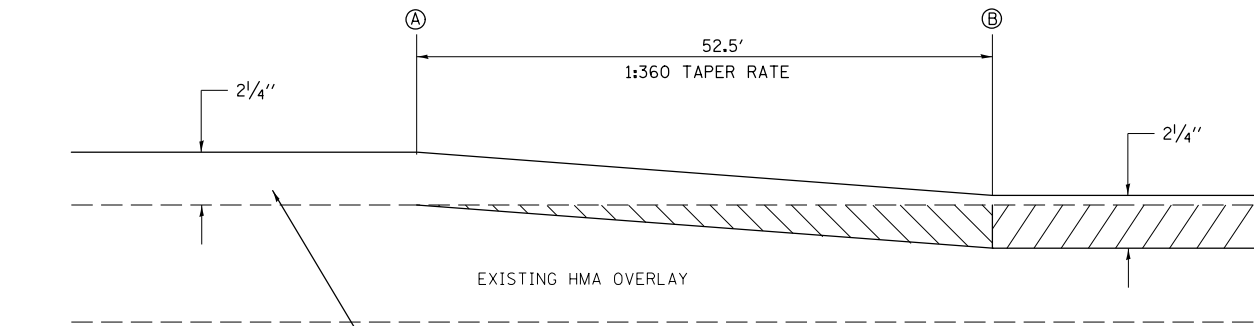

COLD MIX ASPHALT MIXTURE
(202.5 LBS/SQ. YD.)

STATION	TO	STATION
(A) 268+51.50		(B) 269+04.00
(B) 272+42.00		(A) 272+94.50
(A) 278+32.50		(B) 278+85.00
(B) 284+93.00		(A) 285+45.50
(A) 297+57.50		(B) 298+10.00
(B) 302+30.00		(A) 302+82.50
(A) 310+54.50		(B) 311+07.00
(B) 317+94.00		(A) 318+46.50

HMA SURFACE REMOVAL, VARIABLE DEPTH (0 TO 1 3/4")
AREA PAID FOR AS
 HMA SURFACE REMOVAL, 1 3/4"
 HMA SURFACE REMOVAL, 1 3/4"

BUTT JOINT DETAIL FOR PRIVATE ENTRANCE, FIELD ENTRANCE, OR SIDEROAD

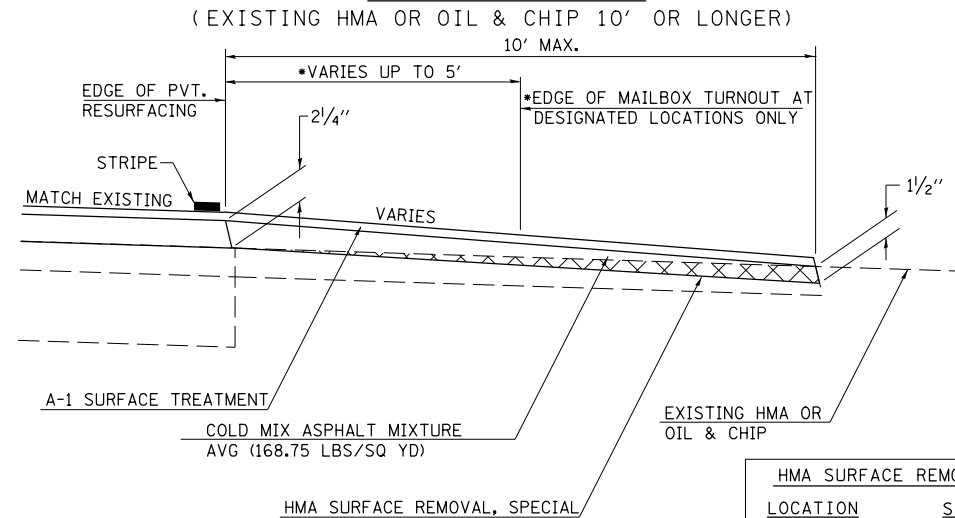

HMA SURFACE REMOVAL, SPECIAL	
LOCATION	STATION
P. E	239+86.10 RT
F. E	245+56.80 RT
F. E.	245+56.80 LT
*P. E.	257+39.70 RT
SIDEROAD	267+72.84 LT
SIDEROAD	267+75.68 RT
SIDEROAD	320+54.02 LT
SIDEROAD	320+57.19 RT
*P. E.	323+36.60 RT
P. E.	335+47.90 LT
P. E.	340+93.60 RT

NOTES: THE INTENT IS TO RESURFACE THE EXISTING CONFIGURATION OF THE ENTRANCES AND SIDEROADS TO A MAXIMUM OF 10' FROM THE EDGE OF PAVEMENT. EXISTING SIDEROADS SHOULD BE RESURFACED TO MAINTAIN THEIR CURRENT RADII.

*THESE DESIGNATED LOCATIONS HAVE AN EXISTING HMA COMBINATION P. E./MAILBOX TURNOUT. WHERE THE EXISTING MAILBOX TURNOUT IS HMA, MILL AND RESURFACE SIMILAR TO THE ADJACENT PE PORTION AS SHOWN ABOVE. WHERE THE EXISTING MAILBOX TURNOUT PORTION IS AGGREGATE, PLACE AGGREGATE TO MATCH THE THICKNESS AND SLOPE OF THE ADJACENT PE PORTION SHOWN ABOVE.

GENERAL NOTES

1. THE EXISTING SURFACE SHALL BE PREPARED IN ACCORDANCE WITH SECTION 408 OF THE STANDARD SPECIFICATIONS.
2. ANY NECESSARY WORK BEHIND THE HMA SHOULDER OR THE INCIDENTAL HMA SURFACING SHALL BE AS SHOWN IN THE PLANS AND/OR AS DIRECTED BY THE ENGINEER.
3. EXISTING FIELD ENTRANCES OF AGGREGATE OR EARTH WITH NO HMA APRON SHALL NOT RECEIVE A NEW HMA APRON WITHOUT PROPER APPROVAL THROUGH THE BUREAU OF OPERATIONS "POLICY ON PERMITS FOR ACCESS DRIVEWAYS TO STATE HIGHWAYS".
4. TO ASSURE APPROPRIATE ACCESS POLICIES ARE FOLLOWED ALL NEW ACCESS SHALL BE APPLIED FOR THROUGH THE BUREAU OF OPERATIONS PERMIT APPLICATION PROCESS. PLAN PREPARATION MEMORANDUMS 40-09 AND 40-11 ALONG WITH DISTRICT CONSTRUCTION MEMORANDUM 03/14 DISCUSS THIS PROCEDURE.
5. PROPOSED SIDEROAD GRADES SHALL BE AS DIRECTED BY THE ENGINEER.
6. AGGREGATE WEDGE SHOULDERS, TYPE B WILL BE WRAPPED AROUND THE SIDEROAD RETURNS. TAPER WIDTH FROM 3' ALONG MAINLINE TO 2' AT BACK OF RETURN.

FILE NAME =	USER NAME = dawsonkb	DESIGNED -	REVISED -
et:\pw\work\p\dot\dawsonkb\0288686\0570930-shr-details.dgn		DRAWN -	REVISED -
		CHECKED -	REVISED -
		DATE -	REVISED -

STATE OF ILLINOIS
DEPARTMENT OF TRANSPORTATION

BUTT JOINT & RESURFACING TRANSITION DETAILS

SCALE: _____ SHEET _____ OF _____ SHEETS STA. _____ TO STA. _____

F.A.S. RTE.	SECTION	COUNTY	TOTAL SHEETS	SHEET NO.
522	(4)RS	Champaign	23	17
			CONTRACT NO. 70930	
ILLINOIS FED. AID PROJECT				

PRIVATE ENTRANCE AND FIELD ENTRANCE DETAIL

(EXISTING HMA OR OIL & CHIP LESS THAN 10')

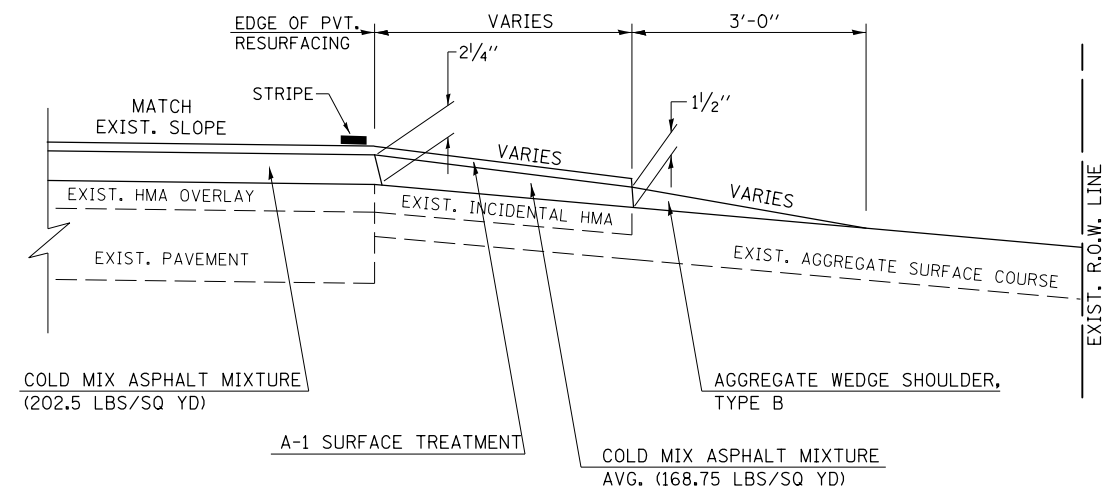

LOCATION	STATION
F. E.	294+02.00 RT
F. E.	307+40.70 RT
P. E.	324+48.00 RT
F. E.	340+93.60 LT
F. E.	368+12.00 RT

NOTES: THE INTENT IS TO RESURFACE THE EXISTING CONFIGURATION OF THE ENTRANCES.

PRIVATE ENTRANCE AND FIELD ENTRANCE DETAIL WITH EXISTING CONCRETE GUTTER, TYPE B MODIFIED

(EXISTING HMA)

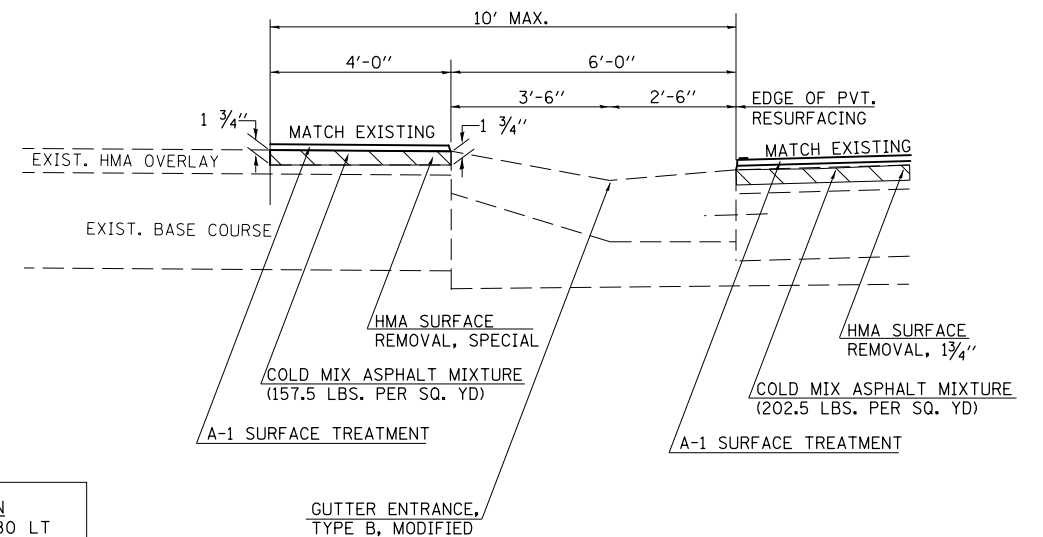

LOCATION	STATION
F. E.	279+73.80 LT
P. E.	280+79.70 RT
P. E.	300+45.90 LT
P. E.	300+74.60 RT
P. E.	301+11.00 RT
*P. E.	314+24.80 RT

NOTES: THE INTENT IS TO RESURFACE THE EXISTING HMA CONFIGURATION OF THE ENTRANCES.

*THIS LOCATION HAS AN EXISTING HMA COMBINATION P.E./MAILBOX TURNOUT. THE MAILBOX TURNOUT PORTION SHALL ALSO BE MILLED AND RESURFACED SIMILAR TO THE ADJACENT PE. SEE DETAIL BELOW.

MAILBOX TURNOUTS

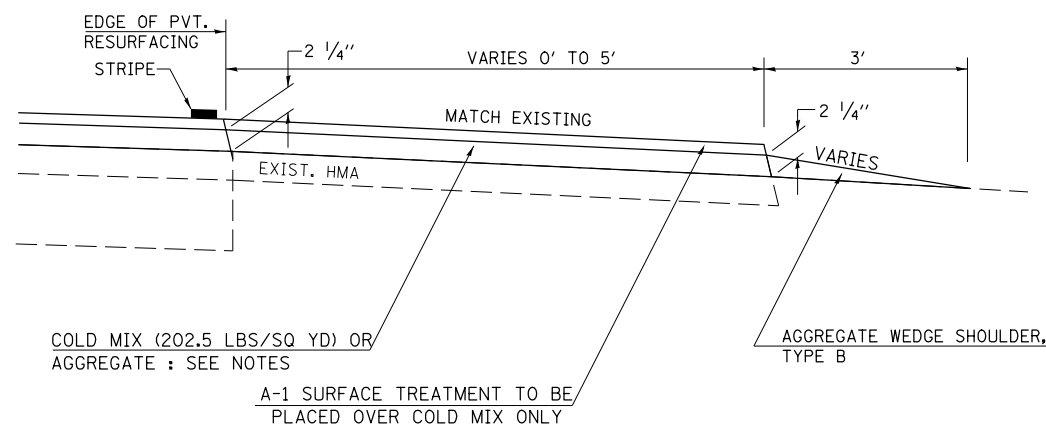

STATION
•257+39.70 RT
•271+20.00 RT
•314+24.80 RT
•323+36.60 RT

NOTES: THE INTENT IS TO RESURFACE THE EXISTING CONFIGURATION OF THE MAIL BOX TURNOUTS. HMA SURFACE REMOVAL, SPECIAL IS REQUIRED AT THE FOLLOWING LOCATION: STA. 271+20 RT

WHERE AN AGGREGATE SURFACE IS TO BE PLACED, USE THE AGGREGATE WEDGE SHOULDER, TYPE B MATERIAL.

*THESE DESIGNATED LOCATIONS HAVE AN EXISTING HMA COMBINATION P.E./MAILBOX TURNOUT. THE EXISTING MAILBOX TURNOUT PORTIONS WITH HMA SURFACES SHALL ALSO BE MILLED AND RESURFACED ACCORDING TO THEIR RESPECTIVE PRIVATE ENTRANCES (SEE DETAILS ON THIS SHEET AND PREVIOUS SHEET). WHERE THE EXISTING MAILBOX TURNOUT PORTIONS HAVE AN AGGREGATE SURFACE, PLACE AGGREGATE ON THESE PORTIONS TO MATCH THE THICKNESS AND SLOPE OF THE ADJACENT PRIVATE ENTRANCE (SEE DETAIL ON PREVIOUS SHEET).

MAILBOX TURNOUT PORTION ADJACENT TO PRIVATE ENTRANCE (EXISTING HMA)
STA. 314+24.80 RT

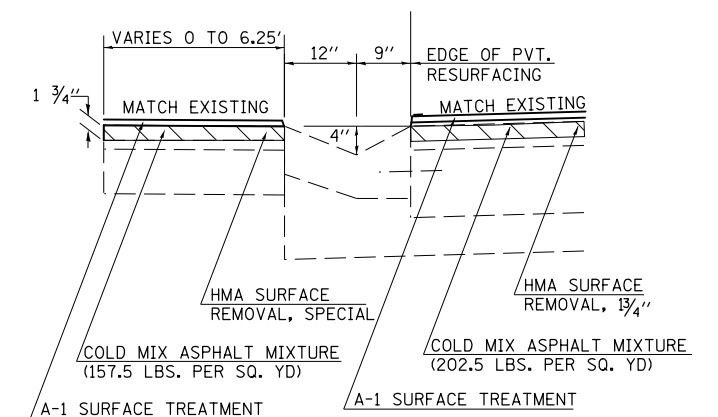

GENERAL NOTES

1. THE EXISTING SURFACE SHALL BE PREPARED IN ACCORDANCE WITH SECTION 408 OF THE STANDARD SPECIFICATIONS.
2. ANY NECESSARY WORK BEHIND THE HMA SHOULDER OR THE INCIDENTAL HMA SURFACING SHALL BE AS SHOWN IN THE PLANS AND/OR AS DIRECTED BY THE ENGINEER.
3. EXISTING FIELD ENTRANCES OF AGGREGATE OR EARTH WITH NO HMA APRON SHALL NOT RECEIVE A NEW HMA APRON WITHOUT PROPER APPROVAL THROUGH THE BUREAU OF OPERATIONS "POLICY ON PERMITS FOR ACCESS DRIVEWAYS TO STATE HIGHWAYS".
4. TO ASSURE APPROPRIATE ACCESS POLICIES ARE FOLLOWED ALL NEW ACCESS SHALL BE APPLIED FOR THROUGH THE BUREAU OF OPERATIONS PERMIT APPLICATION PROCESS. PLAN PREPARATION MEMORANDUMS 40-09 AND 40-11 ALONG WITH DISTRICT CONSTRUCTION MEMORANDUM 03/14 DISCUSS THIS PROCEDURE.

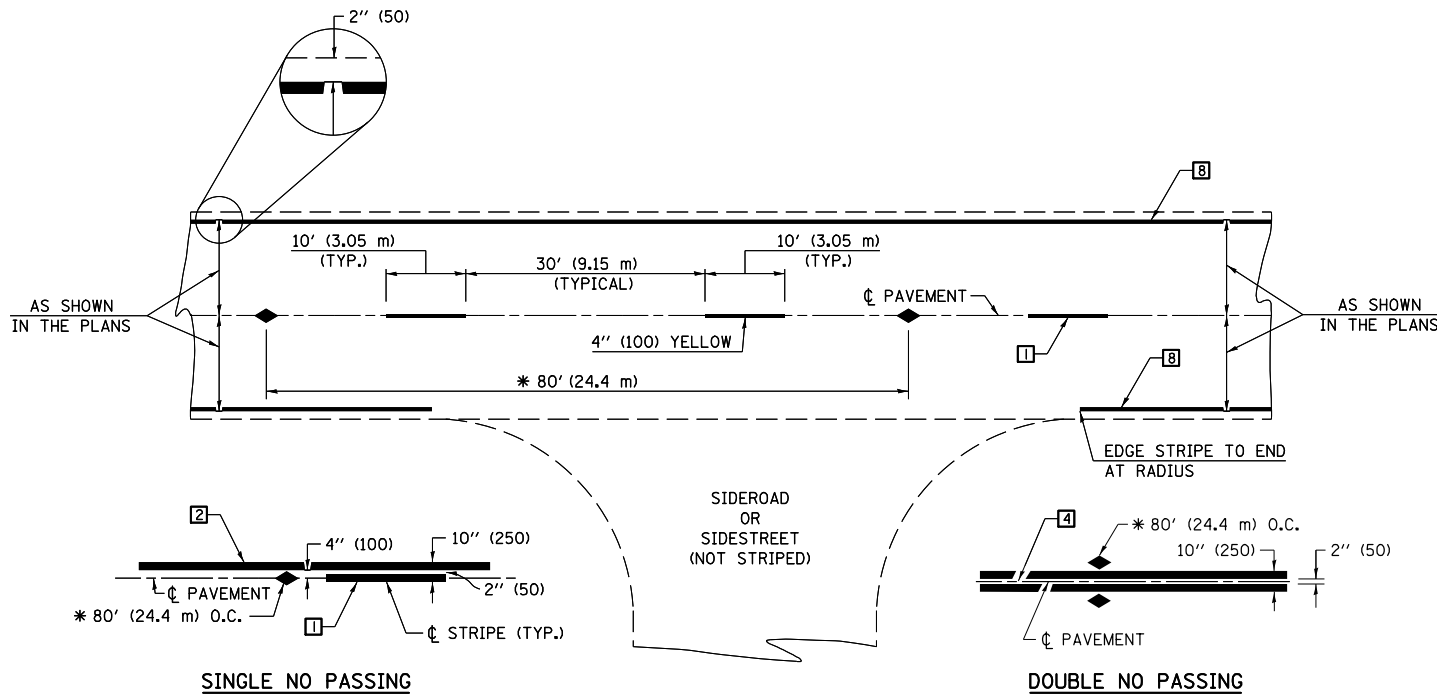

* REDUCE TO 40' (12.2 m) O.C. ON CURVES WITH POSTED OR ADVISORY SPEEDS OF 45 mph (70 km/h) OR LESS.

TWO LANE/TWO WAY

TYPICAL PAVEMENT MARKING LEGEND

- 1 4" (100) SKIP-DASH (YELLOW)
- 2 4" (100) SOLID (YELLOW)
- 3 12" (300) DIAGONAL (YELLOW)
- 4 4" (100) DOUBLE YELLOW (NARROW)
- 5 RESERVED
- 6 RESERVED
- 7 4" (100) SKIP-DASH (WHITE)
- 8 4" (100) SOLID (WHITE)
- 9 12" (300) DIAGONAL (WHITE)
- 10 6" (150) SOLID (WHITE)
- 11 24" (600) STOP BAR (WHITE)
- 12 8" (200) SOLID (WHITE)
- 13 4" (100) LANE LINE EXTENSIONS (WHITE)
- 14 4" (100) PARKING WHITE

TYPICAL PAVEMENT MARKERS LEGEND

- ◆ TWO-WAY AMBER MARKER
- ▶ ONE-WAY AMBER MARKER
- ▷ ONE-WAY CRYSTAL MARKER

RURAL LEFT TURN

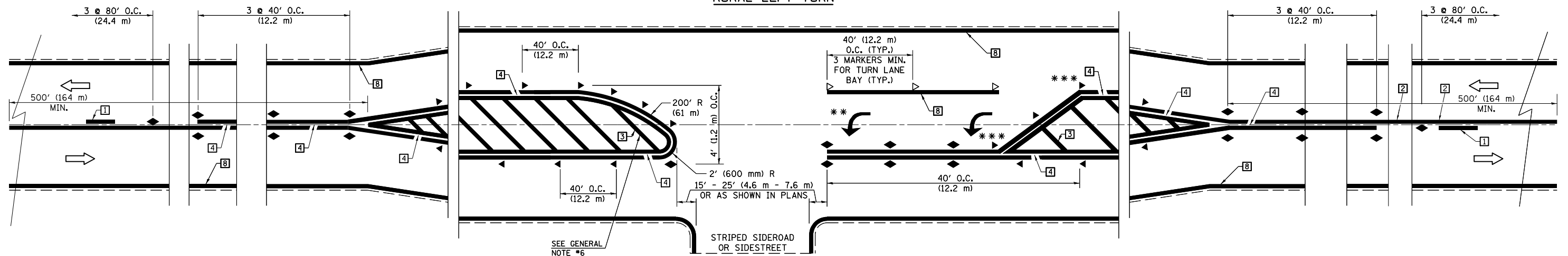

*** REDUCE SPACING IF NECESSARY TO ASSURE MARKERS AT CORNER POINTS.

** TURN ARROWS SHALL BE PLACED AS SHOWN ON SHEET #2.

Note: All dimensions are in INCHES (millimeters) unless otherwise shown.

FILE NAME =	USER NAME = dawsonkb	DESIGNED -	REVISED - 11/06
ei:\pwork\pwork\dot\dawsonkb\0288686\0570930-shd-detail.dgn		DRAWN -	REVISED - 09/2009 - KJI
	PLOT SCALE = 40.0000' / in.	CHECKED -	REVISED -
	PLOT DATE = 1/31/2012	DATE -	REVISED -

**STATE OF ILLINOIS
DEPARTMENT OF TRANSPORTATION**

**PAVEMENT MARKING AND MARKERS
(RURAL & URBAN APPLICATIONS)**

SCALE: _____ SHEET NO. 1 OF 4 SHEETS STA. _____ TO STA. _____

DISTRICT 5 DETAIL NO. 7800AAA

F.A.S. RTE.	SECTION	COUNTY	TOTAL SHEETS	SHEET NO.
522	(4)RS	Champaign	23	19
CONTRACT NO. 70930				
FED. ROAD DIST. NO. - ILLINOIS FED. AID PROJECT				

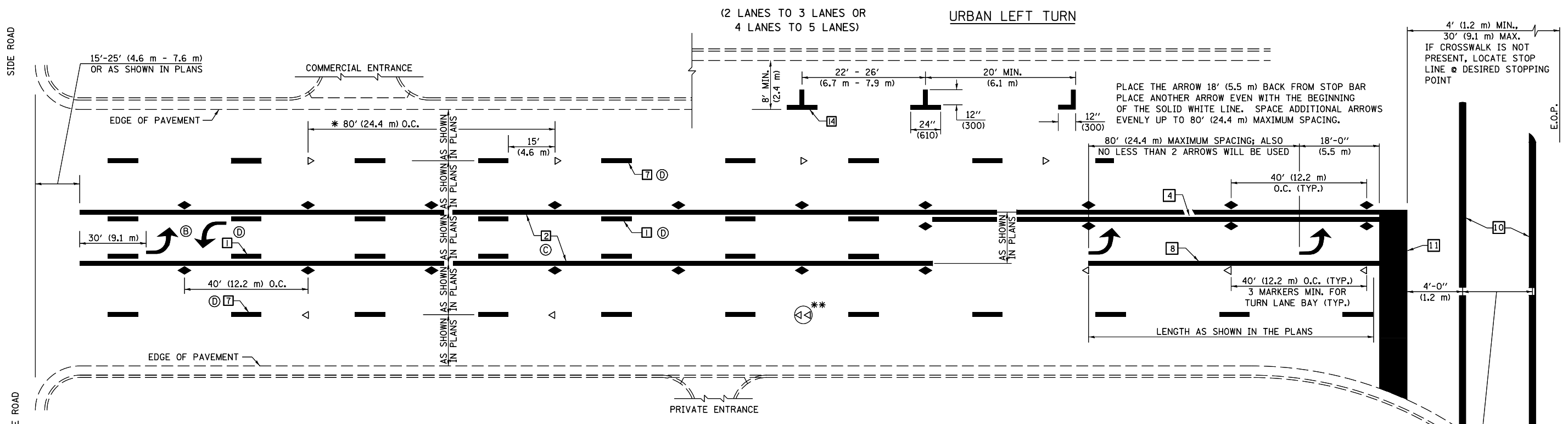

* REDUCE TO 40 FEET (12.2 METERS) ON CENTER ON CURVES WHERE ADVISORY SPEEDS ARE 10 MPH (15 km/h) LOWER THAN POSTED SPEEDS.

** DOUBLE LANE LINE MARKERS SHALL BE SPECIFIED AND SPACED AS SHOWN IN HIGHWAY STANDARD 781001 FOR MULTI-LANE DIVIDED AND UNDIVIDED HIGHWAYS.

- GENERAL NOTES:**
- ⓑ TURN ARROW PAIRS SHALL BE PLACED AT 250' (75 m) INTERVALS AND SHALL BE EVENLY SPACED BETWEEN BOTH ENDS OF THE BIDIRECTIONAL LEFT TURN LANE.
 - ⓒ THE SOLID YELLOW PAVEMENT MARKINGS [2] SHOULD GENERALLY START OR END NEAR THE RADIUS POINT OF EACH STREET RETURN EXCEPT WHERE ONE OR BOTH ENDS WOULD INCLUDE STOP BARS.
 - ⓓ THE SKIP-DASH PAVEMENT MARKINGS [1] OR [7] SHOULD BE CENTERED BETWEEN BOTH ENDS OF EACH CITY BLOCK AND SHALL BE PLACED SO THEY LINE UP ACROSS FROM EACH OTHER. SEE EXAMPLE ON SHEET 2 OF 3.
 - ⓔ USE LARGE ARROW SIZE FOR BOTH RURAL AND URBAN LOCATIONS. (SEE LAST PAGE OF SECTION 780x FOR SYMBOLS TABLE)

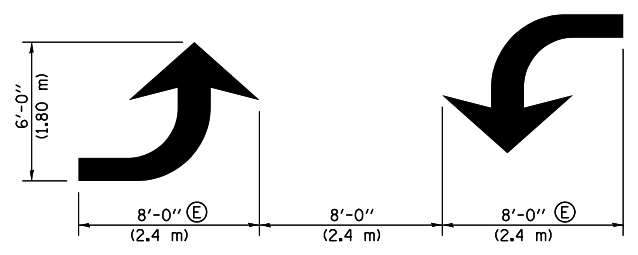
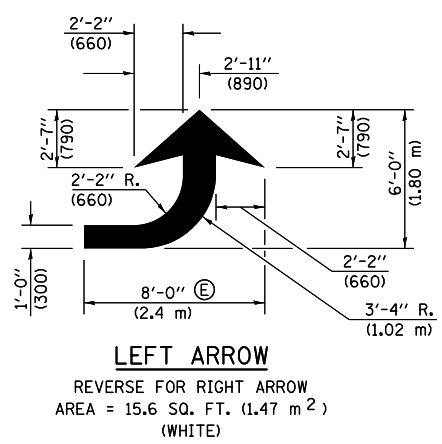

BLOOMINGTON-NORMAL CITY LIMITS ONLY

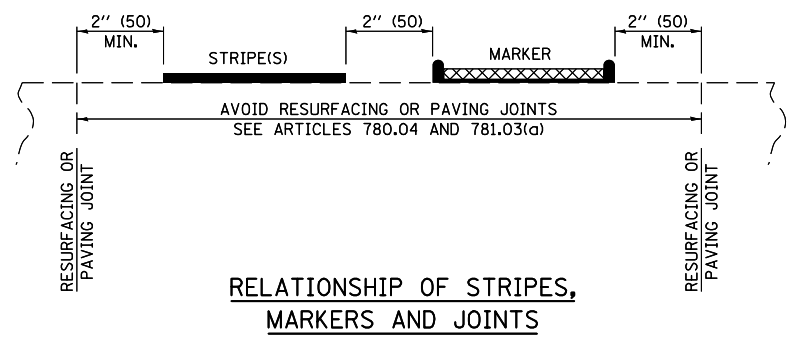
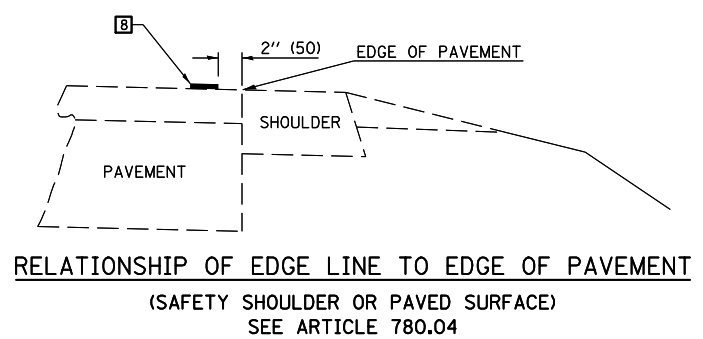
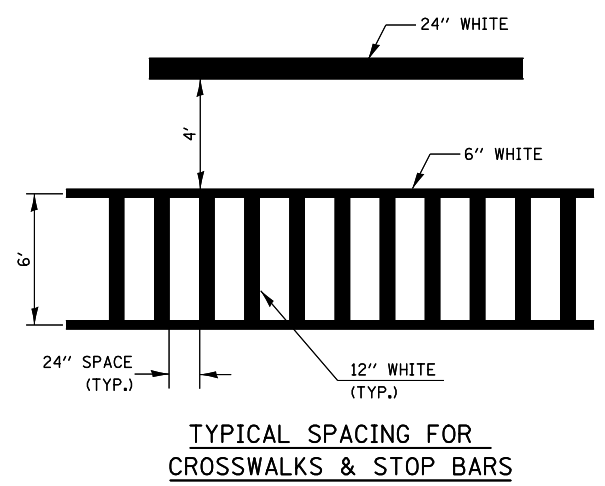

Note: All dimensions are in INCHES (millimeters) unless otherwise shown.

DISTRICT 5 DETAIL NO. 7800AAA

FILE NAME =	USER NAME = dawsonkb	DESIGNED -	REVISED - 11/06
ei:\pw\work\p\idot\dawsonkb\02288686\0570930-shd-detail.dgn		DRAWN -	REVISED - 09/2009 - KJI
	PLOT SCALE = 40.0000' / in.	CHECKED -	REVISED -
	PLOT DATE = 1/31/2012	DATE -	REVISED -

**STATE OF ILLINOIS
 DEPARTMENT OF TRANSPORTATION**

**PAVEMENT MARKING AND MARKERS
 (RURAL & URBAN APPLICATIONS)**

SCALE: _____ SHEET NO. 2_ OF 4_ SHEETS STA. _____ TO STA. _____

F.A.S. RTE.	SECTION	COUNTY	TOTAL SHEETS	SHEET NO.
522	(41)RS	Champaign	23	20
CONTRACT NO. 70930				
FED. ROAD DIST. NO. - [ILLINOIS] FED. AID PROJECT				

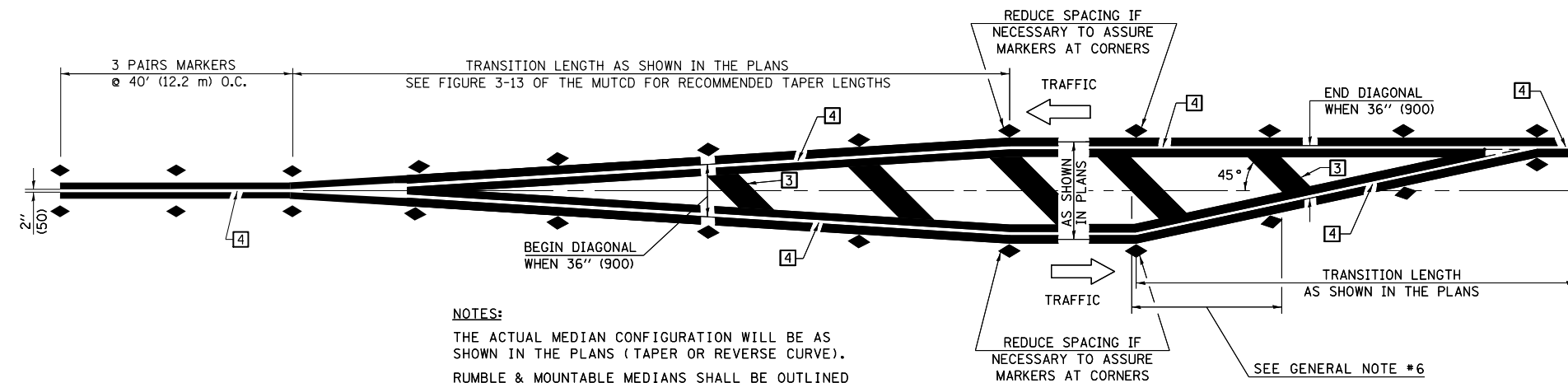

NOTES:
 THE ACTUAL MEDIAN CONFIGURATION WILL BE AS SHOWN IN THE PLANS (TAPER OR REVERSE CURVE).
 RUMBLE & MOUNTABLE MEDIANS SHALL BE OUTLINED WITH [2].

TYPICAL MEDIAN TRANSITIONS

GENERAL NOTES

1. WHEN MEDIANS ARE PRESENT, PAVEMENT MARKINGS ARE TO BE PLACED ADJACENT TO MEDIANS.
2. SOME OF THE INFORMATION INCLUDED WITH THIS DETAIL MAY NOT BE APPLICABLE TO THIS IMPROVEMENT.
3. PAVEMENT MARKINGS ARE TO BE EXTENDED THROUGH OMISSIONS WHEN APPLICABLE.
4. A STRIPING KEY IS AVAILABLE ELSEWHERE AND SHALL BE SHOWN WHERE THE QUANTITIES ARE LISTED.
5. FINAL PAVEMENT MARKINGS SHALL BE IN PLACE PRIOR TO PLACING ANY RAISED REFLECTIVE PAVEMENT MARKERS.
6. THE FOLLOWING CRITERIA SHALL BE USED FOR SELECTING THE DIAGONAL PAVEMENT MARKING SPACING,
 < 30 MPH USE 15' (< 50 km/h USE 4.5 m)
 30-45 MPH USE 20' (50-75 km/h USE 6.0 m)
 > 45 MPH USE 30' (> 75 km/h USE 9.0 m)

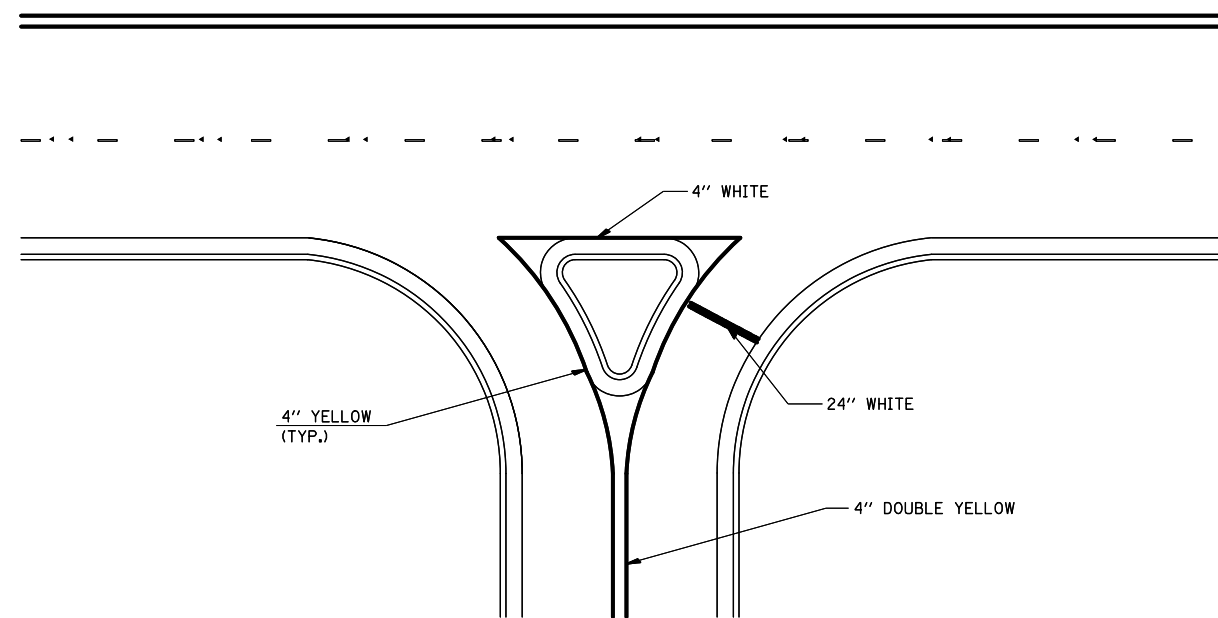

RIGHT IN - RIGHT OUT ACCESS

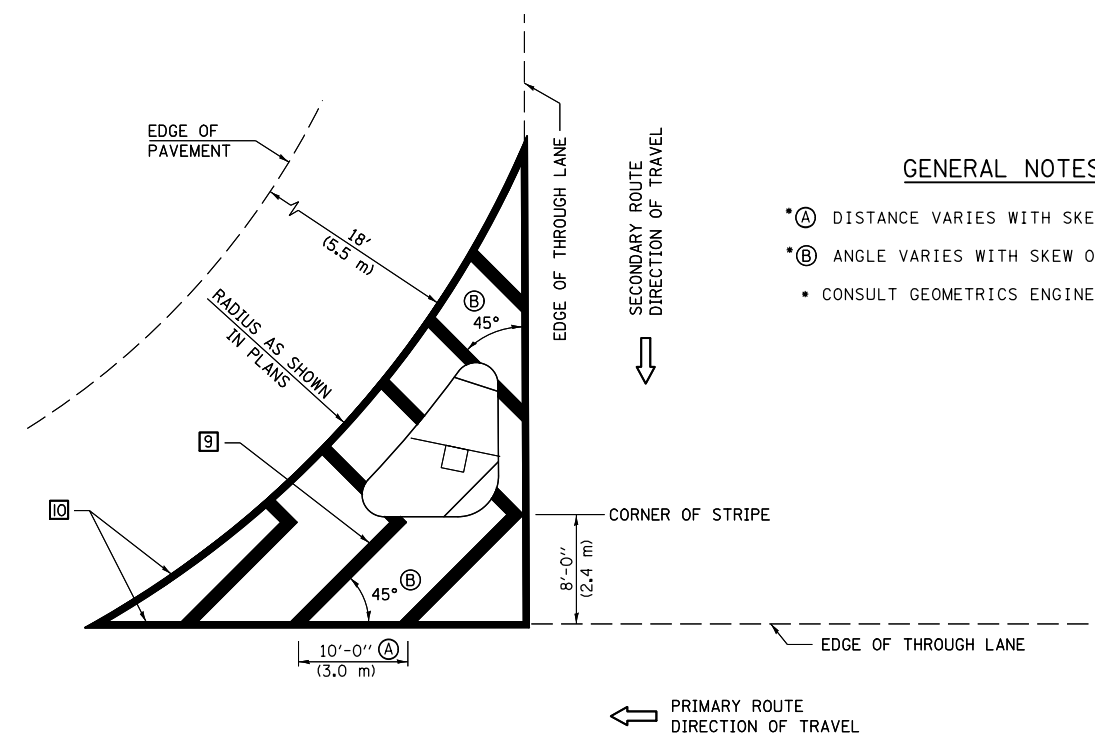

GENERAL NOTES

- (A) DISTANCE VARIES WITH SKEW OF INTERSECTION.
- (B) ANGLE VARIES WITH SKEW OF INTERSECTION.
- CONSULT GEOMETRICS ENGINEER

ISLAND

Note: All dimensions are in INCHES (millimeters) unless otherwise shown.

DISTRICT 5 DETAIL NO. 7800AAAA

FILE NAME =	USER NAME = dawsonkb	DESIGNED -	REVISED - 11/06
ei:\pwork\pwork\dwsonkb\02288686\0570930-shd-details.dgn		DRAWN -	REVISED - 09/2009 - KJI
	PLOT SCALE = 40.0000' / in.	CHECKED -	REVISED -
	PLOT DATE = 1/31/2012	DATE -	REVISED -

**STATE OF ILLINOIS
 DEPARTMENT OF TRANSPORTATION**

**PAVEMENT MARKING AND MARKERS
 (RURAL & URBAN APPLICATIONS)**

SCALE: _____ SHEET NO. 3 OF 4 SHEETS STA. _____ TO STA. _____

F.A.S. RTE.	SECTION	COUNTY	TOTAL SHEETS	SHEET NO.
522	(4)RS	Champaign	23	21
CONTRACT NO. 70930				
FED. ROAD DIST. NO. - ILLINOIS FED. AID PROJECT				

RAILROAD CROSSING WITH INTERCONNECT ONLY

RAILROAD CROSSING WITH INTERCONNECT AND PRE-SIGNALS

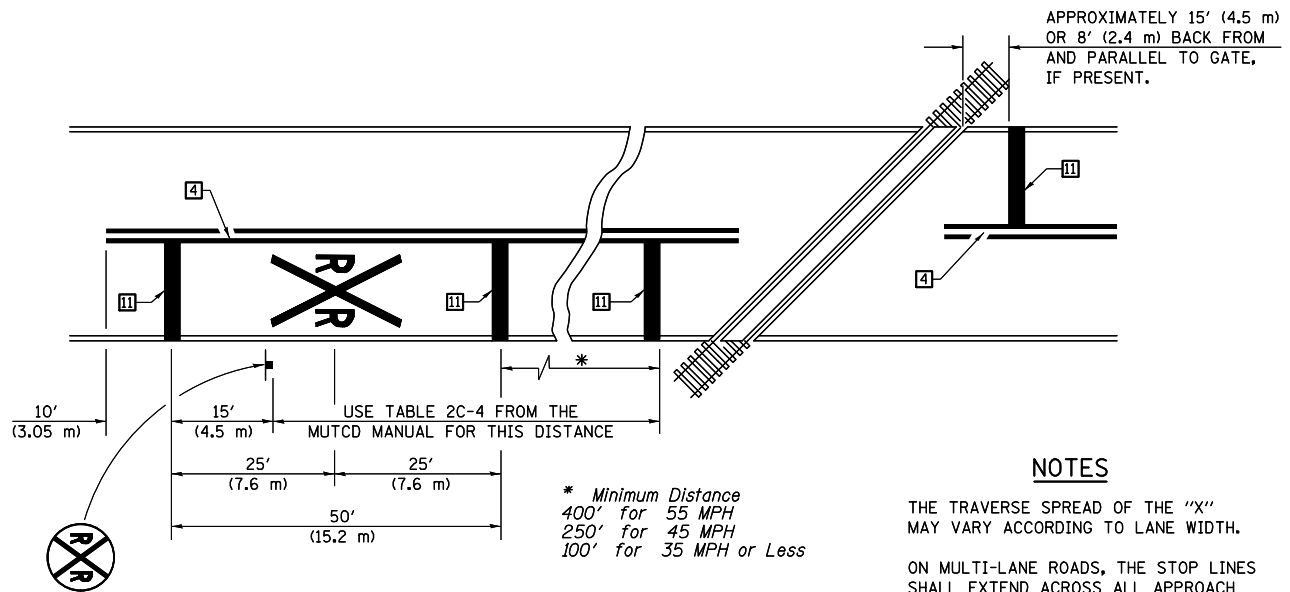

PAVEMENT MARKINGS AT RAILROAD-HIGHWAY GRADE CROSSING

NOTES

APPROXIMATELY 15' (4.5 m) OR 8' (2.4 m) BACK FROM AND PARALLEL TO GATE, IF PRESENT.

THE TRAVERSE SPREAD OF THE "X" MAY VARY ACCORDING TO LANE WIDTH.

ON MULTI-LANE ROADS, THE STOP LINES SHALL EXTEND ACROSS ALL APPROACH LANES AND SEPARATE RXR SYMBOLS SHALL BE PLACED ADJACENT TO EACH OTHER IN EACH LANE.

WHEN THE PAVEMENT MARKING SYMBOL IS USED, A PORTION OF THE SYMBOL SHOULD BE LOCATED DIRECTLY ADJACENT TO THE ADVANCE WARNING SIGN (W10-1) AS PLACED BY TABLE II-1, CONDITION B OF THE MUTCD.

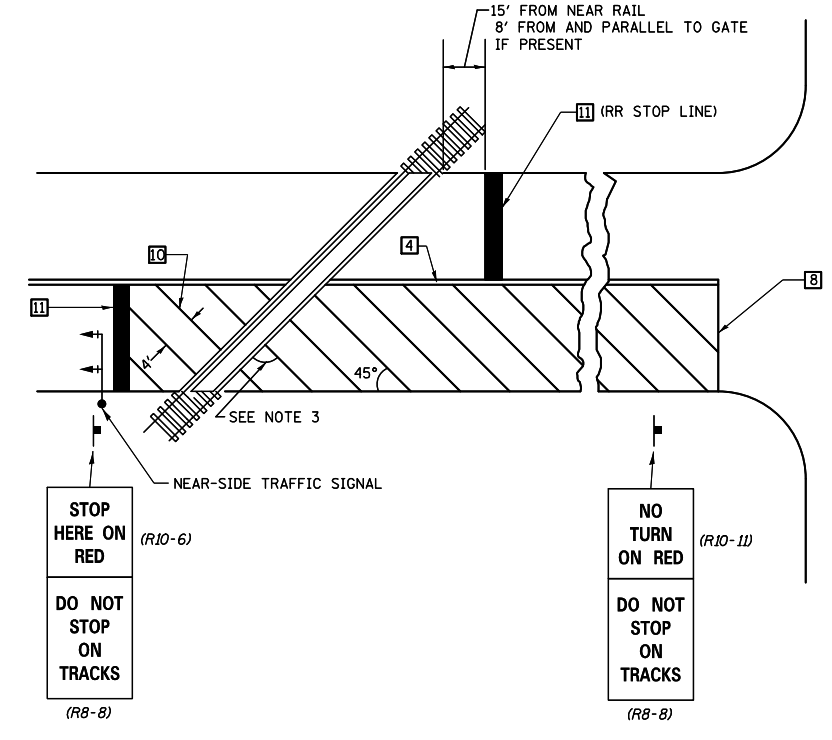
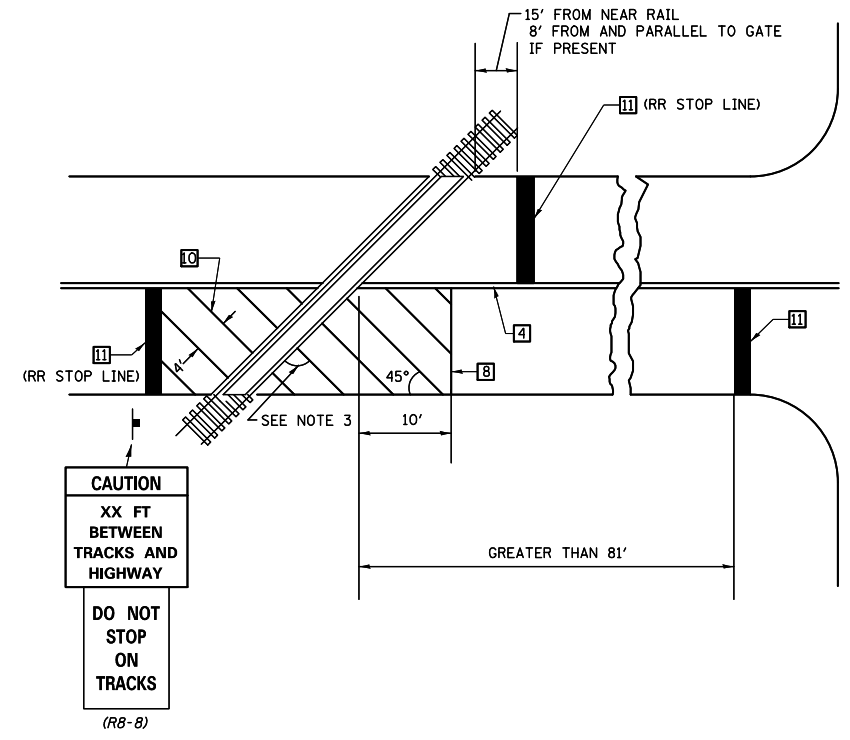

SUPPLEMENTAL PAVEMENT MARKING TREATMENT FOR RAILROAD-HIGHWAY GRADE CROSSING

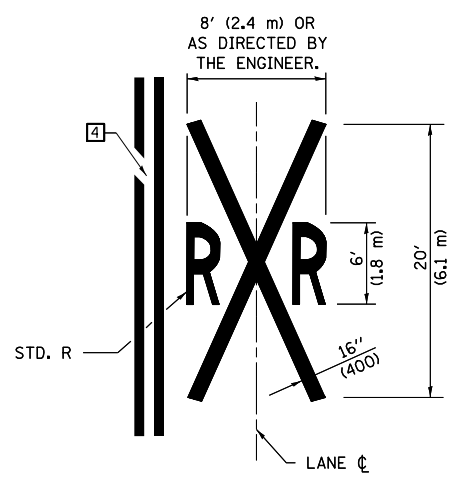

GENERAL NOTES

- SUPPLEMENTAL PAVEMENT MARKINGS TO BE INSTALLED ONLY ON APPROACHES TO INTERSECTIONS CONTROLLED BY TRAFFIC SIGNALS WHICH ARE INTERCONNECTED WITH THE RAILROAD WARNING SIGNALS.
- EXTEND PAVEMENT MARKINGS TO THE INTERSECTION ONLY WHERE NEAR-SIDE TRAFFIC SIGNALS ARE USED.
- WHERE THE ANGLE BETWEEN THE DIAGONAL PAVEMENT MARKINGS AND THE TRACK WOULD BE LESS THAN 20°, THE PAVEMENT MARKINGS SHOULD BE PLACED IN THE OPPOSITE DIRECTION FROM THAT SHOWN.

Note: All dimensions are in INCHES (millimeters) unless otherwise shown.

FILE NAME =	USER NAME = dawsonkb	DESIGNED -	REVISED - 11/06
ei:\pw\work\p1dot\dawsonkb\0288686\0570930-sh1-details.dgn		DRAWN -	REVISED - 09/2009 - KJI
	PLOT SCALE = 40.0000' / in.	CHECKED -	REVISED -
	PLOT DATE = 1/31/2012	DATE -	REVISED -

STATE OF ILLINOIS
DEPARTMENT OF TRANSPORTATION

PAVEMENT MARKING AND MARKERS
(RURAL & URBAN APPLICATIONS)

SCALE: _____ SHEET NO. 4_ OF 4_ SHEETS STA. _____ TO STA. _____

DISTRICT 5 DETAIL NO. 7800AAAA

F.A.S. RTE.	SECTION	COUNTY	TOTAL SHEETS	SHEET NO.
522	(4)RS	Champaign	23	22
FED. ROAD DIST. NO. - ILLINOIS FED. AID PROJECT				CONTRACT NO. 70930

TO BE INSTALLED IN ALL PAVEMENT TYPES FOR PRESERVING PERMANENT SURVEY MARKERS (PI'S, PT'S, PC'S, POC'S, & POT'S) AND LAND SURVEY MONUMENTS (SECTION OR SUBSECTION CORNERS)

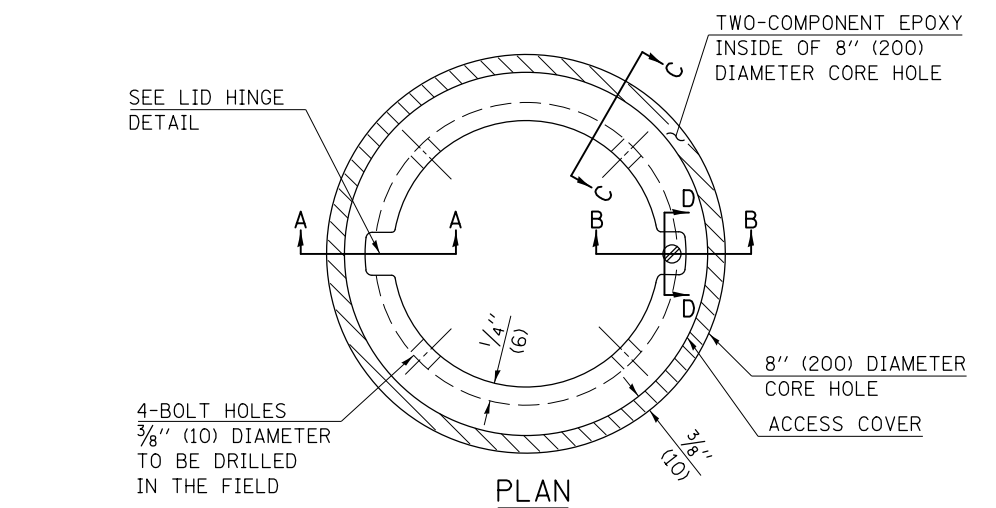

LEGEND

- ALUMINUM CASTING
- 5" (125) OR 6" (150) P.V.C. PIPE
- TWO-COMPONENT EPOXY

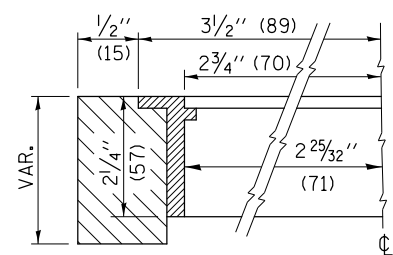

SECTION C-C

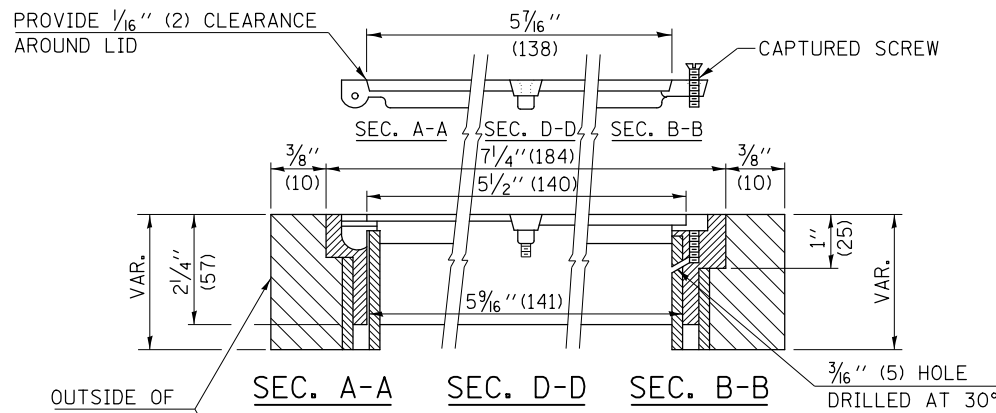

ELEVATION

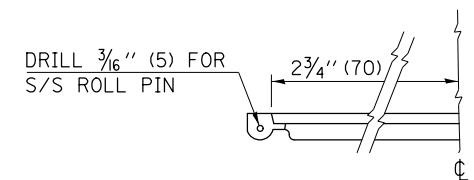

LID HINGE DETAIL

SPECIFICATIONS FOR ACCESS COVER FOR USE WITH SURVEY MARKER VAULT(S) AND SURVEY MARKER COVER ASSEMBLY(S): THE ACCESS COVER WILL BE CAST FROM A SPECIAL ALUMINUM ALLOY THAT IS COMPARABLE TO BRONZE IN HARDNESS. THE ACCESS COVER SHALL BE SPECIALLY ENGINEERED AND DESIGNED TO PROVIDE A SNUG FIT, INCORPORATING EQUIDISTANT LOCKING RIDGES, INSIDE A STANDARD 6" (150 mm) DIAMETER, OR OUTSIDE A STANDARD 5" (125 mm) DIAMETER, SCHEDULE 40 PVC PIPE. THE ACCESS COVER SHALL HAVE SPECIAL UNIFORM 1" (25 mm) THICK TOP SURFACE TO PERMIT INFORMATION TO BE EASILY MACHINE-STAMPED INTO IT. THE ACCESS COVER SHALL INCLUDE A STAINLESS CAPTURED SCREW AND AN OPPOSING RECESSED HINGE ASSEMBLY AS ITS LOCKING MECHANISM. THE ACCESS COVER SHALL INCORPORATE A SPECIAL ACCESS HOLE FOR CLEANING AND DRAINAGE, DRILLED AT 30° INSIDE THE RING OF THE ACCESS COVER, TO THE DRILLED AND TAPPED HOLE PROVIDED FOR THE STAINLESS CAPTURED SCREW. COMPOSITION: ALUMINUM 92-93%; MAGNESIUM 6.5-7.5%. STRENGTH: YIELD - 19,000-21,000 PSI (131-145 MPa); TENSILE - 38,000-44,000 PSI (262-303 MPa); ELONGATION - 10-15% IN 2" (50 mm). SPECIFICATIONS: ALLOY 535.0; Q0-A-601Es. NO EXCEPTIONS.

BILL OF MATERIAL

ALUMINUM CASTING OF THE DIMENSIONS AND SPECIFICATIONS SHOWN OR OTHER SUBJECT TO ENGINEER'S APPROVAL OF SHOP DRAWINGS, 4 EACH - 5/16" X 2" (M8 X 50) BOLTS WITH NUTS, EPOXY, 5" OR 6" (125 mm OR 150 mm) DIAMETER P.V.C. PIPE, SCHEDULE 40 (WHEN REQUIRED).

GENERAL NOTES

1. WORK SHALL NOT START ON THIS ITEM UNTIL THE FINAL LIFT OF SURFACE HAS BEEN COMPLETED.
2. THE SURVEY MONUMENT COVER ASSEMBLY SHALL BE CENTERED ABOVE THE SURVEY MONUMENT TO BE PROTECTED.
3. MODIFICATION OF THE ALUMINUM CASTING SHALL BE DONE BY GRINDING OR SAWING WHEN HEIGHT REDUCTION IS REQUIRED.
4. ALL SURVEY MONUMENT COVER ASSEMBLIES SHALL BE PLACED 1/4" (6 mm) ± BELOW THE FINAL SURFACE.
5. ALUMINUM CASTING SHALL BE PLACED OVER A 5" (125 mm) P.V.C. PIPE OR INSIDE OF A 6" (150 mm) P.V.C. PIPE WHEN AN INCREASE IN HEIGHT IS REQUIRED.
6. THE CASTING SHALL BE ANCHORED IN THE 8" (200 mm) DIAMETER CORE HOLE WITH TWO-COMPONENT EPOXY CONFORMING TO APPLICABLE PORTIONS OF ARTICLE 1025.01 OF THE STANDARD SPECIFICATIONS.
7. THIS WORK WILL BE PAID FOR AT THE CONTRACT UNIT PRICE EACH FOR SURVEY MONUMENT COVER ASSEMBLY WHICH PRICE SHALL INCLUDE ALL LABOR AND MATERIAL AS SPECIFIED INCLUDING CORING THE NEW PAVEMENT SURFACE AND EPOXY. NO ADDITIONAL COMPENSATION WILL BE ALLOWED.
8. THE 8" (200 mm) DIAMETER CORE HOLE SHALL BE SUBJECT TO THE APPROVAL OF THE ENGINEER.

Note: All dimensions are in INCHES (millimeters) unless otherwise shown.

FILE NAME =	USER NAME = dawsonkb	DESIGNED -	REVISED - 11/06
ei:\pw\work\p\idot\dawsonkb\02288686\0570930-shd-details.dgn		DRAWN -	REVISED -
	PLOT SCALE = 40.0000' / in.	CHECKED -	REVISED -
	PLOT DATE = 1/31/2012	DATE -	REVISED -

**STATE OF ILLINOIS
DEPARTMENT OF TRANSPORTATION**

SURVEY MONUMENT COVER ASSEMBLY

SCALE: _____ SHEET NO. ____ OF ____ SHEETS STA. _____ TO STA. _____

DISTRICT 5 DETAIL NO. Z0070100				
F.A.S. RTE.	SECTION	COUNTY	TOTAL SHEETS	SHEET NO.
522	(41)RS	Champaign	23	23
CONTRACT NO. 70930			FED. ROAD DIST. NO. - [ILLINOIS] FED. AID PROJECT	